





# City of West Allis

7525 W. Greenfield Ave.  
West Allis, WI 53214

## Resolution

**File Number: R-2005-0090**

**Final Action:**

---

Resolution to confirm and adopt the report of the City Engineer containing the schedule of proposed assessments for improvement of S. 56 St. from 475' north of W. Walker St. to W. National Ave. and portions of intersecting streets by concrete reconstruction of the pavement with miscellaneous walk repair, new driveway approaches, storm sewer, storm sewer relay, sanitary sewer relay, water main relay, building services and utility adjustments.

WHEREAS, The City Engineer, pursuant to Preliminary Resolution No. R-2005-0043, adopted on February 1, 2005, prepared and submitted his report as provided in sec. 66.0703(5) of the Wisconsin Statutes, for the improvement of the street as hereinafter described; and,

WHEREAS, The City Clerk/Treasurer gave due notice that such report was open for inspection at his office and also at the office of the City Engineer, and that all persons interested could appear before the Common Council and be heard concerning the matters contained in the Preliminary Resolution and Report; and,

WHEREAS, The Common Council met pursuant to such notice, at the time and place therein named; and having considered all statements and communications concerning the proposed improvements, relating to the matters contained in the City Engineer's report, including the schedule of proposed assessments, the Common Council makes no change in said report.

NOW, THEREFORE, BE IT RESOLVED By the Common Council of the City of West Allis:

1. The report of the City Engineer, including the schedule of the proposed assessments, for the improvement of S. 56 St. from 475' north of W. Walker St. to W. National Ave. and portions of intersecting streets by concrete reconstruction of the pavement with miscellaneous walk repair, new driveway approaches, storm sewer, storm sewer relay, sanitary sewer relay, water main relay, building services and utility adjustments be and the same is hereby approved and adopted.
2. The property against which the assessments are proposed is benefited; the assessments shown on the report are true and correct, have been determined on a reasonable basis and are hereby confirmed.
3. The City Engineer is hereby authorized and directed to prepare final plans for the aforesaid area in accordance with the terms of this resolution.

Eng05-33

**ADOPTED**

~~Paul M. Ziebler, City Admin. Officer, Clerk/Treas.~~

**APPROVED**

~~Jeannette Bell, Mayor~~



# CITY OF WEST ALLIS

WISCONSIN



Engineering Department

**MICHAEL G. LEWIS**  
*City Engineer*

March 15, 2005

Honorable Mayor and Common Council  
West Allis, Wisconsin

Dear Mayor and Council Members:

I herewith respectfully submit my report on the assessment of benefits for concrete reconstruction of the pavement including miscellaneous walk repair, new driveway approaches, storm sewer, storm sewer relay, sanitary sewer relay, water main relay, building services and utility adjustments in:

**S. 56 St. from 475' north of W. Walker St. to W. National Ave. and portions of intersecting streets**

as directed in Preliminary Resolution No. R-2005-0043, adopted on February 1, 2005.

This report consists of the following schedules attached hereto:

- Schedule A. - Preliminary Plans and Specifications;
- Schedule B. - Estimate of Entire Cost of Proposed Improvements;
- Schedule C. - Schedule of Proposed Assessments Against Each Parcel Affected.

The property against which the assessments are proposed is benefited.

Respectfully submitted,

Michael G. Lewis, P.E.  
City Engineer

MGL:jb

Encs.

H:\2005 Projects\1052852 CC.doc

**PROPOSED IMPROVEMENT OF**

**S. 56 St. from 475' north of W. Walker St. to W. National Ave.  
and portions of intersecting streets**

by concrete reconstruction of the pavement including miscellaneous walk repair, new driveway approaches, storm sewer, storm sewer relay, sanitary sewer relay, water main relay, building services and utility adjustments.

**SCHEDULE "A"**

Preliminary Plans & Specifications Attached

**SCHEDULE "B"**

Estimate of the Entire Cost

\$ 396,000

**SCHEDULE "C"**

Schedule of Proposed Assessments  
Against Each Parcel Affected

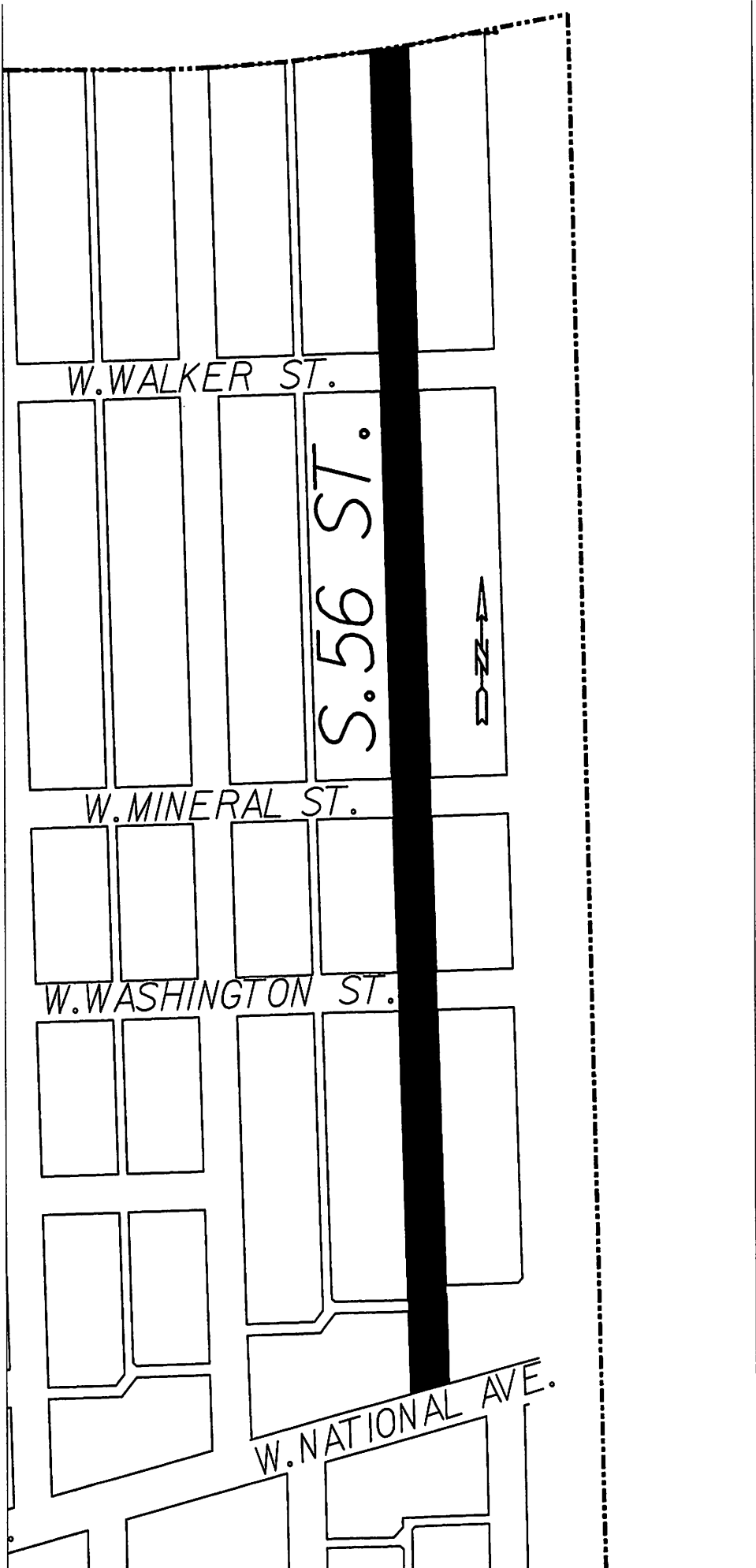

W. WALKER ST.

S. 56 ST.



W. MINERAL ST.

W. WASHINGTON ST.

W. NATIONAL AVE.



# CITY OF WEST ALLIS

WISCONSIN



Engineering Department

**MICHAEL G. LEWIS**  
*City Engineer*

March 15, 2005

Board of Public Works  
West Allis City Hall  
West Allis, Wisconsin

Dear Board Members:

I am herewith submitting preliminary plans and an estimate of costs for concrete reconstruction of the pavement including miscellaneous walk repair, new driveway approaches, storm sewer, storm sewer relay, sanitary sewer relay, water main relay, building services and utility adjustments in:

**S. 56 St. from 475' north of W. Walker St. to W. National Ave. and portions of intersecting streets**

Estimated Construction Cost:	\$360,000
Contingency:	<u>36,000</u>
<b>TOTAL:</b>	<b>\$396,000</b>

Sincerely,

Michael G. Lewis, P.E.  
City Engineer

MGL:jb

H:\2005 Projects\1052852 BPW.doc

**ASSESSMENT REPORT FOR COUNCIL**

**HEARING DATE: March 15, 2005**

**LOCATION**

**DESCRIPTION: S. 56 St. from 475' north of W. Walker St. to W. National Ave. and portions of intersecting streets**

**ACCOUNT NO.: 1052852**

**INTEREST RATE: 6.0%**

<u>2005 ASSESSMENT RATES</u>	<u>Resid.</u>	<u>Comm.</u>	<u>Mfg.</u>
<b><u>Streets</u></b>			
Street reconstruct w/walk, lin. ft.	\$34.63	\$43.29	
<b><u>Driveways</u></b>			
7" concrete approach, per sq. ft.	\$4.31	\$4.31	
<b><u>U/G</u></b>			
Storm sewer lateral, each		\$892.00	

*The properties against which the assessments are proposed are benefited.*



SPECIALS BY PROJECT INDEX

KEY	SPL	015C	03/10/05	PAGE	GROSS	NET	ADDRESS	56 ST
438	0015	000	1	7	1,590.21	1,451.69	701 S	56 ST
438	0016	000	1	7	1,419.83	1,419.83	707 S	56 ST
438	0017	000	1	7	1,419.83	1,419.83	713 S	56 ST
438	0018	000	1	7	1,385.20	1,385.20	719 S	56 ST
438	0019	000	1	7	1,038.90	1,038.90	723 S	56 ST
438	0020	000	1	8	1,038.90	1,038.90	801 S	56 ST
438	0021	000	1	8	1,385.20	1,385.20	807 S	56 ST
438	0022	000	1	8	1,385.20	1,385.20	811 S	56 ST
438	0030	000	1	1	1,395.59	1,395.59	700 S	56 ST
438	0031	000	1	1	1,142.79	1,142.79	706 S	56 ST
438	0032	000	1	1	1,142.79	1,142.79	710 S	56 ST
438	0033	000	1	1	1,142.79	1,142.79	714 S	56 ST
438	0034	000	1	1	1,142.79	1,142.79	718 S	56 ST
438	0035	000	1	1	1,142.79	1,142.79	722 S	56 ST
438	0036	000	1	1	1,558.35	1,558.35	800 S	56 ST
438	0037	000	1	2	1,558.35	1,558.35	806 S	56 ST
438	0056	000	1	11	1,038.90	1,038.90	1029-29A S	56 ST
438	0057	000	1	11	1,558.35	1,558.35	1023 S	56 ST
438	0058	000	1	11	1,558.35	1,558.35	1017 S	56 ST
438	0059	000	1	11	1,558.35	1,558.35	1011-13 S	56 ST
438	0060	000	1	11	1,558.35	1,558.35	1005 S	56 ST
438	0061	000	1	11	1,038.90	1,038.90	1003 S	56 ST
438	0062	000	1	4	1,558.35	1,558.35	1000 S	56 ST
438	0063	000	1	5	1,558.35	1,558.35	1006 S	56 ST
438	0064	000	1	5	1,558.35	1,558.35	1012 S	56 ST
438	0065	000	1	5	1,558.35	1,558.35	1020 S	56 ST
438	0066	000	1	5	1,038.90	1,038.90	1024 S	56 ST
438	0067	000	1	5	1,038.90	1,038.90	1028 S	56 ST
438	0068	000	1	2	1,038.90	1,038.90	900 S	56 ST
438	0069	000	1	2	1,558.35	1,558.35	904 S	56 ST
438	0070	000	1	3	1,558.35	1,558.35	910 S	56 ST
438	0071	000	1	3	1,385.20	1,385.20	916 S	56 ST
438	0072	000	1	3	1,385.20	1,385.20	922 S	56 ST
438	0073	000	1	3	1,385.20	1,385.20	928 S	56 ST

SPECIALS BY PROJECT INDEX

KEY	NET	GROSS	PAGE	ADDRESS
438 0074 000 1	2,077.80	2,077.80	3	932-34 S 56 ST
438 0075 000 1	1,558.35	1,558.35	3	942 S 56 ST
438 0076 000 1	1,558.35	1,790.75	3	946 S 56 ST
438 0077 000 1	1,558.35	1,558.35	4	952-54 S 56 ST
438 0078 000 1	1,038.90	1,038.90	4	960 S 56 ST
438 0079 000 1	1,212.05	1,212.05	4	962 S 56 ST
438 0080 000 1	1,385.20	1,385.20	4	968 S 56 ST
438 0081 000 1	1,038.90	1,038.90	4	972 S 56 ST
438 0082 000 1	1,038.90	1,038.90	4	976 S 56 ST
438 0097 000 1	1,038.90	1,038.90	10	977 S 56 ST
438 0098 000 1	1,558.35	1,558.35	10	971 S 56 ST
438 0099 000 1	1,558.35	1,558.35	10	967 S 56 ST
438 0100 000 1	1,558.35	1,558.35	10	959-61 S 56 ST
438 0101 000 1	1,558.35	1,558.35	10	953 S 56 ST
438 0102 000 1	1,558.35	1,558.35	10	949 S 56 ST
438 0103 000 1	1,558.35	1,558.35	10	943 S 56 ST
438 0104 000 1	1,558.35	1,558.35	9	935 S 56 ST
438 0105 000 1	1,558.35	1,558.35	9	929 S 56 ST
438 0106 000 1	1,558.35	1,558.35	9	923 S 56 ST
438 0107 000 1	1,558.35	1,558.35	9	919 S 56 ST
438 0108 000 1	1,558.35	1,558.35	9	911 S 56 ST
438 0109 000 1	1,212.05	1,212.05	9	907 S 56 ST
438 0110 000 1	1,385.20	1,385.20	9	903 S 56 ST
438 0182 000 1	1,385.20	1,385.20	8	833 S 56 ST
438 0183 000 1	1,385.20	1,385.20	8	827 S 56 ST
438 0184 000 1	1,385.20	1,385.20	8	821 S 56 ST
438 0185 001 1	1,385.20	1,385.20	8	817 S 56 ST
438 0186 000 1	2,077.80	2,077.80	2	816 S 56 ST
438 0187 000 1	1,558.35	1,558.35	2	822 S 56 ST
438 0188 000 1	1,558.35	1,558.35	2	826 S 56 ST
438 0189 000 1	1,038.90	1,038.90	2	832 S 56 ST
438 0198 000 1	4,380.52	4,717.74	7	5538 W NATIONAL AVE
438 0370 000 1	2,325.33	4,475.11	13	5600 W NATL & 1227-33 S
438 0371 000 1	1,558.35	1,558.35	13	1215 S 56 ST

KEY				PAGE	GROSS	NET	ADDRESS
438	0372	000	1	13	1,038.90	1,038.90	1211 S 56 ST
438	0373	000	1	13	1,558.35	1,558.35	1205-07 S 56 ST
438	0374	000	1	13	1,558.35	1,558.35	1139 S 56 ST
438	0375	000	1	12	1,558.35	1,558.35	1133 S 56 ST
438	0376	000	1	12	1,038.90	1,038.90	1129 S 56 ST
438	0377	000	1	12	1,038.90	1,038.90	1125 S 56 ST
438	0378	000	1	12	1,038.90	1,038.90	1121-23 S 56 ST
438	0379	000	1	12	1,385.20	1,385.20	1115 S 56 ST
438	0380	000	1	12	1,385.20	1,385.20	1111-13 S 56 ST
438	0381	000	1	12	1,385.20	1,385.20	1105 S 56 ST
438	0382	000	1	11	1,038.90	1,038.90	1101 S 56 ST
438	0383	000	1	5	1,038.90	1,038.90	1102 S 56 ST
438	0384	000	1	5	1,558.35	1,558.35	1106 S 56 ST
438	0385	000	1	6	1,385.20	1,385.20	1110 S 56 ST
438	0386	000	1	6	1,212.05	1,212.05	1116-18 S 56 ST
438	0387	000	1	6	1,558.35	1,558.35	1120-22 S 56 ST
438	0388	000	1	6	1,558.35	1,558.35	1126-28 S 56 ST
438	0389	000	1	6	1,558.35	1,558.35	1132-34 S 56 ST
438	0390	000	1	6	1,558.35	1,558.35	1138 S 56 ST
438	0391	000	1	6	2,077.80	2,077.80	1204 S 56 ST
438	0392	000	1	7	1,350.22	1,350.22	1212-14 S 56 ST

KEY 438-0030-000 1 ADDRESS 700 S 56 ST OWNER BROWN AUDREY CLASS 4 FRONT FOOT 45.10  
 DESCRIPTION (CONC/ASPH)/MISC WALK - RES 40.30 34.63 FOOTAGE RATE GROSS PERCENT NET  
 RECONSTRUCTION (CONC/ASPH)/MISC WALK - RES 1,395.59 100.00 1,395.59

-----  
 438-0031-000 1 706 S 56 ST SOLIS PABLO 4 33.00 33.00 20

DESCRIPTION FOOTAGE RATE GROSS PERCENT NET  
 RECONSTRUCTION (CONC/ASPH)/MISC WALK - RES 33.00 34.63 1,142.79 100.00 1,142.79

-----  
 438-0032-000 1 710 S 56 ST VERHAALLEN ROBERT J 4 33.00 33.00 30

DESCRIPTION FOOTAGE RATE GROSS PERCENT NET  
 RECONSTRUCTION (CONC/ASPH)/MISC WALK - RES 33.00 34.63 1,142.79 100.00 1,142.79

-----  
 438-0033-000 1 714 S 56 ST MICHALOWSKI BETTY J 4 33.00 33.00 40

DESCRIPTION FOOTAGE RATE GROSS PERCENT NET  
 RECONSTRUCTION (CONC/ASPH)/MISC WALK - RES 33.00 34.63 1,142.79 100.00 1,142.79

-----  
 438-0034-000 1 718 S 56 ST VOGEL BETTY L 4 33.00 33.00 50

DESCRIPTION FOOTAGE RATE GROSS PERCENT NET  
 RECONSTRUCTION (CONC/ASPH)/MISC WALK - RES 33.00 34.63 1,142.79 100.00 1,142.79

-----  
 438-0035-000 1 722 S 56 ST GENNRICH CATHERINE A 4 33.00 33.00 60

DESCRIPTION FOOTAGE RATE GROSS PERCENT NET  
 RECONSTRUCTION (CONC/ASPH)/MISC WALK - RES 33.00 34.63 1,142.79 100.00 1,142.79

-----  
 438-0036-000 1 800 S 56 ST MURRAY DOUGLAS & MARISA 4 45.00 45.00 70

DESCRIPTION FOOTAGE RATE GROSS PERCENT NET  
 RECONSTRUCTION (CONC/ASPH)/MISC WALK - RES 45.00 34.63 1,558.35 100.00 1,558.35

RUN # SPL015 ON 03/10/05 SPECIALS BY PROJECT DETAIL: 1052852 COUNCIL

KEY 438-0037-000 1 ADDRESS 806 S 56 ST OWNER BURGESS ROBERT L CLASS 4 FRONT FOOT 80  
 DESCRIPTION RECONSTRUCTION (CONC/ASPH)/MISC WALK - RES 45.00 34.63 FOOTAGE RATE 1,558.35 100.00 PERCENT NET 45.00  
 RECONSTRUCTION (CONC/ASPH)/MISC WALK - RES 45.00 34.63 FOOTAGE RATE 1,558.35 100.00 PERCENT NET 1,558.35

438-0186-000 1 816 S 56 ST CLEMENTI JOSEPH R 4 60.00 90

DESCRIPTION RECONSTRUCTION (CONC/ASPH)/MISC WALK - RES 60.00 4.31 FOOTAGE RATE 2,077.80 100.00 PERCENT NET 2,077.80  
 7" CONCRETE DRIVEWAY APPROACH PER SQ FT 0.00 0.00 PERCENT NET 0.00  
 RECONSTRUCTION (CONC/ASPH)/MISC WALK - RES 60.00 34.63 FOOTAGE RATE 2,077.80 100.00 PERCENT NET 2,077.80  
 0-15 YEARS (FREE)

438-0187-000 1 822 S 56 ST BARRIBEAU TIMOTHY G 4 45.00 100

DESCRIPTION RECONSTRUCTION (CONC/ASPH)/MISC WALK - RES 45.00 34.63 FOOTAGE RATE 1,558.35 100.00 PERCENT NET 1,558.35

438-0188-000 1 826 S 56 ST PICCHIOTTINO MICHAEL & J 4 45.00 110

DESCRIPTION RECONSTRUCTION (CONC/ASPH)/MISC WALK - RES 45.00 34.63 FOOTAGE RATE 1,558.35 100.00 PERCENT NET 1,558.35

438-0189-000 1 832 S 56 ST SMITH JAMES E & MARY A 4 30.00 120

DESCRIPTION RECONSTRUCTION (CONC/ASPH)/MISC WALK - RES 30.00 34.63 FOOTAGE RATE 1,038.90 100.00 PERCENT NET 1,038.90

438-0068-000 1 900 S 56 ST GIBBS KENNETH L 4 30.00 130

DESCRIPTION RECONSTRUCTION (CONC/ASPH)/MISC WALK - RES 30.00 34.63 FOOTAGE RATE 1,038.90 100.00 PERCENT NET 1,038.90

438-0069-000 1 904 S 56 ST GONNERING D T LIFE EST 4 45.00 140

DESCRIPTION RECONSTRUCTION (CONC/ASPH)/MISC WALK - RES 45.00 34.63 FOOTAGE RATE 1,558.35 100.00 PERCENT NET 1,558.35

KEY	ADDRESS	OWNER	CLASS	FRONT FOOT			
438-0070-000 1	910 S 56 ST	FLANCHER KATHRYN J	4	45.00	150		
DESCRIPTION	FOOTAGE	RATE	GROSS	PERCENT	NET		
7" CONCRETE DRIVEWAY APPROACH PER SQ FT	0.00	4.31	0.00	100.00	0.00		
RECONSTRUCTION (CONC/ASPH)/MISC WALK - RES	45.00	34.63	1,558.35	100.00	1,558.35		

---

KEY	ADDRESS	OWNER	CLASS	FRONT FOOT			
438-0071-000 1	916 S 56 ST	MUEHL RICHARD R	4	40.00	160		
DESCRIPTION	FOOTAGE	RATE	GROSS	PERCENT	NET		
7" CONCRETE DRIVEWAY APPROACH PER SQ FT	0.00	4.31	0.00	100.00	0.00		
RECONSTRUCTION (CONC/ASPH)/MISC WALK - RES	40.00	34.63	1,385.20	100.00	1,385.20		

---

KEY	ADDRESS	OWNER	CLASS	FRONT FOOT			
438-0072-000 1	922 S 56 ST	BIEDENBENDER SHAWN & N	4	40.00	170		
DESCRIPTION	FOOTAGE	RATE	GROSS	PERCENT	NET		
7" CONCRETE DRIVEWAY APPROACH PER SQ FT	0.00	4.31	0.00	100.00	0.00		
RECONSTRUCTION (CONC/ASPH)/MISC WALK - RES	40.00	34.63	1,385.20	100.00	1,385.20		

---

KEY	ADDRESS	OWNER	CLASS	FRONT FOOT			
438-0073-000 1	928 S 56 ST	CRUZ LEANNE B	4	40.00	180		
DESCRIPTION	FOOTAGE	RATE	GROSS	PERCENT	NET		
7" CONCRETE DRIVEWAY APPROACH PER SQ FT	0.00	4.31	0.00	100.00	0.00		
RECONSTRUCTION (CONC/ASPH)/MISC WALK - RES	40.00	34.63	1,385.20	100.00	1,385.20		

---

KEY	ADDRESS	OWNER	CLASS	FRONT FOOT	REMARKS	
438-0074-000 1	932-34 S 56 ST	TORPY CONSTANCE M	4	60.00	S70 W19233 WENTLAND DR	190
DESCRIPTION	FOOTAGE	RATE	GROSS	PERCENT	NET	
7" CONCRETE DRIVEWAY APPROACH PER SQ FT	0.00	4.31	0.00	100.00	0.00	
RECONSTRUCTION (CONC/ASPH)/MISC WALK - RES	60.00	34.63	2,077.80	100.00	2,077.80	

---

KEY	ADDRESS	OWNER	CLASS	FRONT FOOT	REMARKS	
438-0075-000 1	942 S 56 ST	ZIELINSKI STEVE S	4	45.00	N37W26853 KOPMEIER DR	200
DESCRIPTION	FOOTAGE	RATE	GROSS	PERCENT	NET	
7" CONCRETE DRIVEWAY APPROACH PER SQ FT	0.00	4.31	0.00	100.00	0.00	
RECONSTRUCTION (CONC/ASPH)/MISC WALK - RES	45.00	34.63	1,558.35	100.00	1,558.35	

---

KEY	ADDRESS	OWNER	CLASS	FRONT FOOT	REMARKS	
438-0076-000 1	946 S 56 ST	HENGEL NORBERT W	4	45.00		210
DESCRIPTION	FOOTAGE	RATE	GROSS	PERCENT	NET	
7" CONCRETE DRIVEWAY APPROACH PER SQ FT	53.92	4.31	232.40	0.00	0.00	
RECONSTRUCTION (CONC/ASPH)/MISC WALK - RES	45.00	34.63	1,558.35	100.00	1,558.35	
			1,790.75		0-15 YEARS (FREE)	

---

KEY ADDRESS 438-0077-000 1 952-54 S 56 ST OWNER HEATHER HOWARD CLASS 4 FRONT FOOT 954 S 56 ST 45.00  
 DESCRIPTION RECONSTRUCTION (CONC/ASPH)/MISC WALK - RES 45.00 34.63 FOOTAGE RATE GROSS PERCENT NET  
 1,558.35 100.00 1,558.35  
 1,558.35

438-0078-000 1 960 S 56 ST HARDIN DIANNA P 4 30.00  
 DESCRIPTION RECONSTRUCTION (CONC/ASPH)/MISC WALK - RES 30.00 34.63 FOOTAGE RATE GROSS PERCENT NET  
 1,038.90 100.00 1,038.90  
 1,038.90

438-0079-000 1 962 S 56 ST MCGRADY KATHLEEN M 4 35.00  
 DESCRIPTION RECONSTRUCTION (CONC/ASPH)/MISC WALK - RES 35.00 34.63 FOOTAGE RATE GROSS PERCENT NET  
 1,212.05 100.00 1,212.05  
 1,212.05

438-0080-000 1 968 S 56 ST FOOTE JERALD E 4 40.00 762 COLUMBIA AVE  
 DESCRIPTION RECONSTRUCTION (CONC/ASPH)/MISC WALK - RES 40.00 34.63 FOOTAGE RATE GROSS PERCENT NET  
 1,385.20 100.00 1,385.20  
 1,385.20

438-0081-000 1 972 S 56 ST O DEAN LEILA 4 30.00  
 DESCRIPTION RECONSTRUCTION (CONC/ASPH)/MISC WALK - RES 30.00 34.63 FOOTAGE RATE GROSS PERCENT NET  
 1,038.90 100.00 1,038.90  
 1,038.90

438-0082-000 1 976 S 56 ST NEHRBASS DAWN C 4 30.00 2909 N LOCUST RD  
 DESCRIPTION RECONSTRUCTION (CONC/ASPH)/MISC WALK - RES 30.00 34.63 FOOTAGE RATE GROSS PERCENT NET  
 1,038.90 100.00 1,038.90  
 1,038.90

438-0062-000 1 1000 S 56 ST PITT KENNETH 4 45.00  
 DESCRIPTION RECONSTRUCTION (CONC/ASPH)/MISC WALK - RES 45.00 34.63 FOOTAGE RATE GROSS PERCENT NET  
 1,558.35 100.00 1,558.35  
 1,558.35

KEY 438-0063-000 1 ADDRESS 1006 S 56 ST OWNER SNYDER ROBIN P CLASS 4 FRONT FOOT 45.00

DESCRIPTION RECONSTRUCTION (CONC/ASPH)/MISC WALK - RES FOOTAGE 45.00 RATE 34.63 GROSS 1,558.35 PERCENT 100.00 NET 1,558.35

438-0064-000 1 1012 S 56 ST SMITH JR CHARLIE & JANICE 4 45.00 300

DESCRIPTION RECONSTRUCTION (CONC/ASPH)/MISC WALK - RES FOOTAGE 45.00 RATE 34.63 GROSS 1,558.35 PERCENT 100.00 NET 1,558.35

7" CONCRETE DRIVEWAY APPROACH PER 50 FT RECONSTRUCTION (CONC/ASPH)/MISC WALK - RES FOOTAGE 0.00 RATE 4.31 GROSS 0.00 PERCENT 100.00 NET 0.00

438-0065-000 1 1020 S 56 ST VAN ZILE RALPH 4 45.00 1242 S 123 ST 310

DESCRIPTION RECONSTRUCTION (CONC/ASPH)/MISC WALK - RES FOOTAGE 45.00 RATE 34.63 GROSS 1,558.35 PERCENT 100.00 NET 1,558.35

438-0066-000 1 1024 S 56 ST WIECZOREK CHESTER TRUST 4 30.00 1028 S 56 ST 320

DESCRIPTION RECONSTRUCTION (CONC/ASPH)/MISC WALK - RES FOOTAGE 30.00 RATE 34.63 GROSS 1,038.90 PERCENT 100.00 NET 1,038.90

438-0067-000 1 1028 S 56 ST WIECZOREK CHESTER TRUST 4 30.00 330

DESCRIPTION RECONSTRUCTION (CONC/ASPH)/MISC WALK - RES FOOTAGE 30.00 RATE 34.63 GROSS 1,038.90 PERCENT 100.00 NET 1,038.90

438-0383-000 1 1102 S 56 ST GALIOTO SALVATORE 4 30.00 340

DESCRIPTION RECONSTRUCTION (CONC/ASPH)/MISC WALK - RES FOOTAGE 30.00 RATE 34.63 GROSS 1,038.90 PERCENT 100.00 NET 1,038.90

438-0384-000 1 1106 S 56 ST COMBS F & HOFFMAN T 4 45.00 350

DESCRIPTION RECONSTRUCTION (CONC/ASPH)/MISC WALK - RES FOOTAGE 45.00 RATE 34.63 GROSS 1,558.35 PERCENT 100.00 NET 1,558.35



KEY	ADDRESS	OWNER	CLASS	FRONT FOOT	
438-0385-000 1	1110 S 56 ST	PULTZ CAROL S	4	40.00	360
DESCRIPTION	FOOTAGE	RATE	GROSS	PERCENT	NET
7" CONCRETE DRIVEWAY APPROACH PER SQ FT	0.00	4.31	0.00	100.00	0.00
RECONSTRUCTION (CONC/ASPH)/MISC WALK - RES	40.00	34.63	1,385.20	100.00	1,385.20

---

KEY	ADDRESS	OWNER	CLASS	FRONT FOOT	
438-0386-000 1	1116-18 S 56 ST	PERLICK TERRANCE A	4	35.00	1118 S 56 ST 370
DESCRIPTION	FOOTAGE	RATE	GROSS	PERCENT	NET
RECONSTRUCTION (CONC/ASPH)/MISC WALK - RES	35.00	34.63	1,212.05	100.00	1,212.05

---

KEY	ADDRESS	OWNER	CLASS	FRONT FOOT	
438-0387-000 1	1120-22 S 56 ST	MOELLER KURT T	4	45.00	1122 S 56 ST 380
DESCRIPTION	FOOTAGE	RATE	GROSS	PERCENT	NET
RECONSTRUCTION (CONC/ASPH)/MISC WALK - RES	45.00	34.63	1,558.35	100.00	1,558.35

---

KEY	ADDRESS	OWNER	CLASS	FRONT FOOT	
438-0388-000 1	1126-28 S 56 ST	KLARNER KERRIE L	4	45.00	1128 S 56 ST 390
DESCRIPTION	FOOTAGE	RATE	GROSS	PERCENT	NET
7" CONCRETE DRIVEWAY APPROACH PER SQ FT	0.00	4.31	0.00	100.00	0.00
RECONSTRUCTION (CONC/ASPH)/MISC WALK - RES	45.00	34.63	1,558.35	100.00	1,558.35

---

KEY	ADDRESS	OWNER	CLASS	FRONT FOOT	
438-0389-000 1	1132-34 S 56 ST	NEMEC A S	4	45.00	1132 S 56 ST 400
DESCRIPTION	FOOTAGE	RATE	GROSS	PERCENT	NET
7" CONCRETE DRIVEWAY APPROACH PER SQ FT	0.00	4.31	0.00	100.00	0.00
RECONSTRUCTION (CONC/ASPH)/MISC WALK - RES	45.00	34.63	1,558.35	100.00	1,558.35

---

KEY	ADDRESS	OWNER	CLASS	FRONT FOOT	
438-0390-000 1	1138 S 56 ST	NOVAK MICHELLE M	4	45.00	410
DESCRIPTION	FOOTAGE	RATE	GROSS	PERCENT	NET
7" CONCRETE DRIVEWAY APPROACH PER SQ FT	0.00	4.31	0.00	100.00	0.00
RECONSTRUCTION (CONC/ASPH)/MISC WALK - RES	45.00	34.63	1,558.35	100.00	1,558.35

---

KEY	ADDRESS	OWNER	CLASS	FRONT FOOT	
438-0391-000 1	1204 S 56 ST	O'NEAL BRET & HEATHER	4	60.00	420
DESCRIPTION	FOOTAGE	RATE	GROSS	PERCENT	NET
7" CONCRETE DRIVEWAY APPROACH PER SQ FT	0.00	4.31	0.00	100.00	0.00
RECONSTRUCTION (CONC/ASPH)/MISC WALK - RES	60.00	34.63	2,077.80	100.00	2,077.80

---

KEY	ADDRESS	OWNER	CLASS	FRONT FOOT			
438-0392-000 1	1212-14 S 56 ST	NICKEL WILLIAM & JUDITH	4	39.00	3101 S RENO DRIVE		
	DESCRIPTION		FOOTAGE	RATE	GROSS	PERCENT	NET
	RECONSTRUCTION (CONC/ASPH)/MISC WALK - RES		38.99	34.63	1,350.22	100.00	1,350.22

---

KEY	ADDRESS	OWNER	CLASS	FRONT FOOT			
438-0198-000 1	5538 W NATIONAL AVE	HINKFUSS RODNEY A	3	0.00	5227 W NATIONAL AVE		
	DESCRIPTION		FOOTAGE	RATE	GROSS	PERCENT	NET
	7" CONCRETE DRIVEWAY APPROACH PER SQ FT		0.00	4.31	0.00	100.00	0.00
	7" CONCRETE DRIVEWAY APPROACH PER SQ FT		0.00	4.31	0.00	100.00	0.00
	RECONSTRUCTION (CONC/ASPH)/MISC WALK - COM		108.98	43.29	4,717.74	92.85	4,380.52
					4,717.74		4,380.52

RECTANGULARIZED CONSTRUCTION EXT

---

KEY	ADDRESS	OWNER	CLASS	FRONT FOOT			
438-0015-000 1	701 S 56 ST	KETCHMAN RUTH A	4	41.00			
	DESCRIPTION		FOOTAGE	RATE	GROSS	PERCENT	NET
	7" CONCRETE DRIVEWAY APPROACH PER SQ FT		0.00	4.31	0.00	100.00	0.00
	RECONSTRUCTION (CONC/ASPH)/MISC WALK - RES		45.92	34.63	1,590.21	91.29	1,451.69
					1,590.21		1,451.69

RECTANGULARIZED

---

KEY	ADDRESS	OWNER	CLASS	FRONT FOOT			
438-0016-000 1	707 S 56 ST	BAUER HELEN M	4	41.00			
	DESCRIPTION		FOOTAGE	RATE	GROSS	PERCENT	NET
	7" CONCRETE DRIVEWAY APPROACH PER SQ FT		0.00	4.31	0.00	100.00	0.00
	RECONSTRUCTION (CONC/ASPH)/MISC WALK - RES		41.00	34.63	1,419.83	100.00	1,419.83
					1,419.83		1,419.83

---

KEY	ADDRESS	OWNER	CLASS	FRONT FOOT			
438-0017-000 1	713 S 56 ST	NIEMANN JOHN T	4	41.00	N85 W15650 RIDGE RD #105		
	DESCRIPTION		FOOTAGE	RATE	GROSS	PERCENT	NET
	7" CONCRETE DRIVEWAY APPROACH PER SQ FT		0.00	4.31	0.00	100.00	0.00
	RECONSTRUCTION (CONC/ASPH)/MISC WALK - RES		41.00	34.63	1,419.83	100.00	1,419.83
					1,419.83		1,419.83

---

KEY	ADDRESS	OWNER	CLASS	FRONT FOOT			
438-0018-000 1	719 S 56 ST	SMITH APRYL	4	40.00			
	DESCRIPTION		FOOTAGE	RATE	GROSS	PERCENT	NET
	RECONSTRUCTION (CONC/ASPH)/MISC WALK - RES		40.00	34.63	1,385.20	100.00	1,385.20
					1,385.20		1,385.20

---

KEY	ADDRESS	OWNER	CLASS	FRONT FOOT			
438-0019-000 1	723 S 56 ST	KRUK THOMAS G	4	30.00			
	DESCRIPTION		FOOTAGE	RATE	GROSS	PERCENT	NET
	RECONSTRUCTION (CONC/ASPH)/MISC WALK - RES		30.00	34.63	1,038.90	100.00	1,038.90
					1,038.90		1,038.90

---

KEY 438-0020-000 1 ADDRESS 801 S 56 ST OWNER PARNAU TIMOTHY & HEATHER 4 CLASS FRONT FOOT 500

DESCRIPTION RECONSTRUCTION (CONC/ASPH)/MISC WALK - RES 30.00 34.63 1,038.90 100.00 1,038.90

438-0021-000 1 807 S 56 ST KENDALL THOMAS D 4 40.00 510

DESCRIPTION RECONSTRUCTION (CONC/ASPH)/MISC WALK - RES 40.00 34.63 1,385.20 100.00 1,385.20

438-0022-000 1 811 S 56 ST BROWN BRADLEY W & VICKI 4 40.00 520

DESCRIPTION RECONSTRUCTION (CONC/ASPH)/MISC WALK - RES 40.00 34.63 1,385.20 100.00 1,385.20

438-0185-001 1 817 S 56 ST LOPINA J & NARLOW L 4 40.00 530

DESCRIPTION RECONSTRUCTION (CONC/ASPH)/MISC WALK - RES 40.00 34.63 1,385.20 100.00 1,385.20

438-0184-000 1 821 S 56 ST FISCHER MARTIN & DOROTHY 4 40.00 540

DESCRIPTION RECONSTRUCTION (CONC/ASPH)/MISC WALK - RES 40.00 34.63 1,385.20 100.00 1,385.20

438-0183-000 1 827 S 56 ST GATTO JR PETER A & TERESA 4 40.00 550

DESCRIPTION RECONSTRUCTION (CONC/ASPH)/MISC WALK - RES 40.00 34.63 1,385.20 100.00 1,385.20

438-0182-000 1 833 S 56 ST WOJSZKO AMY L 4 40.00 560

DESCRIPTION RECONSTRUCTION (CONC/ASPH)/MISC WALK - RES 40.00 34.63 1,385.20 100.00 1,385.20

DESCRIPTION (CONC/ASPH)/MISC WALK - RES 40.00 34.63 1,385.20 100.00 1,385.20

DESCRIPTION (CONC/ASPH)/MISC WALK - RES 35.00 34.63 1,212.05 100.00 1,212.05

DESCRIPTION (CONC/ASPH)/MISC WALK - RES 45.00 34.63 1,558.35 100.00 1,558.35

DESCRIPTION (CONC/ASPH)/MISC WALK - RES 45.00 34.63 1,558.35 100.00 1,558.35

DESCRIPTION (CONC/ASPH)/MISC WALK - RES 45.00 34.63 1,558.35 100.00 1,558.35

DESCRIPTION (CONC/ASPH)/MISC WALK - RES 45.00 34.63 1,558.35 100.00 1,558.35

DESCRIPTION (CONC/ASPH)/MISC WALK - RES 45.00 34.63 1,558.35 100.00 1,558.35

DESCRIPTION (CONC/ASPH)/MISC WALK - RES 45.00 34.63 1,558.35 100.00 1,558.35  
 RECONSTRUCTION (CONC/ASPH)/MISC WALK - RES 45.00 34.63 1,558.35 100.00 1,558.35

DESCRIPTION FOOTAGE RATE GROSS PERCENT NET  
 RECONSTRUCTION (CONC/ASPH)/MISC WALK - RES 45.00 34.63 1,558.35 100.00 1,558.35

DESCRIPTION FOOTAGE RATE GROSS PERCENT NET  
 RECONSTRUCTION (CONC/ASPH)/MISC WALK - RES 45.00 34.63 1,558.35 100.00 1,558.35

DESCRIPTION FOOTAGE RATE GROSS PERCENT NET  
 RECONSTRUCTION (CONC/ASPH)/MISC WALK - RES 45.00 34.63 1,558.35 100.00 1,558.35

DESCRIPTION FOOTAGE RATE GROSS PERCENT NET  
 RECONSTRUCTION (CONC/ASPH)/MISC WALK - RES 45.00 34.63 1,558.35 100.00 1,558.35

DESCRIPTION FOOTAGE RATE GROSS PERCENT NET  
 RECONSTRUCTION (CONC/ASPH)/MISC WALK - RES 45.00 34.63 1,558.35 100.00 1,558.35

DESCRIPTION FOOTAGE RATE GROSS PERCENT NET  
 RECONSTRUCTION (CONC/ASPH)/MISC WALK - RES 30.00 34.63 1,038.90 100.00 1,038.90

OWNER CLASS  
SAUCEDA BONNIE M & DAVID 4

KEY ADDRESS 56 ST  
438-0061-000 1 1003 S

DESCRIPTION	FOOTAGE	RATE	GROSS	PERCENT	NET
RECONSTRUCTION (CONC/ASPH)/MISC WALK - RES	30.00	34.63	1,038.90	100.00	1,038.90
RECONSTRUCTION (CONC/ASPH)/MISC WALK - RES	30.00	34.63	1,038.90	100.00	1,038.90

ALDEN GREGORY S 4

DESCRIPTION	FOOTAGE	RATE	GROSS	PERCENT	NET
RECONSTRUCTION (CONC/ASPH)/MISC WALK - RES	45.00	34.63	1,558.35	100.00	1,558.35
RECONSTRUCTION (CONC/ASPH)/MISC WALK - RES	45.00	34.63	1,558.35	100.00	1,558.35

NELSON T & SWANSON K 4

DESCRIPTION	FOOTAGE	RATE	GROSS	PERCENT	NET
RECONSTRUCTION (CONC/ASPH)/MISC WALK - RES	45.00	34.63	1,558.35	100.00	1,558.35
RECONSTRUCTION (CONC/ASPH)/MISC WALK - RES	45.00	34.63	1,558.35	100.00	1,558.35

REILLY STEVEN R 4

DESCRIPTION	FOOTAGE	RATE	GROSS	PERCENT	NET
RECONSTRUCTION (CONC/ASPH)/MISC WALK - RES	45.00	34.63	1,558.35	100.00	1,558.35
RECONSTRUCTION (CONC/ASPH)/MISC WALK - RES	45.00	34.63	1,558.35	100.00	1,558.35

CECIL TIMOTHY & SAMANTHA 4

DESCRIPTION	FOOTAGE	RATE	GROSS	PERCENT	NET
RECONSTRUCTION (CONC/ASPH)/MISC WALK - RES	45.00	34.63	1,558.35	100.00	1,558.35
RECONSTRUCTION (CONC/ASPH)/MISC WALK - RES	45.00	34.63	1,558.35	100.00	1,558.35

WARZALA MITCHELL & ROBYN 4

DESCRIPTION	FOOTAGE	RATE	GROSS	PERCENT	NET
RECONSTRUCTION (CONC/ASPH)/MISC WALK - RES	30.00	34.63	1,038.90	100.00	1,038.90
RECONSTRUCTION (CONC/ASPH)/MISC WALK - RES	30.00	34.63	1,038.90	100.00	1,038.90

LYMAN KATRINA & PATRICK 4

DESCRIPTION	FOOTAGE	RATE	GROSS	PERCENT	NET
RECONSTRUCTION (CONC/ASPH)/MISC WALK - RES	30.00	34.63	1,038.90	100.00	1,038.90
RECONSTRUCTION (CONC/ASPH)/MISC WALK - RES	30.00	34.63	1,038.90	100.00	1,038.90

DESCRIPTION	FOOTAGE	RATE	GROSS	PERCENT	NET
RECONSTRUCTION (CONC/ASPH)/MISC WALK - RES	40.00	34.63	1,385.20	100.00	1,385.20
			1,385.20		1,385.20

-----  
 438-0380-000 1 1111-13 S 56 ST JAGODZINSKI DAVID & LISA 4 40.00 1111 S 56 ST 790

DESCRIPTION	FOOTAGE	RATE	GROSS	PERCENT	NET
RECONSTRUCTION (CONC/ASPH)/MISC WALK - RES	40.00	34.63	1,385.20	100.00	1,385.20
			1,385.20		1,385.20

-----  
 438-0379-000 1 1115 S 56 ST MASCH WILLIAM M & KAREN 4 40.00 800

DESCRIPTION	FOOTAGE	RATE	GROSS	PERCENT	NET
RECONSTRUCTION (CONC/ASPH)/MISC WALK - RES	40.00	34.63	1,385.20	100.00	1,385.20
			1,385.20		1,385.20

-----  
 438-0378-000 1 1121-23 S 56 ST SHEBESTA PHYLLIS E 4 30.00 810

DESCRIPTION	FOOTAGE	RATE	GROSS	PERCENT	NET
RECONSTRUCTION (CONC/ASPH)/MISC WALK - RES	30.00	34.63	1,038.90	100.00	1,038.90
			1,038.90		1,038.90

-----  
 438-0377-000 1 1125 S 56 ST DOUGHERTY LARRY E 4 30.00 820

DESCRIPTION	FOOTAGE	RATE	GROSS	PERCENT	NET
RECONSTRUCTION (CONC/ASPH)/MISC WALK - RES	30.00	34.63	1,038.90	100.00	1,038.90
			1,038.90		1,038.90

-----  
 438-0376-000 1 1129 S 56 ST NAZERIS CHRISTINE 4 30.00 830

DESCRIPTION	FOOTAGE	RATE	GROSS	PERCENT	NET
RECONSTRUCTION (CONC/ASPH)/MISC WALK - RES	30.00	34.63	1,038.90	100.00	1,038.90
			1,038.90		1,038.90

-----  
 438-0375-000 1 1133 S 56 ST CORAGGIO ROCKY J & VICKI 4 45.00 840

DESCRIPTION	FOOTAGE	RATE	GROSS	PERCENT	NET
RECONSTRUCTION (CONC/ASPH)/MISC WALK - RES	45.00	34.63	1,558.35	100.00	1,558.35
			1,558.35		1,558.35

DESCRIPTION

FOOTAGE RATE

GROSS PERCENT

NET

7" CONCRETE DRIVEWAY APPROACH PER SQ FT  
 RECONSTRUCTION (CONC/ASPH)/MISC WALK - RES 0.00 4.31 0.00 100.00 0.00  
 45.00 34.63 1,558.35 100.00 1,558.35

438-0373-000 1 1205-07 S 56 ST PRUSAK STEPHEN J TRUSTEE 4 45.00 1207 SOUTH 56TH ST 860

DESCRIPTION

FOOTAGE RATE

GROSS PERCENT

NET

7" CONCRETE DRIVEWAY APPROACH PER SQ FT  
 RECONSTRUCTION (CONC/ASPH)/MISC WALK - RES 0.00 4.31 0.00 100.00 0.00  
 45.00 34.63 1,558.35 100.00 1,558.35

438-0372-000 1 1211 S 56 ST LUSTIG JULIE A 4 30.00 870

DESCRIPTION

FOOTAGE RATE

GROSS PERCENT

NET

RECONSTRUCTION (CONC/ASPH)/MISC WALK - RES 30.00 34.63 1,038.90 100.00 1,038.90

438-0371-000 1 1215 S 56 ST LUCCHESI MARK & PEARL 4 45.00 880

DESCRIPTION

FOOTAGE RATE

GROSS PERCENT

NET

RECONSTRUCTION (CONC/ASPH)/MISC WALK - RES 45.00 34.63 1,558.35 100.00 1,558.35

438-0370-000 1 5600 W NATL & 1227-33 S AGNOS DINO 3 0.00 N89W25259 HIGHLAND PRESE 890

DESCRIPTION

FOOTAGE RATE

GROSS PERCENT

NET

7" CONCRETE DRIVEWAY APPROACH PER SQ FT  
 RECONSTRUCTION (CONC/ASPH)/MISC WALK - COM 0.00 4.31 0.00 100.00 0.00  
 STORM SEWER LATERAL - COM 82.77 43.29 3,583.11 40.00 1,433.33  
 0.00 892.00 4,475.11 100.00 2,325.33  
 LONGSIDE CONSTRUCTION EXT

178 130,706.78 127,848.86 3,747.88 \*\*\*\*\*TOTALS FOR PROJECT \*\*\*\*\*



RUN # SPL015C ON 03/10/05

SPECIALS BY CODE TOTALS 1052852

PAGE 14

CODE	NUMBER	GROSS	NET	FOOTAGE	CODE DESCRIPTION
	22	232.40	0.00	53.92	7" CONCRETE DRIVEWAY APPROACH PER SQ FT
	87	121,281.53	121,143.01	3,502.21	RECONSTRUCTION (CONC/ASPH)/MISC WALK - RES
	2	8,300.85	5,813.85	191.75	RECONSTRUCTION (CONC/ASPH)/MISC WALK - COM
	1	892.00	892.00	0.00	STORM SEWER LATERAL - COM