

15.



# City of West Allis Matter Summary

7525 W. Greenfield Ave.  
West Allis, WI 53214

File Number	Title	Status
-------------	-------	--------

R-2007-0225      Resolution      In Committee

Resolution to approve an Agreement by and between the City of West Allis and the Union Pacific Railroad Company for widening of the track crossing in the 6700 block of West National Avenue.

Introduced: 9/18/2007

Controlling Body: Public Works Committee

Sponsor(s): Public Works Committee

COMMITTEE RECOMMENDATION ADOPT

ACTION DATE:	MOVER	SECONDER		AYE	NO	PRESENT	EXCUSED
			Barczak				
			Czaplewski				
		✓	Dobrowski	✓			
SEP 18 2007			Kopplin	✓			
			Lajsic				
			Narlock	✓			
	✓		Reinke				
			Sengstock	✓			
			Vitale	✓			
			Weigel				
			TOTAL	<u>5</u>			

SIGNATURE OF COMMITTEE MEMBER

*Paul Hall*      \_\_\_\_\_  
 Chair      Vice-Chair      Member

COMMON COUNCIL ACTION ADOPT

ACTION DATE:	MOVER	SECONDER		AYE	NO	PRESENT	EXCUSED
			Barczak	✓			
			Czaplewski	✓			
SEP 18 2007			Dobrowski	✓			
			Kopplin	✓			
			Lajsic	✓			
	✓		Narlock	✓			
			Reinke	✓			
			Sengstock	✓			
		✓	Vitale	✓			
			Weigel	✓			
			TOTAL	<u>10</u>			

Mike Lewis  
Public Works

**STANDING COMMITTEES OF THE  
CITY OF WEST ALLIS COMMON COUNCIL  
2004**

**ADMINISTRATION & FINANCE**

Chair: Michael J. Czaplewski  
Vice-Chair: Martin J. Weigel  
Gary T. Barczak  
Thomas G. Lajsic  
Rosalie L. Reinke

**PUBLIC WORKS**

Chair: Richard F. Narlock  
Vice-Chair: Linda A. Dobrowski  
Kurt E. Kopplin  
Vincent Vitale  
James W. Sengstock

**SAFETY & DEVELOPMENT**

Chair: Thomas G. Lajsic  
Vice-Chair: Vincent Vitale  
Gary T. Barczak  
Martin J. Weigel  
Rosalie L. Reinke

**LICENSE & HEALTH**

Chair: Kurt E. Kopplin  
Vice-Chair: James W. Sengstock  
Linda A. Dobrowski  
Richard F. Narlock  
Michael J. Czaplewski

**ADVISORY**

Chair: Rosalie L. Reinke  
Vice-Chair: Gary T. Barczak  
Linda A. Dobrowski  
Vincent Vitale  
Martin J. Weigel



# City of West Allis

7525 W. Greenfield Ave.  
West Allis, WI 53214

## Resolution

**File Number: R-2007-0225**

**Final Action:**

**Sponsor(s):** Public Works Committee

**SEP 18 2007**

Resolution to approve an Agreement by and between the City of West Allis and the Union Pacific Railroad Company for widening of the track crossing in the 6700 block of West National Avenue.

WHEREAS, the City of West Allis ("City") has requested the Union Pacific Railroad Company ("Railroad") to construct a new crossing, at grade, along, over and across the railroad tracks and right-of-way in the 6700 block of West National Avenue; and,

WHEREAS, the Railroad has agreed to construct the aforesaid crossing provided, among other things, that the City pay a portion of the cost of the work to be performed and the materials supplied.

NOW, THEREFORE, BE IT RESOLVED by the Common Council of the City of West Allis that the Agreement for the construction of a crossing at grade in the 6700 block of West National Avenue by and between the City and the Railroad be and is hereby approved.

BE IT FURTHER RESOLVED that the City Engineer be and is hereby authorized and directed to execute and deliver the Agreement on behalf of the City of West Allis.

BE IT FURTHER RESOLVED that the sum of Forty-Five Thousand Three Hundred Seventy-Six Dollars (\$45,376.00) be and is hereby appropriated from the Tax Incremental District #5 Account to meet the financial liability that will accrue to the City under the Agreement.

ADOPTED SEP 18 2007  
  
Paul M. Ziehler, City Adm. Officer, Clerk/Treas.

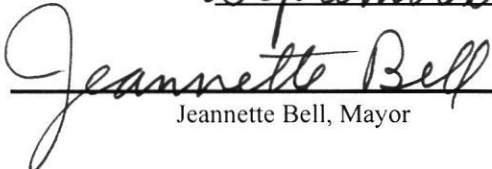
APPROVED September 20, 2007  
  
Jeannette Bell, Mayor

Richard Ellison  
301 W. Lake St  
Northlake, IL 60164  
Industry & Public Projects  
(708) 649-5214  
FAX (708) 649-5418  
richardellison@up.com

# Union Pacific Railroad Company



RECEIVED

SEP 05 2007

CITY OF WEST ALLIS  
ENGINEERING DEPT.

August 31, 2007  
Crossing: Public  
WI: West Allis  
National Ave Street  
MILE POST 86.35 Milwaukee Sub.  
DOT 177241E

Mr. Peter C. Daniels, PE  
Principal Engineer  
West Allis Engineering Department  
7525 W. Greenfield Avenue  
West Allis WI 53214

Dear Mr. Daniels:

SUBJECT: National Avenue Grade Crossing Agreement.

Attached are duplicate originals of the crossing agreement for the above location. Please arrange for City to execution of these agreements. Please return the executed agreement to my attention, at 301-West Lake Street, Room103, Northlake IL 60164. Upon receipt of the fully executed agreement, we will proceed with this project. If you have any additional questions, please contact me at (708) 649-5214

Sincerely,

Richard Ellison  
Industry & Public Projects

CC: Operating File

**IMPROVEMENTS TO EXISTING PUBLIC ROAD AT GRADE CROSSING  
FOR NATIONAL AVE STREET, DOT 177241E  
M.P. 86.36 MILWAUKEE SUBDIVISION  
WEST ALLIS , WISCONSIN**

THIS AGREEMENT, executed in duplicate this \_\_\_\_\_ day of \_\_\_\_\_, by and between UNION PACIFIC RAILROAD COMPANY, a Delaware corporation ("Railroad"), and CITY OF West Allis, a municipal corporation of the State of Wisconsin ("Political Body").

**RECITALS:**

Political Body has requested Railroad to improve the existing National Avenue crossing, at grade, along, over and across Railroad's track and right of way at Railroad Mile Post 86.36, on Railroad's Milwaukee Subdivision, DOT No. 177241E, in City of West Allis, Milwaukee County, State of Wisconsin (the "Crossing"), to which Railroad is agreeable, but solely upon terms and conditions hereinafter set forth.

The location of the Crossing is generally shown on the print marked Exhibit A, attached hereto and hereby made a part hereof.

**AGREEMENT:**

NOW THEREFORE, in consideration of the premises and of the promises and conditions hereinafter set forth, the parties hereto agree as follows:

1. Railroad shall furnish all labor, material, equipment and supervision for, and shall, (a) install a 16 ft. precast concrete crossing, (b) field weld rail, (c) relay track at the Crossing with 115 pound rail, (d) renew the crossties, and (e) surface the track with new ballast.
2. Political Body agrees to reimburse the Railroad for one hundred percent (100%) of Railroad's actual labor and material costs associated with the work and materials described in Section 1 above. Railroad estimates such cost to be Forty Five Thousand Three Hundred and Seventy Six Dollars (\$45,376.00), as set forth in Estimate of Material and Force Account dated August, 02 2007 marked Exhibit B, hereto attached and hereby made a part hereof. During the performance of such work Railroad will provide progressive billing to Political Body based on Railroad's actual costs. Actual costs to Railroad shall include customary additives (which include its overhead and indirect construction costs) to materials, services and labor provided by Railroad. Within One Hundred Twenty (120) days after Railroad has completed its work, Railroad will submit a final billing to Political Body for any balance owed. Political Body shall pay Railroad within thirty (30) days of its receipt of progressive and final bills submitted by Railroad.
3. Railroad, at its cost, shall maintain the Crossing between the track tie ends and Political Body, at its cost, shall maintain all other portions of the Crossing. If, in the future, Political Body elects to have the surfacing material between the track tie ends replaced with paving or some surfacing material other than timber planking, Railroad, at the Political Body's expense, shall install such replacement surfacing.
4. Political Body, at its cost, shall provide all labor, material and equipment associated with traffic control, barricades, detour signing, advanced warning signs and pavement markings. All such work shall be in compliance with the current Manual on Uniform Traffic Control Devices.

5. If Political Body's contractor(s) is/are performing any work described in Section 4 above, then Political Body shall require its contractor(s) to execute Railroad's standard and current form of Contractor's Right of Entry Agreement. Political Body acknowledges receipt of a copy of the Contractor's Right of Entry Agreement and understanding of its terms, provisions, and requirements, and will inform its contractor(s) of the need to execute the Agreement and to obtain and provide to Railroad the insurance policies, binders, certificates and endorsements that are required in the Contractor's Right of Entry Agreement. Under no circumstances will the Political Body's contractor(s) be allowed onto the Railroad's premises without first executing the Contractor's Right of Entry Agreement and providing the aforesaid insurance documents.

6. Fiber optic cable systems may be buried on Railroad's property. Protection of the fiber optic cable systems is of extreme importance since any break could disrupt service to users resulting in business interruption and loss of revenue and profits. Political Body or its contractor(s) shall telephone Railroad during normal business hours (7:00 a.m. to 9:00 p.m., Central Time, Monday through Friday, except holidays) at 1-800-336-9193 (also a 24-hour number, 7 day number for emergency calls) to determine if fiber optic cable is buried anywhere on Railroad's premises to be used by Political Body or its contractor(s). If it is, Political Body or its contractor(s) will telephone the telecommunications company (ies) involved, arrange for a cable locator, and make arrangements for relocation or other protection of the fiber optic cable prior to beginning any work on Railroad's premises.

7. Political Body, for itself and for its successors and assigns, hereby waives any right of assessment against Railroad, as an adjacent property owner, for any and all improvements made under this Agreement.

8. Covenants herein shall inure to or bind each party's successors and assigns; provided, no right of Political Body shall be transferred or assigned, either voluntarily or involuntarily, except by express written agreement acceptable to Railroad.

9. Political Body hereby confirms that funds have been appropriated for the work set forth in this Agreement.

10. The person signing this Agreement on behalf of Political Body hereby confirms that he/she is authorized under Political Body policies and procedures to execute this Agreement and to bind Political Body to the obligations under this Agreement.

IN WITNESS WHEREOF, the parties hereto have duly executed this Agreement as of the date first herein written.

UNION PACIFIC RAILROAD COMPANY

By \_\_\_\_\_  
Title: \_\_\_\_\_

CITY OF West Allis

By   
Title: City Engineer

Union Pacific R.R.

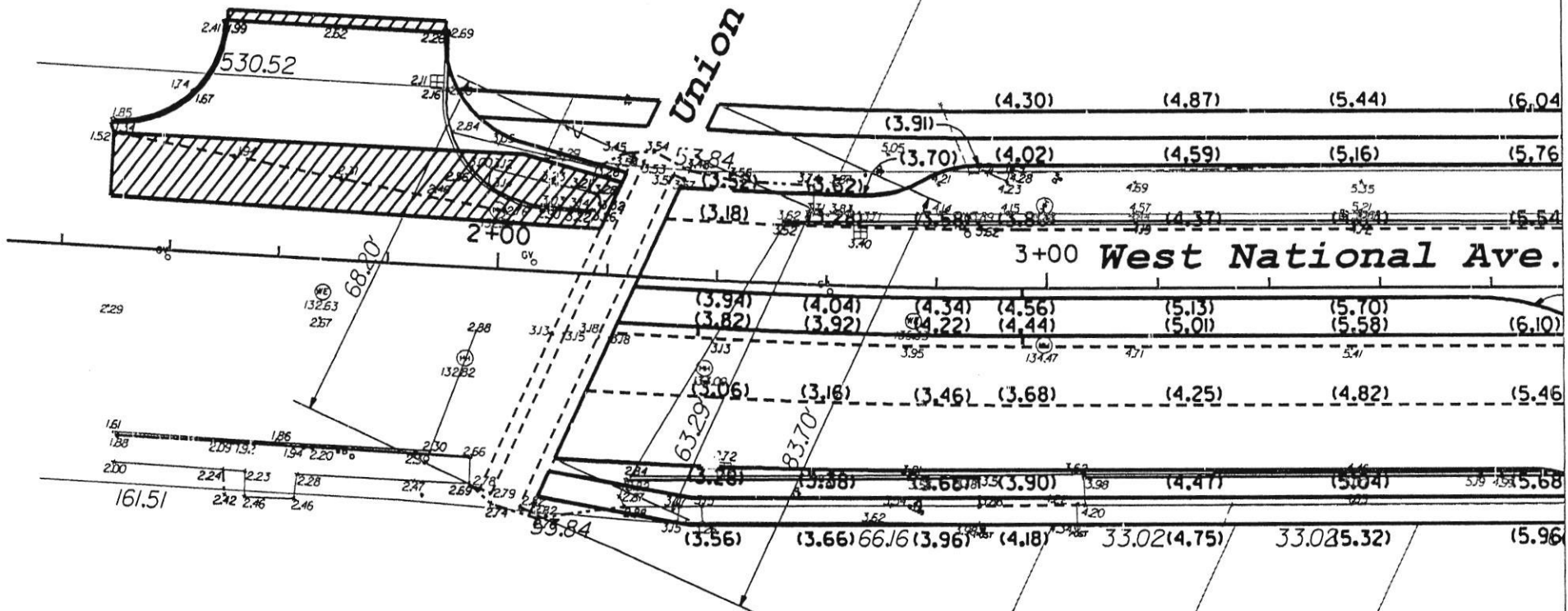

VAC

#6709

DATE: 2007-08-20

ESTIMATE OF MATERIAL AND FORCE ACCOUNT WORK  
BY THE  
UNION PACIFIC RAILROAD

THIS ESTIMATE GOOD FOR 6 MONTHS EXPIRATION DATE IS :2008-02-18

DESCRIPTION OF WORK:

INSTALL A 16 FOOT CONCRETE PAD CROSSING SURFACE INCLUDING TIES, RAIL & BALLAST AT NATIONAL AVENUE IN WEST ALLIS WI. MP. 86.36 ON THE MILWAUKEE SUB. CITY OF WEST ALLIS TO PAY 100% OF THE COST.

PID: 55021 AWO: 56625 MP, SUBDIV: 86.36, MILWAUKEE  
SERVICE UNIT: 01 CITY: WEST ALLIS STATE: WI

DESCRIPTION	QTY	UNIT	LABOR	MATERIAL	RECOLL	UPRR	TOTAL
ENGINEERING WORK							
ENGINEERING			1000		1000		1000
LABOR ADDITIVE 232%			2320		2320		2320
TOTAL ENGINEERING			3320		3320		3320
SIGNAL WORK							
LABOR ADDITIVE 232%			2271		2271		2271
SALES TAX				2	2		2
SIGNAL			979	63	1042		1042
TOTAL SIGNAL			3250	65	3315		3315
TRACK & SURFACE WORK							
BALAST	1.00	CL	2282	666	2948		2948
BILL PREP				900	900		900
CONTRACT - EQUIP RENTAL				10000	10000		10000
FIELD WELD	4				4		4
FOREIGN LINE FREIGHT				52	52		52
HOME LINE FREIGHT				900	900		900
LABOR ADDITIVE 232%			12100		12100		12100
MATL STORE EXPENSE				117	117		117
OTM			197	142	339		339
RAIL	48.00	LF	266	740	1006		1006
RDXING	16.00	TF	1301	2843	4144		4144
SALES TAX				232	232		232
TRACK-RETIRE			209		209		209
TRK-SURF, LIN			2504		2504		2504
WELD			138	265	403		403
XTIE	15.00	EA	1673	1210	2883		2883
TOTAL TRACK & SURFACE			20674	18067	38741		38741
LABOR/MATERIAL EXPENSE			27244	18132			
RECOLLECTIBLE/UPRR EXPENSE					45376	0	
ESTIMATED PROJECT COST							45376
EXISTING REUSEABLE MATERIAL CREDIT						0	
SALVAGE NONUSEABLE MATERIAL CREDIT						0	
RECOLLECTIBLE LESS CREDITS							

THE ABOVE FIGURES ARE ESTIMATES ONLY AND SUBJECT TO FLUCTUATION. IN THE EVENT OF AN INCREASE OR DECREASE IN THE COST OR QUANTITY OF MATERIAL OR LABOR REQUIRED, UPRR WILL BILL FOR ACTUAL CONSTRUCTION COSTS AT THE CURRENT EFFECTIVE RATE.

□

EXHIBIT "B"



## WORK ORDER AUTHORIZATION-DETAIL OF ESTIMATED EXPENDITURES

RAILROAD: UPRR CO.  
 LOCATION: WEST ALLIS,WI,NATIONAL AVE,WILWAUKEE  
 DEPARTMENT: ENGINEERING SERVICES

PROJ NO: 55021  
 A.W.O. NO: 56625  
 W.O. NO:  
 B.I. NO: 06EN10  
 STATE: WI  
 VAL SEC: 4734

-----  
 ----- STOCK MATERIAL PLAN -----

ITEM NUMBER	ITEM DESCRIPTION	UNIT COST	QTY	UM	DIRECT MATL \$
09065700	TAPE, ELECTRICAL PLASTIC	2.53	1	RL	3
09135650	2363 J, SLEEVE, 4-6, REDUCING	0.53	10	EA	5
09136370	2367 J SLEEVE, SPLICING, 4-4	0.49	10	EA	5
09874890	STAPLE, COPPERWELD 3/8 X 1 3/4 X	0.24	12	EA	3
13054000	TIMBER SPIKE, TORXHEAD 3/4" X 12"	1.30	36	EA	47
41276600	ADHESIVE, WELD TAGS, RTV SILICON	3.86	2	EA	8
50279750	XTIE 7"X9"X10' PREPLT FOR 5 1/2"	80.71	15	EA	1211
50361010	BCL2055 GALV RH E-CLIP PA	2.37	60	EA	142
52005690	BOND WIRE, 7 STRANDS 500 LF. ROLL	0.66	50	LF	33
52007040	WEB WELD BOND WIRE TK.CIRC.CONN.	3.73	4	EA	15
54002000	ASPHALT, CROSSING FILL	30.00	18	TN	540
54002020	CROSSING, CONCRETE-115# RAIL(10W)	1128.29	2	ST	2257
55111800	RAIL 115# RE HIGH CARBON BBE	15.43	48	LF	741
55255160	FIELD WELD KIT, 112#/115# ONE SH	59.58	4	EA	238
55264570	PACKING SAND, PRE-MIXED (PER SACK	22.44	0	CA	18
55264930	REFRACTORY PASTE	1.83	1	EA	2
56207660	BALLAST, CLASS 1 "D"	7.02	95	TN	667
TOTAL					5,935
MATL STORE EXP					118
SALES TAX					237



Please send an executed copy to the Clerk's Office with this note attached.

Thank you.

Res. No. R-2007-0225

Date Adopted 9-18-07

NOV 26 2007

CITY OF WEST ALLIS  
ENGINEERING DEPT.

**IMPROVEMENTS TO EXISTING PUBLIC ROAD AT GRADE CROSSING  
FOR NATIONAL AVE STREET, DOT 177241E  
M.P. 86.36 MILWAUKEE SUBDIVISION  
WEST ALLIS , WISCONSIN**

THIS AGREEMENT, executed in duplicate this 25<sup>th</sup> day of OCTOBER, 2007 by and between UNION PACIFIC RAILROAD COMPANY, a Delaware corporation ("Railroad"), and CITY OF West Allis, a municipal corporation of the State of Wisconsin ("Political Body").

**RECITALS:**

Political Body has requested Railroad to improve the existing National Avenue crossing, at grade, along, over and across Railroad's track and right of way at Railroad Mile Post 86.36, on Railroad's Milwaukee Subdivision, DOT No. 177241E, in City of West Allis, Milwaukee County, State of Wisconsin (the "Crossing"), to which Railroad is agreeable, but solely upon terms and conditions hereinafter set forth.

The location of the Crossing is generally shown on the print marked Exhibit A, attached hereto and hereby made a part hereof.

**AGREEMENT:**

NOW THEREFORE, in consideration of the premises and of the promises and conditions hereinafter set forth, the parties hereto agree as follows:

1. Railroad shall furnish all labor, material, equipment and supervision for, and shall, (a) install a 16 ft. precast concrete crossing, (b) field weld rail, (c) relay track at the Crossing with 115 pound rail, (d) renew the crossties, and (e) surface the track with new ballast.

2. Political Body agrees to reimburse the Railroad for one hundred percent (100%) of Railroad's actual labor and material costs associated with the work and materials described in Section 1 above. Railroad estimates such cost to be Forty Five Thousand Three Hundred and Seventy Six Dollars (\$45,376.00), as set forth in Estimate of Material and Force Account dated August, 20 2007 marked Exhibit B, hereto attached and hereby made a part hereof. During the performance of such work Railroad will provide progressive billing to Political Body based on Railroad's actual costs. Actual costs to Railroad shall include customary additives (which include its overhead and indirect construction costs) to materials, services and labor provided by Railroad. Within One Hundred Twenty (120) days after Railroad has completed its work, Railroad will submit a final billing to Political Body for any balance owed. Political Body shall pay Railroad within thirty (30) days of its receipt of progressive and final bills submitted by Railroad.

3. Railroad, at its cost, shall maintain the Crossing between the track tie ends and Political Body, at its cost, shall maintain all other portions of the Crossing. If, in the future, Political Body elects to have the surfacing material between the track tie ends replaced with paving or some surfacing material other than timber planking, Railroad, at the Political Body's expense, shall install such replacement surfacing.

4. Political Body, at its cost, shall provide all labor, material and equipment associated with traffic control, barricades, detour signing, advanced warning signs and pavement markings. All such work shall be in compliance with the current Manual on Uniform Traffic Control Devices.

5. If Political Body's contractor(s) is/are performing any work described in Section 4 above, then Political Body shall require its contractor(s) to execute Railroad's standard and current form of Contractor's Right of Entry Agreement. Political Body acknowledges receipt of a copy of the Contractor's Right of Entry Agreement and understanding of its terms, provisions, and requirements, and will inform its contractor(s) of the need to execute the Agreement and to obtain and provide to Railroad the insurance policies, binders, certificates and endorsements that are required in the Contractor's Right of Entry Agreement. Under no circumstances will the Political Body's contractor(s) be allowed onto the Railroad's premises without first executing the Contractor's Right of Entry Agreement and providing the aforesaid insurance documents.

6. Fiber optic cable systems may be buried on Railroad's property. Protection of the fiber optic cable systems is of extreme importance since any break could disrupt service to users resulting in business interruption and loss of revenue and profits. Political Body or its contractor(s) shall telephone Railroad during normal business hours (7:00 a.m. to 9:00 p.m., Central Time, Monday through Friday, except holidays) at 1-800-336-9193 (also a 24-hour number, 7 day number for emergency calls) to determine if fiber optic cable is buried anywhere on Railroad's premises to be used by Political Body or its contractor(s). If it is, Political Body or its contractor(s) will telephone the telecommunications company (ies) involved, arrange for a cable locator, and make arrangements for relocation or other protection of the fiber optic cable prior to beginning any work on Railroad's premises.

7. Political Body, for itself and for its successors and assigns, hereby waives any right of assessment against Railroad, as an adjacent property owner, for any and all improvements made under this Agreement.

8. Covenants herein shall inure to or bind each party's successors and assigns; provided, no right of Political Body shall be transferred or assigned, either voluntarily or involuntarily, except by express written agreement acceptable to Railroad.

9. Political Body hereby confirms that funds have been appropriated for the work set forth in this Agreement.

10. The person signing this Agreement on behalf of Political Body hereby confirms that he/she is authorized under Political Body policies and procedures to execute this Agreement and to bind Political Body to the obligations under this Agreement.

IN WITNESS WHEREOF, the parties hereto have duly executed this Agreement as of the date first herein written.

UNION PACIFIC RAILROAD COMPANY

By   
Title: AVP ENGINEERING

CITY OF West Allis

By   
Title: City Engineer

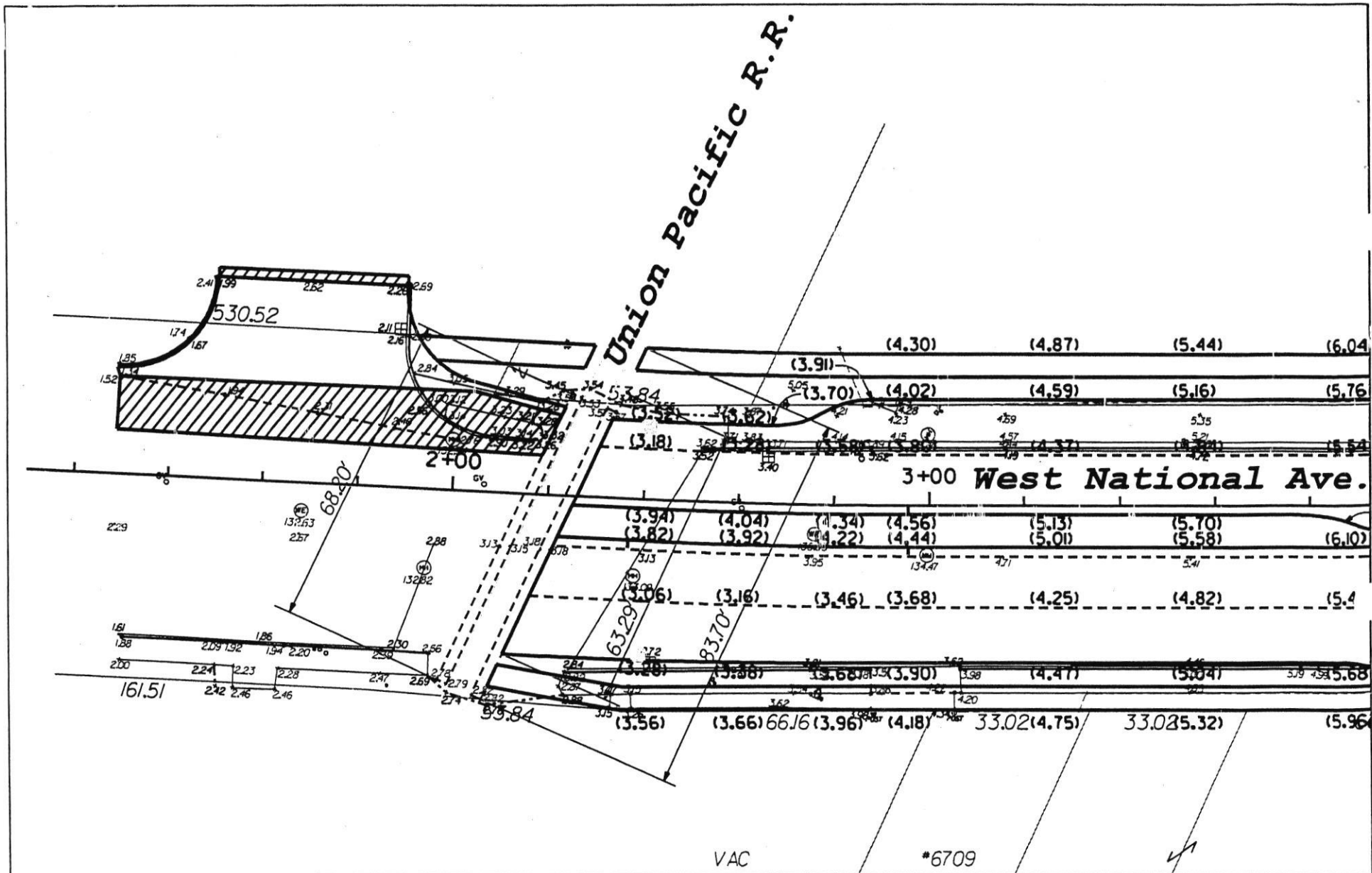

...Toldt\8-27-07\NATIONAL-1.DGN 8/27/2007 3:59:05 PM

DATE: 2007-08-20

ESTIMATE OF MATERIAL AND FORCE ACCOUNT WORK  
BY THE  
UNION PACIFIC RAILROAD

THIS ESTIMATE GOOD FOR 6 MONTHS EXPIRATION DATE IS :2008-02-18

DESCRIPTION OF WORK:

INSTALL A 16 FOOT CONCRETE PAD CROSSING SURFACE INCLUDING TIES, RAIL & BALLAST AT NATIONAL AVENUE IN WEST ALLIS WI. MP. 86.36 ON THE MILWAUKEE SUB. CITY OF WEST ALLIS TO PAY 100% OF THE COST.

PID: 55021 AWO: 56625 MP,SUBDIV: 86.36, MILWAUKEE  
SERVICE UNIT: 01 CITY: WEST ALLIS STATE: WI

DESCRIPTION	QTY	UNIT	LABOR	MATERIAL	RECOLL	UPRR	TOTAL
<b>ENGINEERING WORK</b>							
ENGINEERING			1000		1000		1000
LABOR ADDITIVE 232%			2320		2320		2320
<b>TOTAL ENGINEERING</b>			<b>3320</b>		<b>3320</b>		<b>3320</b>
<b>SIGNAL WORK</b>							
LABOR ADDITIVE 232%			2271		2271		2271
SALES TAX				2	2		2
SIGNAL			979	63	1042		1042
<b>TOTAL SIGNAL</b>			<b>3250</b>	<b>65</b>	<b>3315</b>		<b>3315</b>
<b>TRACK &amp; SURFACE WORK</b>							
BALAST	1.00	CL	2282	666	2948		2948
BILL PREP				900	900		900
CONTRACT - EQUIP RENTAL				10000	10000		10000
FIELD WELD			4		4		4
FOREIGN LINE FREIGHT				52	52		52
HOME LINE FREIGHT				900	900		900
LABOR ADDITIVE 232%			12100		12100		12100
MATL STORE EXPENSE				117	117		117
OTM			197	142	339		339
RAIL	48.00	LF	266	740	1006		1006
RDXING	16.00	TF	1301	2843	4144		4144
SALES TAX				232	232		232
TRACK-RETIRE			209		209		209
TRK-SURF,LIN			2504		2504		2504
WELD			138	265	403		403
XTIE	15.00	EA	1673	1210	2883		2883
<b>TOTAL TRACK &amp; SURFACE</b>			<b>20674</b>	<b>18067</b>	<b>38741</b>		<b>38741</b>
<b>LABOR/MATERIAL EXPENSE</b>			<b>27244</b>	<b>18132</b>			
<b>RECOLLECTIBLE/UPRR EXPENSE</b>					<b>45376</b>	<b>0</b>	
<b>ESTIMATED PROJECT COST</b>							<b>45376</b>
<b>EXISTING REUSEABLE MATERIAL CREDIT</b>					<b>0</b>		
<b>SALVAGE NONUSEABLE MATERIAL CREDIT</b>					<b>0</b>		
<b>RECOLLECTIBLE LESS CREDITS</b>							

THE ABOVE FIGURES ARE ESTIMATES ONLY AND SUBJECT TO FLUCTUATION. IN THE EVENT OF AN INCREASE OR DECREASE IN THE COST OR QUANTITY OF MATERIAL OR LABOR REQUIRED, UPRR WILL BILL FOR ACTUAL CONSTRUCTION COSTS AT THE CURRENT EFFECTIVE RATE.

□

EXHIBIT "B"

## WORK ORDER AUTHORIZATION-DETAIL OF ESTIMATED EXPENDITURES

RAILROAD: UPRR CO.  
 LOCATION: WEST ALLIS, WI, NATIONAL AVE, WILWAUKEE  
 DEPARTMENT: ENGINEERING SERVICES

PROJ NO: 55021  
 A.W.O. NO: 56625  
 W.O. NC:  
 B.I. NO: 06EN10  
 STATE: WI  
 VAL SEC: 4734

-----  
 ----- STOCK MATERIAL PLAN -----

ITEM NUMBER	ITEM DESCRIPTION	UNIT COST	QTY	UM	DIRECT MATL \$
09065700	TAPE, ELECTRICAL PLASTIC	2.53	1	RL	3
09135650	2363 J, SLBEVE, 4-6, REDUCING	0.53	10	EA	5
09136370	2367 J SLBEVE, SPLICING, 4-4	0.49	10	EA	5
09874890	STAPLE, COPPERWELD 3/8 X 1 3/4 X	0.24	12	EA	3
13054000	TIMBER SPIKE, TORXHEAD 3/4" X 12"	1.30	36	EA	47
41276600	ADHESIVE, WELD TAGS, RTV SILICON	3.86	2	EA	8
50279750	XTIE 7"X9"X10' PREPLT FOR 5 1/2"	80.71	15	EA	1211
50361010	ECL2055 GALV RH E-CLIP PA	2.37	60	EA	142
52005690	BOND WIRE, 7 STRANDS 500 LF. ROLL	0.66	50	LF	33
52007040	WEB WELD BOND WIRE TK. CIRC. CONN.	3.73	4	EA	15
54002000	ASPHALT, CROSSING FILL	30.00	18	TN	540
54002020	CROSSING, CONCRETE-115# RAIL(10W)	1128.29	2	ST	2257
55111800	RAIL 115# RE HIGH CARBON BBE	15.43	48	LF	741
55255160	FIELD WELD KIT, 112#/115# ONE SH	59.58	4	EA	238
55264570	PACKING SAND, PRE-MIXED (PER SACK	22.44	0	CA	18
55264930	REFRACTORY PASTE	1.83	1	EA	2
56207660	BALLAST, CLASS 1 "D"	7.02	95	TN	667
TOTAL					5,935
MATL STORE EXP					118
SALES TAX					237