



**ENGINEERING DEPARTMENT**

**Michael G. Lewis**  
*Director of Public Works / City Engineer*

414/302-8360  
414/302-8366 (Fax)

City Hall  
7525 West Greenfield Avenue  
West Allis, Wisconsin 53214

[www.ci.west-allis.wi.us](http://www.ci.west-allis.wi.us)  
[mlewis@ci.west-allis.wi.us](mailto:mlewis@ci.west-allis.wi.us)

Mayor Dan Devine and Members of the Common Council  
7525 West Greenfield Avenue  
West Allis, WI 53214

Honorable Mayor and Council Members:

W. National Avenue from S. 84 Street to S. 92 Street will be reconstructed in the summer of 2012. While the new street is to be constructed the exact same width as it is now; we have identified several parking restrictions that would allow the new street to function with much less congestion.

We are proposing new restrictions during the morning and evening rush hours along the entire length. No parking would be allowed between 7 and 9 am and between 4 and 6 pm. In addition, parking would be permanently restricted on the approaches to several intersections including at S. 92<sup>nd</sup> Street and W. Becher Street.

The traffic congestion currently is measured at level of service D and E (on a scale of A is free flowing and F is failure) at both of the signalized intersections. But while the existing congestion is bad, the future projections are for both intersections to operate at level of service F. This would mean that cars would be backed up from 700 to 1,000 feet along National Ave. at 92<sup>nd</sup> St. and 300 to 800 feet along National Ave. at Becher St. This also would mean that the average speed on National Ave would be reduced to a mere 8 mph as the average car would be delayed 64 seconds while passing through this roadway segment.

These back ups could be cut in half if parking is restricted because motorists could maneuver around left turning vehicles on National Avenue. The average speed would be increased to 18 mph as well and delays would be reduced from 64 seconds to 22 seconds per vehicle. This would also eliminate a number of existing accidents involving parked cars on National Avenue. The road would continue to operate at a level of service D or better for the next twenty years without the need to widen it.

We are also recommending that left turns from 92<sup>nd</sup> Street be prohibited during the rush hour to keep traffic moving along 92<sup>nd</sup> Street.

Sincerely,

Peter C. Daniels, P.E.  
Principal Engineer

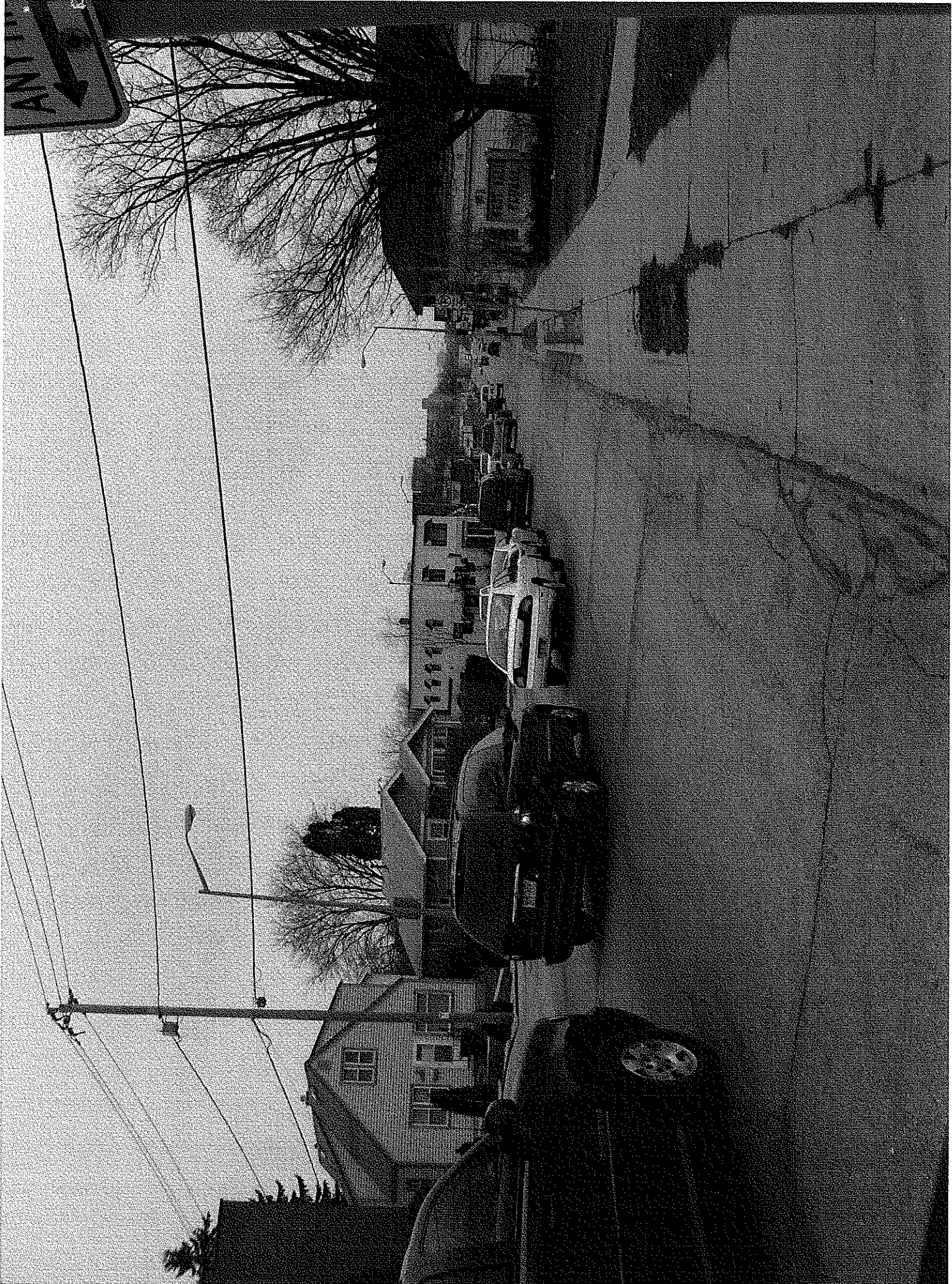





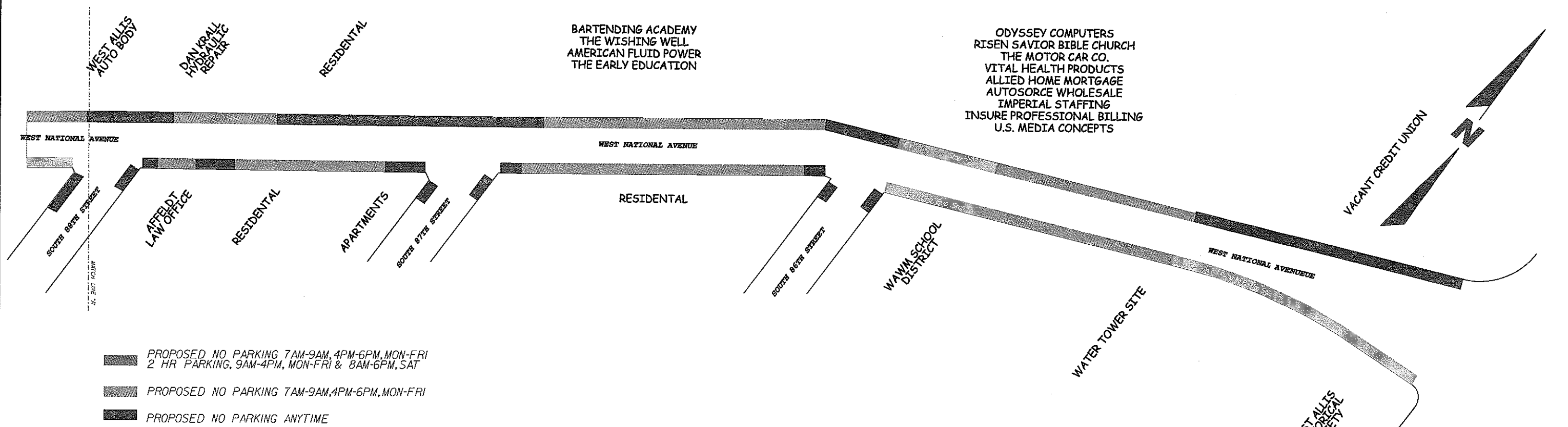
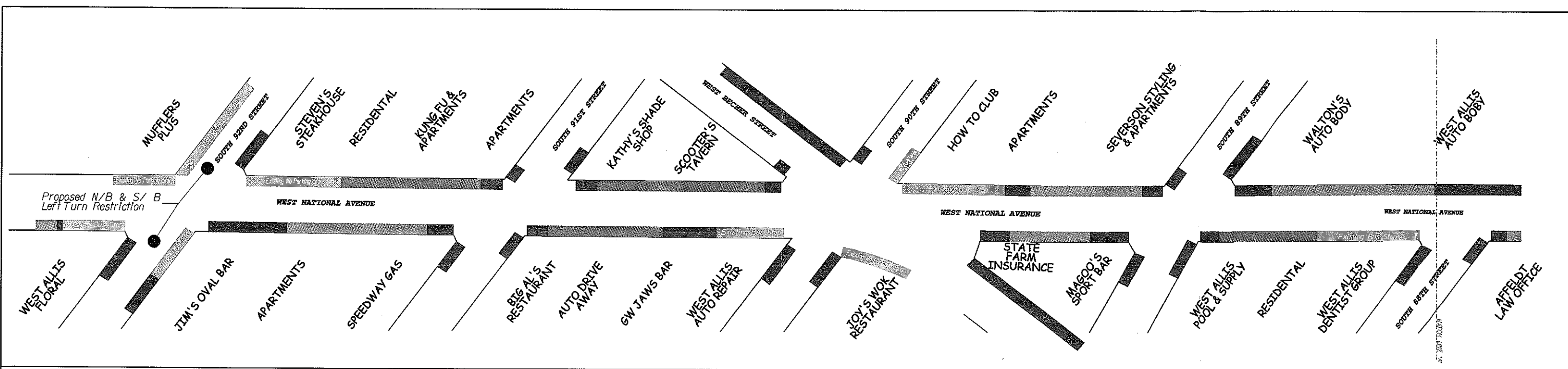

- PROPOSED NO PARKING 7AM-9AM, 4PM-6PM, MON-FRI  
2 HR PARKING, 9AM-4PM, MON-FRI & 8AM-6PM, SAT
- PROPOSED NO PARKING 7AM-9AM, 4PM-6PM, MON-FRI
- PROPOSED NO PARKING ANYTIME

**PROPOSED PARKING RESTRICTIONS**  
 IN: West National Avenue  
 FROM: South 84th St.  
 TO: 110 ft. west of South 92nd St.