

29.



City of West Allis Matter Summary

7525 W. Greenfield Ave.
West Allis, WI 53214

File Number	Title	Status
2008-0454	Communication	In Committee
	Communication from City Engineer Regarding Extending Storm Sewer to the backyard of 2117 S. 96th Street	
	Introduced: 6/17/2008	Controlling Body: Public Works Committee

COMMITTEE RECOMMENDATION Approve

ACTION DATE:	MOVER	SECONDER		AYE	NO	PRESENT	EXCUSED
			Barczak	✓			
		✓	Czaplewski	✓			
			Kopplin				
			Lajsic				
			Narlock				
			Reinke				
			Roadt	✓			
	✓		Sengstock	✓			
			Vitale				
			Weigel				✓
			TOTAL	4			1

SIGNATURE OF COMMITTEE MEMBER

[Signature] _____
 Chair Vice-Chair Member

COMMON COUNCIL ACTION **APPROVAL**

ACTION DATE:	MOVER	SECONDER		AYE	NO	PRESENT	EXCUSED
	✓		Barczak	✓			
			Czaplewski	✓			
			Kopplin	✓			
			Lajsic	✓			
		✓	Narlock	✓			
			Reinke	✓			
			Roadt	✓			
			Sengstock	✓			
			Vitale	✓			
			Weigel				✓
			TOTAL	9			1



ENGINEERING DEPARTMENT

Michael G. Lewis
City Engineer

414/302-8360
414/302-8366 (Fax)

City Hall
7525 West Greenfield Avenue
West Allis, Wisconsin 53214

www.ci.west-allis.wi.us
mlewis@ci.west-allis.wi.us

June 12, 2008

Board of Public Works
City of West Allis
West Allis, WI 53214

**RE: Communication from City Engineer Regarding Extending Storm Sewer to
the backyard of 2117 96th Street**

Dear Board Members:

Attached is a plan showing the intended storm sewer extension. This property is the low point for a number of surrounding properties. We have inspected the property and agree that they have a water problem and it's affecting not only their property, but the 2115 96th property too. Unfortunately, there is no other solution but to extend storm sewer to their backyard. The assessment at 2117 and 2115 would be \$1,000 each. The Board has authorized similar work in the past and it's consistent with current policy. We are asking for approval of the project and to add this work to a future contract. It would be done this year.

Respectfully,

Michael G. Lewis
City Engineer

MGL/mgl

9630

W. BECHER ST

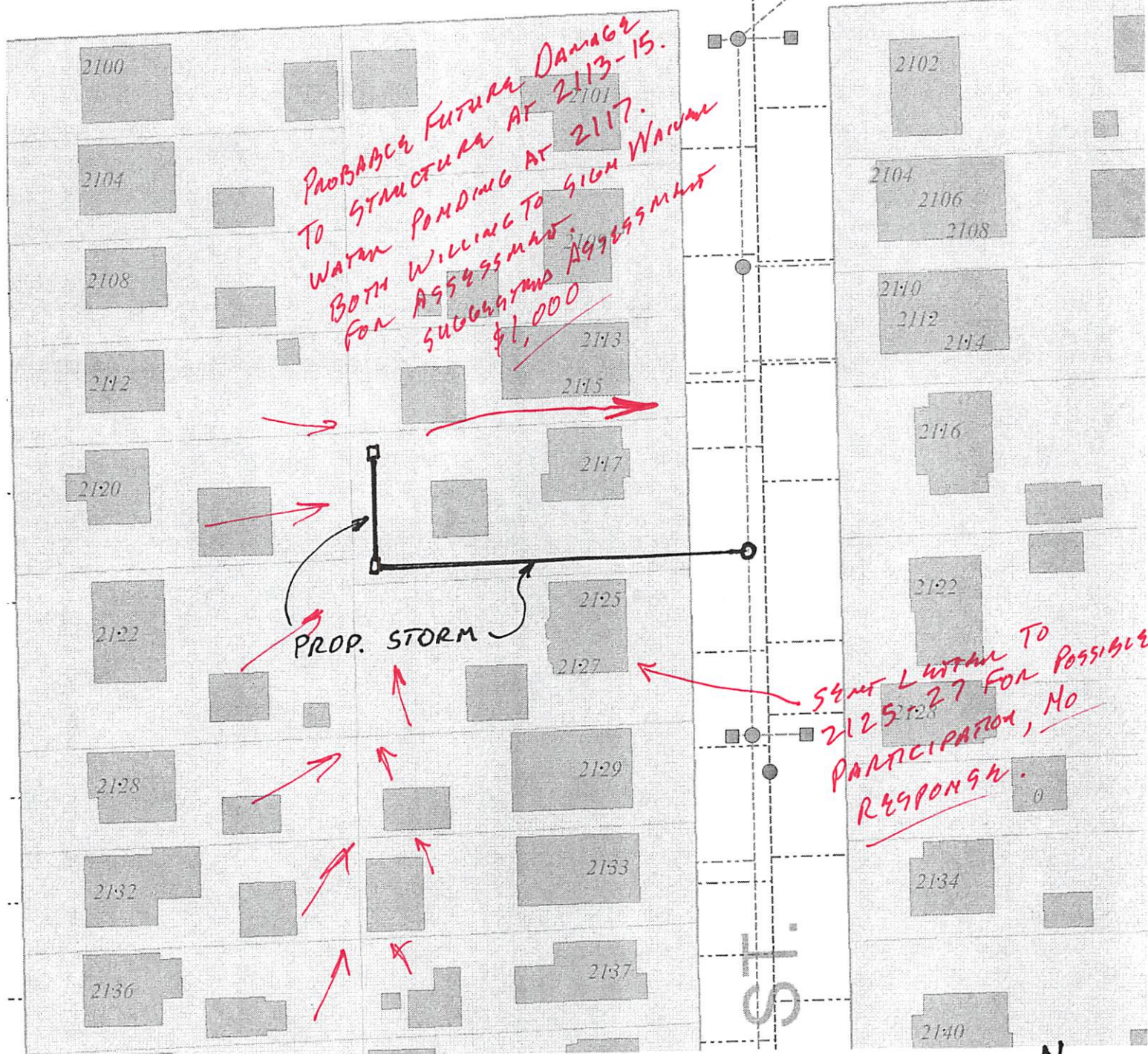

PROBABLY FUTURE DAMAGE
 TO STRUCTURE AT 2113-15.
 WATER PONDING AT 2117.
 BOTH WILLING TO SIGN WAIVER
 FOR ASSESSMENT
 SUGGESTING ASSESSMENT
 \$1,000

SENT LETTER TO
 2125, 2127 FOR POSSIBLE
 PARTICIPATION, NO
 RESPONSE.

CONSTRUCTION ESTIMATE:

150 LIN. FT. OF 10" STORM @ \$70/LF	=	10,500
2 CATCH BASINS @ 1200	=	2,400
1 MANHOLE @ 1500	=	1,500
LAWN REPLACEMENT	=	2,000
PAVEMENT REPLACEMENT	=	800

TOTAL EST. COST = \$17,200

S. 96

