

44.



City of West Allis Matter Summary

7525 W. Greenfield Ave.
West Allis, WI 53214

| File Number | Title | Status |
|-------------|---|--|
| R-2006-0341 | Resolution | In Committee |
| | Resolution approving a Certified Survey Map for proposed commercial lot split of the Taco Bell parking lot at 110** W. National Ave. (Tax Key No. 520-9965-030) | |
| | Introduced: 11/21/2006 | Controlling Body: Safety & Development Committee |
| | | Sponsor(s): Safety & Development Committee |

COMMITTEE RECOMMENDATION

ADOPT

| ACTION DATE: | MOVER | SECONDER | | AYE | NO | PRESENT | EXCUSED |
|---------------|-------|----------|------------|----------|----------|---------|---------|
| <u>4/3/07</u> | | | Barczak | ✓ | | | |
| | | | Czaplewski | | | | |
| | | | Dobrowski | | | | |
| | | | Kopplin | | | | |
| | | | Lajsic | ✓ | | | |
| | | | Narlock | | | | |
| | ✓ | | Reinke | ✓ | | | |
| | | | Sengstock | | | | |
| | | ✓ | Vitale | ✓ | | | |
| | | | Weigel | ✓ | | | |
| | | | TOTAL | <u>5</u> | <u>0</u> | | |

SIGNATURE OF COMMITTEE MEMBER

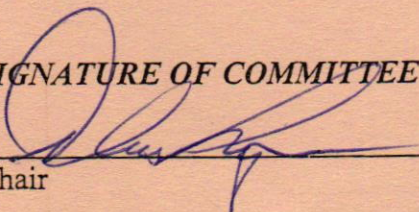
 _____
 Chair Vice-Chair Member

COMMON COUNCIL ACTION **ADOPT**

| ACTION DATE: | MOVER | SECONDER | | AYE | NO | PRESENT | EXCUSED |
|--------------------|-------|----------|------------|-----------|----------|---------|---------|
| <u>APR 03 2007</u> | | | Barczak | ✓ | | | |
| | | | Czaplewski | ✓ | | | |
| | | | Dobrowski | ✓ | | | |
| | | | Kopplin | ✓ | | | |
| | ✓ | | Lajsic | ✓ | | | |
| | | | Narlock | ✓ | | | |
| | | | Reinke | ✓ | | | |
| | | | Sengstock | ✓ | | | |
| | | ✓ | Vitale | ✓ | | | |
| | | | Weigel | ✓ | | | |
| | | | TOTAL | <u>10</u> | <u>0</u> | | |



City of West Allis

7525 W. Greenfield Ave.
West Allis, WI 53214

Resolution

File Number: R-2006-0341

Final Action:

APR 03 2007

Resolution approving a Certified Survey Map for proposed commercial lot split of the Taco Bell parking lot at 110** W. National Ave. (Tax Key No. 520-9965-030)

WHEREAS, Jessica C. White of Yumi Brands, Inc. submitted a Certified Survey Map for proposed commercial lot split of the Taco Bell parking lot at 110** W. National Ave. (Tax Key No. 520-9965-030)

NOW THEREFORE BE IT RESOLVED by the Common Council of the City of West Allis, Wisconsin, that the Certified Survey Map of a parcel of land being a re-division of Parcel 1 of Certified Survey Map No. 4522 in the Northeast 1/4 of the Southeast 1/4 of Section 7, Town 6 North, Range 21 East, in the City of West Allis, Milwaukee County, Wisconsin.

ADOPTED

April 3, 2007

Paul M. Ziehler, City Admin. Officer, Clerk/Treas.

APPROVED

April 4, 2007

Jeannette Bell, Mayor



7525 West Greenfield Avenue
West Allis, Wisconsin 53214-4648



CITY CLERK/TREASURER'S OFFICE

414/302-8200 or 414/302-8207 (Fax)

www.ci.west-allis.wi.us

Paul M. Ziehler

City Admin. Officer, Clerk/Treasurer

Monica Schultz

Assistant City Clerk

Rosemary West

Treasurer's Office Supervisor

April 10, 2007

Yum! Brands, Inc.
Jessica C. White
1900 Colonel Sanders Lane
Louisville, KY 40213

Dear Ms. White:

Enclosed is a copy of Certified Survey Map No. 7902, for proposed commercial lot split of the Taco Bell parking lot at 110** W. National Ave. (Tax Key No. 520-9965-030) which was recorded on April 5, 2007.

Sincerely,

Monica Schultz
Assistant City Clerk

/amn

enc.

cc: Planning & Zoning Department
City Engineer
City Assessor
Director of Building Inspections & Zoning
Special Assessment Clerk
Pat Walker
Jim I. Morrow, Surveyor



City of West Allis

7525 W. Greenfield Ave.
West Allis, WI 53214

Resolution **ORIGINAL**

File Number: R-2006-0341

Final Action:

APR 03 2007

Resolution approving a Certified Survey Map for proposed commercial lot split of the Taco Bell parking lot at 110** W. National Ave. (Tax Key No. 520-9965-030)

WHEREAS, Jessica C. White of Yumi Brands, Inc. submitted a Certified Survey Map for proposed commercial lot split of the Taco Bell parking lot at 110** W. National Ave. (Tax Key No. 520-9965-030)

NOW THEREFORE BE IT RESOLVED by the Common Council of the City of West Allis, Wisconsin, that the Certified Survey Map of a parcel of land being a re-division of Parcel 1 of Certified Survey Map No. 4522 in the Northeast 1/4 of the Southeast 1/4 of Section 7, Town 6 North, Range 21 East, in the City of West Allis, Milwaukee County, Wisconsin.

ADOPTED

April 3, 2007

Paul M. Ziebler, City Admin. Officer, Clerk/Treas.

APPROVED

April 4, 2007

Jeannette Bell, Mayor

③

REGISTER OF DEEDS

JOHN LA FAYE

04/05/2007

11:38AM

09412267

CERTIFIED SURVEY MAP 23.00

No. 7902

295566

CERTIFIED COPY FEE: \$5.00

CERTIFIED MISC FEE: \$1.00

RECORDING FEE: \$17.00

TOTAL: \$23.00

CASH: \$23.00

PHONE # 278-4005
130733

ORIGINAL

CERTIFIED SURVEY MAP NO. 7902

A re-division of Parcel 1 of Certified Survey Map No. 4522 in the Northeast 1/4 of the Southeast 1/4 of Section 7, Town 6 North, Range 21 East, in the City of West Allis, Milwaukee County, Wisconsin.

SURVEYOR'S CERTIFICATE

STATE OF WISCONSIN }
 :SS
WAUKESHA COUNTY }

I, JIM I. MORROW, a Registered Land Surveyor, do hereby certify:

THAT I have surveyed, divided and mapped a re-division of Parcel 1 of Certified Survey Map No. 4522 in the Northeast 1/4 of the Southeast 1/4 of Section 7, Town 6 North, Range 21 East, in the City of West Allis, Milwaukee County, Wisconsin, which is bounded and described as follows:

COMMENCING at the Southeast corner of the Southeast 1/4 of said Section 7; thence North 00°55'40" West along the East line of said 1/4 Section 675.01 feet to a point; thence South 89°04'20" West 1177.76 feet to a point; thence North 38°38'55" West 301.76 feet to a point in the Southerly line of West National Avenue; thence North 51°21'05" East along said Southerly line 712.60 feet to the point of beginning of the lands to be described; thence continuing North 51°21'05" East 271.07 feet along said Southerly line of West National Avenue; thence South 38°38'55" East 55.81 feet to a point; thence South 00°55'40" East 54.65 feet to a point; thence North 89°04'20" East 129.92 feet to a point; thence South 00°55'40" East 67.05 feet to a point; thence South 89°04'20" West 378.48 feet to the point of beginning.

THAT I have made this survey, land division and map by the direction of TACO BELL OF AMERICA, INC., owner of said land.

THAT such map is a correct representation of all the exterior boundaries of the land surveyed and the land division thereof made.

THAT I have fully complied with the provisions of Chapter 236 of the Wisconsin Statutes and Chapter XII of the revised Municipal Codes of the City of West Allis, in surveying, dividing and mapping the same.

10/24/06
DATE

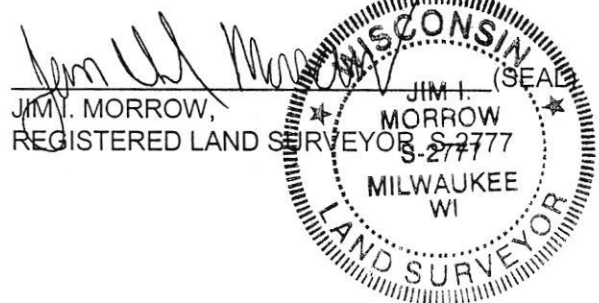

DOC.# 09412267

REGISTER'S OFFICE | SS
Milwaukee County, WI

RECORDED 04/05/2007 11:38AM

JOHN LA FAVE
REGISTER OF DEEDS

AMOUNT: 17.00

ORIGINAL

CERTIFIED SURVEY MAP NO. 7902

A re-division of Parcel 1 of Certified Survey Map No. 4522 in the Northeast 1/4 of the Southeast 1/4 of Section 7, Town 6 North, Range 21 East, in the City of West Allis, Milwaukee County, Wisconsin.

OWNER'S CERTIFICATE

TACO BELL OF AMERICA, INC., a corporation duly organized and existing under and by virtue of the laws of the State of Delaware, as owner, certify that said corporation caused the land described on this map to be surveyed, divided and mapped as represented on this map in accordance with the subdivision regulations of the City of West Allis, and Chapter 236 of the Wisconsin Statutes.

TACO BELL OF AMERICA, INC., does further certify that this map is required by S.236.10 or S.236.12 to be submitted to the following for approval or objection: City of West Allis

IN Witness Whereof, the said TACO BELL OF AMERICA, INC., has caused these presents to be signed by _____, its _____ at _____, Wisconsin, this 30th day of October, 2006.

In the presence of:

TACO BELL OF AMERICA, INC.)

Jessica White
Jessica White

Ky
STATE OF WISCONSIN }
Jefferson COUNTY } :SS

Jessica White, Atty. In fact PERSONALLY came before me this 30th day of October, 2006, _____ of the above named corporation, to me known as the person who executed the foregoing instrument and to me known to be such _____ of said corporation and acknowledged that he executed the foregoing instrument as such officer as the deed of the corporation, by its authority.

Tracy R. Bookout (SEAL)
Notary Public, State of Wisconsin Ky
My commission expires 12-09-08
My commission is permanent.



COMMON COUNCIL RESOLUTION

BE it resolved by the Common Council of the City of West Allis, Wisconsin, that the Certified Survey Map of a parcel of land being a re-division of Parcel 1 of Certified Survey Map No. 4522 in the Northeast 1/4 of the Southeast 1/4 of Section 7, Town 6 North, Range 21 East, in the City of West Allis, Milwaukee County, Wisconsin.

APPROVED: April 4, ~~2006~~ ²⁰⁰⁷

ADOPTED: April 3, ~~2006~~ ²⁰⁰⁷

Jeannette Bell
JEANNETTE BELL, MAYOR

Paul M. Ziehler
PAUL M. ZIEHLER,
CITY CLERK/TREASURER



ORIGINAL

CERTIFIED SURVEY MAP NO. 7902

A re-division of Parcel 1 of Certified Survey Map No. 4522 in the Northeast 1/4 of the Southeast 1/4 of Section 7, Town 6 North, Range 21 East, in the City of West Allis, Milwaukee County, Wisconsin.

CITY CLERK'S CERTIFICATE

I, PAUL M. ZIEHLER, do hereby certify that I am the duly appointed, qualified City Administrative Officer Clerk/Treasurer of the City of West Allis, and the foregoing is a true and correct copy of a resolution adopted by the Common Council of the City of West Allis.

April 4, 2007
DATE

Paul M. Ziebler
PAUL M. ZIEHLER,
CITY ADMINISTRATIVE OFFICER
CLERK/TREASURER

CERTIFICATE OF CITY TREASURER

I, PAUL M. ZIEHLER, being the duly appointed, qualified City Administrative Officer and Treasurer of the City of West Allis do hereby certify that in accordance with the records in my office there are no unpaid special assessments as of April 4, 2007 on any of the lands included in this Certified Survey Map (Tax Key Number(s)) 520-9965-030.

April 4, 2007
DATE

Paul M. Ziebler
PAUL M. ZIEHLER,
CITY ADMINISTRATIVE OFFICER
CLERK/TREASURER

CERTIFICATE OF COUNTY TREASURER

Rex B. Queen
I, DANIEL DILIBERTI, being the duly elected, qualified and acting County Treasurer of the County of Milwaukee, do hereby certify that the records in my office show no unredeemed tax sales and no unpaid taxes or special assessments as of 4-5-07 on any of the lands included in this Certified Survey Map.

4-5-07
DATE

Rex B. Queen
DANIEL DILIBERTI, COUNTY TREASURER
REX B. QUEEN DEPUTY TREASURER



THIS INSTRUMENT WAS DRAWN BY JIM I. MORROW,
REGISTERED LAND SURVEYOR S-2777