

34.



City of West Allis Matter Summary

7525 W. Greenfield Ave.
West Allis, WI 53214

File Number	Title	Status
-------------	-------	--------

R-2011-0023 Resolution Introduced

Resolution to confirm and adopt the report of the Director of Public Works/City Engineer containing the schedule of proposed assessments for improvement of various alleys in the City of West Allis by removal and reconstruction of the concrete alley pavement storm sewer, storm sewer relay, building services, utility adjustments and storm underdrain.

Introduced: 2/1/2011

Controlling Body: Public Works Committee

Sponsor(s): Public Works Committee

COMMITTEE RECOMMENDATION

Adopt

ACTION DATE:	MOVER	SECONDER		AYE	NO	PRESENT	EXCUSED
<u>2/1/2011</u>			Barczak	✓			
			Czaplewski	✓			
			Kopplin				
			Lajsic				
			Narlock				
			Reinke				
	✓		Roadt	✓			
			Sengstock	✓			
			Vitale				
		✓	Weigel	✓			
			TOTAL	<u>5</u>	<u>—</u>		<u>—</u>

SIGNATURE OF COMMITTEE MEMBER

Henry Barczak

Chair

Vice-Chair

Member

COMMON COUNCIL ACTION

ADOPT

ACTION DATE:	MOVER	SECONDER		AYE	NO	PRESENT	EXCUSED
<u>FEB 01 2011</u>	✓		Barczak	✓			
			Czaplewski	✓			
		✓	Kopplin	✓			
			Lajsic	✓			
			Narlock	✓			
			Reinke	✓			
			Roadt	✓			
			Sengstock	✓			
			Vitale	✓			
			Weigel	✓			
			TOTAL	<u>10</u>	<u>—</u>		<u>—</u>



City of West Allis

7525 W. Greenfield Ave.
West Allis, WI 53214

Resolution

File Number: R-2011-0023

Final Action:

Sponsor(s): Public Works Committee

FEB 01 2011

Resolution to confirm and adopt the report of the Director of Public Works/City Engineer containing the schedule of proposed assessments for improvement of various alleys in the City of West Allis by removal and reconstruction of the concrete alley pavement, storm sewer, storm sewer relay, building services, utility adjustments and storm underdrain.

WHEREAS, The Director of Public Works/City Engineer, pursuant to Preliminary Resolution No. R-2010-0208, adopted on September 21, 2010, prepared and submitted his report as provided in sec. 66.0703(5) of the Wisconsin Statutes, for the improvement of the alleys as hereinafter described; and,

WHEREAS, The City Clerk/Treasurer gave due notice that such report was open for inspection at his office and also at the office of the Director of Public Works/City Engineer, and that all persons interested could appear before the Common Council and be heard concerning the matters contained in the Preliminary Resolution and Report; and,

WHEREAS, The Common Council met pursuant to such notice, at the time and place therein named; and having considered all statements and communications concerning the proposed improvements, relating to the matters contained in the Director of Public Works/City Engineer's report, including the schedule of proposed assessments, the Common Council makes no change in said report.

NOW, THEREFORE, BE IT RESOLVED By the Common Council of the City of West Allis

The report of the Director of Public Works/City Engineer, including the schedule of the proposed assessments, for the improvement of:

N/S and E/W alley between S. 76 St. - S. 77 St.: W. Pierce St. to W. Walker St.

N/S alley between S. 73 St. - S. 74 St.: W. Walker St. to 314' north of W. Walker St.

N/S alley between S. 74 St. - S. 75 St.: W. Madison St. to W. Greenfield Ave.

N/S and E/W alley between S. 76 St. - S. 77 St.: W. Lapham St. to W. National Ave.

N/S alley between S. 74 St. - S. 75 St.: W. Hicks St. to W. Rogers St.

N/S alley between S. 92 St. - S. 93 St.: W. Montana Ave. to W. Dakota St.

N/S and E/W alley between S. 68 St. - S. 69 St.: W. National Ave. to W. Mitchell St.

N/S and E/W alley between S. 58 St. - S. 59 St.: W. Grant St. to W. Lincoln Ave.

N/S and E/W alley between S. 56 St. - S. 57 St.: W. Burnham St. to W. Rogers St.

N/S alley between S. 57 St. - S. 58 St.: W. Mobile St. to W. Grant St.

N/S and E/W alley between S. 56 St. - S. 57 St.: W. Rogers St. to W. Mobile St.

N/S and E/W alley between S. 57 St. - S. 58 St.: W. Rogers St. to W. Mobile St.
N/S and E/W alley between S. 58 St. - S. 59 St.: W. National Ave. to W. Greenfield Ave.
N/S and E/W alley between S. 56 St. - S. 57 St.: W. Washington St. to W. National Ave.
N/S alley between S. 56 St. - S. 57 St.: W. Mineral St. to W. Washington St.

by removal and reconstruction of the concrete alley pavement, storm sewer, storm sewer relay, building services, utility adjustments and storm underdrain. be and the same is hereby approved and adopted.

2. The property against which the assessments are proposed is benefited; the assessments shown on the report are true and correct, have been determined on a reasonable basis and are hereby confirmed.

3. The Director of Public Works/City Engineer is hereby authorized and directed to prepare final plans for the aforesaid area in accordance with the terms of this resolution.

EngP1101A-P1115A

ADOPTED FEB 01 2011

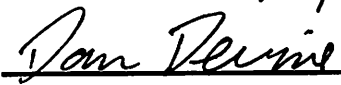
Paul M. Ziehler, City Admin. Officer, Clerk/Treas.

APPROVED 2/3/11

Dan Devine, Mayor



ENGINEERING DEPARTMENT

Michael G. Lewis

Director of Public Works / City Engineer

414/302-8360

414/302-8366 (Fax)

City Hall

7525 West Greenfield Avenue

West Allis, Wisconsin 53214

www.ci.west-allis.wi.us

mlewis@ci.west-allis.wi.us

February 1, 2011

Honorable Mayor and Common Council
West Allis, Wisconsin

Dear Mayor and Council Members:

I herewith respectfully submit my report on the assessment of benefits for removal and reconstruction of the concrete alley pavement, storm sewer, storm sewer relay, building services, utility adjustments and storm underdrain in:

N/S and E/W alley between S. 76 St. – S. 77 St.: W. Pierce St. to W. Walker St.
N/S alley between S. 73 St. – S. 74 St.: W. Walker St. to 314' north of W. Walker St.
N/S alley between S. 74 St. – S. 75 St.: W. Madison St. to W. Greenfield Ave.
N/S and E/W alley between S. 76 St. – S. 77 St.: W. Lapham St. to W. National Ave.
N/S alley between S. 74 St. – S. 75 St.: W. Hicks St. to W. Rogers St.
N/S alley between S. 92 St. – S. 93 St.: W. Montana Ave. to W. Dakota St.
N/S and E/W alley between S. 68 St. – S. 69 St.: W. National Ave. to W. Mitchell St.
N/S and E/W alley between S. 58 St. – S. 59 St.: W. Grant St. to W. Lincoln Ave.
N/S and E/W alley between S. 56 St. – S. 57 St.: W. Burnham St. to W. Rogers St.
N/S alley between S. 57 St. – S. 58 St.: W. Mobile St. to W. Grant St.
N/S and E/W alley between S. 56 St. – S. 57 St.: W. Rogers St. to W. Mobile St.
N/S and E/W alley between S. 57 St. – S. 58 St.: W. Rogers St. to W. Mobile St.
N/S and E/W alley between S. 58 St. – S. 59 St.: W. National Ave. to W. Greenfield Ave.
N/S and E/W alley between S. 56 St. – S. 57 St.: W. Washington St. to W. National Ave.
N/S alley between S. 56 St. – S. 57 St.: W. Mineral St. to W. Washington St.

as directed in Preliminary Resolution No. R-2010-0208, adopted on September 21, 2010.

This report consists of the following schedules attached hereto:

- Schedule A. - Preliminary Plans and Specifications;
- Schedule B. - Estimate of Entire Cost of Proposed Improvements;
- Schedule C. - Schedule of Proposed Assessments Against Each Parcel Affected.

The properties against which the assessments are proposed are benefited.

Respectfully submitted,

A handwritten signature in black ink, appearing to read "Michael G. Lewis".

Michael G. Lewis, P.E.
Director of Public Works/City Engineer

MGL:ns
Encs.

PROPOSED IMPROVEMENT OF

N/S and E/W alley between S. 76 St. – S. 77 St.: W. Pierce St. to W. Walker St.
N/S alley between S. 73 St. – S. 74 St.: W. Walker St. to 314' north of W. Walker St.
N/S alley between S. 74 St. – S. 75 St.: W. Madison St. to W. Greenfield Ave.
N/S and E/W alley between S. 76 St. – S. 77 St.: W. Lapham St. to W. National Ave.
N/S alley between S. 74 St. – S. 75 St.: W. Hicks St. to W. Rogers St.
N/S alley between S. 92 St. – S. 93 St.: W. Montana Ave. to W. Dakota St.
N/S and E/W alley between S. 68 St. – S. 69 St.: W. National Ave. to W. Mitchell St.
N/S and E/W alley between S. 58 St. – S. 59 St.: W. Grant St. to W. Lincoln Ave.
N/S and E/W alley between S. 56 St. – S. 57 St.: W. Burnham St. to W. Rogers St.
N/S alley between S. 57 St. – S. 58 St.: W. Mobile St. to W. Grant St.
N/S and E/W alley between S. 56 St. – S. 57 St.: W. Rogers St. to W. Mobile St.
N/S and E/W alley between S. 57 St. – S. 58 St.: W. Rogers St. to W. Mobile St.
N/S and E/W alley between S. 58 St. – S. 59 St.: W. National Ave. to W. Greenfield Ave.
N/S and E/W alley between S. 56 St. – S. 57 St.: W. Washington St. to W. National Ave.
N/S alley between S. 56 St. – S. 57 St.: W. Mineral St. to W. Washington St.

by removal and reconstruction of the concrete alley pavement, storm sewer, storm sewer relay,
building services, utility adjustments and storm underdrain.

SCHEDULE "A"

Preliminary Plans & Specifications Attached

SCHEDULE "B"

Estimate of the Entire Cost

\$861,000

SCHEDULE "C"

Schedule of Proposed Assessments
Against Each Parcel Affected

W. PIERCE ST.

ALLEY #1

S. 77 ST.

S. 76 ST.

W. WALKER ST.



ALLEY #2

S. 74 ST.

S. 73 ST.



W. WALKER ST.

W. MADISON ST.

S. 75 ST.

S. 74 ST.



ALLEY #3

W. LAPHAM ST.

ST.

S. 77 ST.

S. 76 ST.

ALLEY #4

W. NATIONAL

ALLE.



W. HICKS ST.

S. 75 ST.

S. 74 ST.

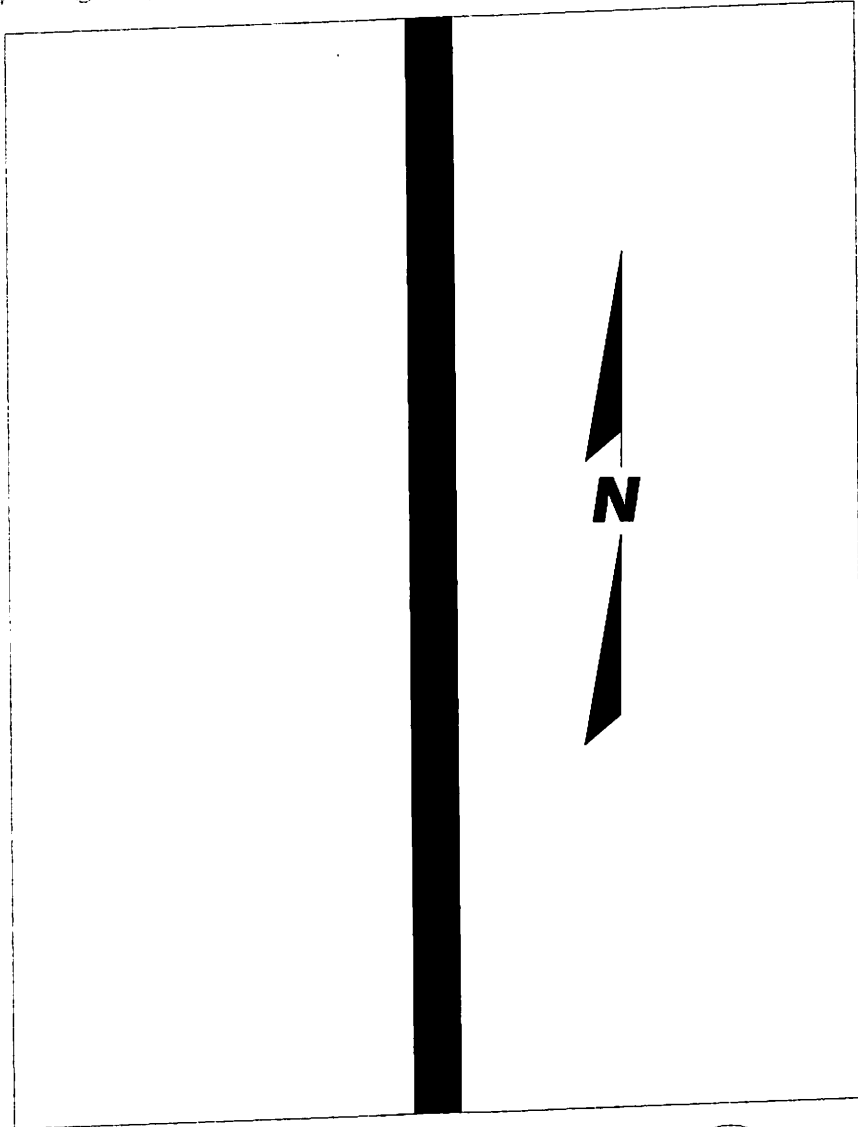

W. ROGERS ST.

ALLEY #5

ALLEY #6

W. MONTANA AVE.

S. 93 ST.

S. 92 ST.



W. DAKOTA ST.

ALLEY #7

W. NATIONAL AVE.

S. 69 ST.

S. 68 ST.



W. MITCHELL ST.

W. GRANT ST.

S. 59 ST.

S. 58 ST.



ALLEY #8

W. LINCOLN AVE.

W. BURNHAM ST.

S. 57 ST.

S. 56 ST.

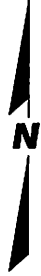

ALLEY #9

W. ROGERS ST.

11. MOBILE ST.

S. 58 ST.

S. 57 ST.

N

W. GRANT ST.

W. ROGERS ST.

ALLEY #11

S. 57 ST.

S. 56 ST.



11. MOBILE ST.

W. ROGERS ST.

ALLEY #12

S. 58 ST.

S. 57 ST.

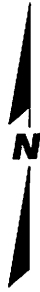

H. MOBILE ST.

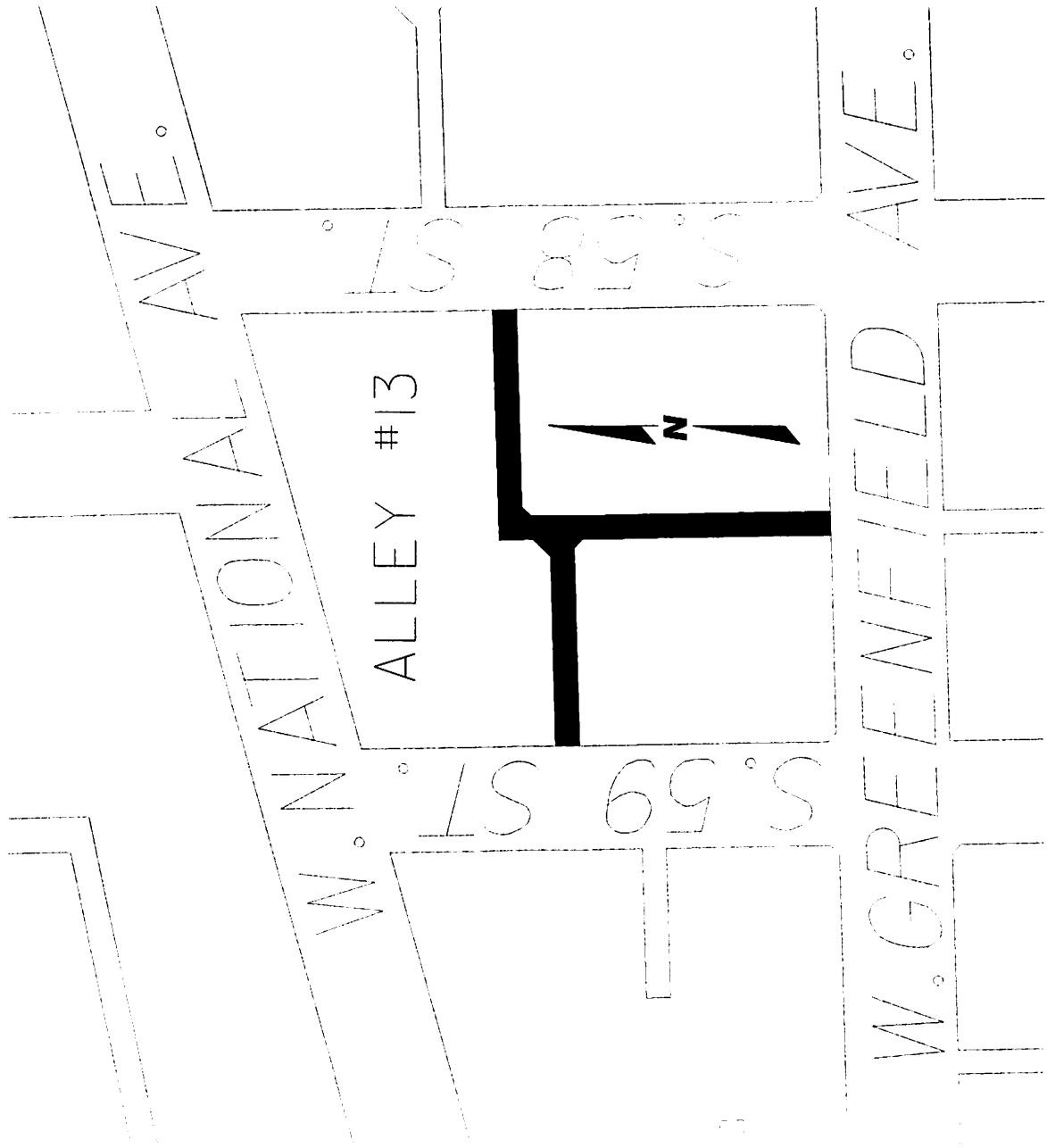

W. WASHINGTON ST.

S. 57 ST.

S. 56 ST.



ALLEY #14

W. NATIONAL AVE.

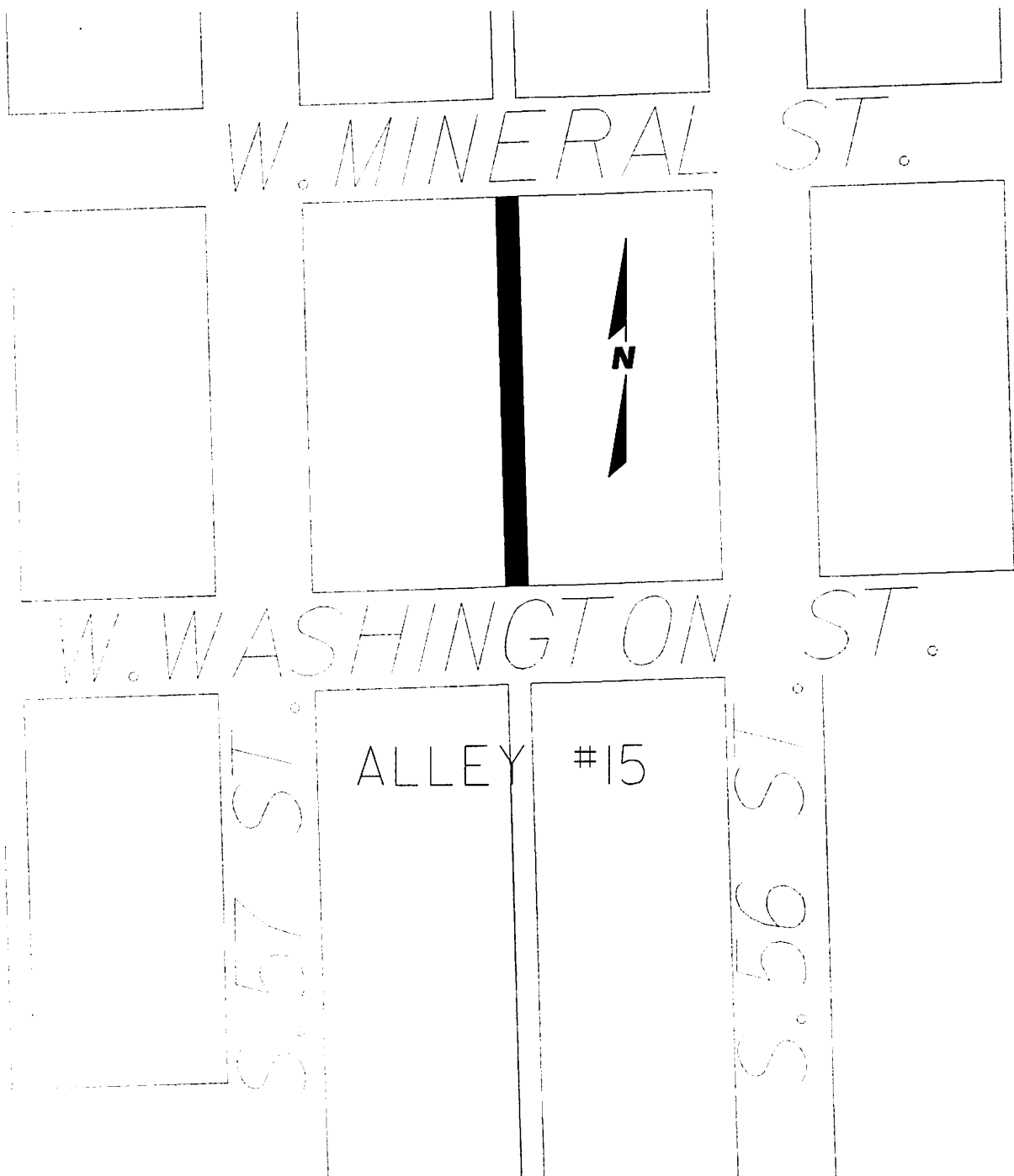



ENGINEERING DEPARTMENT

Michael G. Lewis

Director of Public Works / City Engineer

414/302-8360

414/302-8366 (Fax)

City Hall

7525 West Greenfield Avenue

West Allis, Wisconsin 53214

www.ci.west-allis.wi.us

mlewis@ci.west-allis.wi.us

February 1, 2011

Board of Public Works
West Allis City Hall
West Allis, Wisconsin

Dear Board Members:

I am herewith submitting preliminary plans and an estimate of costs for the removal and reconstruction of the concrete alley pavement, storm sewer, storm sewer relay, building services, utility adjustments and storm underdrain in:

- N/S and E/W alley between S. 76 St. - S. 77 St.: W. Pierce St. to W. Walker St.
N/S alley between S. 73 St. - S. 74 St.: W. Walker St. to 314' north of W. Walker St.
N/S alley between S. 74 St. - S. 75 St.: W. Madison St. to W. Greenfield Ave.
N/S and E/W alley between S. 76 St. - S. 77 St.: W. Lapham St. to W. National Ave.
N/S alley between S. 74 St. - S. 75 St.: W. Hicks St. to W. Rogers St.
N/S alley between S. 92 St. - S. 93 St.: W. Montana Ave. to W. Dakota St.
N/S and E/W alley between S. 68 St. - S. 69 St.: W. National Ave. to W. Mitchell St.
N/S and E/W alley between S. 58 St. - S. 59 St.: W. Grant St. to W. Lincoln Ave.
N/S and E/W alley between S. 56 St. - S. 57 St.: W. Burnham St. to W. Rogers St.
N/S alley between S. 57 St. - S. 58 St.: W. Mobile St. to W. Grant St.
N/S and E/W alley between S. 56 St. - S. 57 St.: W. Rogers St. to W. Mobile St.
N/S and E/W alley between S. 57 St. - S. 58 St.: W. Rogers St. to W. Mobile St.
N/S and E/W alley between S. 58 St. - S. 59 St.: W. National Ave. to W. Greenfield Ave.
N/S and E/W alley between S. 56 St. - S. 57 St.: W. Washington St. to W. National Ave.
N/S alley between S. 56 St. - S. 57 St.: W. Mineral St. to W. Washington St.

Table with 2 columns: Description, Amount. Rows: Estimated Construction Cost (\$ 783,000), Contingency (78,000), TOTAL (\$ 861,000)

Sincerely,

Handwritten signature of Michael G. Lewis

Michael G. Lewis, P.E.
Director of Public Works/City Engineer

MGL:ns

ASSESSMENT REPORT FOR COUNCIL

HEARING DATE: February 1, 2011

LOCATION

DESCRIPTION:

- N/S and E/W alley between S. 76 St. – S. 77 St.: W. Pierce St. to W. Walker St.
- N/S alley between S. 73 St. – S. 74 St.: W. Walker St. to 314' north of W. Walker St.
- N/S alley between S. 74 St. – S. 75 St.: W. Madison St. to W. Greenfield Ave.
- N/S and E/W alley between S. 76 St. – S. 77 St.: W. Lapham St. to W. National Ave.
- N/S alley between S. 74 St. – S. 75 St.: W. Hicks St. to W. Rogers St.
- N/S alley between S. 92 St. – S. 93 St.: W. Montana Ave. to W. Dakota St.
- N/S and E/W alley between S. 68 St. – S. 69 St.: W. National Ave. to W. Mitchell St.
- N/S and E/W alley between S. 58 St. – S. 59 St.: W. Grant St. to W. Lincoln Ave.
- N/S and E/W alley between S. 56 St. – S. 57 St.: W. Burnham St. to W. Rogers St.
- N/S alley between S. 57 St. – S. 58 St.: W. Mobile St. to W. Grant St.
- N/S and E/W alley between S. 56 St. – S. 57 St.: W. Rogers St. to W. Mobile St.
- N/S and E/W alley between S. 57 St. – S. 58 St.: W. Rogers St. to W. Mobile St.
- N/S and E/W alley between S. 58 St. – S. 59 St.: W. National Ave. to W. Greenfield Ave.
- N/S and E/W alley between S. 56 St. – S. 57 St.: W. Washington St. to W. National Ave.
- N/S alley between S. 56 St. – S. 57 St.: W. Mineral St. to W. Washington St.

ACCOUNT NO.: P1101A – P1115A

INTEREST RATE: 4.0%

<u>2011 ASSESSMENT RATES</u>	<u>Resid.</u>	<u>Comm.</u>	<u>Mfg.</u>
<u>Alley</u>			
Concrete Reconstruct, 14', lin. ft.	\$23.29	\$29.11	\$34.93
Concrete Reconstruct, 15', lin. ft.	\$24.07	\$30.08	
Concrete Reconstruct, 18', lin. ft.	\$26.43	\$33.04	
Concrete Reconstruct, 20', lin. ft.	\$28.02	\$35.03	

The properties against which the assessments are proposed are benefited.



City of West Allis Engineering Department

Project Details P1101A

N/S and E/W alley between S. 76 St. - S. 77 St.; W. Pierce St. to W. Walker St.

Property Assessments

Assessment ID	Description	Owner	Area	Rate	Exempt	Local	Total	Category	Value
441-0001-001	800 Block S 77 ST & 7600 W PIERCE ST	West Allis City of						Exempt Local	10
	Alley 14' Concrete Reconstruction		23.29 x 85.00 Lin Ft	= \$	1,979.65	0.00	\$ 0.00		
	Reduction Code Exempt								
	Exempt Property Charged as Residential								
	Alley 14' Concrete Reconstruction		23.29 x 134.00 Lin Ft	= \$	3,120.86	0.00	\$ 0.00		
	Reduction Code Exempt								
	Exempt Property Charged as Residential								
							Total: \$ 0.00		
441-0002-000	837 S 76 ST	Brian D. Becker						Residential	20
	Alley 14' Concrete Reconstruction		23.29 x 42.50 Lin Ft	= \$	989.82	100.00	\$ 989.82		
							Total: \$ 989.82		
441-0003-000	843 S 76 ST	Patricia A. Becker						Residential	30
	Alley 14' Concrete Reconstruction		23.29 x 63.75 Lin Ft	= \$	1,484.74	100.00	\$ 1,484.74		
							Total: \$ 1,484.74		
441-0004-000	851 S 76 ST	Daniel J. Rademan & Suzette L. Bloedel						Residential	40
	Alley 14' Concrete Reconstruction		23.29 x 63.75 Lin Ft	= \$	1,484.74	100.00	\$ 1,484.74		
							Total: \$ 1,484.74		
441-0005-000	859 S 76 ST	James C. Carpenter & Kaye Carpenter						Residential	50
	Alley 14' Concrete Reconstruction		23.29 x 42.50 Lin Ft	= \$	989.82	100.00	\$ 989.82		
							Total: \$ 989.82		
441-0006-000	865 S 76 ST	Stefaniak Elizabeth J Trust						Residential	60
	Alley 14' Concrete Reconstruction		23.29 x 42.50 Lin Ft	= \$	989.82	100.00	\$ 989.82		
							Total: \$ 989.82		



City of West Allis Engineering Department

Project Details P1101A

N/S and E/W alley between S. 76 St. - S. 77 St.; W. Pierce St. to W. Walker St.

441-0007-000	871 S 76 ST	Carey Diane M Trust				Residential	70
	Alley 14' Concrete Reconstruction		23.29 x	42.50 Lin Ft	= \$	989.82 100.00 \$	989.82
						Total: \$	<u>989.82</u>
441-0016-000	824-826 S 77 ST	Shawn Budiac				Residential	80
	Alley 14' Concrete Reconstruction		23.29 x	37.00 Lin Ft	= \$	861.73 100.00 \$	861.73
	Alley 14' Concrete Reconstruction		23.29 x	120.00 Lin Ft	= \$	2,794.80 20.00 \$	558.96
	Reduction Code Longside					Total: \$	<u>1,420.69</u>
441-0015-000	830-832 S 77 ST	Daniel A. Hayes & Debra L. Hayes				Residential	90
	Alley 14' Concrete Reconstruction		23.29 x	37.00 Lin Ft	= \$	861.73 100.00 \$	861.73
						Total: \$	<u>861.73</u>
441-0014-000	834 S 77 ST	Sandra L. Lannert & Michael Fitzgerald				Residential	100
	Alley 14' Concrete Reconstruction		23.29 x	41.75 Lin Ft	= \$	972.36 100.00 \$	972.36
						Total: \$	<u>972.36</u>
441-0013-000	840 S 77 ST	Hill Lorraine M Trust				Residential	110
	Alley 14' Concrete Reconstruction		23.29 x	41.75 Lin Ft	= \$	972.36 100.00 \$	972.36
						Total: \$	<u>972.36</u>
441-0012-000	846 S 77 ST	Lynn Beahler & Darren Beahler				Residential	120
	Alley 14' Concrete Reconstruction		23.29 x	42.50 Lin Ft	= \$	989.82 100.00 \$	989.82
						Total: \$	<u>989.82</u>
441-0011-000	852 S 77 ST	Jessica N. Wagner				Residential	130
	Alley 14' Concrete Reconstruction		23.29 x	42.50 Lin Ft	= \$	989.82 100.00 \$	989.82
						Total: \$	<u>989.82</u>



City of West Allis Engineering Department

Project Details P1101A

N/S and E/W alley between S. 76 St. - S. 77 St.; W. Pierce St. to W. Walker St.

441-0010-000	858 S 77 ST	Sandra E. Perich				Residential	140
	Alley 14' Concrete Reconstruction		23.29 x	42.50 Lin Ft	= \$	989.82 100.00 \$	989.82
						Total: \$	989.82
441-0009-000	862 S 77 ST	Albert C. Sacramento & Maria I. Sacramento				Residential	150
	Alley 14' Concrete Reconstruction		23.29 x	42.50 Lin Ft	= \$	989.82 100.00 \$	989.82
						Total: \$	989.82
441-0008-000	7624 W WALKER ST	Susan C. Piontek				Residential	160
	Alley 14' Concrete Reconstruction		23.29 x	42.50 Lin Ft	= \$	989.82 100.00 \$	989.82
						Total: \$	989.82

Property Type Summary

16 Residential

Item Summary

	Total Quantity		Gross Total	Net Total
Alley 14'				
Concrete Reconstruction				
Residential	1,006.50	Lin Ft	\$23,441.35	\$16,105.00
			<u>\$23,441.35</u>	<u>\$16,105.00</u>
Grand Totals			\$23,441.35	\$16,105.00



City of West Allis Engineering Department

Project Details P1102A

N/S alley between S. 73 St. - S. 74 St.; W. Walker St. to 314' n/o W. Walker St.

Property Assessments

440-0007-000	833-835 S 73 ST	Michael A. Kesler & Jennifer N. Straetz	Residential	10
	Alley 15' Concrete Reconstruction	24.07 x 36.00 Lin Ft = \$	866.52 100.00 \$	866.52
			Total: \$	866.52
440-0008-000	837-839 S 73 ST	Stargate Investments LLC	Residential	20
	Alley 15' Concrete Reconstruction	24.07 x 36.00 Lin Ft = \$	866.52 100.00 \$	866.52
			Total: \$	866.52
440-0009-000	843-845 S 73 ST	Jerry Whiteley & Florisa Whiteley	Residential	30
	Alley 15' Concrete Reconstruction	24.07 x 36.00 Lin Ft = \$	866.52 100.00 \$	866.52
			Total: \$	866.52
440-0010-000	847-849 S 73 ST	Kenneth Wallner	Residential	40
	Alley 15' Concrete Reconstruction	24.07 x 36.00 Lin Ft = \$	866.52 100.00 \$	866.52
			Total: \$	866.52
440-0011-000	853-855 S 73 ST	Jeffrey L. Hamann	Residential	50
	Alley 15' Concrete Reconstruction	24.07 x 36.00 Lin Ft = \$	866.52 100.00 \$	866.52
			Total: \$	866.52
440-0012-001	857-859 S 73 ST	Charles Pankonen	Commercial	60
	Alley 15' Concrete Reconstruction	30.08 x 60.00 Lin Ft = \$	1,804.80 100.00 \$	1,804.80
			Total: \$	1,804.80
440-0014-002	7314 W WALKER ST	Jacqueline M. Thomson	Residential	70
	Alley 15' Concrete Reconstruction	24.07 x 50.00 Lin Ft = \$	1,203.50 100.00 \$	1,203.50
			Total: \$	1,203.50
440-0022-000	834 S 74 ST	Dawn P. Des Jardins	Residential	80
	Alley 15' Concrete Reconstruction	24.07 x 45.00 Lin Ft = \$	1,083.15 100.00 \$	1,083.15
			Total: \$	1,083.15



City of West Allis Engineering Department

Project Details P1102A

N/S alley between S. 73 St. - S. 74 St.; W. Walker St. to 314' n/o W. Walker St.

440-0021-000	840-842 S 74 ST	Christopher M. Peters & Peggy J. Peters	Residential	90
	Alley 15' Concrete Reconstruction	24.07 x 45.00 Lin Ft	= \$ 1,083.15 100.00 \$ 1,083.15	
			Total: \$ 1,083.15	
440-0020-000	844-846 S 74 ST	Edward D. Bomback & Carol Bomback	Residential	100
	Alley 15' Concrete Reconstruction	24.07 x 30.00 Lin Ft	= \$ 722.10 100.00 \$ 722.10	
			Total: \$ 722.10	
440-0019-000	848-850 S 74 ST	Richard Newton	Residential	110
	Alley 15' Concrete Reconstruction	24.07 x 30.00 Lin Ft	= \$ 722.10 100.00 \$ 722.10	
			Total: \$ 722.10	
440-0018-000	852-854 S 74 ST	Jeffrey J. Selec	Residential	120
	Alley 15' Concrete Reconstruction	24.07 x 30.00 Lin Ft	= \$ 722.10 100.00 \$ 722.10	
			Total: \$ 722.10	
440-0017-000	856-858 S 74 ST	Jeffrey W. Cottrell	Residential	130
	Alley 15' Concrete Reconstruction	24.07 x 45.00 Lin Ft	= \$ 1,083.15 100.00 \$ 1,083.15	
			Total: \$ 1,083.15	
440-0016-000	864 S 74 ST	Kathleen A. Sutton	Residential	140
	Alley 15' Concrete Reconstruction	24.07 x 45.00 Lin Ft	= \$ 1,083.15 100.00 \$ 1,083.15	
			Total: \$ 1,083.15	
440-0015-000	868-870 S 74 ST	Ryer Holdings LLC	Commercial	150
	Alley 15' Concrete Reconstruction	30.08 x 44.24 Lin Ft	= \$ 1,330.74 100.00 \$ 1,330.74	
			Total: \$ 1,330.74	

Property Type Summary

2	Commercial
13	Residential



City of West Allis Engineering Department

Project Details P1102A

N/S alley between S. 73 St. - S. 74 St.; W. Walker St. to 314' n/o W. Walker St.

Item Summary

	Total Quantity		Gross Total	Net Total
<hr/>				
Alley 15'				
Concrete Reconstruction				
Commercial	104.24	Lin Ft	\$3,135.54	\$3,135.54
Residential	500.00	Lin Ft	\$12,035.00	\$12,035.00
			<hr/>	<hr/>
			\$15,170.54	\$15,170.54
<hr/>				
Grand Totals			\$15,170.54	\$15,170.54



City of West Allis Engineering Department

Project Details P1103A

N/S alley between S. 74 St. - S. 75 St.; W. Madison St. to W. Greenfield Ave.

Property Assessments

440-0429-000	1301 S 74 ST & 7407 W MADISON ST	Jacqueline M. Todryk				Residential	10
	Alley 15' Concrete Reconstruction		24.07 x	36.54 Lin Ft	= \$	879.52 100.00 \$	879.52
						Total: \$	879.52
440-0428-000	1305 S 74 ST	Frederick J. Karol & Amanda L. Karol				Residential	20
	Alley 15' Concrete Reconstruction		24.07 x	30.00 Lin Ft	= \$	722.10 100.00 \$	722.10
						Total: \$	722.10
440-0427-000	1309 S 74 ST	Adam Patterson & Rachel Patterson				Residential	30
	Alley 15' Concrete Reconstruction		24.07 x	30.00 Lin Ft	= \$	722.10 100.00 \$	722.10
						Total: \$	722.10
440-0426-000	1313 S 74 ST	Brian Stoetzel & Kelly Stoetzel				Residential	40
	Alley 15' Concrete Reconstruction		24.07 x	30.00 Lin Ft	= \$	722.10 100.00 \$	722.10
						Total: \$	722.10
440-0425-000	1317 S 74 ST	Steve J. Wirtz				Residential	50
	Alley 15' Concrete Reconstruction		24.07 x	30.00 Lin Ft	= \$	722.10 100.00 \$	722.10
						Total: \$	722.10
440-0424-000	1321-1323 S 74 ST	Joseph J. Kirchner				Residential	60
	Alley 15' Concrete Reconstruction		24.07 x	30.00 Lin Ft	= \$	722.10 100.00 \$	722.10
						Total: \$	722.10
440-0423-002	1300 Block S 74 ST	West Allis City of				Exempt Local	70
	Alley 15' Concrete Reconstruction		24.07 x	295.00 Lin Ft	= \$	7,100.65 0.00 \$	0.00
	Exempt Property Charged as Residential					Total: \$	0.00



City of West Allis Engineering Department

Project Details P1103A

N/S alley between S. 74 St. - S. 75 St.; W. Madison St. to W. Greenfield Ave.

440-0399-000	1300 S 75 ST	Maximillian T. Blawat & Jennifer Blawat	Residential	80
	Alley 15' Concrete Reconstruction	24.07 x 36.60 Lin Ft	= \$ 880.96	100.00 \$ 880.96
			Total:	\$ 880.96
440-0400-000	1306 S 75 ST	Robert Shmauz & Veronica Shmauz	Residential	90
	Alley 15' Concrete Reconstruction	24.07 x 37.00 Lin Ft	= \$ 890.59	100.00 \$ 890.59
			Total:	\$ 890.59
440-0401-000	1310 S 75 ST	John L. Bendler	Residential	100
	Alley 15' Concrete Reconstruction	24.07 x 37.00 Lin Ft	= \$ 890.59	100.00 \$ 890.59
			Total:	\$ 890.59
440-0402-000	1314 S 75 ST	James Slivka & Maryanne Slivka	Residential	110
	Alley 15' Concrete Reconstruction	24.07 x 37.00 Lin Ft	= \$ 890.59	100.00 \$ 890.59
			Total:	\$ 890.59
440-0403-000	1320 S 75 ST	Justin Hoffmann	Residential	120
	Alley 15' Concrete Reconstruction	24.07 x 37.00 Lin Ft	= \$ 890.59	100.00 \$ 890.59
			Total:	\$ 890.59
440-0404-000	1324 S 75 ST	Raymond J. Miller & Tina Miller	Residential	130
	Alley 15' Concrete Reconstruction	24.07 x 38.00 Lin Ft	= \$ 914.66	100.00 \$ 914.66
			Total:	\$ 914.66
440-0405-000	1330 S 75 ST	Kurt J. Wolter & Colette Wolter	Residential	140
	Alley 15' Concrete Reconstruction	24.07 x 38.00 Lin Ft	= \$ 914.66	100.00 \$ 914.66
			Total:	\$ 914.66
440-0406-000	1336 S 75 ST	Tschabold Donald & Delose Trust	Residential	150
	Alley 15' Concrete Reconstruction	24.07 x 38.00 Lin Ft	= \$ 914.66	100.00 \$ 914.66
			Total:	\$ 914.66



City of West Allis Engineering Department

Project Details P1103A

N/S alley between S. 74 St. - S. 75 St.; W. Madison St. to W. Greenfield Ave.

440-0407-000	1340 S 75 ST	Terrence Bochte & Martha Bochte			Residential	160
	Alley 15' Concrete Reconstruction	24.07 x 38.00 Lin Ft	= \$	914.66	100.00	\$ 914.66
					Total:	\$ 914.66
440-0408-000	1346 S 75 ST	Karen T. Hart			Residential	170
	Alley 15' Concrete Reconstruction	24.07 x 45.00 Lin Ft	= \$	1,083.15	100.00	\$ 1,083.15
					Total:	\$ 1,083.15
440-0409-000	1352 S 75 ST	Steven Blatnik & Marykay Blatnik			Residential	180
	Alley 15' Concrete Reconstruction	24.07 x 45.00 Lin Ft	= \$	1,083.15	100.00	\$ 1,083.15
					Total:	\$ 1,083.15
440-0410-001	1300 Block S 75 ST	West Allis City of			Exempt Local	190
	Alley 15' Concrete Reconstruction	24.07 x 60.00 Lin Ft	= \$	1,444.20	0.00	\$ 0.00
	Exempt Property Charged as Residential				Total:	\$ 0.00

Property Type Summary

19 Residential



City of West Allis Engineering Department

Project Details P1103A

N/S alley between S. 74 St. - S. 75 St.; W. Madison St. to W. Greenfield Ave.

Item Summary

	Total Quantity		Gross Total	Net Total
Alley 15'				
Concrete Reconstruction				
Residential	968.14	Lin Ft	\$23,303.13	\$14,758.28
			<u>\$23,303.13</u>	<u>\$14,758.28</u>
Grand Totals			\$23,303.13	\$14,758.28



Property Assessments

452-0109-000	1601-1603 S 76 ST	Leslie R. Kloes				Residential		10
	Alley 14' Concrete Reconstruction		23.29	x	30.00 Lin Ft	= \$	698.70	100.00 \$ 698.70
							Total:	\$ 698.70
452-0110-000	1605-1607 S 76 ST	Todd A. Fritsche & Tonja L. Fritsche				Residential		20
	Alley 14' Concrete Reconstruction		23.29	x	35.00 Lin Ft	= \$	815.15	100.00 \$ 815.15
							Total:	\$ 815.15
452-0111-000	1609-1611 S 76 ST	Ramiro De Avila				Residential		30
	Alley 14' Concrete Reconstruction		23.29	x	45.00 Lin Ft	= \$	1,048.05	100.00 \$ 1,048.05
							Total:	\$ 1,048.05
452-0112-000	1617-1619 S 76 ST	Jason Janssen				Residential		40
	Alley 14' Concrete Reconstruction		23.29	x	40.00 Lin Ft	= \$	931.60	100.00 \$ 931.60
							Total:	\$ 931.60
452-0113-000	1621-1623 S 76 ST	Northshore Prop Mgmt & Renovation LLC				Residential		50
	Alley 14' Concrete Reconstruction		23.29	x	30.00 Lin Ft	= \$	698.70	100.00 \$ 698.70
							Total:	\$ 698.70
452-0114-000	1625 S 76 ST	Michael D. Warzala				Residential		60
	Alley 14' Concrete Reconstruction		23.29	x	45.00 Lin Ft	= \$	1,048.05	100.00 \$ 1,048.05
							Total:	\$ 1,048.05
452-0115-000	1633 S 76 ST	Christopher Kurtz & Melissa L. Kurtz				Residential		70
	Alley 14' Concrete Reconstruction		23.29	x	45.00 Lin Ft	= \$	1,048.05	100.00 \$ 1,048.05
	Alley 14' Concrete Reconstruction		23.29	x	120.00 Lin Ft	= \$	2,794.80	20.00 \$ 558.96
	Reduction Code Longside						Total:	\$ 1,607.01



City of West Allis Engineering Department

Project Details P1104A

N/S and E/W alley between S. 76 St. - S. 77 St.; W. Lapham St. to W. National Ave.

452-0124-000	1600 S 77 ST	Candace L. Schalk				Residential	80
	Alley 14' Concrete Reconstruction		23.29 x	30.00 Lin Ft	= \$	698.70 100.00 \$	698.70
						Total: \$	<u>698.70</u>
452-0123-000	1604 S 77 ST	Scott Travers & Kathleen Travers				Residential	90
	Alley 14' Concrete Reconstruction		23.29 x	45.00 Lin Ft	= \$	1,048.05 100.00 \$	1,048.05
						Total: \$	<u>1,048.05</u>
452-0122-000	1610-1612 S 77 ST	Michael J. Lustig Jr & Bernadette Lustig				Residential	100
	Alley 14' Concrete Reconstruction		23.29 x	45.00 Lin Ft	= \$	1,048.05 100.00 \$	1,048.05
						Total: \$	<u>1,048.05</u>
452-0121-002	1616 S 77 ST	Daniel Benson				Residential	110
	Alley 14' Concrete Reconstruction		23.29 x	30.00 Lin Ft	= \$	698.70 100.00 \$	698.70
						Total: \$	<u>698.70</u>
452-0121-001	1620-1622 S 77 ST	Nicholas C. Bryan				Residential	120
	Alley 14' Concrete Reconstruction		23.29 x	30.00 Lin Ft	= \$	698.70 100.00 \$	698.70
						Total: \$	<u>698.70</u>
452-0120-000	1624 S 77 ST	Sean O. Kennedy & Monica R. Kennedy				Residential	130
	Alley 14' Concrete Reconstruction		23.29 x	60.00 Lin Ft	= \$	1,397.40 100.00 \$	1,397.40
						Total: \$	<u>1,397.40</u>
452-0119-000	1632 S 77 ST	Teresa A. McDowell				Residential	140
	Alley 14' Concrete Reconstruction		23.29 x	37.00 Lin Ft	= \$	861.73 100.00 \$	861.73
						Total: \$	<u>861.73</u>



City of West Allis Engineering Department

Project Details P1104A

N/S and E/W alley between S. 76 St. - S. 77 St.; W. Lapham St. to W. National Ave.

452-0118-001	1642 S 77 ST & 7608 W NATIONAL AVE	Church Jordan Ev Luth				Exempt Other	150
	Alley 14' Concrete Reconstruction	23.29 x	7.00 Lin Ft	= \$	163.03	100.00	\$ 163.03
	Exempt Property Charged as Residential						
	Alley 14' Concrete Reconstruction	23.29 x	104.00 Lin Ft	= \$	2,422.16	100.00	\$ 2,422.16
	Exempt Property Charged as Residential						
						Total:	\$ 2,585.19
452-0116-000	1647 S 76 ST	West Allis City of				Exempt Local	160
	Alley 14' Concrete Reconstruction	23.29 x	26.00 Lin Ft	= \$	605.54	0.00	\$ 0.00
	Exempt Property Charged as Residential						
						Total:	\$ 0.00

Property Type Summary

16 Residential

Item Summary

	Total Quantity	Gross Total	Net Total
Alley 14'			
Concrete Reconstruction			
Residential	804.00 Lin Ft	\$18,725.16	\$15,883.78
		\$18,725.16	\$15,883.78
Grand Totals		\$18,725.16	\$15,883.78



City of West Allis Engineering Department

Project Details P1105A

N/S alley between S. 74 St. - S. 75 St.; W. Hicks St. to W. Rogers St.

Property Assessments

453-0488-000	1943 S 74 ST	Daryl L. Olson & Jean M. Olson	Residential	10
	Alley 14' Concrete Reconstruction	23.29 x 32.00 Lin Ft = \$	745.28 100.00 \$	745.28
			Total: \$	745.28
453-0489-000	1947-1949 S 74 ST	Susan J. Sommerfeld	Residential	20
	Alley 14' Concrete Reconstruction	23.29 x 32.00 Lin Ft = \$	745.28 100.00 \$	745.28
			Total: \$	745.28
453-0490-000	1951 S 74 ST	Jamie L. Miller & Sherri Warwick	Residential	30
	Alley 14' Concrete Reconstruction	23.29 x 34.00 Lin Ft = \$	791.86 100.00 \$	791.86
			Total: \$	791.86
453-0491-000	1957 S 74 ST	Ronald Keith Stubbs	Residential	40
	Alley 14' Concrete Reconstruction	23.29 x 34.00 Lin Ft = \$	791.86 100.00 \$	791.86
			Total: \$	791.86
453-0492-000	1961 S 74 ST	Edward H. Goggins	Residential	50
	Alley 14' Concrete Reconstruction	23.29 x 34.50 Lin Ft = \$	803.50 100.00 \$	803.50
			Total: \$	803.50
453-0493-000	1965 S 74 ST	Fe V. Wissing & Clarinda R. Umandap	Residential	60
	Alley 14' Concrete Reconstruction	23.29 x 34.50 Lin Ft = \$	803.50 100.00 \$	803.50
			Total: \$	803.50
453-0494-000	1969 S 74 ST	Alfonso Vasquez	Residential	70
	Alley 14' Concrete Reconstruction	23.29 x 31.00 Lin Ft = \$	721.99 100.00 \$	721.99
			Total: \$	721.99
453-0495-000	1973 S 74 ST	Jason P. Poppe & Danielle K. Perinich	Residential	80
	Alley 14' Concrete Reconstruction	23.29 x 31.00 Lin Ft = \$	721.99 100.00 \$	721.99
			Total: \$	721.99



City of West Allis Engineering Department

Project Details P1105A

N/S alley between S. 74 St. - S. 75 St.; W. Hicks St. to W. Rogers St.

453-0496-000	1977 S 74 ST	Geoffrey A. Slater				Residential	90
	Alley 14' Concrete Reconstruction		23.29 x	31.00 Lin Ft	= \$	721.99 100.00 \$	721.99
						Total: \$	<u>721.99</u>
453-0497-000	1983 S 74 ST	David J. Krupski & Karen Krupski				Residential	100
	Alley 14' Concrete Reconstruction		23.29 x	31.90 Lin Ft	= \$	742.95 100.00 \$	742.95
						Total: \$	<u>742.95</u>
453-0506-000	7429 W HICKS ST	Gerald J. Gauthier				Residential	110
	Alley 14' Concrete Reconstruction		23.29 x	38.00 Lin Ft	= \$	885.02 100.00 \$	885.02
						Total: \$	<u>885.02</u>
453-0505-000	1948 S 75 ST	Kathy J. Radovich				Residential	120
	Alley 14' Concrete Reconstruction		23.29 x	41.00 Lin Ft	= \$	954.89 100.00 \$	954.89
						Total: \$	<u>954.89</u>
453-0504-000	1952-1954 S 75 ST	Sandra J. Miszczak & Linda M. Nelson				Residential	130
	Alley 14' Concrete Reconstruction		23.29 x	30.00 Lin Ft	= \$	698.70 100.00 \$	698.70
						Total: \$	<u>698.70</u>
453-0503-000	1956 S 75 ST	Richard L. Holcomb & Christine L. Holcomb				Residential	140
	Alley 14' Concrete Reconstruction		23.29 x	31.00 Lin Ft	= \$	721.99 100.00 \$	721.99
						Total: \$	<u>721.99</u>
453-0502-000	1960 S 75 ST	Scott H. Warner Jr & Margaret Ann Mc Cullough				Residential	150
	Alley 14' Concrete Reconstruction		23.29 x	31.00 Lin Ft	= \$	721.99 100.00 \$	721.99
						Total: \$	<u>721.99</u>
453-0501-000	1964 S 75 ST	Richard J. Silseth				Residential	160
	Alley 14' Concrete Reconstruction		23.29 x	31.00 Lin Ft	= \$	721.99 100.00 \$	721.99
						Total: \$	<u>721.99</u>



City of West Allis Engineering Department

Project Details P1105A

N/S alley between S. 74 St. - S. 75 St.; W. Hicks St. to W. Rogers St.

453-0500-000	1970 S 75 ST	Betty L. Thompson				Residential	170
	Alley 14' Concrete Reconstruction		23.29 x	42.00 Lin Ft	= \$	978.18 100.00 \$	978.18
						Total: \$	<u>978.18</u>
453-0499-000	1974-1976 S 75 ST	Donna Mae Vershowske				Residential	180
	Alley 14' Concrete Reconstruction		23.29 x	42.00 Lin Ft	= \$	978.18 100.00 \$	978.18
						Total: \$	<u>978.18</u>
453-0498-000	1982 S 75 ST	Brian Josephson				Residential	190
	Alley 14' Concrete Reconstruction		23.29 x	39.90 Lin Ft	= \$	929.27 100.00 \$	929.27
						Total: \$	<u>929.27</u>

Property Type Summary

19 Residential

Item Summary

	Total Quantity		Gross Total	Net Total
Alley 14'				
Concrete Reconstruction				
Residential	651.80	Lin Ft	\$15,180.41	\$15,180.41
			<u>\$15,180.41</u>	<u>\$15,180.41</u>
Grand Totals			\$15,180.41	\$15,180.41



City of West Allis Engineering Department

Project Details P1106A

N/S alley between S. 92 St. - S. 93 St.; W. Montana Ave. to W. Dakota St

Property Assessments

518-0001-000	2859 S 92 ST	John R. Hoesli & Rae Hoesli	Residential	10
	Alley 20' Concrete Reconstruction	28.02 x 65.64 Lin Ft	= \$ 1,839.23 100.00 \$ 1,839.23	
			Total: \$ 1,839.23	
518-0002-000	2867 S 92 ST	Paulette G. Krolikowski	Residential	20
	Alley 20' Concrete Reconstruction	28.02 x 62.00 Lin Ft	= \$ 1,737.24 100.00 \$ 1,737.24	
			Total: \$ 1,737.24	
518-0003-000	2875 S 92 ST	Jeffrey Kowalinski & Mary Kowalinski	Residential	30
	Alley 20' Concrete Reconstruction	28.02 x 62.00 Lin Ft	= \$ 1,737.24 100.00 \$ 1,737.24	
			Total: \$ 1,737.24	
518-0004-000	2881 S 92 ST	Brian Hoffmeier	Residential	40
	Alley 20' Concrete Reconstruction	28.02 x 62.00 Lin Ft	= \$ 1,737.24 100.00 \$ 1,737.24	
			Total: \$ 1,737.24	
518-0005-000	2887 S 92 ST	Gayle L. Hughes	Residential	50
	Alley 20' Concrete Reconstruction	28.02 x 62.00 Lin Ft	= \$ 1,737.24 100.00 \$ 1,737.24	
			Total: \$ 1,737.24	
518-0006-000	2893 S 92 ST	Anthony J. Pine	Residential	60
	Alley 20' Concrete Reconstruction	28.02 x 62.00 Lin Ft	= \$ 1,737.24 100.00 \$ 1,737.24	
			Total: \$ 1,737.24	
518-0007-000	2899 S 92 ST	Irene A. Searing & Gary F. Searing	Residential	70
	Alley 20' Concrete Reconstruction	28.02 x 62.00 Lin Ft	= \$ 1,737.24 100.00 \$ 1,737.24	
			Total: \$ 1,737.24	
518-0014-000	2858 S 93 ST	Wesley J. Froehlich & Rose M. Edwards	Residential	80
	Alley 20' Concrete Reconstruction	28.02 x 65.76 Lin Ft	= \$ 1,842.60 100.00 \$ 1,842.60	
			Total: \$ 1,842.60	



City of West Allis Engineering Department

Project Details P1106A

N/S alley between S. 92 St. - S. 93 St.; W. Montana Ave. to W. Dakota St

518-0013-000	2866 S 93 ST	Robert W. Peters & Marsha E. Peters		Residential	90
	Alley 20' Concrete Reconstruction	28.02 x 62.00 Lin Ft	= \$	1,737.24 100.00	\$ 1,737.24
				Total:	\$ 1,737.24
518-0012-000	2874 S 93 ST	Joseph J. Uhaley & James Uhaley		Residential	100
	Alley 20' Concrete Reconstruction	28.02 x 62.00 Lin Ft	= \$	1,737.24 100.00	\$ 1,737.24
	Wall Modular Block or Timber	19.04 x 93.00 Sq Ft	= \$	1,770.72 100.00	\$ 1,770.72
				Total:	\$ 3,507.96
518-0011-000	2880 S 93 ST	Ronald H. Kurt		Residential	110
	Alley 20' Concrete Reconstruction	28.02 x 62.00 Lin Ft	= \$	1,737.24 100.00	\$ 1,737.24
	Wall Modular Block or Timber	19.04 x 98.75 Sq Ft	= \$	1,880.20 100.00	\$ 1,880.20
				Total:	\$ 3,617.44
518-0010-000	2886 S 93 ST	David D. Ryan & Denise M. Ryan		Residential	120
	Alley 20' Concrete Reconstruction	28.02 x 62.00 Lin Ft	= \$	1,737.24 100.00	\$ 1,737.24
	Wall Modular Block or Timber	19.04 x 116.00 Sq Ft	= \$	2,208.64 100.00	\$ 2,208.64
				Total:	\$ 3,945.88
518-0009-000	2892 S 93 ST	Costa Liapis & Gail E. Liapis		Residential	130
	Alley 20' Concrete Reconstruction	28.02 x 62.00 Lin Ft	= \$	1,737.24 100.00	\$ 1,737.24
				Total:	\$ 1,737.24
518-0008-000	2898 S 93 ST	Leopold A. Krzyston		Residential	140
	Alley 20' Concrete Reconstruction	28.02 x 62.00 Lin Ft	= \$	1,737.24 100.00	\$ 1,737.24
				Total:	\$ 1,737.24

Property Type Summary

14 Residential



City of West Allis Engineering Department

Project Details P1106A

N/S alley between S. 92 St. - S. 93 St.; W. Montana Ave. to W. Dakota St.

Item Summary

	Total Quantity		Gross Total	Net Total
Alley 20'				
Concrete Reconstruction				
Residential	875.40	Lin Ft	\$24,528.71	\$24,528.71
			<u>\$24,528.71</u>	<u>\$24,528.71</u>
Wall				
Modular Block or Timber				
Residential	307.75	Sq Ft	\$5,859.56	\$5,859.56
			<u>\$5,859.56</u>	<u>\$5,859.56</u>
Grand Totals			\$30,388.27	\$30,388.27



City of West Allis Engineering Department

Project Details P1107A

N/S and E/W alley between S. 68 St. - S. 69 St.; W. National Ave. to W. Mitchell St.

Property Assessments

453-0584-000	1633 S 68 ST	Erik M. Huerta				Residential	10
	Alley 14' Concrete Reconstruction	23.29	x	30.00 Lin Ft	= \$	698.70 100.00 \$	698.70
	Alley 14' Concrete Reconstruction	23.29	x	117.60 Lin Ft	= \$	2,738.90 20.00 \$	547.78
	Reduction Code Longside						
						Total:	\$ 1,246.48
453-0583-000	1637 S 68 ST	Ruth Kressl				Residential	20
	Alley 14' Concrete Reconstruction	23.29	x	30.00 Lin Ft	= \$	698.70 100.00 \$	698.70
						Total:	\$ 698.70
453-0582-000	1641 S 68 ST	Thomas L. Lipp				Commercial	30
	Alley 14' Concrete Reconstruction	29.11	x	30.00 Lin Ft	= \$	873.30 100.00 \$	873.30
						Total:	\$ 873.30
453-0581-000	1645-1647 S 68 ST	Robert T. Wood & Lisa Kleiner-Wood				Residential	40
	Alley 14' Concrete Reconstruction	23.29	x	30.00 Lin Ft	= \$	698.70 100.00 \$	698.70
						Total:	\$ 698.70
453-0580-000	1649 S 68 ST	Julianne M. Opalewski				Residential	50
	Alley 14' Concrete Reconstruction	23.29	x	30.00 Lin Ft	= \$	698.70 100.00 \$	698.70
						Total:	\$ 698.70
453-0579-000	1653-1655 S 68 ST	Doris M Kuhar Trust				Residential	60
	Alley 14' Concrete Reconstruction	23.29	x	30.00 Lin Ft	= \$	698.70 100.00 \$	698.70
						Total:	\$ 698.70
453-0578-000	1657-1659 S 68 ST	Michael Madden				Residential	70
	Alley 14' Concrete Reconstruction	23.29	x	30.00 Lin Ft	= \$	698.70 100.00 \$	698.70
						Total:	\$ 698.70



City of West Allis Engineering Department
 Project Details P1107A

N/S and E/W alley between S. 68 St. - S. 69 St.; W. National Ave. to W. Mitchell St.

453-0577-001	1661 S 68 ST	David M. Bennett				Residential		80
	Alley 14' Concrete Reconstruction		23.29 x	60.00 Lin Ft	= \$	1,397.40	100.00	\$ 1,397.40
							Total:	\$ 1,397.40
453-0575-000	1669 S 68 ST	Taylor Bean & Whitaker Mortgage Corp				Residential		90
	Alley 14' Concrete Reconstruction		23.29 x	30.00 Lin Ft	= \$	698.70	100.00	\$ 698.70
							Total:	\$ 698.70
453-0569-000	1640 S 69 ST	Christine Morris				Residential		100
	Alley 14' Concrete Reconstruction		23.29 x	30.00 Lin Ft	= \$	698.70	100.00	\$ 698.70
	Alley 14' Concrete Reconstruction		23.29 x	120.00 Lin Ft	= \$	2,794.80	20.00	\$ 558.96
	Reduction Code Longside						Total:	\$ 1,257.66
453-0570-000	1644 S 69 ST	Geanice Gladney				Residential		110
	Alley 14' Concrete Reconstruction		23.29 x	30.00 Lin Ft	= \$	698.70	100.00	\$ 698.70
							Total:	\$ 698.70
453-0571-000	1648-1650 S 69 ST	Brian Bahr				Residential		120
	Alley 14' Concrete Reconstruction		23.29 x	30.00 Lin Ft	= \$	698.70	100.00	\$ 698.70
							Total:	\$ 698.70
453-0572-000	1652 S 69 ST	Mark A. Nisenbaum				Residential		130
	Alley 14' Concrete Reconstruction		23.29 x	60.00 Lin Ft	= \$	1,397.40	100.00	\$ 1,397.40
							Total:	\$ 1,397.40
453-0573-001	1660-1662 S 69 ST	Robert T. Boissonnault & Debra Boissonnault				Residential		140
	Alley 14' Concrete Reconstruction		23.29 x	30.00 Lin Ft	= \$	698.70	100.00	\$ 698.70
							Total:	\$ 698.70



City of West Allis Engineering Department

Project Details P1107A

N/S and E/W alley between S. 68 St. - S. 69 St.; W. National Ave. to W. Mitchell St.

453-0573-002	1664-1666 S 69 ST	Matthew P. Adamczyk				Residential	150
	Alley 14' Concrete Reconstruction	23.29 x	30.00 Lin Ft	= \$	698.70	100.00	\$ 698.70
						Total:	\$ 698.70
453-0574-000	1668 S 69 ST & 6828 W MITCHELL ST	Sally Neuenschwander				Residential	160
	Alley 14' Concrete Reconstruction	23.29 x	30.00 Lin Ft	= \$	698.70	100.00	\$ 698.70
						Total:	\$ 698.70
453-0565-000	6803 W NATIONAL AVE	Kevin M. Nugent & Vickie L. Nugent				Commercial	170
	Alley 14' Concrete Reconstruction	29.11 x	129.44 Lin Ft	= \$	3,768.00	100.00	\$ 3,768.00
						Total:	\$ 3,768.00
453-0566-000	1600 Block S 69 ST	Guy M. Robb				Commercial	180
	Alley 14' Concrete Reconstruction	29.11 x	60.00 Lin Ft	= \$	1,746.60	40.00	\$ 698.64
	Reduction Code Longside						
	Alley 14' Concrete Reconstruction	29.11 x	45.00 Lin Ft	= \$	1,309.95	100.00	\$ 1,309.95
						Total:	\$ 2,008.59
453-0567-000	6827 W NATIONAL AVE	Guy M. Robb				Commercial	190
	Alley 14' Concrete Reconstruction	29.11 x	45.00 Lin Ft	= \$	1,309.95	100.00	\$ 1,309.95
						Total:	\$ 1,309.95
453-0568-000	1628 S 69 ST & 6833 W NATIONAL AVE	Eppler Enterprises LLC				Commercial	200
	Alley 14' Concrete Reconstruction	29.11 x	30.00 Lin Ft	= \$	873.30	100.00	\$ 873.30
						Total:	\$ 873.30

Property Type Summary

5	Commercial
15	Residential



City of West Allis Engineering Department

Project Details P1107A

N/S and E/W alley between S. 68 St. - S. 69 St.; W. National Ave. to W. Mitchell St.

Item Summary

	Total Quantity		Gross Total	Net Total
<hr/>				
Alley 14'				
Concrete Reconstruction				
Commercial	339.44	Lin Ft	\$9,881.10	\$8,833.14
Residential	747.60	Lin Ft	\$17,411.60	\$12,984.64
			<hr/>	<hr/>
			\$27,292.70	\$21,817.78
<hr/>				
Grand Totals			\$27,292.70	\$21,817.78



Property Assessments

474-0387-000	2203 S 58 ST	Patricia A. Cronce				Residential	10
	Alley 14' Concrete Reconstruction		23.29	x	38.00 Lin Ft	= \$ 885.02	100.00 \$ 885.02
						Total: \$	885.02
474-0388-000	2207 S 58 ST	Patricia A. Brockel				Residential	20
	Alley 14' Concrete Reconstruction		23.29	x	40.00 Lin Ft	= \$ 931.60	100.00 \$ 931.60
						Total: \$	931.60
474-0389-000	2213-2215 S 58 ST	Kent B. Shy				Residential	30
	Alley 14' Concrete Reconstruction		23.29	x	40.00 Lin Ft	= \$ 931.60	100.00 \$ 931.60
						Total: \$	931.60
474-0390-000	2217 S 58 ST	Sharon A. Sindicic				Residential	40
	Alley 14' Concrete Reconstruction		23.29	x	40.00 Lin Ft	= \$ 931.60	100.00 \$ 931.60
						Total: \$	931.60
474-0391-001	2223 S 58 ST	Mark D. Schanning				Residential	50
	Alley 14' Concrete Reconstruction		23.29	x	30.00 Lin Ft	= \$ 698.70	100.00 \$ 698.70
						Total: \$	698.70
474-0391-002	2227-2229 S 58 ST	Jovan Prpa & Olivera Prpa				Residential	60
	Alley 14' Concrete Reconstruction		23.29	x	30.00 Lin Ft	= \$ 698.70	100.00 \$ 698.70
						Total: \$	698.70
474-0392-000	2231-2233 S 58 ST	Ian T. Huffman				Residential	70
	Alley 14' Concrete Reconstruction		23.29	x	30.00 Lin Ft	= \$ 698.70	100.00 \$ 698.70
						Total: \$	698.70
474-0393-000	2235 S 58 ST	Joyce A. Katona				Residential	80
	Alley 14' Concrete Reconstruction		23.29	x	30.00 Lin Ft	= \$ 698.70	100.00 \$ 698.70
						Total: \$	698.70



City of West Allis Engineering Department

Project Details P1108A

N/S and E/W alley between S. 58 St. - S. 59 St.; W. Grant St. to W. Lincoln Ave.

474-0394-000	2239 S 58 ST	Michael Robins				Residential	90
	Alley 14' Concrete Reconstruction		23.29 x	45.00 Lin Ft	= \$	1,048.05 100.00	\$ 1,048.05
						Total:	\$ 1,048.05
474-0395-000	2245 S 58 ST	Marson V J&J L Revoc Trust				Residential	100
	Alley 14' Concrete Reconstruction		23.29 x	45.00 Lin Ft	= \$	1,048.05 100.00	\$ 1,048.05
						Total:	\$ 1,048.05
474-0396-000	2253 S 58 ST	Jose Gonzalez & Maria Gonzalez				Residential	110
	Alley 14' Concrete Reconstruction		23.29 x	60.00 Lin Ft	= \$	1,397.40 100.00	\$ 1,397.40
						Total:	\$ 1,397.40
474-0397-000	2259 S 58 ST	Donald R. Rapp Jr & Julie A. Rapp				Residential	120
	Alley 14' Concrete Reconstruction		23.29 x	38.00 Lin Ft	= \$	885.02 100.00	\$ 885.02
	Alley 14' Concrete Reconstruction		23.29 x	120.00 Lin Ft	= \$	2,794.80 20.00	\$ 558.96
	Reduction Code Longside					Total:	\$ 1,443.98
474-0416-000	2200 S 59 ST	Timothy M. Grutzmacher & Jessica L. Grutzmac				Residential	130
	Alley 14' Concrete Reconstruction		23.29 x	38.00 Lin Ft	= \$	885.02 100.00	\$ 885.02
						Total:	\$ 885.02
474-0415-000	2206 S 59 ST	Jeffrey R. Elias & Mary Elias				Residential	140
	Alley 14' Concrete Reconstruction		23.29 x	30.00 Lin Ft	= \$	698.70 100.00	\$ 698.70
						Total:	\$ 698.70
474-0414-000	2210 S 59 ST	Leo P. Mandelin				Residential	150
	Alley 14' Concrete Reconstruction		23.29 x	30.00 Lin Ft	= \$	698.70 100.00	\$ 698.70
						Total:	\$ 698.70