



ENGINEERING DEPARTMENT

Michael G. Lewis
City Engineer

414/302-8360
414/302-8366 (Fax)

City Hall
7525 West Greenfield Avenue
West Allis, Wisconsin 53214

www.ci.west-allis.wi.us
mlewis@ci.west-allis.wi.us

June 12, 2008

Board of Public Works
City of West Allis
West Allis, WI 53214

**RE: Communication from City Engineer Regarding Extending Storm Sewer to
the backyard of 2117 96th Street**

Dear Board Members:

Attached is a plan showing the intended storm sewer extension. This property is the low point for a number of surrounding properties. We have inspected the property and agree that they have a water problem and it's affecting not only their property, but the 2115 96th property too. Unfortunately, there is no other solution but to extend storm sewer to their backyard. The assessment at 2117 and 2115 would be \$1,000 each. The Board has authorized similar work in the past and it's consistent with current policy. We are asking for approval of the project and to add this work to a future contract. It would be done this year.

Respectfully,

Michael G. Lewis
City Engineer

MGL/mgl

W. BECHER ST

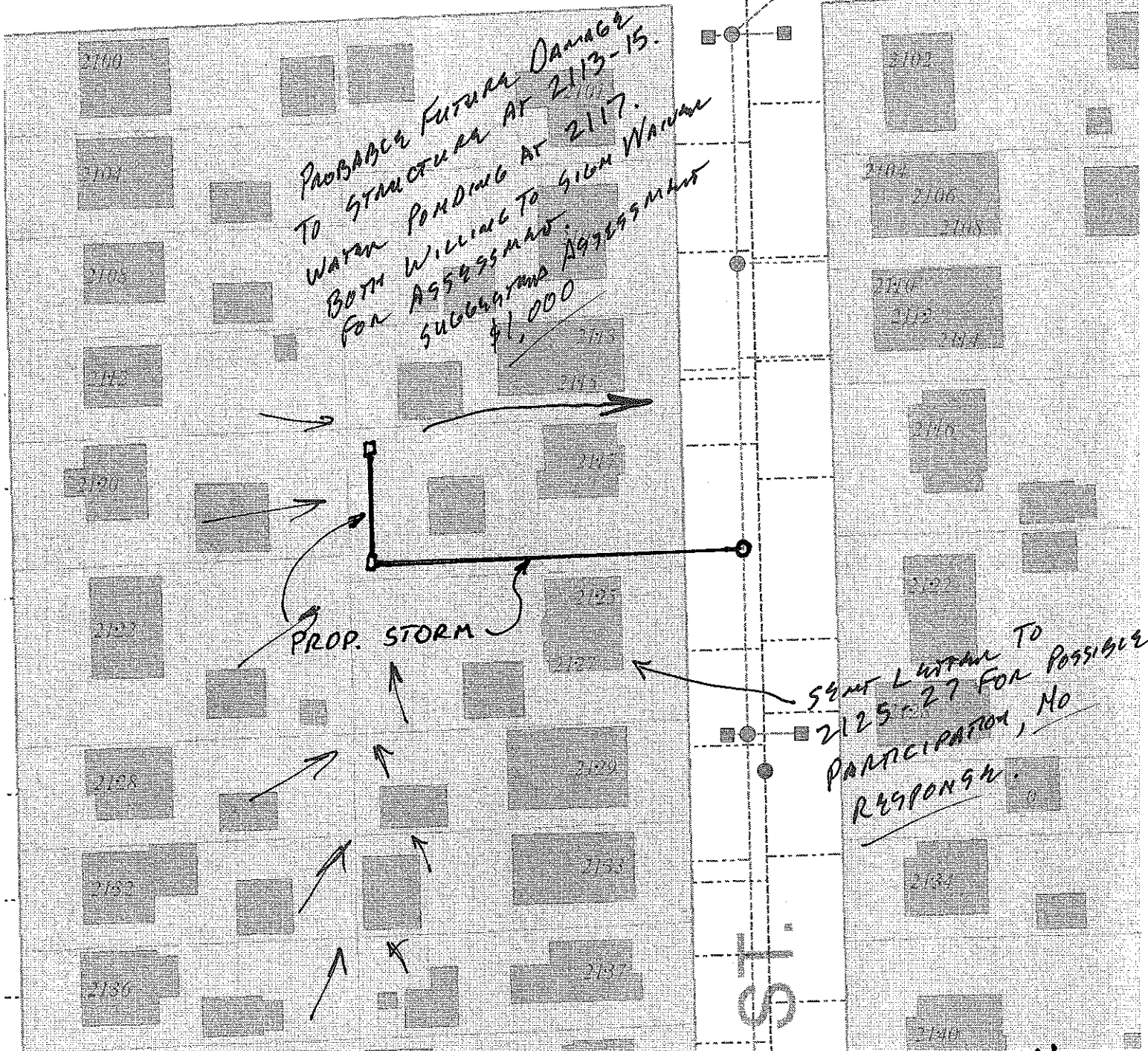

CONSTRUCTION ESTIMATE:

150 LIA. FT. OF 10" STORM @ \$70/LF	= 10,500
2 CATCH BASINS @ 1200	= 2,400
1 MANHOLE @ 1500	= 1,500
LAWN REPLACEMENT	= 2,000
PAVEMENT REPLACEMENT	= 800

TOTAL EST. COST = \$17,200

965

