



Expedited Temporary Extension of Class B Licensed Premises

Fill out the following application and submit to clerk@westalliswi.gov. A copy of the floor plan of the proposed extension along with a plan of the permanently licensed premises must be attached for the application to be processed.

Check List all license types: Class B Food Music/Entertainment, list type: _____

Name of Applicant: Sally Dollar

Trade Name: Barcode

Address of Premises: 2110 S. 60th St

Phone Number: 414-763-5644

Email Address: bdollar5735@att.net

Current Licensed Premises Description:
Indoor Tavern

Proposed Temporary Premises Description. Include any structures that will be erected on the outdoor premises (i.e.tents):
indoor tavern / outdoor fenced in patio w/ extension to roped off parking lot on special events - NO tents NO
(a copy of the floor plan for both current and proposed premises must accompany the application)

Identify the specific area(s) for which the special extension of premises is requested. Area must be contiguous to the current licensed premises. Check all that apply and select the location of the area (example: north side, front, etc.) Selling outside

Sidewalk café (public sidewalk) at the North South West East side of the premises

Patio (concrete surface) at the North South West East side of the premises

Beer garden (soil/grass surface) at the North South West East side of the premises

Deck (attached to building) at the North South West East side of the premises

Other: Describe area(s): _____

Does extension area have an additional street address? No Yes If yes, list address: _____

Hours of Operation for the **proposed** extension (may not be later than 9pm Sun – Thur; 10 pm Fri – Saturday)

Sunday	<u>6a</u>	to	<u>9p</u>	Thursday	<u>6a</u>	to	<u>9p</u>
Monday	<u>6a</u>	to	<u>9p</u>	Friday	<u>6a</u>	to	<u>10p</u>
Tuesday	<u>6a</u>	to	<u>9p</u>	Saturday	<u>6a</u>	to	<u>10p</u>
Wed.	<u>6a</u>	to	<u>9p</u>				

Your application will be considered at each council meeting until November 18 unless you inform the clerk that you wish to withdraw your application.

____ Occupancy ____ 2020 Proposed Inside Occupancy X 2020 Proposed Outside Occupancy

Number and Type of Toilet Facilities # of Women's Toilets 1 # of Men's Toilets 1
of Men's Urinals 1 # of Temporary Toilets _____



Expedited Temporary Extension of Class B Licensed Premises

I understand that the following conditions apply if granted the extension:

- The extended premises must be contiguous to the licensed premises and must either be owned by or be under the control of the licensee or extend on to a public sidewalk.
- The extended premises, other than premises extending on to a public sidewalk, shall be enclosed in a manner that the ingress and egress of patrons may be monitored.

I understand that the hours of operation are limited to the following:

- Sunday – Thursday operations must cease at 9:00 p.m.
- Friday – Saturday operations must cease at 10:00 p.m.

For applications requesting the use of public sidewalk:

I understand that the following conditions apply if granted the extension:

- Any premises extended into a public sidewalk may place only movable tables and chairs on that premises.
- The licensee shall maintain a clear path 3 feet wide for pedestrian traffic.
- The licensee assumes primary liability for damages to person or property. No bond is required.
- The licensee is obligated to immediately remove any obstructions upon notice by the city
- The licensee is not entitled to damages for removal of an obstruction, and if the licensee does not remove the obstruction upon notice, it may be removed at the licensee's expense.
- Third parties whose rights are interfered with by the granting of a privilege have a right of action against the licensee only.

I certify the information submitted in this application is true and understand that false statements or failure to adhere to the conditions may result in denial of future licenses/permits and/or revocation of this extension.

Applicant Name:

Sally R. Kae

Date:

3/22/21

Submit application to clerk@westalliswi.gov.

Submit Form

60th Street

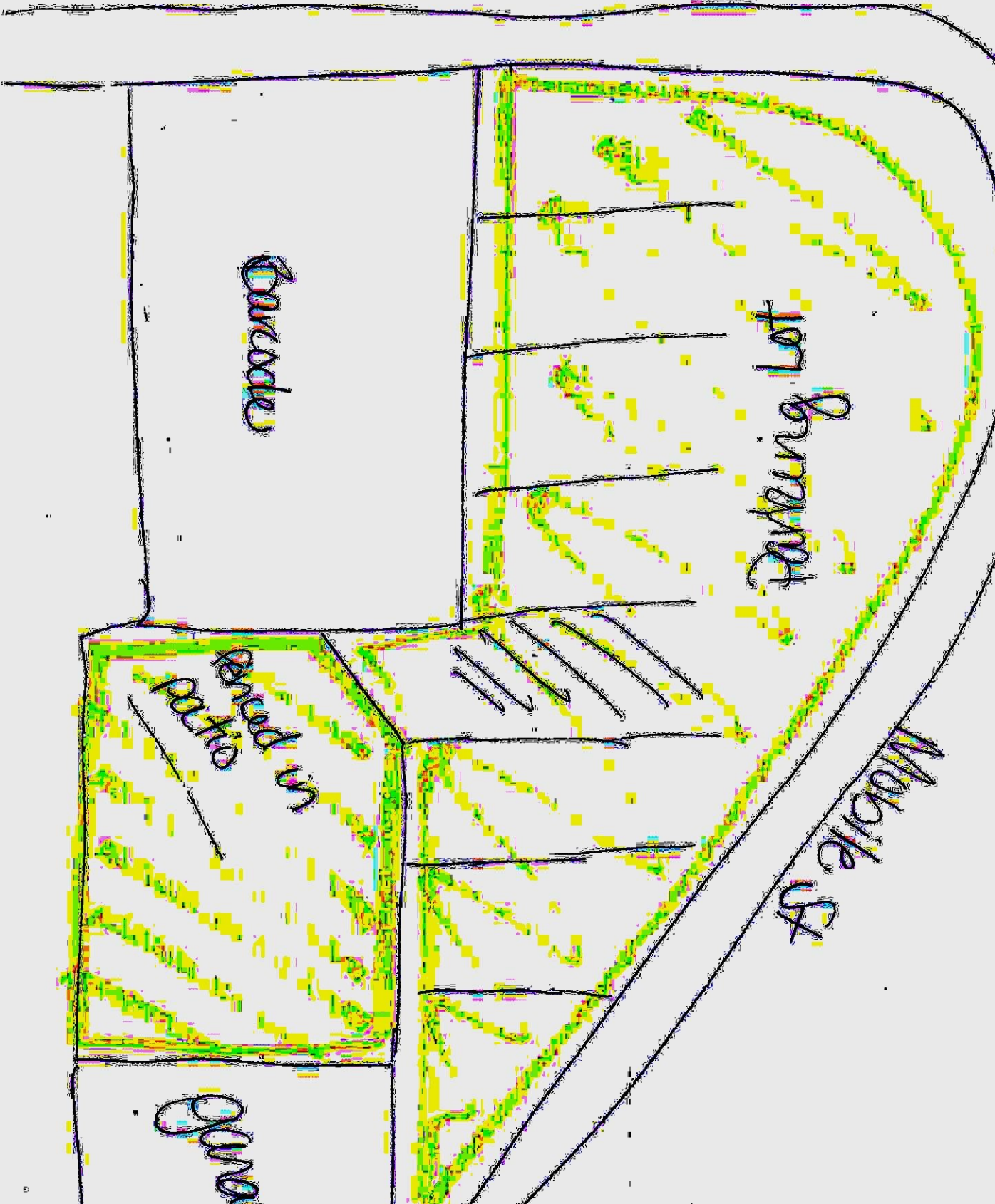

Garage

Parking Lot

Paved in patio

Garage

Market St