

43.
54.



City of West Allis Matter Summary

7525 W. Greenfield Ave.
West Allis, WI 53214

File Number **Title** **Status**

R-2008-0072 Resolution In Committee

Resolution approving a Certified Survey Map for proposed parcel combination for Heartbreakers, an existing business located at 9440-42 W. National Ave., submitted by Dominic LaLicata, Cugino's Entertainment, LLC. (Tax Key No. 479-0676-002).

Introduced: 3/18/2008

Controlling Body: Safety & Development Committee

Sponsor(s): Safety & Development Committee

COMMITTEE RECOMMENDATION ADOPT AS Amended

ACTION DATE:	MOVER	SECONDER		AYE	NO	PRESENT	EXCUSED
<u>3/31/08</u>			Barczak	✓			
			Czaplewski				
			Dobrowski				
			Kopplin				
			Lajsic	✓			
			Narlock				
			Reinke	✓			
			Sengstock				
	✓		Vitale	✓			
			Weigel	✓			
			TOTAL	<u>5</u>	<u>0</u>		

SIGNATURE OF COMMITTEE MEMBER

[Signature] _____
Chair Vice-Chair Member

COMMON COUNCIL ACTION adopt as amended

ACTION DATE:	MOVER	SECONDER		AYE	NO	PRESENT	EXCUSED
<u>3-31-08</u>			Barczak	✓			
			Czaplewski	✓			
			Dobrowski	✓			
			Kopplin	✓			
		✓		Lajsic	✓		
				Narlock	✓		
				Reinke	✓		
				Sengstock	✓		
			Vitale	✓			
			Weigel	✓			
			TOTAL	<u>10</u>	<u>—</u>		



City of West Allis

7525 W. Greenfield Ave.
West Allis, WI 53214

Resolution

File Number: R-2008-0072

Final Action:

Sponsor(s): Safety & Development Committee

Resolution approving a Certified Survey Map for proposed parcel combination for Heartbreakers, an existing business located at 9440-42 W. National Ave., submitted by Dominic LaLicata, Cugino's Entertainment, LLC. (Tax Key No. 479-0676-002).

WHEREAS, Dominic LaLicata, Cugino's Entertainment, LLC., submitted a Certified Survey Map for proposed parcel combination for Heartbreakers, an existing business located at 9440-42 W. National Ave.

BE IT RESOLVED by the ^{the city} Common Council of the City of West Allis, Wisconsin, that the Certified Survey Map of a parcel of land in the Southeast 1/4 of Section 5, Township 6 North, Range 21 East, in the City of West Allis, County of Milwaukee, Wisconsin, be and the same is hereby adopted ~~upon completion of the proposed remodeled Certified Survey Map~~ ^{ing} surrendered to Clerks ~~and not more than a year from date~~ & if not this conditional approval is ~~resolution~~ ^{revoked}.

ADOPTED _____

APPROVED _____

Paul M. Ziehler, City Admin. Officer, Clerk/Treas.

Jeannette Bell, Mayor

Whereas there are currently two Class B liquor licenses for the premises & whereas the filing of this ~~map~~ Certified Survey Map will make one of the licenses superfluous & contrary to State law & Municipal Ordinance.

one Class B liquor license shall be

Be it further Resolved that

revoked

of this conditional approval



City of West Allis

7525 W. Greenfield Ave.
West Allis, WI 53214

Resolution

File Number: R-2008-0072

Final Action: 3/31/2008

Sponsor(s): Safety & Development Committee

Resolution approving a Certified Survey Map for proposed parcel combination for Heartbreakers, an existing business located at 9440-42 W. National Ave., submitted by Dominic LaLicata, Cugino's Entertainment, LLC. (Tax Key No. 479-0676-002).

WHEREAS, Dominic LaLicata, Cugino's Entertainment, LLC., submitted a Certified Survey Map for proposed parcel combination for Heartbreakers, an existing business located at 9440-42 W. National Ave.

WHEREAS, there are currently two Class B Liquor Licenses for the premises and whereas, the filing of this Certified Survey Map will make one of the licenses superfluous and contrary to state law and municipal ordinance.

BE IT RESOLVED by the Common Council of the City of West Allis, Wisconsin, that the Certified Survey Map of a parcel of land in the Southeast 1/4 of Section 5, Township 6 North, Range 21 East, in the City of West Allis, County of Milwaukee, Wisconsin, be and the same is hereby adopted.

BE IT FURTHER RESOLVED that upon completion of the proposed remodeling, one Class B Liquor License shall be surrendered to the City Clerk not more than a year from date of this conditional approval and if not, this conditional approval is revoked.

ADOPTED AS AMENDED 03/31/2008

Paul M. Ziehler, City Admin. Officer, Clerk/Treas.

APPROVED AS AMENDED 4-2-08

Jeannette Bell, Mayor



CITY CLERK/TREASURER'S OFFICE
414/302-8200 or 414/302-8207 (Fax)
www.ci.west-allis.wi.us
Paul M. Ziehler
City Admin. Officer, Clerk/Treasurer
Monica Schultz
Assistant City Clerk
Rosemary West
Treasurer's Office Supervisor

June 6, 2008

Mr. Dominic LaLicata
Cugino's Entertainment, LLC.
9442 W. National Avenue
West Allis, WI 53227

Dear Mr. LaLicata:

Enclosed is a copy of Certified Survey Map No. 8049, for proposed parcel combination for Heartbreakers, an existing business located at 9440-42 W. National Ave., submitted by Dominic LaLicata, Cugino's Entertainment, LLC. (Tax Key No. 479-0676-002).

Sincerely,

Monica Schultz
Assistant City Clerk

jml

enc.

cc: Planning & Zoning Department
City Engineer
City Assessor
Director of Building Inspections & Zoning
Special Assessment Clerk
Pat Walker
Development
Michael Doble, Landcraft Survey & Engineering, Inc.

CERTIFIED SURVEY MAP NO. 8049

Parcel 1 and Parcel 2 of Certified Survey Map No. 5181, a division of Lots 35 & 36, Block 3, McGeoch Highlands, being a part of the Southeast 1/4 of Section 5, Township 6 North, Range 21 East, in the City of West Allis, County of Milwaukee, Wisconsin.

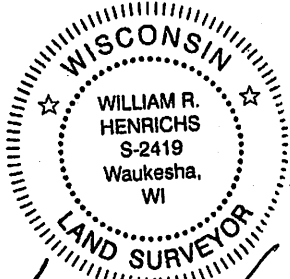

William R. Henrichs
 February 22, 2008
 Rev. April 8, 2008

- Notes:
 O—Denotes 1" iron pipe found
 ●—Denotes 1" x 24" iron pipe set, 1.68 lbs. per lin. ft.

GRAPHIC SCALE

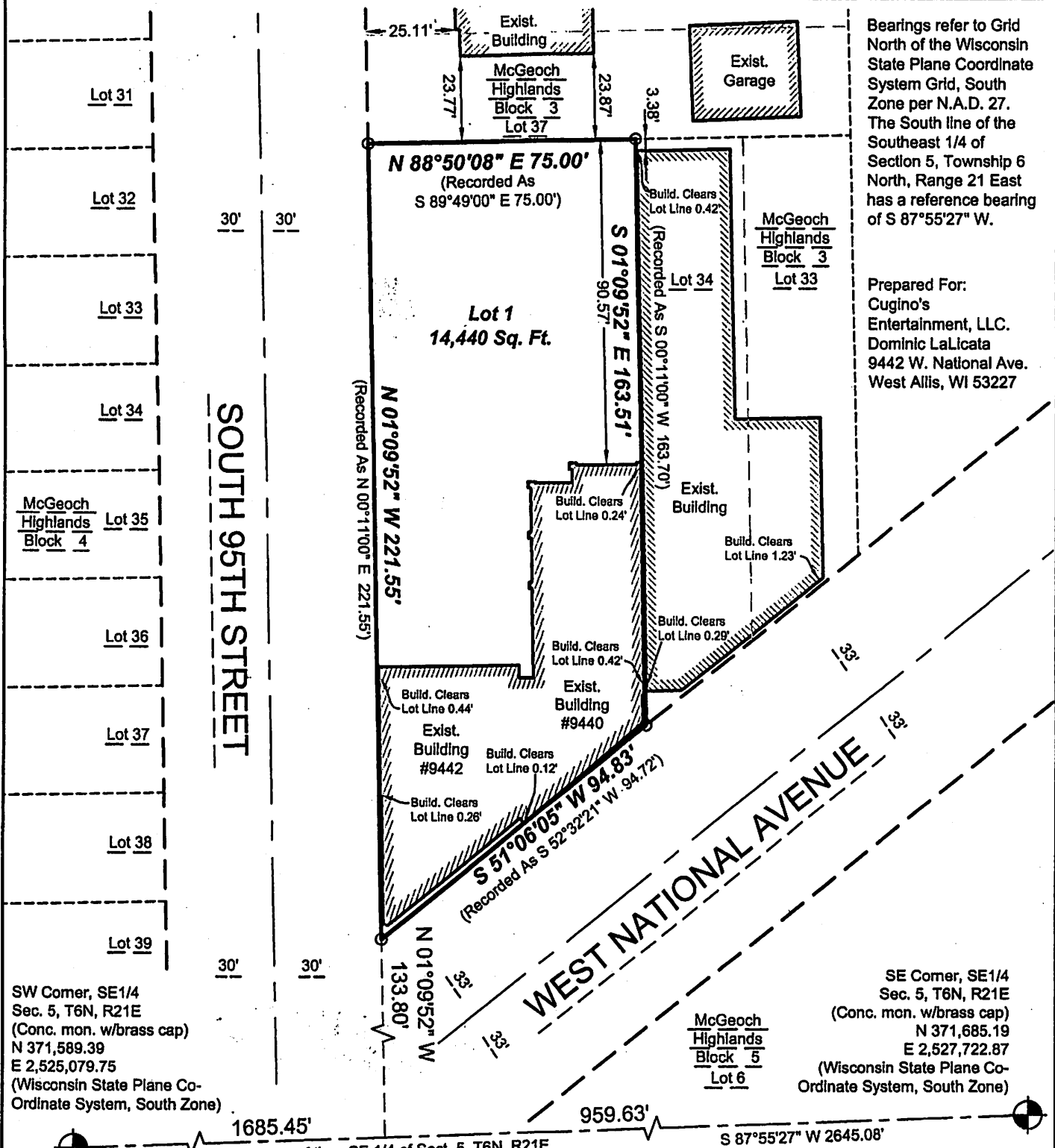
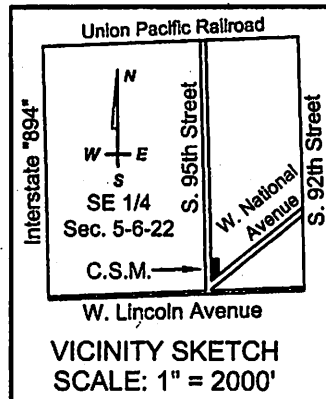
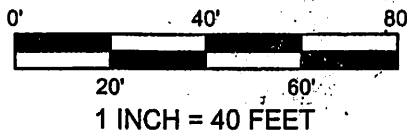

Bearings refer to Grid North of the Wisconsin State Plane Coordinate System Grid, South Zone per N.A.D. 27. The South line of the Southeast 1/4 of Section 5, Township 6 North, Range 21 East has a reference bearing of $S 87^{\circ}55'27'' W$.

Prepared For:
 Cugino's Entertainment, LLC.
 Dominic LaLicata
 9442 W. National Ave.
 West Allis, WI 53227

SW Corner, SE1/4
 Sec. 5, T6N, R21E
 (Conc. mon. w/brass cap)
 N 371,589.39
 E 2,525,079.75
 (Wisconsin State Plane Co-Ordinate System, South Zone)

SE Corner, SE1/4
 Sec. 5, T6N, R21E
 (Conc. mon. w/brass cap)
 N 371,685.19
 E 2,527,722.87
 (Wisconsin State Plane Co-Ordinate System, South Zone)

LANDCRAFT SURVEY AND ENGINEERING, INC.
 REGISTERED LAND SURVEYORS AND CIVIL ENGINEERS
 2077 South 116th Street, West Allis, WI 53227
 PH. (414) 604-0674 FAX (414) 604-0677
 INFO@LANDCRAFTSE.COM

This instrument drafted by
 William R. Henrichs, RLS S-2419

Job Number: 070403
 February 22, 2008
 Sheet 1 of 4 Sheets

CERTIFIED SURVEY MAP NO. 8049

Parcel 1 and Parcel 2 of Certified Survey Map No. 5181, a division of Lots 35 & 36, Block 3, McGeoch Highlands, being a part of the Southeast 1/4 of Section 5, Township 6 North, Range 21 East, in the City of West Allis, County of Milwaukee, Wisconsin.

SURVEYOR'S CERTIFICATE

STATE OF WISCONSIN)
MILWAUKEE COUNTY) SS

I, William R. Henrichs, Registered Land Surveyor, do hereby certify:

That I have surveyed, mapped that part of the Parcel 1 and Parcel 2 of Certified Survey Map No. 5181, a division of Lots 35 & 36, Block 3, McGeoch Highlands, being a part of the Southeast 1/4 of Section 5, Township 6 North, Range 21 East, in the City of West Allis, County of Milwaukee, Wisconsin, which is bounded and described as follows:

Commencing at the Southeast corner of said Southeast 1/4;
Thence S 87°55'27" W, along the South line of said Southeast 1/4, 959.63 feet;
Thence N 01°09'52" W, 133.80 feet to the place of beginning;
Thence N 01°09'52" W, 221.55 feet;
Thence N 88°50'08" E, 75.00 feet;
Thence S 01°09'52" E, 163.51 feet;
Thence S 51°06'05" W, 94.83 feet to the place of beginning;
Said lands containing 14,440 square feet, 0.3315 acres.

That I have made such survey, land division and map by the direction of **Cugino's Entertainment, LLC.**, owner of said land.

That such plat is a correct representation of all the exterior boundaries of the land surveyed and the land division thereof made.

That I have fully complied with the provisions of Chapter 236 of the Wisconsin State Statutes and the City of West Allis Land Division Ordinance in surveying, mapping and dividing the same.

February 22, 2008
Date
Rev. April 8, 2008



William R. Henrichs
William R. Henrichs
Registered Land Surveyor, S-2419

DOC.# 09609589

REGISTER'S OFFICE | SS
Milwaukee County, WI

RECORDED 06/04/2008 03:14PM

JOHN LA FAVE
REGISTER OF DEEDS
AMOUNT: 17.00
FEE EXEMPT 77.25 #: 0

LANDCRAFT SURVEY AND ENGINEERING, INC.
REGISTERED LAND SURVEYORS AND CIVIL ENGINEERS
2077 South 116th Street, West Allis, WI 53227
PH. (414) 604-0674 FAX (414) 604-0677
INFO@LANDCRAFTSE.COM

This instrument drafted by
William R. Henrichs, RLS S-2419

Job Number: 070403
February 22, 2008
Sheet 2 of 4 Sheets

CERTIFIED SURVEY MAP NO. 8049

Parcel 1 and Parcel 2 of Certified Survey Map No. 5181, a division of Lots 35 & 36, Block 3, McGeoch Highlands, being a part of the Southeast 1/4 of Section 5, Township 6 North, Range 21 East, in the City of West Allis, County of Milwaukee, Wisconsin.

OWNER'S CERTIFICATE OF DEDICATION

Cugino's Entertainment, LLC., a Limited Liability Company duly organized and existing under and by virtue of the laws of the State of Wisconsin, as owner, does hereby certify that said limited liability company caused the land described on this certified survey map to be surveyed, divided, mapped and dedicated as represented on this certified survey map.

IN WITNESS WHEREOF, the said Cugino's Entertainment, LLC. has caused these presents to be signed by Dominic LaLicata, Member, on this 29 day of APRIL, 2008.

In the presence of: Cugino's Entertainment, LLC.

Dominic LaLicata, Member

STATE OF WISCONSIN)
MILWAUKEE COUNTY) SS

Personally came before me this 29 day of April, 2008, Dominic LaLicata, Member of the above named limited liability company, to me known to be the person who executed the foregoing instrument, and to me known to be such Member of said limited liability company, and acknowledged that he executed the foregoing instrument as such Member as the deed of said limited liability company, by its authority.

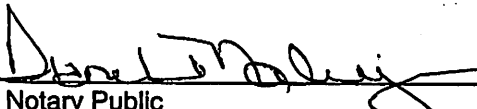
Notary Public
State of Wisconsin
My Commission Expires: 4-11-10

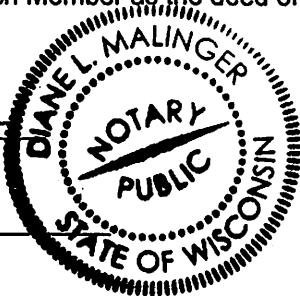

CONSENT OF CORPORATE MORTGAGEE

MARITIME SAVINGS BANK, a corporation duly organized and existing under and by virtue of the laws of the State of Wisconsin, mortgagee of the above described land, does hereby consent to the surveying, dividing, mapping and dedication of the land described on this certified survey map and does hereby consent to the above certification of owners.

IN WITNESS WHEREOF, the said Maritime Savings Bank, has caused these presents to be signed by Kathryn A. Kronquist, its ^{Vice} President, and its corporate seal to be hereunto affixed this 29th day of April, 2008.

April 29, 2008
Date

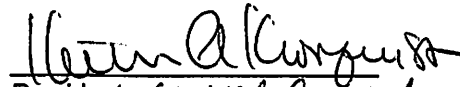

Vice President - General Counsel

STATE OF WISCONSIN)
MILWAUKEE COUNTY) SS

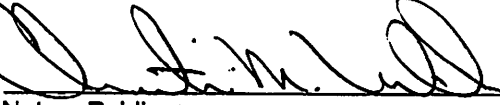
Personally came before me this 29th day of April, 2008, Kathryn A. Kronquist, to me known to be the person who executed the foregoing instrument and to me known to be such officer of said corporation and acknowledged the same.

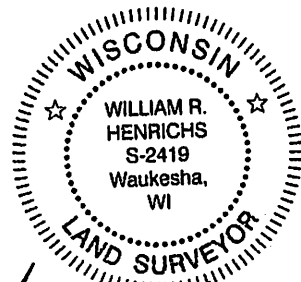
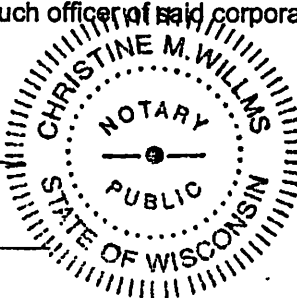
Notary Public
State of Wisconsin
My Commission Expires: 9-13-09



February 22, 2008
Rev. April 8, 2008

LANDCRAFT SURVEY AND ENGINEERING, INC.

REGISTERED LAND SURVEYORS AND CIVIL ENGINEERS
2077 South 116th Street, West Allis, WI 53227
PH. (414) 604-0674 FAX (414) 604-0677
INFO@LANDCRAFTSE.COM

This instrument drafted by
William R. Henrichs, RLS S-2419

Job Number: 070403
February 22, 2008
Sheet 3 of 4 Sheets

CERTIFIED SURVEY MAP NO. 8049

Parcel 1 and Parcel 2 of Certified Survey Map No. 5181, a division of Lots 35 & 36, Block 3, McGeoch Highlands, being a part of the Southeast 1/4 of Section 5, Township 6 North, Range 21 East, in the City of West Allis, County of Milwaukee, Wisconsin.

COMMON COUNCIL APPROVAL

Be it resolved by the Common Council of the City of West Allis, Wisconsin, that the Certified Survey Map of a parcel of land in the Southeast 1/4 of Section 5, Township 6 North, Range 21 East, in the City of West Allis, County of Milwaukee, Wisconsin, be and the same is hereby adopted.

Approved: May 22, 2008

Adopted: May 20, 2008

[Signature]
Dan Devine, Mayor

[Signature]
Paul M. Ziehler
City Administrative Officer
Clerk/Treasurer

CERTIFICATE OF COUNTY TREASURER

STATE OF WISCONSIN)
MILWAUKEE COUNTY) SS

I, Daniel Diliberti, being the duly elected, qualified and acting Treasurer of the County of Milwaukee, Wisconsin, do hereby certify that in accordance with the records in my office, there are no unpaid taxes of unpaid special assessments as of June 4, 2008 on any of the lands included in this Certified Survey Map.

June 4, 2008
Date

[Signature]
Dan Diliberti
Milwaukee County Treasurer

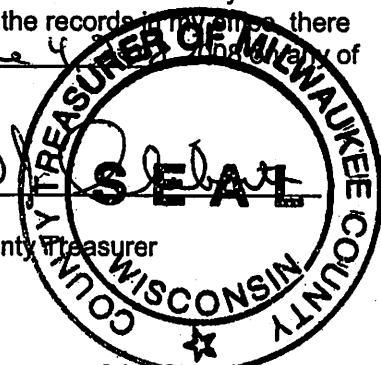

CERTIFICATE OF CITY TREASURER

I, Paul M. Ziehler, being the duly appointed and qualified City Treasurer of the City of West Allis, Wisconsin, do hereby certify that in accordance with the records in my office, there are no unpaid taxes of unpaid special assessments as of May 29, 2008 on any of the lands included in this Certified Survey Map.

5/30/08
Date

[Signature]
Paul M. Ziehler
City Administrative Officer
Clerk/Treasurer

CERTIFICATE OF CITY CLERK

I, Paul M. Ziehler, being the duly appointed and qualified City Clerk of the City of West Allis, Wisconsin, and that the foregoing is a true and correct copy of a resolution adopted by the Common Council of the City of West Allis, Wisconsin on the 20th day of May, 2008.

5/30/08
Date

[Signature]
Paul M. Ziehler
City Administrative Officer
Clerk/Treasurer

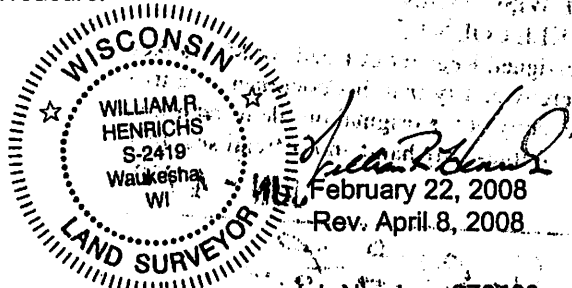

LANDCRAFT SURVEY AND ENGINEERING, INC.
REGISTERED LAND SURVEYORS AND CIVIL ENGINEERS
2077 South 116th Street, West Allis, WI 53227
PH. (414) 604-0674 FAX (414) 604-0677
INFO@LANDCRAFTSE.COM

This instrument drafted by
William R. Henrichs, RLS S-2419

Job Number: 070403
February 22, 2008
Sheet 4 of 4 Sheets



STATE OF WISCONSIN
MILWAUKEE COUNTY

I, the undersigned Register of Deeds of Milwaukee
County, hereby certify that this document is a true
and correct copy of the original on file or record in
my office. Witness my hand and official seal this

JUN - 4 2008

date

John La Fave

JOHN LA FAVE
Register of Deeds