



T 414.220.9640  
 751 N Jefferson St.  
 Suite 200  
 Milwaukee, WI 53202

CONSULTANTS:

**NOT FOR CONSTRUCTION**  
 THESE DRAWINGS ARE RELEASED FOR DESIGN DEVELOPMENT PURPOSES ONLY. THEY ARE NOT TO BE USED FOR REGULATORY APPROVAL, PERMIT, OR CONSTRUCTION PURPOSES.

LAS CAZUELAS CHILLAQUILES & TACO BAR  
 6738 W GREENFIELD AVE.  
 WEST ALLIS, WI 53214  
 SHEET TITLE:  
 ARCHITECTURAL SITE PLAN

REVISIONS:  
 1 12/12/23 Outdoor Furniture

SCALE	VARIES
PROJECT NUMBER	230902
SET TYPE	CONDITIONAL USE
DATE ISSUED	11/08/2023
SHEET NUMBER	<b>A020</b>

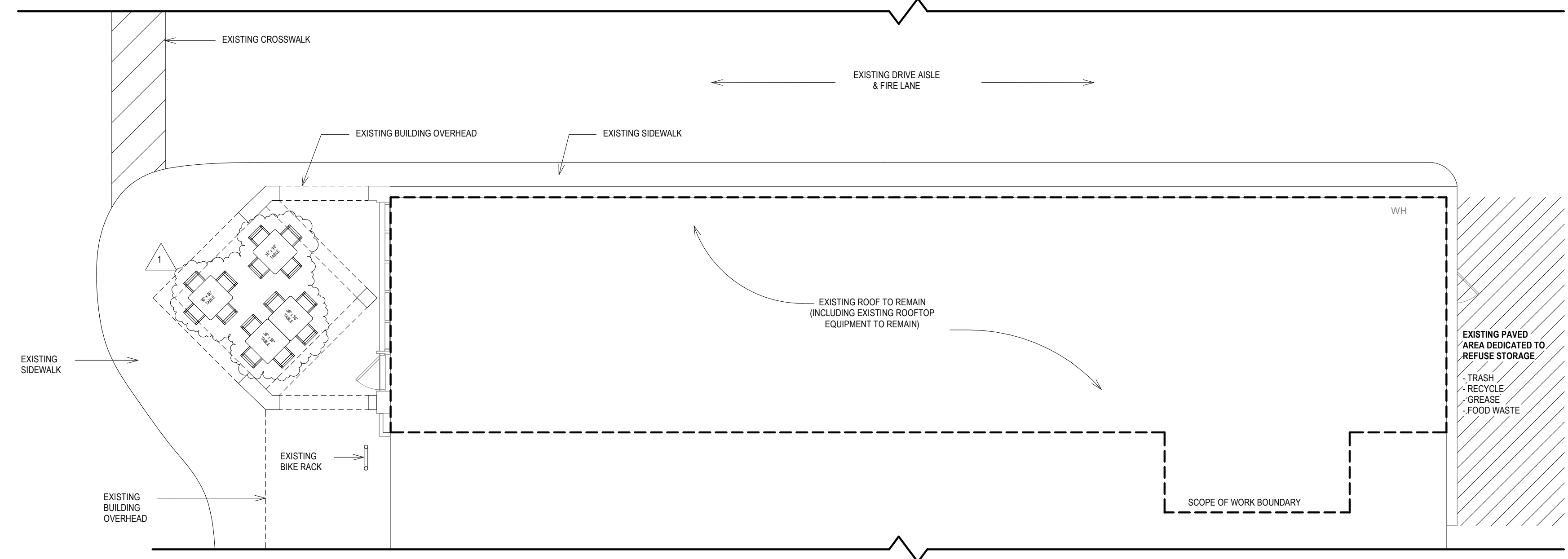

**2 SITE PLAN**  
 Scale: 1/8" = 1'-0"  
 0' 2' 4' 8' 12'

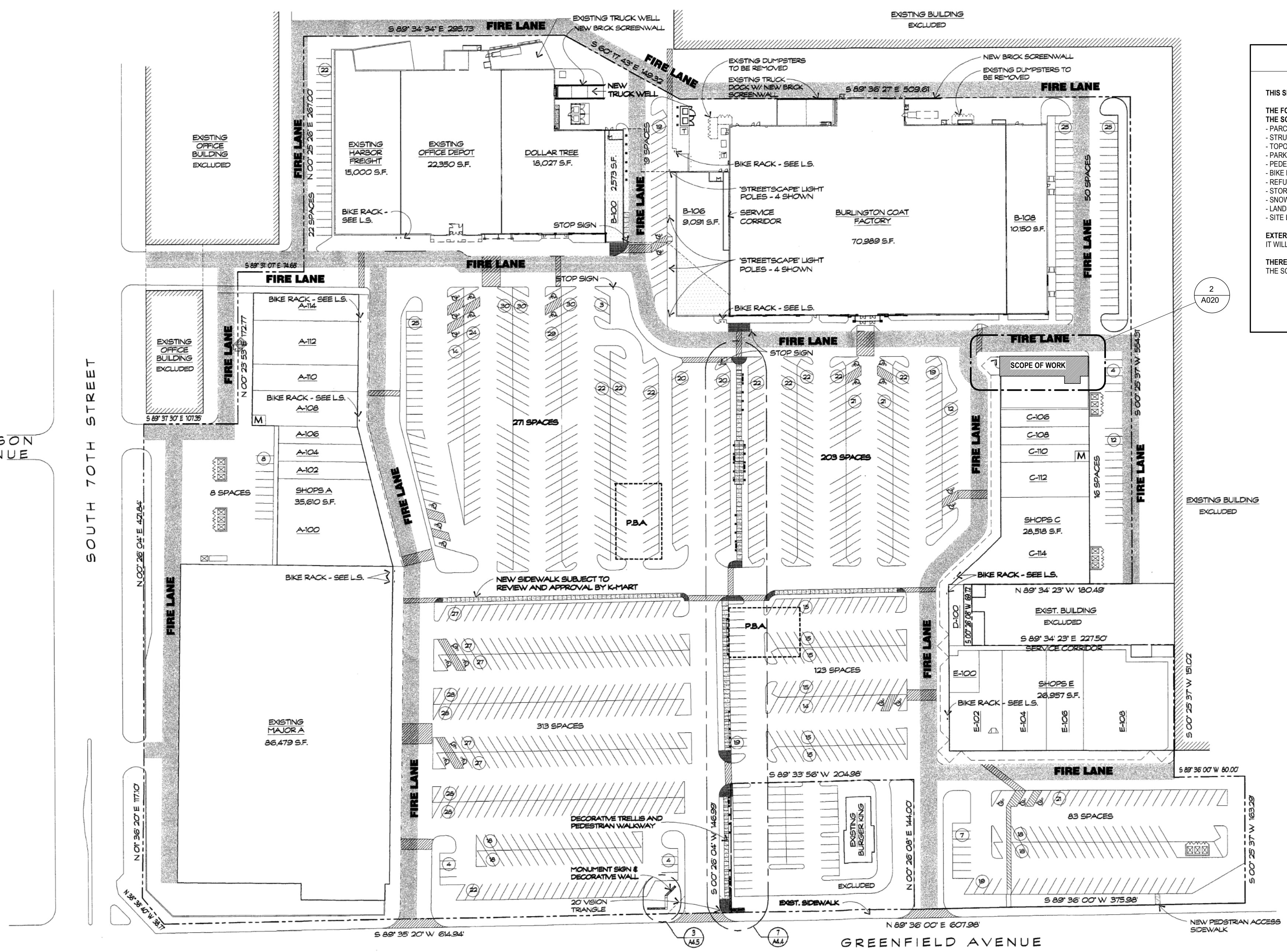

**1 CONTEXTUAL SITE PLAN**  
 Scale: 1" = 80'-0"  
 0' 20' 40' 80' 120'

**SITE PLAN NOTES**

THIS SITE PLAN IS PROVIDED FOR CONDITIONAL USE APPLICATION REQUIREMENTS ONLY.

THE FOLLOWING ITEMS ARE EXISTING CONDITIONS OF THE WEST ALLIS TOWNE CENTRE AND WILL NOT BE ALTERED BY THE SCOPE OF THIS PROJECT:

- PARCEL BOUNDARIES
- STRUCTURES
- TOPOGRAPHY
- PARKING, VEHICULAR CIRCULATION, FIRE LANES
- PEDESTRIAN CIRCULATION PATHWAYS
- BIKE PARKING
- REFUSE AREAS (THIS PROJECT WILL USE THE SAME AREAS ALREADY PROVIDED)
- STORMWATER AND UTILITIES
- SNOW STORAGE
- LANDSCAPING AND PLANTING
- SITE LIGHTING

EXTERIOR STOREFRONT SIGNAGE IS NOT ADDRESSED IN THIS SUBMITTAL. IT WILL BE SUBMITTED SEPARATELY BY OWNER VIA A SIGN PERMIT APPLICATION.

THERE ARE NO OTHER PROPOSED CHANGES TO THE EXTERIOR OF THE EXISTING BUILDING. THE SCOPE OF WORK FOR THIS PROJECT IS LIMITED TO INTERIOR SPACES OF AN EXISTING STOREFRONT ONLY.