



ENGINEERING DEPARTMENT

Michael G. Lewis

Director of Public Works / City Engineer

414/302-8360

414/302-8366 (Fax)

City Hall

7525 West Greenfield Avenue

West Allis, Wisconsin 53214

www.westalliswi.gov

mlewis@westalliswi.gov

November 3, 2015

Honorable Mayor and Common Council
West Allis, Wisconsin

Dear Mayor and Council Members:

I herewith respectfully submit my report on the assessment of benefits for concrete reconstruction with miscellaneous walk, new driveway approaches, storm sewer, storm sewer relay, sanitary sewer relay, water main relay, building services and utility adjustments in:

**S. 79 St. from W. Greenfield Ave. to W. National Ave.,
S. 85 St. from W. Washington St. to W. Greenfield Ave.,
and portions of intersecting streets**

as directed in Preliminary Resolution No. R-2015-0186, adopted on September 1, 2015.

This report consists of the following schedules attached hereto:

Schedule A. - Preliminary Plans and Specifications;

Schedule B. - Estimate of Entire Cost of Proposed Improvements;

Schedule C. - Schedule of Proposed Assessments Against Each Parcel Affected.

The properties against which the assessments are proposed are benefited.

Respectfully submitted,

A handwritten signature in black ink, appearing to read "Michael G. Lewis".

Michael G. Lewis, P.E.
Director of Public Works/City Engineer

MGL:ns

Encs.

PROPOSED IMPROVEMENT OF

**S. 79 St. from W. Greenfield Ave. to W. National Ave.
S. 85 St. from W. Washington St. to W. Greenfield Ave.
And portions of intersecting streets**

by concrete reconstruction with miscellaneous walk, new driveway approaches, storm sewer,
storm sewer relay, sanitary sewer relay, water main relay, building services and utility
adjustments

SCHEDULE "A"

Preliminary Plans & Specifications Attached

SCHEDULE "B"

Estimate of the Entire Cost

\$992,000

SCHEDULE "C"

Schedule of Proposed Assessments
Against Each Parcel Affected

W. GREENFIELD AVE.

S. 80 ST.

S. 78 ST.

S. 79 ST.



S. 80 ST.

S. 78 ST.

LINCOLN
SCHOOL

W. NATIONAL AVE.

W. WASHINGTON ST.



S. 85 ST.

W. GREENFIELD AVE.

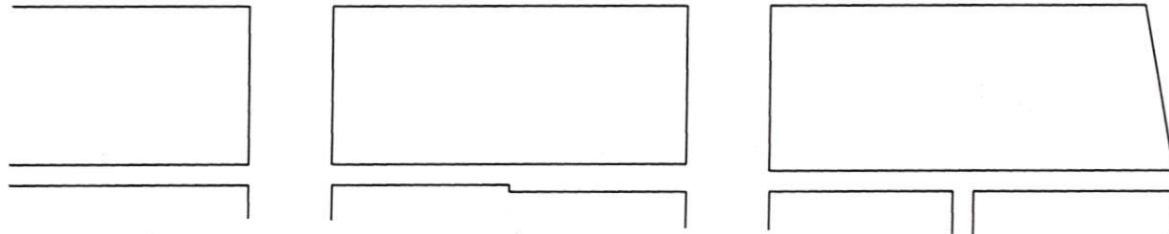



ENGINEERING DEPARTMENT

Michael G. Lewis

Director of Public Works / City Engineer

414/302-8360

414/302-8366 (Fax)

City Hall

7525 West Greenfield Avenue

West Allis, Wisconsin 53214

www.westalliswi.gov

mlewis@westalliswi.gov

November 3, 2015

Board of Public Works
West Allis City Hall
West Allis, Wisconsin

Dear Board Members:

I am herewith submitting preliminary plans and an estimate of costs for the concrete reconstruction with miscellaneous walk, new driveway approaches, storm sewer, storm sewer relay, sanitary sewer relay, water main relay, building services and utility adjustments in:

**S. 79 St. from W. Greenfield Ave. to W. National Ave.,
S. 85 St. from W. Washington St. to W. Greenfield Ave.,
and portions of intersecting streets**

Estimated Construction Cost:	\$902,000
Contingency:	90,000
TOTAL:	\$992,000

Sincerely,

A handwritten signature in black ink, appearing to read "Michael G. Lewis".

Michael G. Lewis, P.E.
Director of Public Works/City Engineer

MGL:ns

ASSESSMENT REPORT FOR COUNCIL

HEARING DATE: November 3, 2015

LOCATION

DESCRIPTION: S. 79 St. from W. Greenfield Ave. to W. National Ave.
S. 85 St. from W. Washington St. to W. Greenfield Ave.

ACCOUNT NO.: P1622S, P1625S

INTEREST RATE: 4.0%

<u>2016 ASSESSMENT RATES</u>	<u>Resid.</u>	<u>Comm.</u>	<u>Mfg.</u>
<u>Streets</u>			
New Construction, lin. ft.	\$55.32	\$69.15	\$82.98
<u>Driveways</u>			
7" Concrete Approach, sq. ft.	\$ 6.90	\$ 6.90	\$ 6.90

The properties against which the assessments are proposed are benefited.



City of West Allis Engineering Department
Project Details P1622S

S. 79 St. from W. Greenfield Ave. to W. National Ave.

Property Assessments

452-0152-000 7829-33 W GRNFLD & 1408 S 79 7829 Greenfield LLC Commercial 10

Street Concrete Reconstruction 69.15 x 120.00 Lin Ft = \$ 8,298.00 40.00 \$ 3,319.20

Reduction Code Longside

Storm Sewer Lateral Install 1,428.00 x 1.00 Each = \$ 1,428.00 100.00 \$ 1,428.00

Total: \$ 4,747.20

452-0584-000 1418 S 79 ST Palmetto Properties LLC Residential 20

Street Concrete Reconstruction 55.32 x 30.00 Lin Ft = \$ 1,659.60 100.00 \$ 1,659.60

Storm Sewer Lateral Install 618.00 x 1.00 Each = \$ 618.00 100.00 \$ 618.00

Driveway 7" Concrete Approach 6.90 x 40.00 Sq Ft = \$ 276.00 100.00 \$ 276.00

Total: \$ 2,553.60

452-0583-000 1420-22 S 79 ST Robert B Rondini & Lisa M Cottrell Residential 30

Street Concrete Reconstruction 55.32 x 30.00 Lin Ft = \$ 1,659.60 100.00 \$ 1,659.60

Storm Sewer Lateral Install 618.00 x 1.00 Each = \$ 618.00 100.00 \$ 618.00

Driveway 7" Concrete Approach 6.90 x 40.00 Sq Ft = \$ 276.00 100.00 \$ 276.00

Total: \$ 2,553.60

452-0582-000 1424-26 S 79 ST Andrew A Yeager & Robert Yeager, II Residential 40

Street Concrete Reconstruction 55.32 x 30.00 Lin Ft = \$ 1,659.60 100.00 \$ 1,659.60

Storm Sewer Lateral Install 618.00 x 1.00 Each = \$ 618.00 100.00 \$ 618.00

Driveway 7" Concrete Approach 6.90 x 55.00 Sq Ft = \$ 379.50 100.00 \$ 379.50

Total: \$ 2,657.10

452-0581-000 1428-30 S 79 ST Ryan Schraufnagel Residential 50

Street Concrete Reconstruction 55.32 x 30.00 Lin Ft = \$ 1,659.60 100.00 \$ 1,659.60

Storm Sewer Lateral Install 618.00 x 1.00 Each = \$ 618.00 100.00 \$ 618.00

Driveway 7" Concrete Approach 6.90 x 55.00 Sq Ft = \$ 379.50 100.00 \$ 379.50

Total: \$ 2,657.10



City of West Allis Engineering Department
Project Details P1622S

S. 79 St. from W. Greenfield Ave. to W. National Ave.

452-0580-000	1434 S 79 ST	Carl B Stessl & Victoria Stessl	Residential	60
	Street Concrete Reconstruction	55.32 x 40.00 Lin Ft	= \$ 2,212.80	100.00 \$ 2,212.80
	Storm Sewer Lateral Install	618.00 x 1.00 Each	= \$ 618.00	100.00 \$ 618.00
	Driveway 7" Concrete Approach	6.90 x 123.00 Sq Ft	= \$ 848.70	100.00 \$ 848.70
			Total:	\$ 3,679.50
452-0579-000	1438 S 79 ST	Jason R Hellman	Residential	70
	Street Concrete Reconstruction	55.32 x 40.00 Lin Ft	= \$ 2,212.80	100.00 \$ 2,212.80
	Storm Sewer Lateral Install	618.00 x 1.00 Each	= \$ 618.00	100.00 \$ 618.00
	Driveway 7" Concrete Approach	6.90 x 93.00 Sq Ft	= \$ 641.70	100.00 \$ 641.70
			Total:	\$ 3,472.50
452-0578-000	1444-46 S 79 ST	Harold N Weber	Residential	80
	Street Concrete Reconstruction	55.32 x 40.00 Lin Ft	= \$ 2,212.80	100.00 \$ 2,212.80
	Storm Sewer Lateral Install	618.00 x 1.00 Each	= \$ 618.00	100.00 \$ 618.00
	Driveway 7" Concrete Approach	6.90 x 93.00 Sq Ft	= \$ 641.70	100.00 \$ 641.70
			Total:	\$ 3,472.50
452-0577-000	1448-50 S 79 ST	Michael Stout & Cynthia Stout	Residential	90
	Street Concrete Reconstruction	55.32 x 60.00 Lin Ft	= \$ 3,319.20	100.00 \$ 3,319.20
	Storm Sewer Lateral Install	618.00 x 1.00 Each	= \$ 618.00	100.00 \$ 618.00
	Driveway 7" Concrete Approach	6.90 x 135.00 Sq Ft	= \$ 931.50	100.00 \$ 931.50
			Total:	\$ 4,868.70
452-0576-000	1456-58 S 79 ST	Holman Homes LLC	Residential	100
	Street Concrete Reconstruction	55.32 x 53.00 Lin Ft	= \$ 2,931.96	100.00 \$ 2,931.96
	Storm Sewer Lateral Install	618.00 x 1.00 Each	= \$ 618.00	100.00 \$ 618.00
	Driveway 7" Concrete Approach	6.90 x 118.00 Sq Ft	= \$ 814.20	100.00 \$ 814.20
			Total:	\$ 4,364.16



City of West Allis Engineering Department
 Project Details P1622S

S. 79 St. from W. Greenfield Ave. to W. National Ave.

452-0575-000	1464-66 S 79 ST	Jenny Kierzek	Residential	110
Street Concrete Reconstruction	55.32 x 67.00 Lin Ft	= \$	3,706.44	100.00 \$ 3,706.44
			Total:	\$ 3,706.44
452-0152-001	1500-02 S 79 ST	Marjorie J Keske	Residential	120
Street Concrete Reconstruction	55.32 x 41.10 Lin Ft	= \$	2,273.65	100.00 \$ 2,273.65
			Total:	\$ 2,273.65
452-0153-000	1506 S 79 ST	Beverly A Brunn	Residential	130
Street Concrete Reconstruction	55.32 x 38.00 Lin Ft	= \$	2,102.16	100.00 \$ 2,102.16
Storm Sewer Lateral Install	618.00 x 1.00 Each	= \$	618.00	100.00 \$ 618.00
			Total:	\$ 2,720.16
452-0154-000	1512 S 79 ST	JAC Homes LLC	Residential	140
Street Concrete Reconstruction	55.32 x 38.00 Lin Ft	= \$	2,102.16	100.00 \$ 2,102.16
Storm Sewer Lateral Install	618.00 x 1.00 Each	= \$	618.00	100.00 \$ 618.00
			Total:	\$ 2,720.16
452-0155-000	1516-18 S 79 ST	Michael A Odle & Janet K Perkins	Residential	150
Street Concrete Reconstruction	55.32 x 38.00 Lin Ft	= \$	2,102.16	100.00 \$ 2,102.16
Storm Sewer Lateral Install	618.00 x 1.00 Each	= \$	618.00	100.00 \$ 618.00
			Total:	\$ 2,720.16
452-0156-000	1520 S 79 ST	Ereindra Morales Barrios	Residential	160
Street Concrete Reconstruction	55.32 x 38.00 Lin Ft	= \$	2,102.16	100.00 \$ 2,102.16
Storm Sewer Lateral Install	618.00 x 1.00 Each	= \$	618.00	100.00 \$ 618.00
			Total:	\$ 2,720.16
452-0157-000	1528 S 79 ST	Gerald W Traxel, Jr & Lisa M Traxel	Residential	170
Street Concrete Reconstruction	55.32 x 38.00 Lin Ft	= \$	2,102.16	100.00 \$ 2,102.16
Storm Sewer Lateral Install	618.00 x 1.00 Each	= \$	618.00	100.00 \$ 618.00
			Total:	\$ 2,720.16



City of West Allis Engineering Department
 Project Details P1622S

S. 79 St. from W. Greenfield Ave. to W. National Ave.

452-0158-000	1532-34 S 79 ST	Edwin A Vis & Mary C Vis	Residential	180
	Street Concrete Reconstruction	55.32 x 37.00 Lin Ft	= \$ 2,046.84	100.00 \$ 2,046.84
	Storm Sewer Lateral Install	618.00 x 1.00 Each	= \$ 618.00	100.00 \$ 618.00
	Driveway 7" Concrete Approach	6.90 x 106.00 Sq Ft	= \$ 731.40	100.00 \$ 731.40
			Total:	\$ 3,396.24
452-0159-000	1536 S 79 ST	David Allen Girardot	Residential	190
	Street Concrete Reconstruction	55.32 x 38.00 Lin Ft	= \$ 2,102.16	100.00 \$ 2,102.16
	Storm Sewer Lateral Install	618.00 x 1.00 Each	= \$ 618.00	100.00 \$ 618.00
	Driveway 7" Concrete Approach	6.90 x 102.00 Sq Ft	= \$ 703.80	100.00 \$ 703.80
			Total:	\$ 3,423.96
452-0160-000	1542 S 79 ST	David A Parbs & Jill M Koehler	Residential	200
	Street Concrete Reconstruction	55.32 x 51.00 Lin Ft	= \$ 2,821.32	100.00 \$ 2,821.32
	Storm Sewer Lateral Install	618.00 x 1.00 Each	= \$ 618.00	100.00 \$ 618.00
	Driveway 7" Concrete Approach	6.90 x 144.00 Sq Ft	= \$ 993.60	100.00 \$ 993.60
			Total:	\$ 4,432.92
452-0175-000	1548 S 79 ST	Patricia Redies	Residential	210
	Street Concrete Reconstruction	55.32 x 33.00 Lin Ft	= \$ 1,825.56	100.00 \$ 1,825.56
	Storm Sewer Lateral Install	618.00 x 1.00 Each	= \$ 618.00	100.00 \$ 618.00
			Total:	\$ 2,443.56
452-0174-000	1552-54 S 79 ST	Nicholas J Martorano & Katherine Martorano	Residential	220
	Street Concrete Reconstruction	55.32 x 30.00 Lin Ft	= \$ 1,659.60	100.00 \$ 1,659.60
	Storm Sewer Lateral Install	618.00 x 1.00 Each	= \$ 618.00	100.00 \$ 618.00
			Total:	\$ 2,277.60
452-0173-000	1558-60 S 79 ST	Robin M Inman	Residential	230
	Street Concrete Reconstruction	55.32 x 45.00 Lin Ft	= \$ 2,489.40	100.00 \$ 2,489.40
	Storm Sewer Lateral Install	618.00 x 1.00 Each	= \$ 618.00	100.00 \$ 618.00
			Total:	\$ 3,107.40



City of West Allis Engineering Department
Project Details P1622S

S. 79 St. from W. Greenfield Ave. to W. National Ave.

452-0172-000	1562 S 79 ST	David Wildes & Claudette Wildes			Residential	240
	Street Concrete Reconstruction	55.32	x	45.00 Lin Ft	= \$	2,489.40
	Storm Sewer Lateral Install	618.00	x	1.00 Each	= \$	618.00
		Total:				\$ 3,107.40
452-0171-000	1568 S 79 ST	Peter R Voskuil			Residential	250
	Street Concrete Reconstruction	55.32	x	40.00 Lin Ft	= \$	2,212.80
	Storm Sewer Lateral Install	618.00	x	1.00 Each	= \$	618.00
		Total:				\$ 2,830.80
452-0170-000	1574 S 79 ST	Jessica M Parker			Residential	260
	Street Concrete Reconstruction	55.32	x	40.00 Lin Ft	= \$	2,212.80
	Storm Sewer Lateral Install	618.00	x	1.00 Each	= \$	618.00
		Total:				\$ 2,830.80
452-0169-000	1580-82 S 79 ST	Ashley M Imperiale			Residential	270
	Street Concrete Reconstruction	55.32	x	35.00 Lin Ft	= \$	1,936.20
	Storm Sewer Lateral Install	618.00	x	1.00 Each	= \$	618.00
		Total:				\$ 2,554.20
452-0168-000	7822 W LAPHAM & 1584 S 79	Jacob W Hoppe			Residential	280
	Street Concrete Reconstruction	55.32	x	35.00 Lin Ft	= \$	1,936.20
		Total:				\$ 1,936.20



City of West Allis Engineering Department
 Project Details P1622S

S. 79 St. from W. Greenfield Ave. to W. National Ave.

452-0595-000	7815 & 7827 W LAPHAM ST	Sch Dist of Wa Wm Et Al	Exempt Local	290
Street Concrete Reconstruction		55.32 x 369.42 Lin Ft	= \$ 20,436.31	100.00 \$ 20,436.31
Exempt Property Charged as Residential				
Street Concrete Reconstruction		55.32 x 114.00 Lin Ft	= \$ 6,306.48	40.00 \$ 2,522.59
Reduction Code Longside				
Exempt Property Charged as Residential				
Street Concrete Reconstruction		55.32 x 120.00 Lin Ft	= \$ 6,638.40	40.00 \$ 2,655.36
Reduction Code Longside				
Exempt Property Charged as Residential				
Driveway 7" Concrete Approach		6.90 x 240.00 Sq Ft	= \$ 1,656.00	100.00 \$ 1,656.00
Exempt Property Charged as Residential				
Driveway 7" Concrete Approach		6.90 x 85.00 Sq Ft	= \$ 586.50	100.00 \$ 586.50
Exempt Property Charged as Residential				
			Total:	\$ 27,856.76

452-0176-001	7909-13 W GREENFIELD AVE	JBB Investments LLC	Commercial	300
Street Concrete Reconstruction		69.15 x 120.00 Lin Ft	= \$ 8,298.00	40.00 \$ 3,319.20
Reduction Code Longside				
Driveway 7" Concrete Approach		6.90 x 147.00 Sq Ft	= \$ 1,014.30	100.00 \$ 1,014.30
Driveway 7" Concrete Approach		6.90 x 93.00 Sq Ft	= \$ 641.70	100.00 \$ 641.70
			Total:	\$ 4,975.20

452-0200-000	1419 S 79 ST	Donald Kosiboski & Susan Kosiboski	Residential	310
Street Concrete Reconstruction		55.32 x 42.00 Lin Ft	= \$ 2,323.44	100.00 \$ 2,323.44
Storm Sewer Lateral Install		618.00 x 1.00 Each	= \$ 618.00	100.00 \$ 618.00
Driveway 7" Concrete Approach		6.90 x 91.00 Sq Ft	= \$ 627.90	100.00 \$ 627.90
			Total:	\$ 3,569.34



City of West Allis Engineering Department
Project Details P1622S

S. 79 St. from W. Greenfield Ave. to W. National Ave.

452-0199-000	1423 S 79 ST	Adrian F Kriplean	Residential	320
Street Concrete Reconstruction	55.32 x	41.00 Lin Ft	= \$ 2,268.12	100.00 \$ 2,268.12
Storm Sewer Lateral Install	618.00 x	1.00 Each	= \$ 618.00	100.00 \$ 618.00
Driveway 7" Concrete Approach	6.90 x	128.00 Sq Ft	= \$ 883.20	100.00 \$ 883.20
			Total:	\$ 3,769.32

452-0198-000	1429-31 S 79 ST	Clark H Pade	Residential	330
Street Concrete Reconstruction	55.32 x	49.00 Lin Ft	= \$ 2,710.68	100.00 \$ 2,710.68
Storm Sewer Lateral Install	618.00 x	1.00 Each	= \$ 618.00	100.00 \$ 618.00
Driveway 7" Concrete Approach	6.90 x	117.00 Sq Ft	= \$ 807.30	100.00 \$ 807.30
			Total:	\$ 4,135.98

452-0197-000	1435-37 S 79 ST	Daniel Courtney & Travis Kalmuck	Residential	340
Street Concrete Reconstruction	55.32 x	36.00 Lin Ft	= \$ 1,991.52	100.00 \$ 1,991.52
Storm Sewer Lateral Install	618.00 x	1.00 Each	= \$ 618.00	100.00 \$ 618.00
Driveway 7" Concrete Approach	6.90 x	113.00 Sq Ft	= \$ 779.70	100.00 \$ 779.70
			Total:	\$ 3,389.22

452-0196-000	1439-41 S 79 ST	William R Sitarz	Residential	350
Street Concrete Reconstruction	55.32 x	42.00 Lin Ft	= \$ 2,323.44	100.00 \$ 2,323.44
Storm Sewer Lateral Install	618.00 x	1.00 Each	= \$ 618.00	100.00 \$ 618.00
Driveway 7" Concrete Approach	6.90 x	114.00 Sq Ft	= \$ 786.60	100.00 \$ 786.60
			Total:	\$ 3,728.04

452-0195-000	1445 S 79 ST	Cary A Decker & Deborah Decker	Residential	360
Street Concrete Reconstruction	55.32 x	42.00 Lin Ft	= \$ 2,323.44	100.00 \$ 2,323.44
Storm Sewer Lateral Install	618.00 x	1.00 Each	= \$ 618.00	100.00 \$ 618.00
Driveway 7" Concrete Approach	6.90 x	93.00 Sq Ft	= \$ 641.70	100.00 \$ 641.70
			Total:	\$ 3,583.14



City of West Allis Engineering Department
 Project Details P1622S

S. 79 St. from W. Greenfield Ave. to W. National Ave.

452-0194-000	1451 S 79 ST	Christopher T Ostram & Danielle M Ostram				Residential	370
	Street Concrete Reconstruction	55.32 x	42.00 Lin Ft	= \$	2,323.44	100.00	\$ 2,323.44
	Storm Sewer Lateral Install	618.00 x	1.00 Each	= \$	618.00	100.00	\$ 618.00
	Driveway 7" Concrete Approach	6.90 x	93.00 Sq Ft	= \$	641.70	100.00	\$ 641.70
					<u>Total:</u>		<u>\$ 3,583.14</u>
452-0193-000	1457 S 79 ST	Daniel R Sponder				Residential	380
	Street Concrete Reconstruction	55.32 x	42.00 Lin Ft	= \$	2,323.44	100.00	\$ 2,323.44
	Storm Sewer Lateral Install	618.00 x	1.00 Each	= \$	618.00	100.00	\$ 618.00
	Driveway 7" Concrete Approach	6.90 x	118.00 Sq Ft	= \$	814.20	100.00	\$ 814.20
					<u>Total:</u>		<u>\$ 3,755.64</u>
452-0192-000	1463 S 79 ST	Whyman J Hassel & Mary Kay Hassel				Residential	390
	Street Concrete Reconstruction	55.32 x	42.00 Lin Ft	= \$	2,323.44	100.00	\$ 2,323.44
	Storm Sewer Lateral Install	618.00 x	1.00 Each	= \$	618.00	100.00	\$ 618.00
	Driveway 7" Concrete Approach	6.90 x	107.00 Sq Ft	= \$	738.30	100.00	\$ 738.30
					<u>Total:</u>		<u>\$ 3,679.74</u>
452-0191-000	1469 S 79 ST	Beverly F Brezgel				Residential	400
	Street Concrete Reconstruction	55.32 x	42.00 Lin Ft	= \$	2,323.44	100.00	\$ 2,323.44
					<u>Total:</u>		<u>\$ 2,323.44</u>
452-0226-000	1501-03 S 79 ST	II Chief Investments LLC				Residential	410
	Street Concrete Reconstruction	55.32 x	40.00 Lin Ft	= \$	2,212.80	100.00	\$ 2,212.80
					<u>Total:</u>		<u>\$ 2,212.80</u>
452-0227-000	1507 S 79 ST	Myron W Krause & Beverly Krause				Residential	420
	Street Concrete Reconstruction	55.32 x	40.00 Lin Ft	= \$	2,212.80	100.00	\$ 2,212.80
	Storm Sewer Lateral Install	618.00 x	1.00 Each	= \$	618.00	100.00	\$ 618.00
	Driveway 7" Concrete Approach	6.90 x	88.00 Sq Ft	= \$	607.20	100.00	\$ 607.20
					<u>Total:</u>		<u>\$ 3,438.00</u>



City of West Allis Engineering Department
Project Details P1622S

S. 79 St. from W. Greenfield Ave. to W. National Ave.

452-0228-000	1511 S 79 ST	Hansen Thomas a & Helen M Trust & c/o Eberh:				Residential	430
	Street Concrete Reconstruction	55.32	x	40.00 Lin Ft	= \$	2,212.80	100.00 \$ 2,212.80
	Storm Sewer Lateral Install	618.00	x	1.00 Each	= \$	618.00	100.00 \$ 618.00
	Driveway 7" Concrete Approach	6.90	x	98.00 Sq Ft	= \$	676.20	100.00 \$ 676.20
						Total:	\$ 3,507.00
452-0229-000	1517 S 79 ST	Patrick A Kaluzynski				Residential	440
	Street Concrete Reconstruction	55.32	x	30.00 Lin Ft	= \$	1,659.60	100.00 \$ 1,659.60
	Storm Sewer Lateral Install	618.00	x	1.00 Each	= \$	618.00	100.00 \$ 618.00
						Total:	\$ 2,277.60
452-0230-000	1521 S 79 ST	Daniel J Ubl & Jennifer C Brindley Ubl				Residential	450
	Street Concrete Reconstruction	55.32	x	60.00 Lin Ft	= \$	3,319.20	100.00 \$ 3,319.20
	Storm Sewer Lateral Install	618.00	x	1.00 Each	= \$	618.00	100.00 \$ 618.00
	Driveway 7" Concrete Approach	6.90	x	92.00 Sq Ft	= \$	634.80	100.00 \$ 634.80
						Total:	\$ 4,572.00
452-0231-000	1529 S 79 ST	Charlotte A Stahl				Residential	460
	Street Concrete Reconstruction	55.32	x	45.00 Lin Ft	= \$	2,489.40	100.00 \$ 2,489.40
	Storm Sewer Lateral Install	618.00	x	1.00 Each	= \$	618.00	100.00 \$ 618.00
	Driveway 7" Concrete Approach	6.90	x	92.00 Sq Ft	= \$	634.80	100.00 \$ 634.80
						Total:	\$ 3,742.20
452-0232-000	1537 S 79 ST	Joseph T Kraetz & Joanne Kraetz				Residential	470
	Street Concrete Reconstruction	55.32	x	45.00 Lin Ft	= \$	2,489.40	100.00 \$ 2,489.40
	Storm Sewer Lateral Install	618.00	x	1.00 Each	= \$	618.00	100.00 \$ 618.00
	Driveway 7" Concrete Approach	6.90	x	87.00 Sq Ft	= \$	600.30	100.00 \$ 600.30
						Total:	\$ 3,707.70



City of West Allis Engineering Department
Project Details P1622S

S. 79 St. from W. Greenfield Ave. to W. National Ave.

452-0233-000	1543 S 79 ST	Eric J Sanderson & Tammy Sanderson			Residential	480
	Street Concrete Reconstruction	55.32 x	60.00 Lin Ft	= \$	3,319.20	100.00 \$ 3,319.20
	Storm Sewer Lateral Install	618.00 x	1.00 Each	= \$	618.00	100.00 \$ 618.00
	Driveway 7" Concrete Approach	6.90 x	87.00 Sq Ft	= \$	600.30	100.00 \$ 600.30
					Total:	\$ 4,537.50
452-0234-000	1549-51 S 79 ST	Alexandros Lazarides			Residential	490
	Street Concrete Reconstruction	55.32 x	60.00 Lin Ft	= \$	3,319.20	100.00 \$ 3,319.20
	Storm Sewer Lateral Install	618.00 x	1.00 Each	= \$	618.00	100.00 \$ 618.00
	Driveway 7" Concrete Approach	6.90 x	92.00 Sq Ft	= \$	634.80	100.00 \$ 634.80
					Total:	\$ 4,572.00
452-0235-000	1559 S 79 ST	Alexandros Lazarides			Residential	500
	Street Concrete Reconstruction	55.32 x	60.00 Lin Ft	= \$	3,319.20	100.00 \$ 3,319.20
	Storm Sewer Lateral Install	618.00 x	1.00 Each	= \$	618.00	100.00 \$ 618.00
	Driveway 7" Concrete Approach	6.90 x	85.00 Sq Ft	= \$	586.50	100.00 \$ 586.50
					Total:	\$ 4,523.70
452-0236-000	1565 S 79 ST	Nathan T Wilson & Annika Mooers			Residential	510
	Street Concrete Reconstruction	55.32 x	60.00 Lin Ft	= \$	3,319.20	100.00 \$ 3,319.20
	Storm Sewer Lateral Install	618.00 x	1.00 Each	= \$	618.00	100.00 \$ 618.00
	Driveway 7" Concrete Approach	6.90 x	70.00 Sq Ft	= \$	483.00	100.00 \$ 483.00
					Total:	\$ 4,420.20
452-0237-000	1575 S 79 ST	Shawn J Corrigan & Lisa L Corrigan			Residential	520
	Street Concrete Reconstruction	55.32 x	60.00 Lin Ft	= \$	3,319.20	100.00 \$ 3,319.20
	Storm Sewer Lateral Install	618.00 x	1.00 Each	= \$	618.00	100.00 \$ 618.00
	Driveway 7" Concrete Approach	6.90 x	70.00 Sq Ft	= \$	483.00	100.00 \$ 483.00
					Total:	\$ 4,420.20



City of West Allis Engineering Department
Project Details P1622S

S. 79 St. from W. Greenfield Ave. to W. National Ave.

452-0238-000	1583 S 79 ST	William J Pond	Residential	530
Street Concrete Reconstruction	55.32 x 60.00 Lin Ft	= \$	3,319.20	100.00 \$ 3,319.20
			Total:	\$ 3,319.20
452-0525-000	7909 W LAPHAM & 1601 S 79	Richard K Stahle	Residential	540
Street Concrete Reconstruction	55.32 x 54.00 Lin Ft	= \$	2,987.28	100.00 \$ 2,987.28
			Total:	\$ 2,987.28
452-0526-000	1609 S 79 ST	Marni J Salazar-Kadesha	Residential	550
Street Concrete Reconstruction	55.32 x 60.00 Lin Ft	= \$	3,319.20	100.00 \$ 3,319.20
Storm Sewer Lateral Install	618.00 x 1.00 Each	= \$	618.00	100.00 \$ 618.00
Driveway 7" Concrete Approach	6.90 x 115.00 Sq Ft	= \$	793.50	100.00 \$ 793.50
			Total:	\$ 4,730.70
452-0527-000	1617 S 79 ST	Thomas Farrell & Janine Farrell	Residential	560
Street Concrete Reconstruction	55.32 x 40.00 Lin Ft	= \$	2,212.80	100.00 \$ 2,212.80
Storm Sewer Lateral Install	618.00 x 1.00 Each	= \$	618.00	100.00 \$ 618.00
Driveway 7" Concrete Approach	6.90 x 114.00 Sq Ft	= \$	786.60	100.00 \$ 786.60
			Total:	\$ 3,617.40
452-0528-000	1623 S 79 ST	Kevin Siebenlist & Ruth Siebenlist	Residential	570
Street Concrete Reconstruction	55.32 x 40.00 Lin Ft	= \$	2,212.80	100.00 \$ 2,212.80
Storm Sewer Lateral Install	618.00 x 1.00 Each	= \$	618.00	100.00 \$ 618.00
Driveway 7" Concrete Approach	6.90 x 112.00 Sq Ft	= \$	772.80	100.00 \$ 772.80
			Total:	\$ 3,603.60
452-0529-000	1629 S 79 ST	Richard C Boucher, Sr & Theresa A Kowalski	Residential	580
Street Concrete Reconstruction	55.32 x 40.00 Lin Ft	= \$	2,212.80	100.00 \$ 2,212.80
Storm Sewer Lateral Install	618.00 x 1.00 Each	= \$	618.00	100.00 \$ 618.00
Driveway 7" Concrete Approach	6.90 x 128.00 Sq Ft	= \$	883.20	100.00 \$ 883.20
			Total:	\$ 3,714.00



City of West Allis Engineering Department
 Project Details P1622S

S. 79 St. from W. Greenfield Ave. to W. National Ave.

452-0530-000	1635 S 79 ST	Ronald Schook			Residential	590
	Street Concrete Reconstruction	55.32 x	40.00 Lin Ft	= \$	2,212.80	100.00 \$ 2,212.80
	Storm Sewer Lateral Install	618.00 x	1.00 Each	= \$	618.00	100.00 \$ 618.00
					Total:	\$ 2,830.80
452-0531-000	1639 S 79 ST	Gerald A Popp			Commercial	600
	Street Concrete Reconstruction	69.15 x	40.00 Lin Ft	= \$	2,766.00	100.00 \$ 2,766.00
	Storm Sewer Lateral Install	1,428.00 x	1.00 Each	= \$	1,428.00	100.00 \$ 1,428.00
	Driveway 7" Concrete Approach	6.90 x	104.00 Sq Ft	= \$	717.60	100.00 \$ 717.60
					Total:	\$ 4,911.60
452-0532-000	1645 S 79 ST	Danielle Weiss			Residential	610
	Street Concrete Reconstruction	55.32 x	40.00 Lin Ft	= \$	2,212.80	100.00 \$ 2,212.80
	Storm Sewer Lateral Install	618.00 x	1.00 Each	= \$	618.00	100.00 \$ 618.00
	Driveway 7" Concrete Approach	6.90 x	117.00 Sq Ft	= \$	807.30	100.00 \$ 807.30
					Total:	\$ 3,638.10
452-0533-000	1651 S 79 ST	Edward T Stoller			Residential	620
	Street Concrete Reconstruction	55.32 x	40.00 Lin Ft	= \$	2,212.80	100.00 \$ 2,212.80
	Storm Sewer Lateral Install	618.00 x	1.00 Each	= \$	618.00	100.00 \$ 618.00
	Driveway 7" Concrete Approach	6.90 x	122.00 Sq Ft	= \$	841.80	100.00 \$ 841.80
					Total:	\$ 3,672.60
452-0534-000	1655-57 S 79 ST	Dennis D Stevens & Kathy Stevens			Residential	630
	Street Concrete Reconstruction	55.32 x	40.00 Lin Ft	= \$	2,212.80	100.00 \$ 2,212.80
	Storm Sewer Lateral Install	618.00 x	1.00 Each	= \$	618.00	100.00 \$ 618.00
	Driveway 7" Concrete Approach	6.90 x	130.00 Sq Ft	= \$	897.00	100.00 \$ 897.00
					Total:	\$ 3,727.80



City of West Allis Engineering Department
 Project Details P1622S

S. 79 St. from W. Greenfield Ave. to W. National Ave.

452-0535-000	1661-63 S 79 ST	Daniel J Wycklendt		Residential	640
Street Concrete Reconstruction	55.32 x	40.00 Lin Ft	= \$	2,212.80	\$ 2,212.80
Storm Sewer Lateral Install	618.00 x	1.00 Each	= \$	618.00	\$ 618.00
Driveway 7" Concrete Approach	6.90 x	87.00 Sq Ft	= \$	600.30	\$ 600.30
			Total:		\$ 3,431.10
452-0536-000	7902 W NATIONAL AVE	WestGlen Properties LLC		Commercial	650
Street Concrete Reconstruction	69.15 x	143.84 Lin Ft	= \$	9,946.54	\$ 3,978.62
Reduction Code Longside					
Driveway 7" Concrete Approach	6.90 x	127.00 Sq Ft	= \$	876.30	\$ 876.30
			Total:		\$ 4,854.92

Property Type Summary

4	Commercial
61	Residential



City of West Allis Engineering Department
 Project Details P1622S

S. 79 St. from W. Greenfield Ave. to W. National Ave.

Item Summary

	Total Quantity	Gross Total	Net Total
Driveway			
7" Concrete Approach	471.00 Sq Ft	\$3,249.90	\$3,249.90
Commercial			
Residential	4,189.00 Sq Ft	\$28,904.10	\$28,904.10
		<u>\$32,154.00</u>	<u>\$32,154.00</u>
Storm Sewer Lateral			
Install			
Commercial	2.00 Each	\$2,856.00	\$2,856.00
Residential	53.00 Each	\$32,754.00	\$32,754.00
		<u>\$35,610.00</u>	<u>\$35,610.00</u>
Street			
Concrete Reconstruction			
Commercial	423.84 Lin Ft	\$29,308.54	\$13,383.02
Residential	3,197.52 Lin Ft	\$176,886.80	\$169,119.87
		<u>\$206,195.34</u>	<u>\$182,502.89</u>
Grand Totals		<u>\$273,959.34</u>	<u>\$250,266.89</u>



City of West Allis Engineering Department
 Project Details P1625S

S. 85 St. from W. Washington St. to W. Greenfield Ave.

Property Assessments

442-0721-000	1100 S 85 ST	Rowena Williams		Residential	10
	Street Concrete Reconstruction	55.32 x	36.53 Lin Ft	= \$	2,020.84
	Storm Sewer Lateral Install	618.00 x	1.00 Each	= \$	618.00
				Total: \$	2,638.84
442-0720-000	1106 S 85 ST	Timothy B Kasten		Residential	20
	Street Concrete Reconstruction	55.32 x	39.00 Lin Ft	= \$	2,157.48
	Storm Sewer Lateral Install	618.00 x	1.00 Each	= \$	618.00
	Driveway 7" Concrete Approach	6.90 x	135.00 Sq Ft	= \$	931.50
				Total: \$	3,706.98
442-0719-000	1110 S 85 ST	Shirley D Wayne		Residential	30
	Street Concrete Reconstruction	55.32 x	39.00 Lin Ft	= \$	2,157.48
	Storm Sewer Lateral Install	618.00 x	1.00 Each	= \$	618.00
				Total: \$	2,775.48
442-0718-000	1116 S 85 ST	Sandra L Larson		Residential	40
	Street Concrete Reconstruction	55.32 x	39.00 Lin Ft	= \$	2,157.48
	Storm Sewer Lateral Install	618.00 x	1.00 Each	= \$	618.00
				Total: \$	2,775.48
442-0717-000	1122 S 85 ST	Robert M Yanacheck		Residential	50
	Street Concrete Reconstruction	55.32 x	39.00 Lin Ft	= \$	2,157.48
	Storm Sewer Lateral Install	618.00 x	1.00 Each	= \$	618.00
				Total: \$	2,775.48
442-0716-000	1126 S 85 ST	Danielle Marie Miller		Residential	60
	Street Concrete Reconstruction	55.32 x	39.00 Lin Ft	= \$	2,157.48
	Storm Sewer Lateral Install	618.00 x	1.00 Each	= \$	618.00
				Total: \$	2,775.48



City of West Allis Engineering Department
 Project Details P1625S

S. 85 St. from W. Washington St. to W. Greenfield Ave.

442-0715-000	1132 S 85 ST	Jeffrey A Maass & Susan Maass			Residential	70
	Street Concrete Reconstruction	55.32	x	39.00 Lin Ft	= \$ 2,157.48	100.00 \$ 2,157.48
	Storm Sewer Lateral Install	618.00	x	1.00 Each	= \$ 618.00	100.00 \$ 618.00
					Total: \$ 2,775.48	
442-0714-000	1204 S 85 ST	Dana A Ritzman & Peter Ritzman			Residential	80
	Street Concrete Reconstruction	55.32	x	39.00 Lin Ft	= \$ 2,157.48	100.00 \$ 2,157.48
	Storm Sewer Lateral Install	618.00	x	1.00 Each	= \$ 618.00	100.00 \$ 618.00
					Total: \$ 2,775.48	
442-0713-000	1208 S 85 ST	Dolores J Wilson			Residential	90
	Street Concrete Reconstruction	55.32	x	39.00 Lin Ft	= \$ 2,157.48	100.00 \$ 2,157.48
	Storm Sewer Lateral Install	618.00	x	1.00 Each	= \$ 618.00	100.00 \$ 618.00
					Total: \$ 2,775.48	
442-0712-000	1214 S 85 ST	Richard Carl Blomenkamp & Alicia A Blomenkar			Residential	100
	Street Concrete Reconstruction	55.32	x	39.00 Lin Ft	= \$ 2,157.48	100.00 \$ 2,157.48
	Storm Sewer Lateral Install	618.00	x	1.00 Each	= \$ 618.00	100.00 \$ 618.00
					Total: \$ 2,775.48	
442-0711-000	1220 S 85 ST	John Jay Oleskow			Residential	110
	Street Concrete Reconstruction	55.32	x	39.00 Lin Ft	= \$ 2,157.48	100.00 \$ 2,157.48
	Storm Sewer Lateral Install	618.00	x	1.00 Each	= \$ 618.00	100.00 \$ 618.00
					Total: \$ 2,775.48	
442-0710-000	1224 S 85 ST	1224 S 85 LLC			Residential	120
	Street Concrete Reconstruction	55.32	x	38.86 Lin Ft	= \$ 2,149.74	100.00 \$ 2,149.74
	Storm Sewer Lateral Install	618.00	x	1.00 Each	= \$ 618.00	100.00 \$ 618.00
					Total: \$ 2,767.74	



City of West Allis Engineering Department
Project Details P1625S

S. 85 St. from W. Washington St. to W. Greenfield Ave.

442-0618-000	1230 S 85 ST	Jeffrey G Grabowski	Residential	130
Street Concrete Reconstruction	55.32 x 36.23 Lin Ft	= \$	2,004.24	100.00 \$ 2,004.24
Storm Sewer Lateral Install	618.00 x 1.00 Each	= \$	618.00	100.00 \$ 618.00
Driveway 7" Concrete Approach	6.90 x 126.00 Sq Ft	= \$	869.40	100.00 \$ 869.40
			Total:	\$ 3,491.64
442-0619-000	1234 S 85 ST	Jerome Wissbroecker & Roxann L Wissbroecker	Residential	140
Street Concrete Reconstruction	55.32 x 35.00 Lin Ft	= \$	1,936.20	100.00 \$ 1,936.20
Storm Sewer Lateral Install	618.00 x 1.00 Each	= \$	618.00	100.00 \$ 618.00
Driveway 7" Concrete Approach	6.90 x 133.00 Sq Ft	= \$	917.70	100.00 \$ 917.70
			Total:	\$ 3,471.90
442-0620-000	1300-02 S 85 ST	Alfred S Wyremski	Residential	150
Street Concrete Reconstruction	55.32 x 40.00 Lin Ft	= \$	2,212.80	100.00 \$ 2,212.80
Storm Sewer Lateral Install	618.00 x 1.00 Each	= \$	618.00	100.00 \$ 618.00
Driveway 7" Concrete Approach	6.90 x 118.00 Sq Ft	= \$	814.20	100.00 \$ 814.20
			Total:	\$ 3,645.00
442-0621-000	1306 S 85 ST	Vernon A Hanley & Arlene Hanley	Residential	160
Street Concrete Reconstruction	55.32 x 40.00 Lin Ft	= \$	2,212.80	100.00 \$ 2,212.80
Storm Sewer Lateral Install	618.00 x 1.00 Each	= \$	618.00	100.00 \$ 618.00
Driveway 7" Concrete Approach	6.90 x 148.00 Sq Ft	= \$	1,021.20	100.00 \$ 1,021.20
			Total:	\$ 3,852.00
442-0622-000	1312 S 85 ST	Letty J Lewin	Residential	170
Street Concrete Reconstruction	55.32 x 40.00 Lin Ft	= \$	2,212.80	100.00 \$ 2,212.80
Storm Sewer Lateral Install	618.00 x 1.00 Each	= \$	618.00	100.00 \$ 618.00
Driveway 7" Concrete Approach	6.90 x 127.00 Sq Ft	= \$	876.30	100.00 \$ 876.30
			Total:	\$ 3,707.10



City of West Allis Engineering Department
 Project Details P1625S

S. 85 St. from W. Washington St. to W. Greenfield Ave.

442-0623-000	1318 S 85 ST	Richard W Day			Residential	180
	Street Concrete Reconstruction	55.32 x	40.00 Lin Ft	= \$	2,212.80	100.00 \$ 2,212.80
	Storm Sewer Lateral Install	618.00 x	1.00 Each	= \$	618.00	100.00 \$ 618.00
	Driveway 7" Concrete Approach	6.90 x	111.00 Sq Ft	= \$	765.90	100.00 \$ 765.90
					Total:	\$ 3,596.70
442-0624-000	1322 S 85 ST	Daniel Cesarz & Melissa Cesarz			Residential	190
	Street Concrete Reconstruction	55.32 x	40.00 Lin Ft	= \$	2,212.80	100.00 \$ 2,212.80
	Storm Sewer Lateral Install	618.00 x	1.00 Each	= \$	618.00	100.00 \$ 618.00
	Driveway 7" Concrete Approach	6.90 x	122.00 Sq Ft	= \$	841.80	100.00 \$ 841.80
					Total:	\$ 3,672.60
442-0625-000	1328 S 85 ST	William E Colton, Jr			Residential	200
	Street Concrete Reconstruction	55.32 x	40.00 Lin Ft	= \$	2,212.80	100.00 \$ 2,212.80
	Storm Sewer Lateral Install	618.00 x	1.00 Each	= \$	618.00	100.00 \$ 618.00
	Driveway 7" Concrete Approach	6.90 x	133.00 Sq Ft	= \$	917.70	100.00 \$ 917.70
					Total:	\$ 3,748.50
442-0626-000	1332 S 85 ST	William C Smith			Residential	210
	Street Concrete Reconstruction	55.32 x	40.00 Lin Ft	= \$	2,212.80	100.00 \$ 2,212.80
	Storm Sewer Lateral Install	618.00 x	1.00 Each	= \$	618.00	100.00 \$ 618.00
	Driveway 7" Concrete Approach	6.90 x	137.00 Sq Ft	= \$	945.30	100.00 \$ 945.30
					Total:	\$ 3,776.10
442-0627-000	1338 S 85 ST	Homebridge Financial Services Inc			Residential	220
	Street Concrete Reconstruction	55.32 x	40.00 Lin Ft	= \$	2,212.80	100.00 \$ 2,212.80
	Storm Sewer Lateral Install	618.00 x	1.00 Each	= \$	618.00	100.00 \$ 618.00
	Driveway 7" Concrete Approach	6.90 x	130.00 Sq Ft	= \$	897.00	100.00 \$ 897.00
					Total:	\$ 3,727.80



City of West Allis Engineering Department
 Project Details P1625S

S. 85 St. from W. Washington St. to W. Greenfield Ave.

442-0628-000	1344 S 85 ST	Debra Guardiola			Residential	230
	Street Concrete Reconstruction	55.32 x	40.00 Lin Ft	= \$	2,212.80	100.00 \$ 2,212.80
	Storm Sewer Lateral Install	618.00 x	1.00 Each	= \$	618.00	100.00 \$ 618.00
	Driveway 7" Concrete Approach	6.90 x	141.00 Sq Ft	= \$	972.90	100.00 \$ 972.90
					Total:	\$ 3,803.70
442-0629-000	1348-50 S 85 ST	James N Larson			Residential	240
	Street Concrete Reconstruction	55.32 x	40.00 Lin Ft	= \$	2,212.80	100.00 \$ 2,212.80
	Storm Sewer Lateral Install	618.00 x	1.00 Each	= \$	618.00	100.00 \$ 618.00
	Driveway 7" Concrete Approach	6.90 x	141.00 Sq Ft	= \$	972.90	100.00 \$ 972.90
					Total:	\$ 3,803.70
442-0630-000	1354 S 85 ST	Sean D Tetzlaff			Residential	250
	Street Concrete Reconstruction	55.32 x	40.00 Lin Ft	= \$	2,212.80	100.00 \$ 2,212.80
	Storm Sewer Lateral Install	618.00 x	1.00 Each	= \$	618.00	100.00 \$ 618.00
	Driveway 7" Concrete Approach	6.90 x	131.00 Sq Ft	= \$	903.90	100.00 \$ 903.90
					Total:	\$ 3,734.70
442-0631-000	1360 S 85 ST	Kathleen J Hugel			Residential	260
	Street Concrete Reconstruction	55.32 x	40.00 Lin Ft	= \$	2,212.80	100.00 \$ 2,212.80
	Storm Sewer Lateral Install	618.00 x	1.00 Each	= \$	618.00	100.00 \$ 618.00
	Driveway 7" Concrete Approach	6.90 x	83.00 Sq Ft	= \$	572.70	100.00 \$ 572.70
					Total:	\$ 3,403.50
442-0632-000	8436 W GREENFIELD AVE	T.J.K. Commercial Properties LLC			Commercial	270
	Street Concrete Reconstruction	69.15 x	120.00 Lin Ft	= \$	8,298.00	40.00 \$ 3,319.20
	Driveway 7" Concrete Approach	6.90 x	114.00 Sq Ft	= \$	786.60	100.00 \$ 786.60
					Total:	\$ 4,105.80



City of West Allis Engineering Department
 Project Details P1625S

S. 85 St. from W. Washington St. to W. Greenfield Ave.

442-0674-000	1103 S 85&8507 W WASHINGTON	Walter Scotty, Jr			Residential	280
	Street Concrete Reconstruction	55.32 x	36.92 Lin Ft	= \$	2,042.41	100.00 \$ 2,042.41
	Storm Sewer Lateral Install	618.00 x	1.00 Each	= \$	618.00	100.00 \$ 618.00
					Total:	\$ 2,660.41
442-0675-000	1107 S 85 ST	Amelia T Wilhelm			Residential	290
	Street Concrete Reconstruction	55.32 x	39.00 Lin Ft	= \$	2,157.48	100.00 \$ 2,157.48
	Storm Sewer Lateral Install	618.00 x	1.00 Each	= \$	618.00	100.00 \$ 618.00
					Total:	\$ 2,775.48
442-0676-000	1111 S 85 ST	Everette M Johnson			Residential	300
	Street Concrete Reconstruction	55.32 x	39.00 Lin Ft	= \$	2,157.48	100.00 \$ 2,157.48
	Storm Sewer Lateral Install	618.00 x	1.00 Each	= \$	618.00	100.00 \$ 618.00
					Total:	\$ 2,775.48
442-0677-000	1117 S 85 ST	Buddy L Williams			Residential	310
	Street Concrete Reconstruction	55.32 x	39.00 Lin Ft	= \$	2,157.48	100.00 \$ 2,157.48
	Storm Sewer Lateral Install	618.00 x	1.00 Each	= \$	618.00	100.00 \$ 618.00
					Total:	\$ 2,775.48
442-0678-000	1123 S 85 ST	Deborah Engel			Residential	320
	Street Concrete Reconstruction	55.32 x	39.00 Lin Ft	= \$	2,157.48	100.00 \$ 2,157.48
	Storm Sewer Lateral Install	618.00 x	1.00 Each	= \$	618.00	100.00 \$ 618.00
					Total:	\$ 2,775.48
442-0679-000	1127 S 85 ST	Richard J Olson			Residential	330
	Street Concrete Reconstruction	55.32 x	39.00 Lin Ft	= \$	2,157.48	100.00 \$ 2,157.48
	Storm Sewer Lateral Install	618.00 x	1.00 Each	= \$	618.00	100.00 \$ 618.00
					Total:	\$ 2,775.48



City of West Allis Engineering Department
 Project Details P1625S

S. 85 St. from W. Washington St. to W. Greenfield Ave.

442-0680-000	1133 S 85 ST	Gary C Henning		Residential	340
	Street Concrete Reconstruction	55.32 x	39.00 Lin Ft	= \$ 2,157.48	100.00 \$ 2,157.48
	Storm Sewer Lateral Install	618.00 x	1.00 Each	= \$ 618.00	100.00 \$ 618.00
				Total:	\$ 2,775.48
442-0681-000	1205-07 S 85 ST	Alan R Stout & Kathleen Stout		Residential	350
	Street Concrete Reconstruction	55.32 x	39.00 Lin Ft	= \$ 2,157.48	100.00 \$ 2,157.48
	Storm Sewer Lateral Install	618.00 x	1.00 Each	= \$ 618.00	100.00 \$ 618.00
				Total:	\$ 2,775.48
442-0682-000	1209-11 S 85 ST	Arthur J Senger, Jr		Residential	360
	Street Concrete Reconstruction	55.32 x	39.00 Lin Ft	= \$ 2,157.48	100.00 \$ 2,157.48
	Storm Sewer Lateral Install	618.00 x	1.00 Each	= \$ 618.00	100.00 \$ 618.00
	Driveway 7" Concrete Approach	6.90 x	124.00 Sq Ft	= \$ 855.60	100.00 \$ 855.60
				Total:	\$ 3,631.08
442-0683-000	1215 S 85 ST	John P Treder		Residential	370
	Street Concrete Reconstruction	55.32 x	39.00 Lin Ft	= \$ 2,157.48	100.00 \$ 2,157.48
	Storm Sewer Lateral Install	618.00 x	1.00 Each	= \$ 618.00	100.00 \$ 618.00
				Total:	\$ 2,775.48
442-0684-000	1221 S 85 ST	Carol A Walloch		Residential	380
	Street Concrete Reconstruction	55.32 x	39.00 Lin Ft	= \$ 2,157.48	100.00 \$ 2,157.48
	Storm Sewer Lateral Install	618.00 x	1.00 Each	= \$ 618.00	100.00 \$ 618.00
				Total:	\$ 2,775.48
442-0685-000	1225 S 85 ST	Matt D Abstetar		Residential	390
	Street Concrete Reconstruction	55.32 x	34.30 Lin Ft	= \$ 1,897.48	100.00 \$ 1,897.48
	Storm Sewer Lateral Install	618.00 x	1.00 Each	= \$ 618.00	100.00 \$ 618.00
				Total:	\$ 2,515.48



City of West Allis Engineering Department
 Project Details P1625S

S. 85 St. from W. Washington St. to W. Greenfield Ave.

Account Number	Description	City Of West Allis	City Of West Allis	Exempt Local	400
442-0601-000	Street Concrete Reconstruction	55.32 x	4.56 Lin Ft	252.26	0.00
	Exempt Property Charged as Residential				0.00
				<u>Total: \$</u>	<u>0.00</u>
442-0649-000	Street Concrete Reconstruction	55.32 x	35.94 Lin Ft	1,988.20	1,988.20
	Storm Sewer Lateral Install	618.00 x	1.00 Each	618.00	618.00
				<u>Total: \$</u>	<u>2,606.20</u>
442-0648-000	Street Concrete Reconstruction	55.32 x	35.00 Lin Ft	1,936.20	1,936.20
	Storm Sewer Lateral Install	618.00 x	1.00 Each	618.00	618.00
	Driveway 7" Concrete Approach	6.90 x	139.00 Sq Ft	959.10	959.10
				<u>Total: \$</u>	<u>3,513.30</u>
442-0647-000	Street Concrete Reconstruction	55.32 x	40.00 Lin Ft	2,212.80	2,212.80
	Storm Sewer Lateral Install	618.00 x	1.00 Each	618.00	618.00
	Driveway 7" Concrete Approach	6.90 x	129.00 Sq Ft	890.10	890.10
				<u>Total: \$</u>	<u>3,720.90</u>
442-0646-000	Street Concrete Reconstruction	55.32 x	40.00 Lin Ft	2,212.80	2,212.80
	Storm Sewer Lateral Install	618.00 x	1.00 Each	618.00	618.00
	Driveway 7" Concrete Approach	6.90 x	132.00 Sq Ft	910.80	910.80
				<u>Total: \$</u>	<u>3,741.60</u>



City of West Allis Engineering Department
Project Details P1625S

S. 85 St. from W. Washington St. to W. Greenfield Ave.

442-0645-000	1313 S 85 ST	William M Cooper			Residential	450
	Street Concrete Reconstruction	55.32	x	40.00 Lin Ft	= \$ 2,212.80	100.00 \$ 2,212.80
	Storm Sewer Lateral Install	618.00	x	1.00 Each	= \$ 618.00	100.00 \$ 618.00
	Driveway 7" Concrete Approach	6.90	x	136.00 Sq Ft	= \$ 938.40	100.00 \$ 938.40
					Total: \$ 3,769.20	
442-0644-000	1319 S 85 ST	Gerald Roepke & Carolyn Roepke			Residential	460
	Street Concrete Reconstruction	55.32	x	40.00 Lin Ft	= \$ 2,212.80	100.00 \$ 2,212.80
	Storm Sewer Lateral Install	618.00	x	1.00 Each	= \$ 618.00	100.00 \$ 618.00
	Driveway 7" Concrete Approach	6.90	x	141.00 Sq Ft	= \$ 972.90	100.00 \$ 972.90
					Total: \$ 3,803.70	
442-0643-000	1323 S 85 ST	Antonina Larson & Stephen Larson			Residential	470
	Street Concrete Reconstruction	55.32	x	40.00 Lin Ft	= \$ 2,212.80	100.00 \$ 2,212.80
	Storm Sewer Lateral Install	618.00	x	1.00 Each	= \$ 618.00	100.00 \$ 618.00
	Driveway 7" Concrete Approach	6.90	x	139.00 Sq Ft	= \$ 959.10	100.00 \$ 959.10
					Total: \$ 3,789.90	
442-0642-000	1329 S 85 ST	Donald Seefeldt & Yvonne Lewin-Seefeldt			Residential	480
	Street Concrete Reconstruction	55.32	x	40.00 Lin Ft	= \$ 2,212.80	100.00 \$ 2,212.80
	Storm Sewer Lateral Install	618.00	x	1.00 Each	= \$ 618.00	100.00 \$ 618.00
	Driveway 7" Concrete Approach	6.90	x	140.00 Sq Ft	= \$ 966.00	100.00 \$ 966.00
					Total: \$ 3,796.80	
442-0641-000	1333 S 85 ST	Ryan Schmidt & Anna Schmidt			Residential	490
	Street Concrete Reconstruction	55.32	x	40.00 Lin Ft	= \$ 2,212.80	100.00 \$ 2,212.80
	Storm Sewer Lateral Install	618.00	x	1.00 Each	= \$ 618.00	100.00 \$ 618.00
	Driveway 7" Concrete Approach	6.90	x	132.00 Sq Ft	= \$ 910.80	100.00 \$ 910.80
					Total: \$ 3,741.60	



City of West Allis Engineering Department
Project Details P1625S

S. 85 St. from W. Washington St. to W. Greenfield Ave.

442-0640-000	1339 S 85 ST	Richard R Riege & Jane E Riege			Residential	500
	Street Concrete Reconstruction	55.32	x	40.00 Lin Ft	= \$ 2,212.80	100.00 \$ 2,212.80
	Storm Sewer Lateral Install	618.00	x	1.00 Each	= \$ 618.00	100.00 \$ 618.00
	Driveway 7" Concrete Approach	6.90	x	140.00 Sq Ft	= \$ 966.00	100.00 \$ 966.00
					Total: \$ 3,796.80	
442-0639-000	1345 S 85 ST	Robert Rehlinger & Rita Rehlinger			Residential	510
	Street Concrete Reconstruction	55.32	x	40.00 Lin Ft	= \$ 2,212.80	100.00 \$ 2,212.80
	Storm Sewer Lateral Install	618.00	x	1.00 Each	= \$ 618.00	100.00 \$ 618.00
	Driveway 7" Concrete Approach	6.90	x	139.00 Sq Ft	= \$ 959.10	100.00 \$ 959.10
					Total: \$ 3,789.90	
442-0638-000	1349 S 85 ST	Daniel A Fenske			Residential	520
	Street Concrete Reconstruction	55.32	x	40.00 Lin Ft	= \$ 2,212.80	100.00 \$ 2,212.80
	Storm Sewer Lateral Install	618.00	x	1.00 Each	= \$ 618.00	100.00 \$ 618.00
	Driveway 7" Concrete Approach	6.90	x	138.00 Sq Ft	= \$ 952.20	100.00 \$ 952.20
					Total: \$ 3,783.00	
442-0637-000	1355 S 85 ST	Daniel J Folkman & Rebecca S Folkman			Residential	530
	Street Concrete Reconstruction	55.32	x	40.00 Lin Ft	= \$ 2,212.80	100.00 \$ 2,212.80
	Storm Sewer Lateral Install	618.00	x	1.00 Each	= \$ 618.00	100.00 \$ 618.00
	Driveway 7" Concrete Approach	6.90	x	142.00 Sq Ft	= \$ 979.80	100.00 \$ 979.80
					Total: \$ 3,810.60	
442-0636-000	1361 S 85 ST	Patrick W Mc Carthy & Pamela S Mc Carthy			Residential	540
	Street Concrete Reconstruction	55.32	x	40.00 Lin Ft	= \$ 2,212.80	100.00 \$ 2,212.80
	Storm Sewer Lateral Install	618.00	x	1.00 Each	= \$ 618.00	100.00 \$ 618.00
	Driveway 7" Concrete Approach	6.90	x	90.00 Sq Ft	= \$ 621.00	100.00 \$ 621.00
					Total: \$ 3,451.80	



City of West Allis Engineering Department
 Project Details P1625S

S. 85 St. from W. Washington St. to W. Greenfield Ave.

442-0670-001	8500 W GREENFIELD AVE & 1373 S 85 ST	Kenneth Baranowski			550
Street Concrete Reconstruction		69.15 x	120.00 Lin Ft	= \$ 8,298.00	40.00 \$ 3,319.20
Reduction Code Longside					
Driveway 7" Concrete Approach		6.90 x	177.00 Sq Ft	= \$ 1,221.30	100.00 \$ 1,221.30
				Total: \$	<u>4,540.50</u>

Property Type Summary

2	Commercial
53	Residential



City of West Allis Engineering Department
 Project Details P1625S

S. 85 St. from W. Washington St. to W. Greenfield Ave.

Item Summary

	Total Quantity	Gross Total	Net Total
Driveway			
7" Concrete Approach	291.00 Sq Ft	\$2,007.90	\$2,007.90
Commercial			
Residential	3,777.00 Sq Ft	\$26,061.30	\$26,061.30
		<u>\$28,069.20</u>	<u>\$28,069.20</u>
Storm Sewer Lateral			
Install	52.00 Each	\$32,136.00	\$32,136.00
Residential		<u>\$32,136.00</u>	<u>\$32,136.00</u>
Street			
Concrete Reconstruction	240.00 Lin Ft	\$16,596.00	\$6,638.40
Commercial			
Residential	2,033.34 Lin Ft	\$112,484.37	\$112,232.11
		<u>\$129,080.37</u>	<u>\$118,870.51</u>
Grand Totals		\$189,285.57	\$179,075.71