

**ADDENDUM #1
TRAIL BRIDGE
State Project 1693-32-74**

THIS LICENSE ADDENDUM #1 made and entered into this 20th day of February, 2018, by and between **WISCONSIN ELECTRIC POWER COMPANY**, a Wisconsin corporation, doing business as We Energies, (hereinafter "Licensor") and **CITY OF WEST ALLIS**, (hereinafter "Licensee").

WITNESSETH

BY LICENSE AGREEMENT, entered into the 10th day of November, 2011 by and between said Licensor and Licensee license, wherein Licensor granted Licensee the right, permission and authority to develop and use a part of Licensor's fee owned right of way lands for the purpose of hiking, biking, and cross-country skiing and other similar non-motorized recreational uses for use by the general public, and

WHEREAS, Licensee has requested Licensor to permit the inclusion of additional right of way lands of Licensor for the expansion the recreational trail and to permit construction and installation of a pedestrian bridge over Highway 100 south of Greenfield Avenue, being more particularly described as:

A portion of Company's right of way land in the Northwest ¼ of Section 5, Township 6 North, Range 21 East in the City of West Allis, Milwaukee County, Wisconsin (hereinafter "Lands"). The location of the land is shown and shaded in yellow on the attached map marked Exhibit "A", and made a part hereof.

NOW, THEREFORE, for and in consideration of covenants, conditions and agreements hereinafter contained and for the mutual benefit of Licensor and Licensee, both parties hereby agree to the following:

1. Licensor hereby agrees to make part of said License those additional right of way shaded in pink as lands referenced in said Exhibit "A". Additional requirements for the bridge and bridge piers are attached and referenced as Exhibit "B", and made a part hereof. Licensee will construct bridge based off the plans submitted and dated and accepted by West Allis 10/24/2017.
2. Licensee agrees that all work done in proximity of any electric line facilities shall be performed in conformance with the provisions and requirements of all applicable laws, rules and regulations, including without limitation all laws, rules and regulations such as O.S.H.A. Safety and Health Regulations of Construction dealing with safe work practices and the operation of equipment near electrical lines and equipment, and the provisions of the Wisconsin State Electrical Code and any amendments thereto. A minimum of a 12' clearance from all overhead electric facilities must be maintained at all times. A 10' clearance from any underground electric or gas facilities must be maintained at all times.

Note: O.S.H.A. Rules may require greater distances than Licensor's minimum clearances listed depending on type of work being done. Please follow O.S.H.A. when it is greater than Licensor's minimum clearances.

3. Licensee agrees to contact "Digger's Hotline" at (800) 242-8511 at least five (5) days prior to any work, excavation or construction of trail or bridge, as permitted herein, in order to determine the location of any electric, telephone, gas, or any other utility facilities within the Lands of Licensor and the applicable clearance requirements for work performed in proximity to such facilities.
4. Licensee agrees to contact Rollie Simatic (414) 944-5955 or (414) 315-1350 or such other person or phone number as Licensor may from time to time designate, within the specified time limits to inform him about the following occurrences:
 - a) At least seven (7) days prior to the commencement of the project herein permitted or future approved projects.
 - b) Within seven (7) calendar days after the termination of the License with a plan for restoration in accordance with the requirements of Section 15 of License.
 - c) Within seven (7) calendar days after the restoration has been completed.
 - d) Within seven (7) calendar days after a lapse of one (1) year since Licensee accepted this License Addendum if the project herein permitted has not been undertaken by such date.
5. No stockpiling or staging of equipment or materials within the Lands is permitted at any time. Unobstructed access of the Lands must be maintained at all times.
6. If Licensee requests to alter or change the approved plans or adds any work to that already approved, requested changes and additions must be submitted to Licensor for further review or approval.
7. Licensee agrees that pedestrian bridge belongs to the Licensee (City of West Allis) and Licensee is responsible for installation, replacement, maintenance, and removal of bridge at its sole cost. Licensee also agrees that any retaining walls, fencing, bridge lighting and/or other items not mentioned but installed by Licensee will be installed, replaced, maintained, and removed at the sole cost of the Licensee.
8. Licensee shall post on both sides of bridge entry the maximum weight that bridge can support and that no motorized vehicles are allowed on bridge at any time.
9. Licensor must review plans prior to installation for final approval. Please allow a minimum of 30 days for review of plans before construction.
10. This License Addendum #1 shall be deemed a part of and incorporated into the License. All other terms, conditions and provisions of the License shall remain in full force and effect.

In witness whereof Licensor and Licensee have executed this document this 22nd day of February 2018.

WISCONSIN ELECTRIC POWER COMPANY

By James T. Raabe (Licensor)
James T. Raabe, Manager of Property Management

CITY OF WEST ALLIS

(Licensee)

By Dan Devine
Daniel Devine, Mayor

By _____

Print Name and Title Dan Devine, Mayor

**STATE OF WISCONSIN
DEPARTMENT OF TRANSPORTATION
PLAN OF PROPOSED IMPROVEMENT
CROSS-TOWN CONNECTOR BRIDGE
OVER STH 100
(NON-HWY)
MILWAUKEE COUNTY**

STATE PROJECT	FEDERAL PROJECT
1693-32-74	
	CONTRACT

EXHIBIT A

STATE PROJECT NUMBER
1693-32-74

ACCEPTED FOR
City of West Allis

ORIGINAL PLANS PREPARED BY
Singh Engineers
Scientists
Consultants

WISCONSIN PROFESSIONAL ENGINEER
MICHAEL C. CASPER
No. 12284
ROBERT WASHINGTON
No. 12285
WISCONSIN PROFESSIONAL LAND SURVEYOR

DATE: _____
Prepared by: _____
Checked by: _____
Management Consultant: _____
DATE: 10/25/17
Management Consultant: _____

STATE OF WISCONSIN
DEPARTMENT OF TRANSPORTATION

PREPARED BY: _____
CHECKED BY: _____
MANAGEMENT CONSULTANT: _____

APPROVED FOR THE PLAN BY: _____
DATE: 10/25/17
Management Consultant: _____

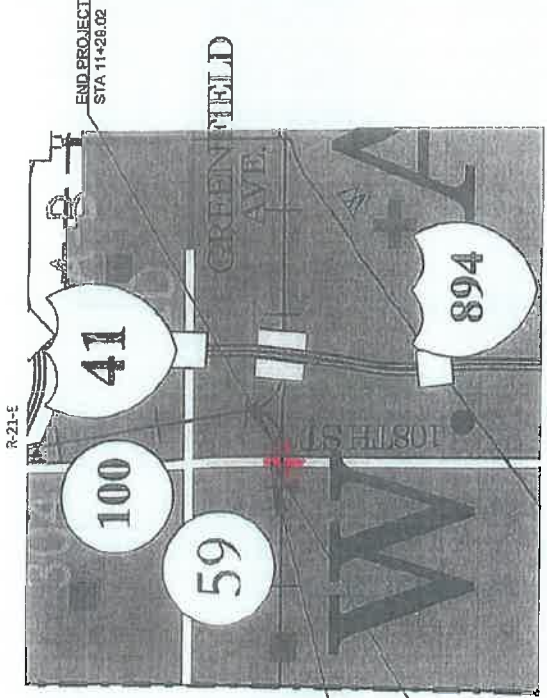

HORIZONTAL POSITIONS SHOWN ON THIS PLAN ARE WISCONSIN COUNTY COORDINATES. IN WAUKESHA COUNTY, INLAND COORDINATES IN US SURVEY FEET, AND DISTANCES MAY BE USED AS GROUND DISTANCES. ELEVATIONS SHOWN ON THIS PLAN ARE DISTANCES TO THE NORTH AMERICAN VERTICAL DATUM, NAVD83 (2011).

- ORDER OF SHEETS**
- 1 Typical Sections and Details
 - 2 Estimate of Quantities
 - 3 Miscellaneous Quantities
 - 4 Right of Way Plan
 - 5 Plans and Profiles
 - 6 Standard Detail Estimating
 - 7 Sign Plans
 - 8 Structure Plans
 - 9 Conspicuous Elevation Data
 - 10 Cross Sections
- TOTAL SHEETS =



- DESIGN DESIGNATION**
- AA-BT N/A
 - AA-BT N/A
 - OHV N/A
 - OD N/A
 - DISSEMINATED N/A
 - ENR N/A

- CONVENTIONAL SYMBOLS**
- PROFILES
 - GRADE LINE
 - PROPERTY LINE
 - PROPERTY LINE
 - LIMITED HIGHWAY RIGHT-OF-WAY
 - EXISTING RIGHT-OF-WAY
 - PROPOSED OR NEW PAVEMENT
 - SLOPE INTERCEPT
 - REFERENCE LINE
 - EXISTING CURVE
 - PROPOSED CURVE
 - COMBUSTIBLE FLUIDS
 - EXPOSED AREA
 - WOODDED OR SPRING AREA
- PROFILE**
- GRADE LINE
 - PROPERTY LINE
 - PROPERTY LINE
 - SPECIAL DITCH
 - GRADE ELEVATION
 - CULVERT (Pier or Box)
 - UTILITIES
 - ELECTRIC
 - PROP. OPTIC
 - GAS
 - SAWTEETH SEWER
 - SYSTEMS/SEWER
 - TELEPHONE
 - WATER
 - UTILITY PILE/STAKE
 - POWDER POLE
 - TELEPHONE POLE

FIG. 1693-32-74-01 CROSS-TOWN CONNECTOR BRIDGE OVER STH 100 (NON-HWY) MILWAUKEE COUNTY, WISCONSIN

EXHIBIT "B"

Gas Pipeline in land South 108th Street by Offset Pier Support

We Energies Gas Department is in full support of this alternative design along with these stipulations that need to be added to your Special Provisions:

1. Joe Thom (We Energies area Operations Supervisor) shall be contacted 2 weeks prior to the bridge contractor exposing the 24" gas main. Joe Thom's direct number is 414-389-4373.
2. A watchdog (which will be set up via Digger's Hotline) must be informed prior to any ground disturbances within 10' of either side of the 24" gas. The watchdog will then work with the contractor to determine when to be on site based upon the contractor's schedule. The watchdog will communicate with Joe Thom should any We Energies gas crews need to come out to evaluate the integrity of the pipe during the construction of the bridge pier.
3. The contractor shall be responsible and be equipped to support the exposed and suspended gas main as necessary. An Operations Engineer must be notified once the excavation size limits are determined to evaluate the need and requirements to support the pipe and to answer any related questions. The area Operations Engineer is Nasir Barud. Nasir's direct number is 414-221-5591.
4. This 24" main was installed in 1949. The wrap on this main will most likely contain hazardous materials. We Energies service center crews will need to re-wrap the 24" main in the areas of where it is exposed. Once the main is exposed and supported, service center crews will evaluate and re-wrap the pipe as necessary. We Energies will be responsible for the removal and disposal of any hazardous material that comes off the pipe. We Energies will need to utilize the existing lane closures along STH 100 for mobilization and also need a two week window to complete the re-wrap of the pipe. This schedule is weather dependent.
5. Once the final concrete footing and pier is set and complete, there will need to be 18" of horizontal clearance between the 24" main and the bridge pier. There will need to be 24" of vertical clearance between the footing and the 24" gas main. The watchdog and We Energies Service Center will determine if any rock shield is necessary to be placed between the gas and the footing and implement it as such.
6. Slurry sand will be required to backfill over the exposed 24" gas main. This slurry sand (just water and sand) will need to cover the 24" main so that there is a 6" thick layer over the top of the gas main. Once a 6" layer of slurry sand is poured over the 24" gas main, a #1 state slurry or any other aggregate backfill (as the bridge engineer sees fit) that does not contain cement may be used for the remainder of the excavation. We Energies will need to be able to access this pipe for any future maintenance after the construction is complete.
7. Licensee shall create formal plans for the bridge pier offset, crossing South 108th Street and incorporate them into the WDOT Plans Project Number 1693-32-74. Licensee will resubmit formal plan to Licensor for final review regarding the off-set pier. Licensor will submit final plans well ahead construction time, for formal approval from Licensor. Bridge cannot be installed without this final approval.