



City of West Allis Matter Summary

7525 W. Greenfield Ave.
West Allis, WI 53214

| File Number | Title | Status |
|-------------|-------|--------|
|-------------|-------|--------|

R-2003-0023 Resolution In Committee

Resolution to confirm and adopt the report of the City Engineer containing the schedule of proposed assessments for improvement of East/West alley between S. Livingston Terr., S. 67 Pl., W. Grant St. and W. Beloit Rd. by removal and reconstruction of the concrete alley pavement, storm sewer, storm sewer relay, building services, utility adjustments and storm underdrain.

Introduced: 01/21/2003

Controlling Body: Public Works Committee

COMMITTEE RECOMMENDATION

Approve & Adopt

MOVER: Sengstock AYES 5 NOES _____

SECONDER: Vitale EXCUSED _____

COMMITTEE ACTION DATE 1-21-03

SIGNATURES OF COMMITTEE MEMBERS

Rubel
Chair

Vice-Chair

COMMON COUNCIL ACTION adopted

FINAL ACTION DATE 1-21-03

MOVER:
Narlock

SECONDER:
Vitale

| | AYE | NO |
|---------------|-----------|-------|
| 1. Barczak | ✓ | _____ |
| 2. Czaplewski | ✓ | _____ |
| 3. Kopplin | ✓ | _____ |
| 4. Lajsic | ✓ | _____ |
| 5. Murphy | ✓ | _____ |
| 6. Narlock | ✓ | _____ |
| 7. Reinke | ✓ | _____ |
| 8. Sengstock | ✓ | _____ |
| 9. Trudell | ✓ | _____ |
| 10. Vitale | ✓ | _____ |
| TOTAL | <u>10</u> | _____ |

cc: engineer
pu
france



City of West Allis

7525 W. Greenfield Ave.
West Allis, WI 53214

Resolution

File Number: R-2003-0023

Final Action:

1-21-03

Resolution to confirm and adopt the report of the City Engineer containing the schedule of proposed assessments for improvement of East/West alley between S. Livingston Terr., S. 67 Pl., W. Grant St. and W. Beloit Rd. by removal and reconstruction of the concrete alley pavement, storm sewer, storm sewer relay, building services, utility adjustments and storm underdrain.

WHEREAS, The City Engineer, pursuant to Preliminary Resolution No. 27248, adopted on December 3, 2002, prepared and submitted his report as provided in sec. 66.0703(5) of the Wisconsin Statutes, for the improvement of the alley as hereinafter described; and,

WHEREAS, The City Clerk/Treasurer gave due notice that such report was open for inspection at his office and also at the office of the City Engineer, and that all persons interested could appear before the Common Council and be heard concerning the matters contained in the Preliminary Resolution and Report; and,

WHEREAS, The Common Council met pursuant to such notice, at the time and place therein named; and having considered all statements and communications concerning the proposed improvements, relating to the matters contained in the City Engineer's report, including the schedule of proposed assessments, the Common Council makes no change in said report.

NOW, THEREFORE, BE IT RESOLVED By the Common Council of the City of West Allis:

1. The report of the City Engineer, including the schedule of the proposed assessments, for the improvement of East/West alley between S. Livingston Terr., S. 67 Pl., W. Grant St. and W. Beloit Rd. by removal and reconstruction of the concrete alley pavement, storm sewer, storm sewer relay, building services, utility adjustments and storm underdrain be and the same is hereby approved and adopted.
2. The property against which the assessments are proposed is benefited; the assessments shown on the report are true and correct, have been determined on a reasonable basis and are hereby confirmed.
3. The City Engineer is hereby authorized and directed to prepare final plans for the aforesaid area in accordance with the terms of this resolution.

Eng03-20

ADOPTED Jan. 21, 2003
Paul M. Ziehler
Paul M. Ziehler, Acting City Clerk/Treasurer

APPROVED January 27, 2003
Jeannette Bell
Jeannette Bell, Mayor



CITY OF WEST ALLIS

WISCONSIN



Engineering Department

MICHAEL G. LEWIS
City Engineer

January 21, 2003

Honorable Mayor and Common Council
West Allis, Wisconsin

Dear Mayor and Council Members:

I herewith respectfully submit my report on the assessment of benefits for removal and reconstruction of the concrete alley pavement, storm sewer, storm sewer relay, building services, utility adjustments and storm underdrain in:

**East/West alley between S. Livingston Terr., S. 67 Pl., W. Grant St. and
W. Beloit Rd.**

as directed in Preliminary Resolution No. 27248, adopted on December 3, 2002.

This report consists of the following schedules attached hereto:

- Schedule A. - Preliminary Plans and Specifications;
- Schedule B. - Estimate of Entire Cost of Proposed Improvements;
- Schedule C. - Schedule of Proposed Assessments Against Each Parcel Affected.

The property against which the assessments are proposed is benefited.

Respectfully submitted,

Michael G. Lewis, P.E.
City Engineer

MGL:jb

Encs.

H:\2003 Projects\1031071 CC.doc

PROPOSED IMPROVEMENT OF

East/West alley between S. Livingston Terr., S. 67 Pl., W. Grant St. and W. Beloit Rd.

by removal and reconstruction of the concrete alley pavement, storm sewer, storm sewer relay, building services, utility adjustments and storm underdrain.

SCHEDULE "A"

Preliminary Plans & Specifications Attached

SCHEDULE "B"

Estimate of the Entire Cost

\$49,500

SCHEDULE "C"

Schedule of Proposed Assessments
Against Each Parcel Affected

LIVINGSTON
ST.

W. GRANT ST.

S. 67 PL.

W. BELOIT RD.

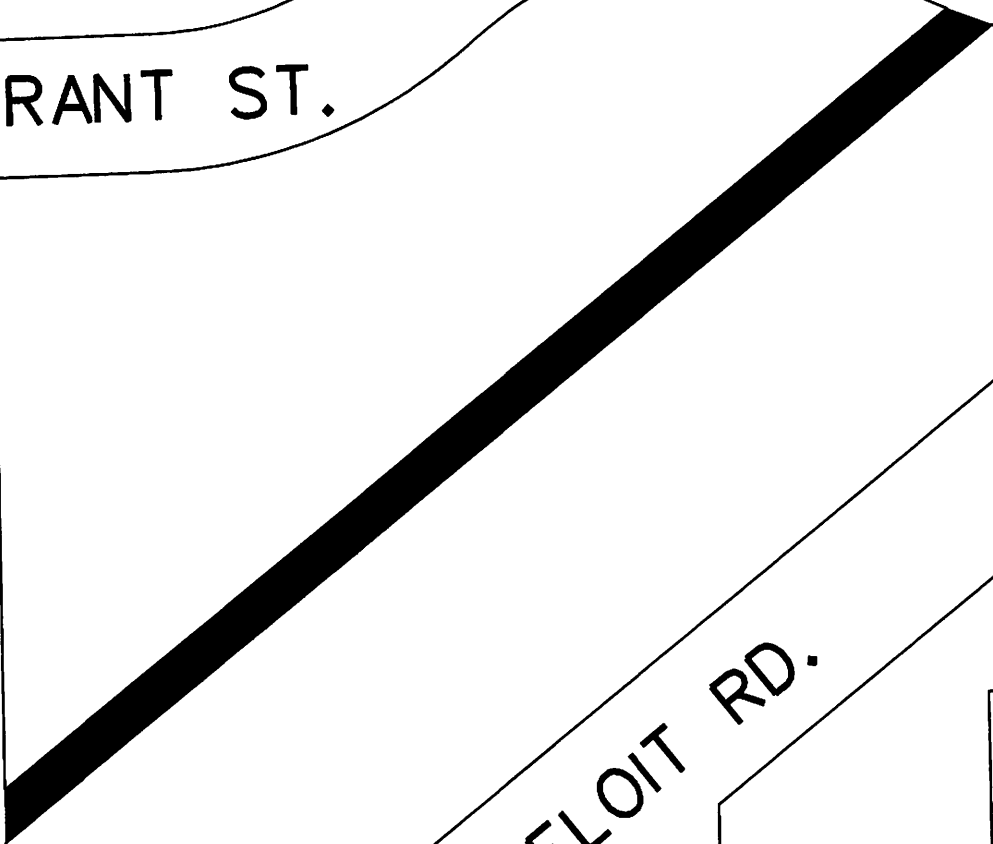



CITY OF WEST ALLIS

WISCONSIN



Engineering Department

MICHAEL G. LEWIS
City Engineer

January 21, 2003

Board of Public Works
West Allis City Hall
West Allis, Wisconsin

Dear Board Members:

I am herewith submitting preliminary plans and an estimate of costs for removal and reconstruction of the concrete alley pavement, storm sewer, storm sewer relay, building services, utility adjustments and storm underdrain in:

**East/West alley between S. Livingston Terr., S. 67 Pl., W. Grant St. and
W. Beloit Rd.**

| | |
|------------------------------|------------------|
| Estimated Construction Cost: | \$ 45,000 |
| Contingency: | <u>4,500</u> |
| TOTAL: | \$ 49,500 |

Sincerely,

Michael G. Lewis, P.E.
City Engineer

MGL:jb

H:\2003 Projects\1031071 BPW.doc

ASSESSMENT REPORT FOR COUNCIL

HEARING DATE: January 21, 2003

LOCATION

**DESCRIPTION: East/West alley between S. Livingston Terr., S. 67 Pl.,
W. Grant St. and W. Beloit Rd.**

ACCOUNT NO.: 1031071

INTEREST RATE: 6.0%

| <u>2003 ASSESSMENT RATES</u> | <u>Resid.</u> | <u>Comm.</u> | <u>Mfg.</u> |
|------------------------------|---------------|--------------|-------------|
| <u>16' Wide Alley</u> | | | |
| Reconstruct, per Lin. Ft. | \$16.68 | \$20.85 | |

The properties against which the assessments are proposed are benefited.

SPECIALS BY PROJECT INDEX

RUN # SPL015C 01/13/03

| KEY | NET | GROSS | PAGE | ADDRESS |
|----------------|----------|----------|------|-------------------------|
| 475 0191 001 1 | 1,689.89 | 1,689.89 | 2 | 66** W BELOIT RD |
| 475 0194 000 1 | 667.20 | 667.20 | 2 | 6620-22 W BELOIT RD |
| 475 0195 001 1 | 3,177.96 | 3,177.96 | 2 | 6640 & 6700 W BELOIT RD |
| 475 0195 002 1 | 1,668.00 | 1,668.00 | 2 | 6626 W BELOIT RD |
| 475 0197 001 1 | 1,266.51 | 1,782.59 | 2 | 2222-24 S 67 PL |
| 475 0198 000 1 | 477.05 | 477.05 | 1 | 2216-18 S 67 PL |
| 475 0202 000 1 | 939.08 | 965.77 | 1 | 6723 W GRANT ST |
| 475 0203 000 1 | 940.42 | 1,064.18 | 1 | 6717 W GRANT ST |
| 475 0204 000 1 | 816.32 | 816.32 | 1 | 6715 W GRANT ST |
| 475 0205 000 1 | 362.29 | 362.29 | 1 | 6705 W GRANT ST |
| 475 0206 000 1 | 541.10 | 541.10 | 1 | 6635 W GRANT ST |
| 475 0207 000 1 | 718.41 | 1,229.32 | 1 | 6625 W GRANT ST |

| KEY | ADDRESS | OWNER | CLASS | FRONT FOOT | | | |
|----------------|---|-------------------------|-------|----------------------|---------|------------------|-----------------|
| 475-0207-000 1 | 6625 W GRANT ST | ASP GERALD A & MICHELE | 4 | 44.02 | 140 | | |
| | DESCRIPTION | FOOTAGE | RATE | GROSS | PERCENT | NET | |
| | ALLEY-CONCRETE RECONSTRUCT 16' WIDE - RES | 73.70 | 16.68 | 1,229.32 1,229.32 | 58.44 | 718.41 718.41 | RECTANGULARIZED |
| ----- | | | | | | | |
| 475-0206-000 1 | 6635 W GRANT ST | PLAHUTA ROBERT M | 4 | 53.77 | 150 | | |
| | DESCRIPTION | FOOTAGE | RATE | GROSS | PERCENT | NET | |
| | ALLEY-CONCRETE RECONSTRUCT 16' WIDE - RES | 32.44 | 16.68 | 541.10 541.10 | 100.00 | 541.10 541.10 | |
| ----- | | | | | | | |
| 475-0205-000 1 | 6705 W GRANT ST | JONES MALDWYN & EVELYN | 4 | 50.68 | 160 | | |
| | DESCRIPTION | FOOTAGE | RATE | GROSS | PERCENT | NET | |
| | ALLEY-CONCRETE RECONSTRUCT 16' WIDE - RES | 21.72 | 16.68 | 362.29 362.29 | 100.00 | 362.29 362.29 | |
| ----- | | | | | | | |
| 475-0204-000 1 | 6715 W GRANT ST | CISEWSKI JENNIFER | 4 | 42.70 | 170 | | |
| | DESCRIPTION | FOOTAGE | RATE | GROSS | PERCENT | NET | |
| | ALLEY-CONCRETE RECONSTRUCT 16' WIDE - RES | 48.94 | 16.68 | 816.32 816.32 | 100.00 | 816.32 816.32 | |
| ----- | | | | | | | |
| 475-0203-000 1 | 6717 W GRANT ST | NOHELY JEFFREY R & LISA | 4 | 47.14 | 180 | | |
| | DESCRIPTION | FOOTAGE | RATE | GROSS | PERCENT | NET | |
| | ALLEY-CONCRETE RECONSTRUCT 16' WIDE - RES | 63.80 | 16.68 | 1,064.18 1,064.18 | 88.37 | 940.42 940.42 | RECTANGULARIZED |
| ----- | | | | | | | |
| 475-0202-000 1 | 6723 W GRANT ST | HORNICK MARY F LIFE EST | 4 | 45.37 | 190 | | |
| | DESCRIPTION | FOOTAGE | RATE | GROSS | PERCENT | NET | |
| | ALLEY-CONCRETE RECONSTRUCT 16' WIDE - RES | 57.90 | 16.68 | 965.77 965.77 | 97.24 | 939.08 939.08 | RECTANGULARIZED |
| ----- | | | | | | | |
| 475-0198-000 1 | 2216-18 S 67 PL | OLSEN III FREDERICK & J | 4 | 40.00 | 200 | | |
| | DESCRIPTION | FOOTAGE | RATE | GROSS | PERCENT | NET | |
| | ALLEY-CONCRETE RECONSTRUCT 16' WIDE - RES | 28.60 | 16.68 | 477.05 477.05 | 100.00 | 477.05 477.05 | |
| ----- | | | | | | | |

KEY ADDRESS OWNER CLASS FRONT FOOT
 475-0197-001 1 2222-24 S 67 PL KVALHEIM KIM D 4 0.00
 DESCRIPTION FOOTAGE RATE GROSS PERCENT NET
 ALLEY-CONCRETE RECONSTRUCT 16' WIDE - RES 106.87 16.68 1,782.59 71.05 1,266.51 RECTANGULARIZED
 1,782.59 1,266.51

 475-0191-001 1 66** W BELOIT RD RICE ENTERPRISES 3 0.00 220

DESCRIPTION FOOTAGE RATE GROSS PERCENT NET
 ALLEY-CONCRETE RECONSTRUCT 16' WIDE - COM 81.05 20.85 1,689.89 100.00 1,689.89

 475-0194-000 1 6620-22 W BELOIT RD RICE ENTERPRISES 4 40.00 230

DESCRIPTION FOOTAGE RATE GROSS PERCENT NET
 ALLEY-CONCRETE RECONSTRUCT 16' WIDE - RES 40.00 16.68 667.20 100.00 667.20
 667.20 667.20

 475-0195-002 1 6626 W BELOIT RD RICE ENTERPRISES 3 80.00 1050 S GRIDER ST 240

DESCRIPTION FOOTAGE RATE GROSS PERCENT NET
 ALLEY-CONCRETE RECONSTRUCT 16' WIDE - COM 80.00 20.85 1,668.00 100.00 1,668.00

 475-0195-001 1 6640 & 6700 W BELOIT RD WEST ALLIS RL ESTATE LLC 3 0.00 1050 S GRIDER ST 250

DESCRIPTION FOOTAGE RATE GROSS PERCENT NET
 ALLEY-CONCRETE RECONSTRUCT 16' WIDE - COM 152.42 20.85 3,177.96 100.00 3,177.96

 24 14,441.67 13,264.23 787.44 *****TOTALS FOR PROJECT *****

RUN # SPL015C ON 01/13/03

| CODE | NUMBER | GROSS |
|------|--------|----------|
| | 9 | 7,905.82 |
| | 3 | 6,535.85 |

| NET |
|----------|
| 6,728.38 |
| 6,535.85 |

13,264.23

SPECIALS BY CODE TOTALS 1031071

| FOOTAGE | CODE | DESCRIPTION |
|---------|----------------|----------------------------|
| 473.97 | ALLEY-CONCRETE | RECONSTRUCT 16' WIDE - RES |
| 313.47 | ALLEY-CONCRETE | RECONSTRUCT 16' WIDE - COM |

R-2003-0023