

**STANDING COMMITTEES OF THE
CITY OF WEST ALLIS COMMON COUNCIL
2004**

ADMINISTRATION & FINANCE

Chair: Michael J. Czaplewski
Vice-Chair: Martin J. Weigel
Gary T. Barczak
Thomas G. Lajsic
Rosalie L. Reinke

PUBLIC WORKS

Chair: Richard F. Narlock
Vice-Chair: Linda A. Dobrowski
Kurt E. Kopplin
Vincent Vitale
James W. Sengstock

SAFETY & DEVELOPMENT

Chair: Thomas G. Lajsic
Vice-Chair: Vincent Vitale
Gary T. Barczak
Martin J. Weigel
Rosalie L. Reinke

LICENSE & HEALTH

Chair: Kurt E. Kopplin
Vice-Chair: James W. Sengstock
Linda A. Dobrowski
Richard F. Narlock
Michael J. Czaplewski

ADVISORY

Chair: Rosalie L. Reinke
Vice-Chair: Gary T. Barczak
Linda A. Dobrowski
Vincent Vitale
Martin J. Weigel



City of West Allis

7525 W. Greenfield Ave.
West Allis, WI 53214

Resolution

File Number: R-2005-0090

Final Action:

Resolution to confirm and adopt the report of the City Engineer containing the schedule of proposed assessments for improvement of S. 56 St. from 475' north of W. Walker St. to W. National Ave. and portions of intersecting streets by concrete reconstruction of the pavement with miscellaneous walk repair, new driveway approaches, storm sewer, storm sewer relay, sanitary sewer relay, water main relay, building services and utility adjustments.

WHEREAS, The City Engineer, pursuant to Preliminary Resolution No. R-2005-0043, adopted on February 1, 2005, prepared and submitted his report as provided in sec. 66.0703(5) of the Wisconsin Statutes, for the improvement of the street as hereinafter described; and,

WHEREAS, The City Clerk/Treasurer gave due notice that such report was open for inspection at his office and also at the office of the City Engineer, and that all persons interested could appear before the Common Council and be heard concerning the matters contained in the Preliminary Resolution and Report; and,

WHEREAS, The Common Council met pursuant to such notice, at the time and place therein named; and having considered all statements and communications concerning the proposed improvements, relating to the matters contained in the City Engineer's report, including the schedule of proposed assessments, the Common Council makes no change in said report.

NOW, THEREFORE, BE IT RESOLVED By the Common Council of the City of West Allis:

1. The report of the City Engineer, including the schedule of the proposed assessments, for the improvement of S. 56 St. from 475' north of W. Walker St. to W. National Ave. and portions of intersecting streets by concrete reconstruction of the pavement with miscellaneous walk repair, new driveway approaches, storm sewer, storm sewer relay, sanitary sewer relay, water main relay, building services and utility adjustments be and the same is hereby approved and adopted.
2. The property against which the assessments are proposed is benefited; the assessments shown on the report are true and correct, have been determined on a reasonable basis and are hereby confirmed.
3. The City Engineer is hereby authorized and directed to prepare final plans for the aforesaid area in accordance with the terms of this resolution.

Eng05-33

ADOPTED

~~Paul M. Ziebler, City Admin. Officer, Clerk/Treas.~~

APPROVED

~~Jeannette Bell, Mayor~~



CITY OF WEST ALLIS

WISCONSIN



Engineering Department

MICHAEL G. LEWIS
City Engineer

March 15, 2005

Honorable Mayor and Common Council
West Allis, Wisconsin

Dear Mayor and Council Members:

I herewith respectfully submit my report on the assessment of benefits for concrete reconstruction of the pavement including miscellaneous walk repair, new driveway approaches, storm sewer, storm sewer relay, sanitary sewer relay, water main relay, building services and utility adjustments in:

S. 56 St. from 475' north of W. Walker St. to W. National Ave. and portions of intersecting streets

as directed in Preliminary Resolution No. R-2005-0043, adopted on February 1, 2005.

This report consists of the following schedules attached hereto:

- Schedule A. - Preliminary Plans and Specifications;
- Schedule B. - Estimate of Entire Cost of Proposed Improvements;
- Schedule C. - Schedule of Proposed Assessments Against Each Parcel Affected.

The property against which the assessments are proposed is benefited.

Respectfully submitted,

Michael G. Lewis, P.E.
City Engineer

MGL:jb

Encs.

H:\2005 Projects\1052852 CC.doc

PROPOSED IMPROVEMENT OF

**S. 56 St. from 475' north of W. Walker St. to W. National Ave.
and portions of intersecting streets**

by concrete reconstruction of the pavement including miscellaneous walk repair, new driveway approaches, storm sewer, storm sewer relay, sanitary sewer relay, water main relay, building services and utility adjustments.

SCHEDULE "A"

Preliminary Plans & Specifications Attached

SCHEDULE "B"

Estimate of the Entire Cost

\$ 396,000

SCHEDULE "C"

Schedule of Proposed Assessments
Against Each Parcel Affected

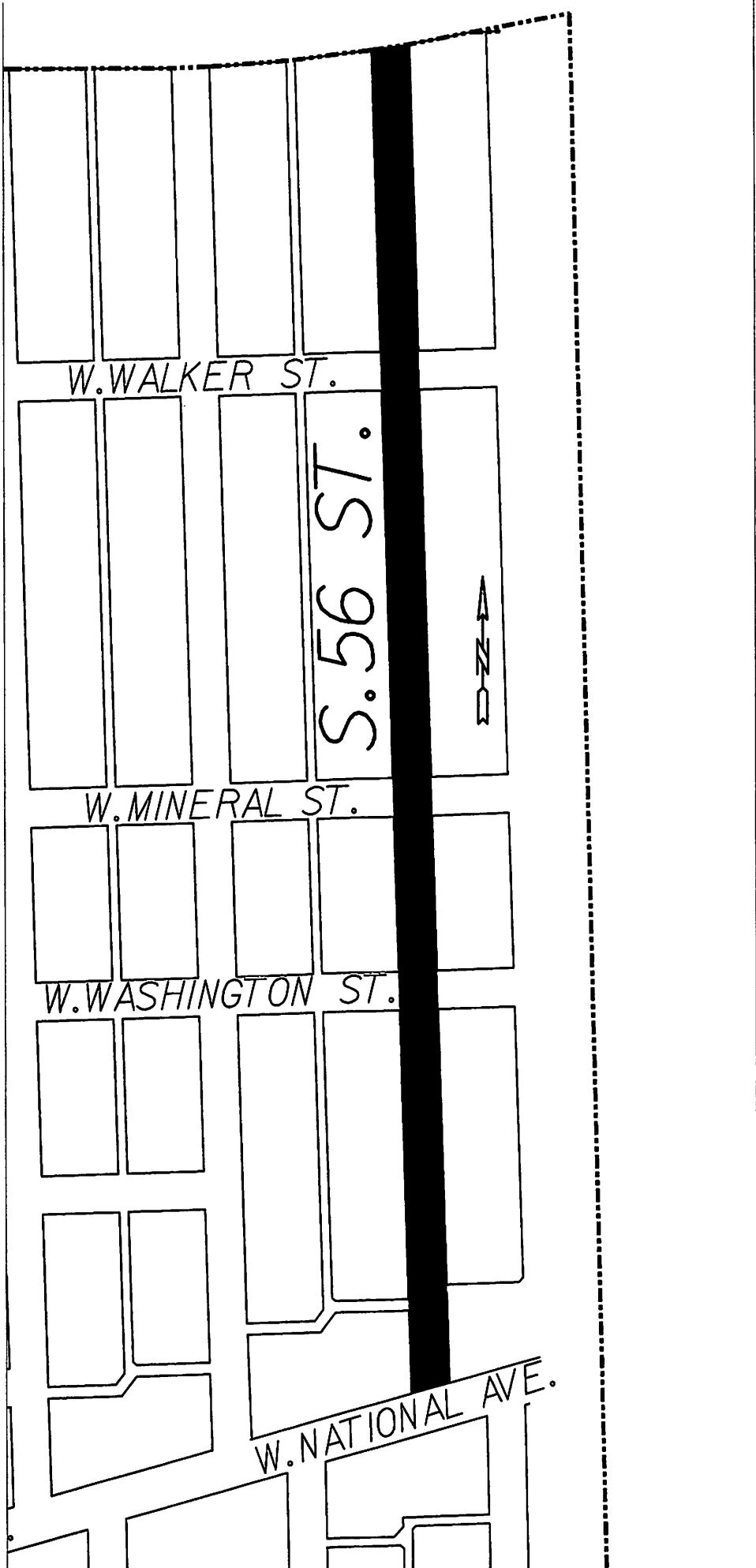

W. WALKER ST.

S. 56 ST.



W. MINERAL ST.

W. WASHINGTON ST.

W. NATIONAL AVE.



CITY OF WEST ALLIS

WISCONSIN



Engineering Department

MICHAEL G. LEWIS
City Engineer

March 15, 2005

Board of Public Works
West Allis City Hall
West Allis, Wisconsin

Dear Board Members:

I am herewith submitting preliminary plans and an estimate of costs for concrete reconstruction of the pavement including miscellaneous walk repair, new driveway approaches, storm sewer, storm sewer relay, sanitary sewer relay, water main relay, building services and utility adjustments in:

S. 56 St. from 475' north of W. Walker St. to W. National Ave. and portions of intersecting streets

Estimated Construction Cost:	\$360,000
Contingency:	<u>36,000</u>
TOTAL:	\$396,000

Sincerely,

Michael G. Lewis, P.E.
City Engineer

MGL:jb

H:\2005 Projects\1052852 BPW.doc

ASSESSMENT REPORT FOR COUNCIL

HEARING DATE: March 15, 2005

LOCATION

DESCRIPTION: S. 56 St. from 475' north of W. Walker St. to W. National Ave. and portions of intersecting streets

ACCOUNT NO.: 1052852

INTEREST RATE: 6.0%

<u>2005 ASSESSMENT RATES</u>	<u>Resid.</u>	<u>Comm.</u>	<u>Mfg.</u>
<u>Streets</u>			
Street reconstruct w/walk, lin. ft.	\$34.63	\$43.29	
<u>Driveways</u>			
7" concrete approach, per sq. ft.	\$4.31	\$4.31	
<u>U/G</u>			
Storm sewer lateral, each		\$892.00	

The properties against which the assessments are proposed are benefited.

KEY		PAGE	GROSS	NET	ADDRESS
438 0015 000 1	7	1,590.21	1,451.69	701 S	56 ST
438 0016 000 1	7	1,419.83	1,419.83	707 S	56 ST
438 0017 000 1	7	1,419.83	1,419.83	713 S	56 ST
438 0018 000 1	7	1,385.20	1,385.20	719 S	56 ST
438 0019 000 1	7	1,038.90	1,038.90	723 S	56 ST
438 0020 000 1	8	1,038.90	1,038.90	801 S	56 ST
438 0021 000 1	8	1,385.20	1,385.20	807 S	56 ST
438 0022 000 1	8	1,385.20	1,385.20	811 S	56 ST
438 0030 000 1	1	1,395.59	1,395.59	700 S	56 ST
438 0031 000 1	1	1,142.79	1,142.79	706 S	56 ST
438 0032 000 1	1	1,142.79	1,142.79	710 S	56 ST
438 0033 000 1	1	1,142.79	1,142.79	714 S	56 ST
438 0034 000 1	1	1,142.79	1,142.79	718 S	56 ST
438 0035 000 1	1	1,142.79	1,142.79	722 S	56 ST
438 0036 000 1	1	1,558.35	1,558.35	800 S	56 ST
438 0037 000 1	2	1,558.35	1,558.35	806 S	56 ST
438 0056 000 1	11	1,038.90	1,038.90	1029-29A S	56 ST
438 0057 000 1	11	1,558.35	1,558.35	1023 S	56 ST
438 0058 000 1	11	1,558.35	1,558.35	1017 S	56 ST
438 0059 000 1	11	1,558.35	1,558.35	1011-13 S	56 ST
438 0060 000 1	11	1,558.35	1,558.35	1005 S	56 ST
438 0061 000 1	11	1,038.90	1,038.90	1003 S	56 ST
438 0062 000 1	4	1,558.35	1,558.35	1000 S	56 ST
438 0063 000 1	5	1,558.35	1,558.35	1006 S	56 ST
438 0064 000 1	5	1,558.35	1,558.35	1012 S	56 ST
438 0065 000 1	5	1,558.35	1,558.35	1020 S	56 ST
438 0066 000 1	5	1,038.90	1,038.90	1024 S	56 ST
438 0067 000 1	5	1,038.90	1,038.90	1028 S	56 ST
438 0068 000 1	2	1,038.90	1,038.90	900 S	56 ST
438 0069 000 1	2	1,558.35	1,558.35	904 S	56 ST
438 0070 000 1	3	1,558.35	1,558.35	910 S	56 ST
438 0071 000 1	3	1,385.20	1,385.20	916 S	56 ST
438 0072 000 1	3	1,385.20	1,385.20	922 S	56 ST
438 0073 000 1	3	1,385.20	1,385.20	928 S	56 ST

KEY			PAGE	GROSS	NET	ADDRESS
438 0074 000 1	3	2,077.80	2,077.80	932-34 S	56 ST	
438 0075 000 1	3	1,558.35	1,558.35	942 S	56 ST	
438 0076 000 1	3	1,790.75	1,558.35	946 S	56 ST	
438 0077 000 1	4	1,558.35	1,558.35	952-54 S	56 ST	
438 0078 000 1	4	1,038.90	1,038.90	960 S	56 ST	
438 0079 000 1	4	1,212.05	1,212.05	962 S	56 ST	
438 0080 000 1	4	1,385.20	1,385.20	968 S	56 ST	
438 0081 000 1	4	1,038.90	1,038.90	972 S	56 ST	
438 0082 000 1	4	1,038.90	1,038.90	976 S	56 ST	
438 0097 000 1	10	1,038.90	1,038.90	977 S	56 ST	
438 0098 000 1	10	1,558.35	1,558.35	971 S	56 ST	
438 0099 000 1	10	1,558.35	1,558.35	967 S	56 ST	
438 0100 000 1	10	1,558.35	1,558.35	959-61 S	56 ST	
438 0101 000 1	10	1,558.35	1,558.35	953 S	56 ST	
438 0102 000 1	10	1,558.35	1,558.35	949 S	56 ST	
438 0103 000 1	10	1,558.35	1,558.35	943 S	56 ST	
438 0104 000 1	9	1,558.35	1,558.35	935 S	56 ST	
438 0105 000 1	9	1,558.35	1,558.35	929 S	56 ST	
438 0106 000 1	9	1,558.35	1,558.35	923 S	56 ST	
438 0107 000 1	9	1,558.35	1,558.35	919 S	56 ST	
438 0108 000 1	9	1,558.35	1,558.35	911 S	56 ST	
438 0109 000 1	9	1,212.05	1,212.05	907 S	56 ST	
438 0110 000 1	9	1,385.20	1,385.20	903 S	56 ST	
438 0182 000 1	8	1,385.20	1,385.20	833 S	56 ST	
438 0183 000 1	8	1,385.20	1,385.20	827 S	56 ST	
438 0184 000 1	8	1,385.20	1,385.20	821 S	56 ST	
438 0185 001 1	8	1,385.20	1,385.20	817 S	56 ST	
438 0186 000 1	2	2,077.80	2,077.80	816 S	56 ST	
438 0187 000 1	2	1,558.35	1,558.35	822 S	56 ST	
438 0188 000 1	2	1,558.35	1,558.35	826 S	56 ST	
438 0189 000 1	2	1,038.90	1,038.90	832 S	56 ST	
438 0198 000 1	7	4,717.74	4,380.52	5538 W NATIONAL AVE		
438 0370 000 1	13	4,475.11	2,325.33	5600 W NATL & 1227-33 S		
438 0371 000 1	13	1,558.35	1,558.35	1215 S	56 ST	

KEY			PAGE	GROSS	NET	ADDRESS
438	0372	000	1	1,038.90	1,038.90	1211 S 56 ST
438	0373	000	1	1,558.35	1,558.35	1205-07 S 56 ST
438	0374	000	1	1,558.35	1,558.35	1139 S 56 ST
438	0375	000	1	1,558.35	1,558.35	1133 S 56 ST
438	0376	000	1	1,038.90	1,038.90	1129 S 56 ST
438	0377	000	1	1,038.90	1,038.90	1125 S 56 ST
438	0378	000	1	1,038.90	1,038.90	1121-23 S 56 ST
438	0379	000	1	1,385.20	1,385.20	1115 S 56 ST
438	0380	000	1	1,385.20	1,385.20	1111-13 S 56 ST
438	0381	000	1	1,385.20	1,385.20	1105 S 56 ST
438	0382	000	1	1,038.90	1,038.90	1101 S 56 ST
438	0383	000	1	1,038.90	1,038.90	1102 S 56 ST
438	0384	000	1	1,558.35	1,558.35	1106 S 56 ST
438	0385	000	1	1,385.20	1,385.20	1110 S 56 ST
438	0386	000	1	1,212.05	1,212.05	1116-18 S 56 ST
438	0387	000	1	1,558.35	1,558.35	1120-22 S 56 ST
438	0388	000	1	1,558.35	1,558.35	1126-28 S 56 ST
438	0389	000	1	1,558.35	1,558.35	1132-34 S 56 ST
438	0390	000	1	1,558.35	1,558.35	1138 S 56 ST
438	0391	000	1	2,077.80	2,077.80	1204 S 56 ST
438	0392	000	1	1,350.22	1,350.22	1212-14 S 56 ST

KEY 438-0030-000 1 ADDRESS 700 S 56 ST OWNER BROWN AUDREY CLASS 4 FRONT FOOT 45.10
 DESCRIPTION RECONSTRUCTION (CONC/ASPH)/MISC WALK - RES 40.30 34.63 FOOTAGE RATE GROSS PERCENT NET
 1,395.59 100.00 1,395.59

438-0031-000 1 706 S 56 ST SOLIS PABLO 4 33.00
 DESCRIPTION RECONSTRUCTION (CONC/ASPH)/MISC WALK - RES 33.00 34.63 FOOTAGE RATE GROSS PERCENT NET
 1,142.79 100.00 1,142.79

438-0032-000 1 710 S 56 ST VERHALEN ROBERT J 4 33.00
 DESCRIPTION RECONSTRUCTION (CONC/ASPH)/MISC WALK - RES 33.00 34.63 FOOTAGE RATE GROSS PERCENT NET
 1,142.79 100.00 1,142.79

438-0033-000 1 714 S 56 ST MICHALOWSKI BETTY J 4 33.00
 DESCRIPTION RECONSTRUCTION (CONC/ASPH)/MISC WALK - RES 33.00 34.63 FOOTAGE RATE GROSS PERCENT NET
 1,142.79 100.00 1,142.79

438-0034-000 1 718 S 56 ST VOGEL BETTY L 4 33.00
 DESCRIPTION RECONSTRUCTION (CONC/ASPH)/MISC WALK - RES 33.00 34.63 FOOTAGE RATE GROSS PERCENT NET
 1,142.79 100.00 1,142.79

438-0035-000 1 722 S 56 ST GENNRICH CATHERINE A 4 33.00
 DESCRIPTION RECONSTRUCTION (CONC/ASPH)/MISC WALK - RES 33.00 34.63 FOOTAGE RATE GROSS PERCENT NET
 1,142.79 100.00 1,142.79

438-0036-000 1 800 S 56 ST MURRAY DOUGLAS & MARISA 4 45.00
 DESCRIPTION RECONSTRUCTION (CONC/ASPH)/MISC WALK - RES 45.00 34.63 FOOTAGE RATE GROSS PERCENT NET
 1,558.35 100.00 1,558.35

RUN # SPL015 ON 03/10/05 SPECIALS BY PROJECT DETAIL: 1052852 COUNCIL

80

FRONT FOOT
45.00

CLASS
4

OWNER ROBERT L
BURGESS

ADDRESS 56 ST
438-0037-000 1

DESCRIPTION (CONC/ASPH)/MISC WALK - RES 45.00 34.63
FOOTAGE RATE
GROSS PERCENT NET
1,558.35 100.00 1,558.35
1,558.35

90

60.00

4

CLEMENTI JOSEPH R

438-0186-000 1 816 S 56 ST

DESCRIPTION
7" CONCRETE DRIVEWAY APPROACH PER 90 FT
RECONSTRUCTION (CONC/ASPH)/MISC WALK - RES 0.00 4.31
FOOTAGE RATE
GROSS PERCENT NET
2,077.80 100.00 2,077.80
2,077.80 0-15 YEARS (FREE)

100

45.00

4

BARRIBEAU TIMOTHY G

438-0187-000 1 822 S 56 ST

DESCRIPTION
RECONSTRUCTION (CONC/ASPH)/MISC WALK - RES 45.00 34.63
FOOTAGE RATE
GROSS PERCENT NET
1,558.35 100.00 1,558.35
1,558.35

110

45.00

4

PICCHIOTTINO MICHAEL & J 4

438-0188-000 1 826 S 56 ST

DESCRIPTION
RECONSTRUCTION (CONC/ASPH)/MISC WALK - RES 45.00 34.63
FOOTAGE RATE
GROSS PERCENT NET
1,558.35 100.00 1,558.35
1,558.35

120

30.00

4

SMITH JAMES E & MARY A

438-0189-000 1 832 S 56 ST

DESCRIPTION
RECONSTRUCTION (CONC/ASPH)/MISC WALK - RES 30.00 34.63
FOOTAGE RATE
GROSS PERCENT NET
1,038.90 100.00 1,038.90
1,038.90

130

30.00

4

GIBBS KENNETH L

438-0068-000 1 900 S 56 ST

DESCRIPTION
RECONSTRUCTION (CONC/ASPH)/MISC WALK - RES 30.00 34.63
FOOTAGE RATE
GROSS PERCENT NET
1,038.90 100.00 1,038.90
1,038.90

140

45.00

4

GONNERING D T LIFE EST 4

438-0069-000 1 904 S 56 ST

DESCRIPTION
RECONSTRUCTION (CONC/ASPH)/MISC WALK - RES 45.00 34.63
FOOTAGE RATE
GROSS PERCENT NET
1,558.35 100.00 1,558.35
1,558.35

KEY	ADDRESS	OWNER	CLASS	FRONT FOOT
438-0070-000 1	910 S 56 ST	FLANCHER KATHRYN J	4	45.00
DESCRIPTION				
7" CONCRETE DRIVEWAY APPROACH PER SO FT				
RECONSTRUCTION (CONC/ASPH)/MISC WALK - RES				
		FOOTAGE	RATE	GROSS
				PERCENT
				NET
		0.00	4.31	0.00
		45.00	34.63	1,558.35
				100.00
				1,558.35

150

KEY	ADDRESS	OWNER	CLASS	FRONT FOOT
438-0071-000 1	916 S 56 ST	MUEHL RICHARD R	4	40.00
DESCRIPTION				
7" CONCRETE DRIVEWAY APPROACH PER SO FT				
RECONSTRUCTION (CONC/ASPH)/MISC WALK - RES				
		FOOTAGE	RATE	GROSS
				PERCENT
				NET
		0.00	4.31	0.00
		40.00	34.63	1,385.20
				100.00
				1,385.20

160

KEY	ADDRESS	OWNER	CLASS	FRONT FOOT
438-0072-000 1	922 S 56 ST	BIEDENBENDER SHAWN & N	4	40.00
DESCRIPTION				
7" CONCRETE DRIVEWAY APPROACH PER SO FT				
RECONSTRUCTION (CONC/ASPH)/MISC WALK - RES				
		FOOTAGE	RATE	GROSS
				PERCENT
				NET
		0.00	4.31	0.00
		40.00	34.63	1,385.20
				100.00
				1,385.20

170

KEY	ADDRESS	OWNER	CLASS	FRONT FOOT
438-0073-000 1	928 S 56 ST	CRUZ LEANNE B	4	40.00
DESCRIPTION				
7" CONCRETE DRIVEWAY APPROACH PER SO FT				
RECONSTRUCTION (CONC/ASPH)/MISC WALK - RES				
		FOOTAGE	RATE	GROSS
				PERCENT
				NET
		0.00	4.31	0.00
		40.00	34.63	1,385.20
				100.00
				1,385.20

180

KEY	ADDRESS	OWNER	CLASS	FRONT FOOT
438-0074-000 1	932-34 S 56 ST	TORPY CONSTANCE M	4	60.00
DESCRIPTION				
7" CONCRETE DRIVEWAY APPROACH PER SO FT				
RECONSTRUCTION (CONC/ASPH)/MISC WALK - RES				
		FOOTAGE	RATE	GROSS
				PERCENT
				NET
		0.00	4.31	0.00
		60.00	34.63	2,077.80
				100.00
				2,077.80

190

KEY	ADDRESS	OWNER	CLASS	FRONT FOOT
438-0075-000 1	942 S 56 ST	ZIELINSKI STEVE S	4	45.00
DESCRIPTION				
7" CONCRETE DRIVEWAY APPROACH PER SO FT				
RECONSTRUCTION (CONC/ASPH)/MISC WALK - RES				
		FOOTAGE	RATE	GROSS
				PERCENT
				NET
		0.00	4.31	0.00
		45.00	34.63	1,558.35
				100.00
				1,558.35

200

KEY	ADDRESS	OWNER	CLASS	FRONT FOOT
438-0076-000 1	946 S 56 ST	HENGEL NORBERT W	4	45.00
DESCRIPTION				
7" CONCRETE DRIVEWAY APPROACH PER SO FT				
RECONSTRUCTION (CONC/ASPH)/MISC WALK - RES				
		FOOTAGE	RATE	GROSS
				PERCENT
				NET
		53.92	4.31	232.40
		45.00	34.63	1,558.35
				0.00
				1,790.75
				100.00
				1,558.35

210

0-15 YEARS (FREE)

KEY ADDRESS 438-0077-000 1 952-54 S 56 ST OWNER HEATHER HOWARD CLASS 4 FRONT FOOT 954 S 56 ST 45.00 220

DESCRIPTION RECONSTRUCTION (CONC/ASPH)/MISC WALK - RES 45.00 34.63 FOOTAGE RATE 1,558.35 100.00 PERCENT NET 1,558.35

438-0078-000 1 960 S 56 ST HARDIN DIANNA P 4 30.00 230

DESCRIPTION RECONSTRUCTION (CONC/ASPH)/MISC WALK - RES 30.00 34.63 FOOTAGE RATE 1,038.90 100.00 PERCENT NET 1,038.90

438-0079-000 1 962 S 56 ST MCGRADY KATHLEEN M 4 35.00 240

DESCRIPTION RECONSTRUCTION (CONC/ASPH)/MISC WALK - RES 35.00 34.63 FOOTAGE RATE 1,212.05 100.00 PERCENT NET 1,212.05

438-0080-000 1 968 S 56 ST FOOTE JERALD E 4 40.00 762 COLUMBIA AVE 250

DESCRIPTION RECONSTRUCTION (CONC/ASPH)/MISC WALK - RES 40.00 34.63 FOOTAGE RATE 1,385.20 100.00 PERCENT NET 1,385.20

438-0081-000 1 972 S 56 ST O DEAN LEILA 4 30.00 260

DESCRIPTION RECONSTRUCTION (CONC/ASPH)/MISC WALK - RES 30.00 34.63 FOOTAGE RATE 1,038.90 100.00 PERCENT NET 1,038.90

438-0082-000 1 976 S 56 ST NEHRBASS DAWN C 4 30.00 2909 N LOCUST RD 270

DESCRIPTION RECONSTRUCTION (CONC/ASPH)/MISC WALK - RES 30.00 34.63 FOOTAGE RATE 1,038.90 100.00 PERCENT NET 1,038.90

438-0062-000 1 1000 S 56 ST PITT KENNETH 4 45.00 280

DESCRIPTION RECONSTRUCTION (CONC/ASPH)/MISC WALK - RES 45.00 34.63 FOOTAGE RATE 1,558.35 100.00 PERCENT NET 1,558.35

DESCRIPTION	FOOTAGE	RATE	GROSS	PERCENT	NET
RECONSTRUCTION (CONC/ASPH)/MISC WALK - RES	45.00	34.63	1,558.35	100.00	1,558.35

DESCRIPTION	FOOTAGE	RATE	GROSS	PERCENT	NET
7" CONCRETE DRIVEWAY APPROACH PER 90 FT	0.00	4.31	0.00	100.00	0.00
RECONSTRUCTION (CONC/ASPH)/MISC WALK - RES	45.00	34.63	1,558.35	100.00	1,558.35

DESCRIPTION	FOOTAGE	RATE	GROSS	PERCENT	NET
RECONSTRUCTION (CONC/ASPH)/MISC WALK - RES	45.00	34.63	1,558.35	100.00	1,558.35

DESCRIPTION	FOOTAGE	RATE	GROSS	PERCENT	NET
RECONSTRUCTION (CONC/ASPH)/MISC WALK - RES	30.00	34.63	1,038.90	100.00	1,038.90

DESCRIPTION	FOOTAGE	RATE	GROSS	PERCENT	NET
RECONSTRUCTION (CONC/ASPH)/MISC WALK - RES	30.00	34.63	1,038.90	100.00	1,038.90

DESCRIPTION	FOOTAGE	RATE	GROSS	PERCENT	NET
RECONSTRUCTION (CONC/ASPH)/MISC WALK - RES	30.00	34.63	1,038.90	100.00	1,038.90

DESCRIPTION	FOOTAGE	RATE	GROSS	PERCENT	NET
RECONSTRUCTION (CONC/ASPH)/MISC WALK - RES	45.00	34.63	1,558.35	100.00	1,558.35

KEY ADDRESS 1110 S 56 ST OWNER PULIZ CAROL S CLASS 4 FRONT FOOT 40.00
 438-0385-000 1 1110 S 56 ST
 DESCRIPTION FOOTAGE RATE GROSS PERCENT NET
 7" CONCRETE DRIVEWAY APPROACH PER SQ FT 0.00 4.31 0.00 100.00 0.00
 RECONSTRUCTION (CONC/ASPH)/MISC WALK - RES 40.00 34.63 1,385.20 100.00 1,385.20

438-0386-000 1 1116-18 S 56 ST PERLICK TERRANCE A 4 35.00 1118 S 56 ST
 DESCRIPTION FOOTAGE RATE GROSS PERCENT NET
 RECONSTRUCTION (CONC/ASPH)/MISC WALK - RES 35.00 34.63 1,212.05 100.00 1,212.05

438-0387-000 1 1120-22 S 56 ST MOELLER KURT T 4 45.00 1122 S 56 ST
 DESCRIPTION FOOTAGE RATE GROSS PERCENT NET
 RECONSTRUCTION (CONC/ASPH)/MISC WALK - RES 45.00 34.63 1,558.35 100.00 1,558.35

438-0388-000 1 1126-28 S 56 ST KLARNER KERRIE L 4 45.00 1128 S 56 ST
 DESCRIPTION FOOTAGE RATE GROSS PERCENT NET
 7" CONCRETE DRIVEWAY APPROACH PER SQ FT 0.00 4.31 0.00 100.00 0.00
 RECONSTRUCTION (CONC/ASPH)/MISC WALK - RES 45.00 34.63 1,558.35 100.00 1,558.35

438-0389-000 1 1132-34 S 56 ST NEMEC A S 4 45.00 1132 S 56 ST
 DESCRIPTION FOOTAGE RATE GROSS PERCENT NET
 7" CONCRETE DRIVEWAY APPROACH PER SQ FT 0.00 4.31 0.00 100.00 0.00
 RECONSTRUCTION (CONC/ASPH)/MISC WALK - RES 45.00 34.63 1,558.35 100.00 1,558.35

438-0390-000 1 1138 S 56 ST NOVAK MICHELLE M 4 45.00
 DESCRIPTION FOOTAGE RATE GROSS PERCENT NET
 7" CONCRETE DRIVEWAY APPROACH PER SQ FT 0.00 4.31 0.00 100.00 0.00
 RECONSTRUCTION (CONC/ASPH)/MISC WALK - RES 45.00 34.63 1,558.35 100.00 1,558.35

438-0391-000 1 1204 S 56 ST O'NEAL BRET & HEATHER 4 60.00
 DESCRIPTION FOOTAGE RATE GROSS PERCENT NET
 7" CONCRETE DRIVEWAY APPROACH PER SQ FT 0.00 4.31 0.00 100.00 0.00
 RECONSTRUCTION (CONC/ASPH)/MISC WALK - RES 60.00 34.63 2,077.80 100.00 2,077.80

KEY	ADDRESS	OWNER	CLASS	FRONT FOOT			
438-0392-000 1	1212-14 S 56 ST	NICKEL WILLIAM & JUDITH	4	39.00	3101 S RENO DRIVE		430

DESCRIPTION	FOOTAGE	RATE	GROSS	PERCENT	NET		
RECONSTRUCTION (CONC/ASPH)/MISC WALK - RES	38.99	34.63	1,350.22	100.00	1,350.22		

438-0198-000 1	5538 W NATIONAL AVE	HINKFUSS RODNEY A	3	0.00	5227 W NATIONAL AVE		440

DESCRIPTION	FOOTAGE	RATE	GROSS	PERCENT	NET		
7" CONCRETE DRIVEWAY APPROACH PER SO FT	0.00	4.31	0.00	100.00	0.00		
7" CONCRETE DRIVEWAY APPROACH PER SO FT	0.00	4.31	0.00	100.00	0.00		
RECONSTRUCTION (CONC/ASPH)/MISC WALK - COM	108.98	43.29	4,717.74	92.85	4,380.52	RECTANGULARIZED	CONSTRUCTION EXT

438-0015-000 1	701 S 56 ST	KETCHMAN RUTH A	4	41.00			450

DESCRIPTION	FOOTAGE	RATE	GROSS	PERCENT	NET		
7" CONCRETE DRIVEWAY APPROACH PER SO FT	0.00	4.31	0.00	100.00	0.00		
RECONSTRUCTION (CONC/ASPH)/MISC WALK - RES	45.92	34.63	1,590.21	91.29	1,451.69	RECTANGULARIZED	

438-0016-000 1	707 S 56 ST	BAUER HELEN M	4	41.00			460

DESCRIPTION	FOOTAGE	RATE	GROSS	PERCENT	NET		
7" CONCRETE DRIVEWAY APPROACH PER SO FT	0.00	4.31	0.00	100.00	0.00		
RECONSTRUCTION (CONC/ASPH)/MISC WALK - RES	41.00	34.63	1,419.83	100.00	1,419.83		

438-0017-000 1	713 S 56 ST	NIEMANN JOHN T	4	41.00	N85 W15650 RIDGE RD #105		470

DESCRIPTION	FOOTAGE	RATE	GROSS	PERCENT	NET		
7" CONCRETE DRIVEWAY APPROACH PER SO FT	0.00	4.31	0.00	100.00	0.00		
RECONSTRUCTION (CONC/ASPH)/MISC WALK - RES	41.00	34.63	1,419.83	100.00	1,419.83		

438-0018-000 1	719 S 56 ST	SMITH APRYL	4	40.00			480

DESCRIPTION	FOOTAGE	RATE	GROSS	PERCENT	NET		
RECONSTRUCTION (CONC/ASPH)/MISC WALK - RES	40.00	34.63	1,385.20	100.00	1,385.20		

438-0019-000 1	723 S 56 ST	KRUK THOMAS G	4	30.00			490

DESCRIPTION	FOOTAGE	RATE	GROSS	PERCENT	NET		
RECONSTRUCTION (CONC/ASPH)/MISC WALK - RES	30.00	34.63	1,038.90	100.00	1,038.90		

KEY 438-0020-000 1 ADDRESS 801 S 56 ST OWNER PARNAU TIMOTHY & HEATHER 4 CLASS FRONT FOOT 30.00

DESCRIPTION RECONSTRUCTION (CONC/ASPH)/MISC WALK - RES 30.00 34.63 1,038.90 100.00 1,038.90

438-0021-000 1 807 S 56 ST KENDALL THOMAS D 4 40.00 510

DESCRIPTION RECONSTRUCTION (CONC/ASPH)/MISC WALK - RES 40.00 34.63 1,385.20 100.00 1,385.20

438-0022-000 1 811 S 56 ST BROWN BRADLEY W & VICKI 4 40.00 520

DESCRIPTION RECONSTRUCTION (CONC/ASPH)/MISC WALK - RES 40.00 34.63 1,385.20 100.00 1,385.20

438-0185-001 1 817 S 56 ST LOPINA J & NARLOW L 4 40.00 530

DESCRIPTION RECONSTRUCTION (CONC/ASPH)/MISC WALK - RES 40.00 34.63 1,385.20 100.00 1,385.20

438-0184-000 1 821 S 56 ST FISCHER MARTIN & DOROTHY 4 40.00 540

DESCRIPTION RECONSTRUCTION (CONC/ASPH)/MISC WALK - RES 40.00 34.63 1,385.20 100.00 1,385.20

438-0183-000 1 827 S 56 ST GATTO JR PETER A & TERESA 4 40.00 550

DESCRIPTION RECONSTRUCTION (CONC/ASPH)/MISC WALK - RES 40.00 34.63 1,385.20 100.00 1,385.20

438-0182-000 1 833 S 56 ST WOJSZKO AMY L 4 40.00 560

DESCRIPTION RECONSTRUCTION (CONC/ASPH)/MISC WALK - RES 40.00 34.63 1,385.20 100.00 1,385.20

DESCRIPTION	FOOTAGE	RATE	GROSS	PERCENT	NET
RECONSTRUCTION (CONC/ASPH)/MISC WALK - RES	40.00	34.63	1,385.20	100.00	1,385.20
			1,385.20		1,385.20

DESCRIPTION	FOOTAGE	RATE	GROSS	PERCENT	NET
RECONSTRUCTION (CONC/ASPH)/MISC WALK - RES	35.00	34.63	1,212.05	100.00	1,212.05
			1,212.05		1,212.05

DESCRIPTION	FOOTAGE	RATE	GROSS	PERCENT	NET
RECONSTRUCTION (CONC/ASPH)/MISC WALK - RES	45.00	34.63	1,558.35	100.00	1,558.35
			1,558.35		1,558.35

DESCRIPTION	FOOTAGE	RATE	GROSS	PERCENT	NET
RECONSTRUCTION (CONC/ASPH)/MISC WALK - RES	45.00	34.63	1,558.35	100.00	1,558.35
			1,558.35		1,558.35

DESCRIPTION	FOOTAGE	RATE	GROSS	PERCENT	NET
RECONSTRUCTION (CONC/ASPH)/MISC WALK - RES	45.00	34.63	1,558.35	100.00	1,558.35
			1,558.35		1,558.35

DESCRIPTION	FOOTAGE	RATE	GROSS	PERCENT	NET
RECONSTRUCTION (CONC/ASPH)/MISC WALK - RES	45.00	34.63	1,558.35	100.00	1,558.35
			1,558.35		1,558.35

DESCRIPTION	FOOTAGE	RATE	GROSS	PERCENT	NET
RECONSTRUCTION (CONC/ASPH)/MISC WALK - RES	45.00	34.63	1,558.35	100.00	1,558.35
			1,558.35		1,558.35

KEY
 438-0103-000 1 ADDRESS 56 ST
 OWNER DALE & BRENDA CLASS FRONT FOOT
 ZEUGNER 4
 DESCRIPTION FOOTAGE RATE GROSS PERCENT NET
 RECONSTRUCTION (CONC/ASPH)/MISC WALK - RES 45.00 34.63 1,558.35 100.00 1,558.35
 RECONSTRUCTION (CONC/ASPH)/MISC WALK - RES 45.00 34.63 1,558.35 100.00 1,558.35

438-0102-000 1 949 S 56 ST LICHT CHARLES J & HOLLY 4
 DESCRIPTION FOOTAGE RATE GROSS PERCENT NET
 RECONSTRUCTION (CONC/ASPH)/MISC WALK - RES 45.00 34.63 1,558.35 100.00 1,558.35
 RECONSTRUCTION (CONC/ASPH)/MISC WALK - RES 45.00 34.63 1,558.35 100.00 1,558.35

438-0101-000 1 953 S 56 ST LANGFORD RANDOLPH & KAREN 4
 DESCRIPTION FOOTAGE RATE GROSS PERCENT NET
 RECONSTRUCTION (CONC/ASPH)/MISC WALK - RES 45.00 34.63 1,558.35 100.00 1,558.35
 RECONSTRUCTION (CONC/ASPH)/MISC WALK - RES 45.00 34.63 1,558.35 100.00 1,558.35

438-0100-000 1 959-61 S 56 ST ZIELINSKI JACQUELINE 4
 DESCRIPTION FOOTAGE RATE GROSS PERCENT NET
 RECONSTRUCTION (CONC/ASPH)/MISC WALK - RES 45.00 34.63 1,558.35 100.00 1,558.35
 RECONSTRUCTION (CONC/ASPH)/MISC WALK - RES 45.00 34.63 1,558.35 100.00 1,558.35

438-0099-000 1 967 S 56 ST TEVZ RICHARD J 4
 DESCRIPTION FOOTAGE RATE GROSS PERCENT NET
 RECONSTRUCTION (CONC/ASPH)/MISC WALK - RES 45.00 34.63 1,558.35 100.00 1,558.35
 RECONSTRUCTION (CONC/ASPH)/MISC WALK - RES 45.00 34.63 1,558.35 100.00 1,558.35

438-0098-000 1 971 S 56 ST KUTNER TONI M 4
 DESCRIPTION FOOTAGE RATE GROSS PERCENT NET
 RECONSTRUCTION (CONC/ASPH)/MISC WALK - RES 45.00 34.63 1,558.35 100.00 1,558.35
 RECONSTRUCTION (CONC/ASPH)/MISC WALK - RES 45.00 34.63 1,558.35 100.00 1,558.35

438-0097-000 1 977 S 56 ST BUTTWEILER ROBERT W 4
 DESCRIPTION FOOTAGE RATE GROSS PERCENT NET
 RECONSTRUCTION (CONC/ASPH)/MISC WALK - RES 30.00 34.63 1,038.90 100.00 1,038.90
 RECONSTRUCTION (CONC/ASPH)/MISC WALK - RES 30.00 34.63 1,038.90 100.00 1,038.90

DESCRIPTION	FOOTAGE	RATE	GROSS	PERCENT	NET
RECONSTRUCTION (CONC/ASPH)/MISC WALK - RES	30.00	34.63	1,038.90	100.00	1,038.90
			1,038.90		1,038.90

DESCRIPTION	FOOTAGE	RATE	GROSS	PERCENT	NET
RECONSTRUCTION (CONC/ASPH)/MISC WALK - RES	45.00	34.63	1,558.35	100.00	1,558.35
			1,558.35		1,558.35

DESCRIPTION	FOOTAGE	RATE	GROSS	PERCENT	NET
RECONSTRUCTION (CONC/ASPH)/MISC WALK - RES	45.00	34.63	1,558.35	100.00	1,558.35
			1,558.35		1,558.35

DESCRIPTION	FOOTAGE	RATE	GROSS	PERCENT	NET
RECONSTRUCTION (CONC/ASPH)/MISC WALK - RES	45.00	34.63	1,558.35	100.00	1,558.35
			1,558.35		1,558.35

DESCRIPTION	FOOTAGE	RATE	GROSS	PERCENT	NET
RECONSTRUCTION (CONC/ASPH)/MISC WALK - RES	45.00	34.63	1,558.35	100.00	1,558.35
			1,558.35		1,558.35

DESCRIPTION	FOOTAGE	RATE	GROSS	PERCENT	NET
RECONSTRUCTION (CONC/ASPH)/MISC WALK - RES	30.00	34.63	1,038.90	100.00	1,038.90
			1,038.90		1,038.90

DESCRIPTION	FOOTAGE	RATE	GROSS	PERCENT	NET
RECONSTRUCTION (CONC/ASPH)/MISC WALK - RES	30.00	34.63	1,038.90	100.00	1,038.90
			1,038.90		1,038.90

DESCRIPTION	FOOTAGE	RATE	GROSS	PERCENT	NET
RECONSTRUCTION (CONC/ASPH)/MISC WALK - RES	40.00	34.63	1,385.20	100.00	1,385.20

438-0380-000 1 1111-13 S 56 ST JAGODZINSKI DAVID & LISA 4 40.00 1111 S 56 ST

DESCRIPTION	FOOTAGE	RATE	GROSS	PERCENT	NET
RECONSTRUCTION (CONC/ASPH)/MISC WALK - RES	40.00	34.63	1,385.20	100.00	1,385.20

438-0379-000 1 1115 S 56 ST MASCH WILLIAM M & KAREN 4 40.00

DESCRIPTION	FOOTAGE	RATE	GROSS	PERCENT	NET
RECONSTRUCTION (CONC/ASPH)/MISC WALK - RES	40.00	34.63	1,385.20	100.00	1,385.20

438-0378-000 1 1121-23 S 56 ST SHEBESTA PHYLLIS E 4 30.00

DESCRIPTION	FOOTAGE	RATE	GROSS	PERCENT	NET
RECONSTRUCTION (CONC/ASPH)/MISC WALK - RES	30.00	34.63	1,038.90	100.00	1,038.90

438-0377-000 1 1125 S 56 ST DOUGHERTY LARRY E 4 30.00

DESCRIPTION	FOOTAGE	RATE	GROSS	PERCENT	NET
RECONSTRUCTION (CONC/ASPH)/MISC WALK - RES	30.00	34.63	1,038.90	100.00	1,038.90

438-0376-000 1 1129 S 56 ST NAZERIS CHRISTINE 4 30.00

DESCRIPTION	FOOTAGE	RATE	GROSS	PERCENT	NET
RECONSTRUCTION (CONC/ASPH)/MISC WALK - RES	30.00	34.63	1,038.90	100.00	1,038.90

438-0375-000 1 1133 S 56 ST CORAGGIO ROCKY J & VICKI 4 45.00

DESCRIPTION	FOOTAGE	RATE	GROSS	PERCENT	NET
RECONSTRUCTION (CONC/ASPH)/MISC WALK - RES	45.00	34.63	1,558.35	100.00	1,558.35

KEY	ADDRESS	OWNER	CLASS	FRONT FOOT	
438-0374-000 1	1139 S 56 ST	HALUSKA WALTER	4	45.00	850
DESCRIPTION	FOOTAGE	RATE	GROSS	PERCENT	NET
7" CONCRETE DRIVEWAY APPROACH PER SO FT	0.00	4.31	0.00	100.00	0.00
RECONSTRUCTION (CONC/ASPH)/MISC WALK - RES	45.00	34.63	1,558.35	100.00	1,558.35

KEY	ADDRESS	OWNER	CLASS	FRONT FOOT	
438-0373-000 1	1205-07 S 56 ST	PRUSAK STEPHEN J TRUSTEE	4	45.00	1207 SOUTH 56TH ST 860
DESCRIPTION	FOOTAGE	RATE	GROSS	PERCENT	NET
7" CONCRETE DRIVEWAY APPROACH PER SO FT	0.00	4.31	0.00	100.00	0.00
RECONSTRUCTION (CONC/ASPH)/MISC WALK - RES	45.00	34.63	1,558.35	100.00	1,558.35

KEY	ADDRESS	OWNER	CLASS	FRONT FOOT	
438-0372-000 1	1211 S 56 ST	LUSTIG JULIE A	4	30.00	870
DESCRIPTION	FOOTAGE	RATE	GROSS	PERCENT	NET
RECONSTRUCTION (CONC/ASPH)/MISC WALK - RES	30.00	34.63	1,038.90	100.00	1,038.90

KEY	ADDRESS	OWNER	CLASS	FRONT FOOT	
438-0371-000 1	1215 S 56 ST	LUCCHESI MARK & PEARL	4	45.00	880
DESCRIPTION	FOOTAGE	RATE	GROSS	PERCENT	NET
RECONSTRUCTION (CONC/ASPH)/MISC WALK - RES	45.00	34.63	1,558.35	100.00	1,558.35

KEY	ADDRESS	OWNER	CLASS	FRONT FOOT	
438-0370-000 1	5600 W NATL & 1227-33 S	AGNOS DINO	3	0.00	N89W25259 HIGHLAND PRESE 890
DESCRIPTION	FOOTAGE	RATE	GROSS	PERCENT	NET
7" CONCRETE DRIVEWAY APPROACH PER SO FT	0.00	4.31	0.00	100.00	0.00
RECONSTRUCTION (CONC/ASPH)/MISC WALK - COM	82.77	43.29	3,583.11	40.00	1,433.33
STORM SEWER LATERAL - COM	0.00	892.00	892.00	100.00	892.00
			4,475.11		2,325.33

178 130,706.78 127,848.86 3,747.88 *****TOTALS FOR PROJECT *****

CODE	NUMBER	GROSS	NET	FOOTAGE	CODE DESCRIPTION
	22	232.40	0.00	53.92	7" CONCRETE DRIVEWAY APPROACH PER SQ FT
	87	121,281.53	121,143.01	3,502.21	RECONSTRUCTION (CONC/ASPH)/MISC WALK - RES
	2	8,300.85	5,813.85	191.75	RECONSTRUCTION (CONC/ASPH)/MISC WALK - COM
	1	892.00	892.00	0.00	STORM SEWER LATERAL - COM