

I hit the bottom metal part of my van. Late last week June 6th, 2024 I drove my van up our grade at work front end first. That is when I noticed the damage to my front bumper. I am enclosing pictures of my van, copy of damage estimate and pictures of the approach to the alley on 61st Street. I swear that my statement is 100% true. I think a person should be able to drive into an alley way and not have to worry about damaging their vehicle. My description of what happened is as true and accurate as possible.

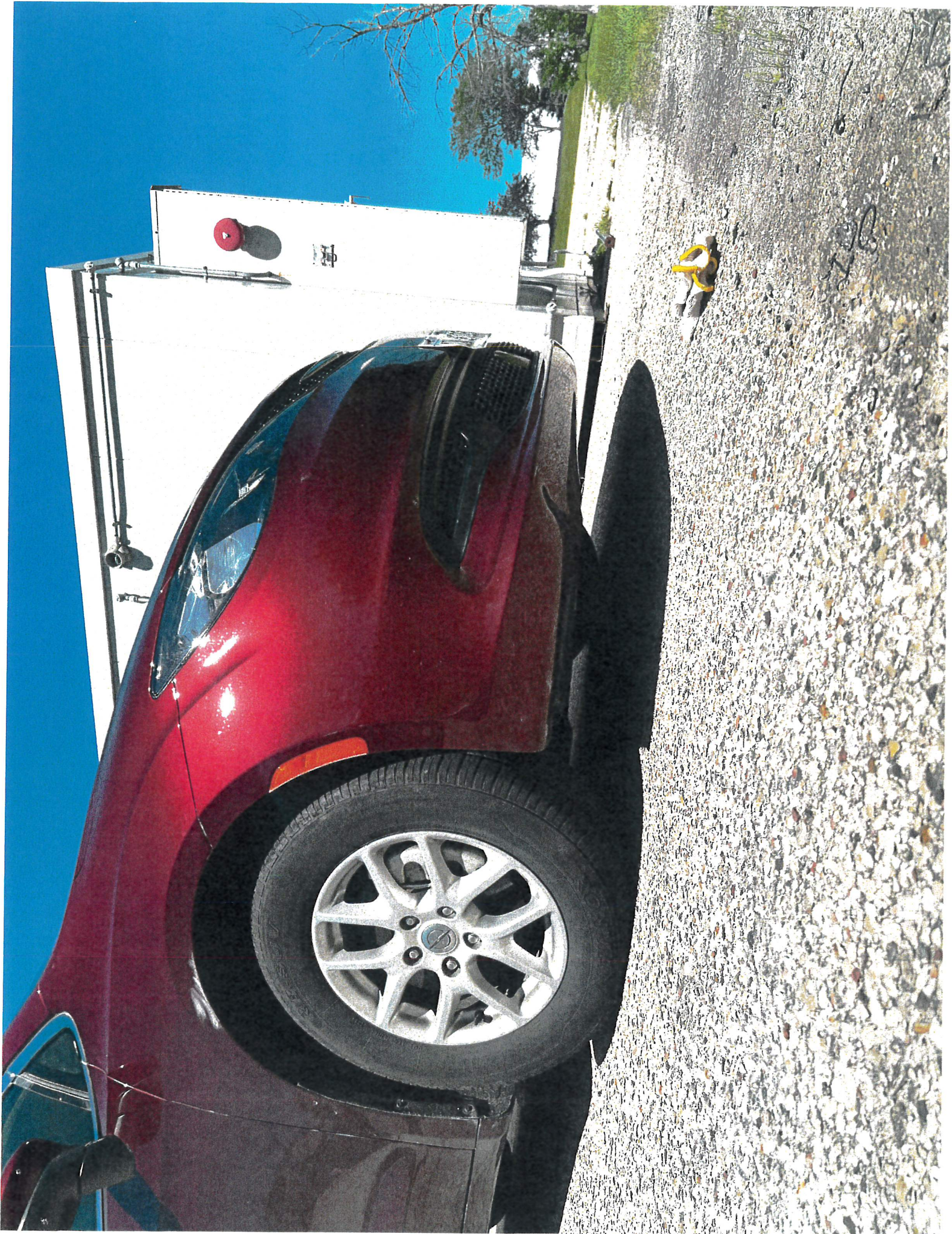

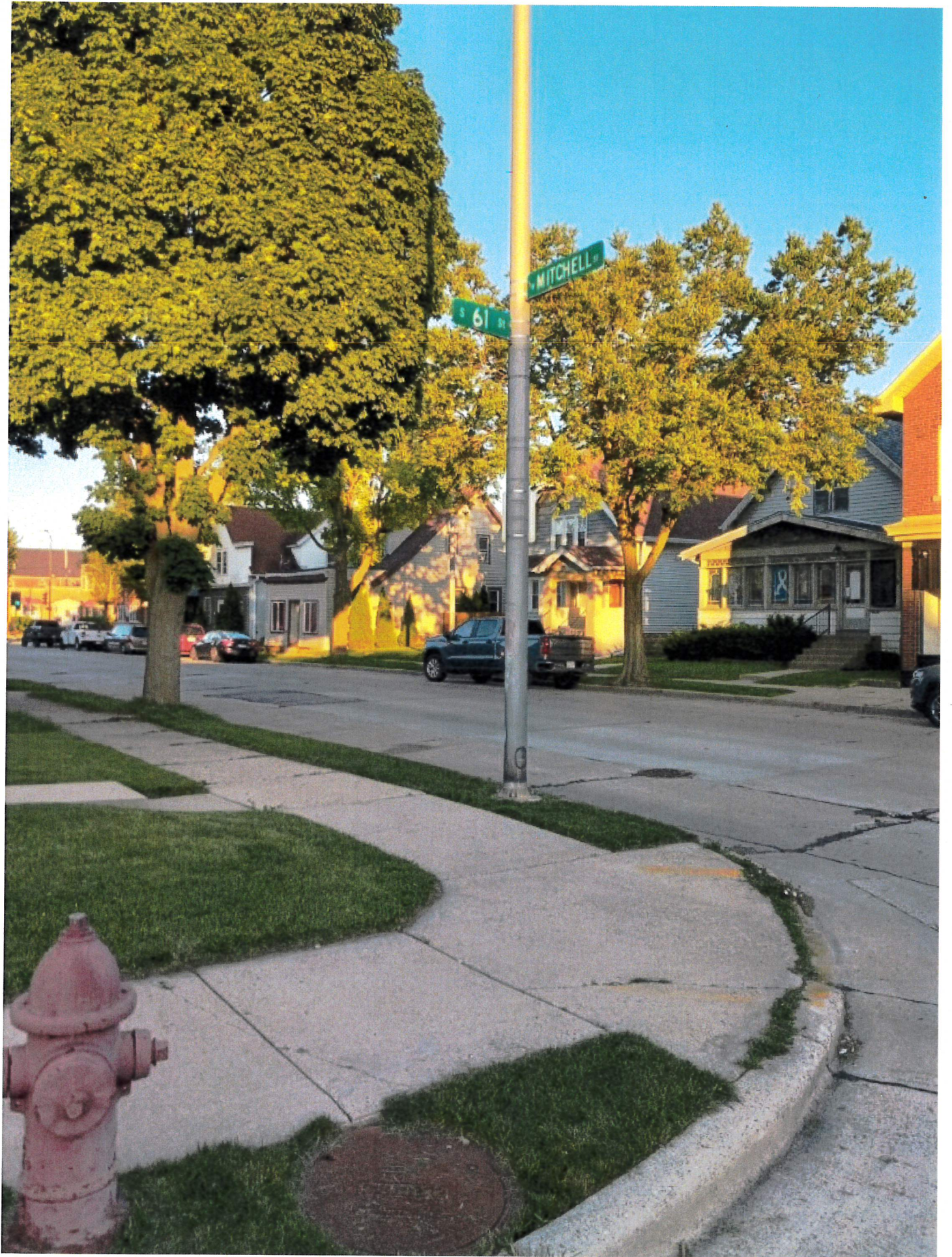





S 61st St

MITCHELL St











Mander Collision & Glass, Inc.
Waukesha

1604 Manhattan Dr., Waukesha, WI 53186
Phone: (262) 446-0655
FAX: (262) 446-0650

Workfile ID: 8d99437a
PartsShare: 7YPSbj
Federal ID: 41-2000478
State ID: 036-0000106494-04
Resale Number: 456-0000106494-03
Federal EPA: N/A
State EPA: N/A

Preliminary Estimate

Customer: DOMBROWSKI, DENNIS

Job Number:

Written By: Justin Tanck

Insured: DOMBROWSKI, DENNIS Policy #: Claim #: NA
Type of Loss: Date of Loss: Days to Repair: 0
Point of Impact:

Owner: DOMBROWSKI, DENNIS **Inspection Location:** Mander Collision & Glass, Inc. Waukesha
1948 S 59TH ST 1604 Manhattan Dr.
MILWAUKEE, WI 53219-1546 Waukesha, WI 53186
(262) 501-5676 Cell Repair Facility
(262) 521-2870 Business (262) 446-0655 Day
Insurance Company:

VEHICLE

2021 CHRY Voyager LXI FWD (Fleet) 4D VAN 6-3.6L Gasoline Sequential MPI

VIN: 2C4RC1DG4MR509032 Interior Color: Mileage In: Vehicle Out:
License: Exterior Color: Mileage Out:
State: WI Production Date: Condition: Job #:

TRANSMISSION

Automatic Transmission

POWER

Power Steering
Power Brakes
Power Windows
Power Locks
Power Mirrors
Heated Mirrors
Power Driver Seat

DECOR

Dual Mirrors
Privacy Glass
Console/Storage
Overhead Console

CONVENIENCE

Air Conditioning

Intermittent Wipers

Tilt Wheel

Cruise Control

Rear Defogger

Keyless Entry

Alarm

Message Center

Steering Wheel Touch Controls

Rear Window Wiper

Telescopic Wheel

Climate Control

Dual Air Condition

Backup Camera

Dual Power Sliding Doors

Remote Starter

Home Link

RADIO

AM Radio

FM Radio

Stereo

Search/Seek

Auxiliary Audio Connection

Satellite Radio

SAFETY

Drivers Side Air Bag

Passenger Air Bag

Anti-Lock Brakes (4)

4 Wheel Disc Brakes

Traction Control

Stability Control

Front Side Impact Air Bags

Head/Curtain Air Bags

Hands Free Device

ROOF

Luggage/Roof Rack

SEATS

Bucket Seats
Reclining/Lounge Seats
Leather Seats
3rd Row Seat
Retractable Seats

WHEELS

Aluminum/Alloy Wheels

PAINT

Three Stage Paint

OTHER

Rear Spoiler
California Emissions

Preliminary Estimate

Customer: DOMBROWSKI, DENNIS

Job Number:

2021 CHRY Voyager LXI FWD (Fleet) 4D VAN 6-3.6L Gasoline Sequential MPI

Line	Oper	Description	Part Number	Qty	Extended Price \$	Labor	Paint
1		FRONT BUMPER & GRILLE					
2	* <>	Rpr Bumper cover				6.0	3.3
3		Add for Three Stage					2.3
4		O/H bumper assy				3.9	
5	Repl	Air shield	68273160AF	1	127.00	Incl.	
6		VEHICLE DIAGNOSTICS					
7	* Rpr	Pre-repair scan				0.5 M	
8	* Rpr	Post-repair scan				0.5 M	
9	# Subl	Hazardous waste removal		1	5.00 T		
10	# Repl	Flex additive		1	5.00		
11	** Repl	A/M Clips and Nuts		1	10.00		
12	#	***Additional Damage May Be Found***		1			
SUBTOTALS					147.00	10.9	5.6

ESTIMATE TOTALS

Category	Basis	Rate	Cost \$
Parts			142.00
Body Labor	9.9 hrs @	\$ 76.00 /hr	752.40
Paint Labor	5.6 hrs @	\$ 76.00 /hr	425.60
Mechanical Labor	1.0 hrs @	\$ 115.00 /hr	115.00
Paint Supplies	5.6 hrs @	\$ 56.00 /hr	313.60
Miscellaneous			5.00
Subtotal			1,753.60
Sales Tax	\$ 1,753.60 @	5.0000 %	87.68
Grand Total			1,841.28

**Additional damage may be found after disassembly. **

A scheduled appointment is a date in which the vehicle is put into a queue and may take up to a week for an available technician to perform a disassembly.??

During the repair process the damage amount may go up due to part price increases or calibration costs.

MOTOR VEHICLE REPAIR PRACTICES ARE REGULATED BY CHAPTER ATCP 132, WIS. ADM. CODE, ADMINISTERED BY THE BUREAU OF CONSUMER PROTECTION, WISCONSIN DEPT. OF AGRICULTURE, TRADE AND CONSUMER PROTECTION, P.O. BOX 8911, MADISON, WISCONSIN 53708-8911.

Preliminary Estimate

Customer: DOMBROWSKI, DENNIS

Job Number:

2021 CHRY Voyager LXI FWD (Fleet) 4D VAN 6-3.6L Gasoline Sequential MPI

Estimate based on MOTOR CRASH ESTIMATING GUIDE and potentially other third party sources of data. Unless otherwise noted, (a) all items are derived from the Guide DR3NS17, CCC Data Date 05/16/2024, and potentially other third party sources of data; and (b) the parts presented are OEM-parts. OEM parts are manufactured by or for the vehicle's Original Equipment Manufacturer (OEM) according to OEM's specifications for U.S. distribution. OEM parts are available at OE/Vehicle dealerships or the specified supplier. OPT OEM (Optional OEM) or ALT OEM (Alternative OEM) parts are OEM parts that may be provided by or through alternate sources other than the OEM vehicle dealerships with discounted pricing. Asterisk (*) or Double Asterisk (**) indicates that the parts and/or labor data provided by third party sources of data may have been modified or may have come from an alternate data source. Tilde sign (~) items indicate MOTOR Not-Included Labor operations. The symbol (<>) indicates the refinish operation WILL NOT be performed as a separate procedure from the other panels in the estimate. Non-Original Equipment Manufacturer aftermarket parts are described as Non OEM, A/M or NAGS. Used parts are described as LKQ, RCY, or USED. Reconditioned parts are described as Recond. Recored parts are described as Recore. NAGS Part Numbers and Benchmark Prices are provided by National Auto Glass Specifications. Labor operation times listed on the line with the NAGS information are MOTOR suggested labor operation times. NAGS labor operation times are not included. Pound sign (#) items indicate manual entries.

Some 2024 vehicles contain minor changes from the previous year. For those vehicles, prior to receiving updated data from the vehicle manufacturer, labor and parts data from the previous year may be used. The CCC ONE estimator has a list of applicable vehicles. Parts numbers and prices should be confirmed with the local dealership.

The following is a list of additional abbreviations or symbols that may be used to describe work to be done or parts to be repaired or replaced:

SYMBOLS FOLLOWING PART PRICE:

m=MOTOR Mechanical component. s=MOTOR Structural component. T=Miscellaneous Taxed charge category. X=Miscellaneous Non-Taxed charge category.

SYMBOLS FOLLOWING LABOR:

D=Diagnostic labor category. E=Electrical labor category. F=Frame labor category. G=Glass labor category. M=Mechanical labor category. S=Structural labor category. (numbers) 1 through 4=User Defined Labor Categories.

OTHER SYMBOLS AND ABBREVIATIONS:

Adj.=Adjacent. Algn.=Align. ALU=Aluminum. A/M=Aftermarket part. Blnd=Blend. BOR=Boron steel. CAPA=Certified Automotive Parts Association. D&R=Disconnect and Reconnect. HSS=High Strength Steel. HYD=Hydroformed Steel. Incl.=Included. LKQ=Like Kind and Quality. LT=Left. MAG=Magnesium. Non-Adj.=Non Adjacent. NSF=NSF International Certified Part. O/H=Overhaul. Qty=Quantity. Refn=Refinish. Repl=Replace. R&I=Remove and Install. R&R=Remove and Replace. Rpr=Repair. RT=Right. SAS=Sandwiched Steel. Sect=Section. Subl=Sublet. UHS=Ultra High Strength Steel. N=Note(s) associated with the estimate line.

CCC ONE Estimating - A product of CCC Intelligent Services Inc.

The following is a list of abbreviations that may be used in CCC ONE Estimating that are not part of the MOTOR CRASH ESTIMATING GUIDE:

BAR=Bureau of Automotive Repair. EPA=Environmental Protection Agency. NHTSA= National Highway Transportation and Safety Administration. PDR=Paintless Dent Repair. VIN=Vehicle Identification Number.

