



City of West Allis

Matter Summary

7525 W. Greenfield Ave.
West Allis, WI 53214

File Number	Title	Status
R-2011-0031	Resolution	Introduced
Resolution approving a Certified Survey Map to combine all existing platted lots within tax key number 475-0195-001 for the proposed demolition of the existing New Samaria apartment building and construction of a new 50-unit multi-family apartment building to be located at 6640-6700 W. Beloit Rd. submitted by Norman Barrientos Design and Erich Schwenker of Cardinal Capital Management.		
Introduced: 2/15/2011		Controlling Body: Safety & Development Committee
		Sponsor(s): Safety & Development Committee

COMMITTEE RECOMMENDATION

ADOPT

ACTION DATE:	MOVER	SECONDER		AYE	NO	PRESENT	EXCUSED
<u>2/15/11</u>			Barczak				
			Czaplewski				
			Kopplin	✓			
			Lajsic	✓			
			Narlock	✓			
			Reinke	✓			
			Roadt				
			Sengstock				
	✓		Vitale	✓			
			Weigel				
TOTAL				<u>5</u>	<u>0</u>		

SIGNATURE OF COMMITTEE MEMBER

Chair

Vice-Chair

Member

COMMON COUNCIL ACTION

ADOPT

ACTION DATE:	MOVER	SECONDER		AYE	NO	PRESENT	EXCUSED
<u>FEB 15 2011</u>		✓	Barczak	✓			
			Czaplewski	✓			
			Kopplin	✓			
	✓		Lajsic	✓			
			Narlock	✓			
			Reinke	✓			
			Roadt	✓			
			Sengstock	✓			
			Vitale	✓			
			Weigel	✓			
TOTAL				<u>10</u>			

**STANDING COMMITTEES OF THE
CITY OF WEST ALLIS COMMON COUNCIL**

ADMINISTRATION & FINANCE

Chair: Kurt E. Kopplin
Vice-Chair: Vincent Vitale
Thomas G. Lajsic
Richard F. Narlock
Rosalie L. Reinke

PUBLIC WORKS

Chair: Gary T. Barczak
Vice-Chair: Martin J. Weigel
Michael J. Czaplewski
Daniel J. Roadt
James W. Sengstock

SAFETY & DEVELOPMENT

Chair: Thomas G. Lajsic
Vice-Chair: Richard F. Narlock
Kurt E. Kopplin
Rosalie L. Reinke
Vincent Vitale

LICENSE & HEALTH

Chair: Michael J. Czaplewski
Vice-Chair: James W. Sengstock
Gary T. Barczak
Daniel J. Roadt
Martin J. Weigel

ADVISORY

Chair: Rosalie L. Reinke
Vice-Chair: Daniel J. Roadt
Kurt E. Kopplin
Richard F. Narlock
Vincent Vitale



City of West Allis

7525 W. Greenfield Ave.
West Allis, WI 53214

Resolution

File Number: R-2011-0031

Final Action:

Sponsor(s): Safety & Development Committee

FEB 15 2011

Resolution approving a Certified Survey Map to combine all existing platted lots within tax key number 475-0195-001 for the proposed demolition of the existing New Samaria apartment building and construction of a new 50-unit multi-family apartment building to be located at 6640-6700 W. Beloit Rd. submitted by Norman Barrientos Design and Erich Schwenker of Cardinal Capital Management.

WHEREAS, Erich Schwenker, d/b/a Cardinal Capital Management submitted a Certified Survey Map to combine all existing platted lots within tax key number 475-0195-001 for the proposed demolition of the existing New Samaria apartment building and construction of a new 50-unit multi-family apartment building to be located at 6640-6700 W. Beloit Rd.

NOW THEREFORE BE IT RESOLVED by the Common Council of the City of West Allis, Wisconsin, that the Certified Survey Map of a parcel of land being lots 7 to 16 inclusive, in Block 5, JUNEAU HIGHLANDS, located in part of the Southeast 1/4 of Section 3, Township 6 North, Range 21 East, City of West Allis, Milwaukee County, Wisconsin be and the same is hereby adopted.

ADOPTED

FEB 15 2011

Paul M. Ziehler, City Admin. Officer, Clerk/Treas.

APPROVED

2/18/11

Dan Devine, Mayor

CERTIFIED SURVEY MAP NO. _____

Being Lots 7 to 16 inclusive, in Block 5, JUNEAU HIGHLANDS, being a part of the Southeast 1/4 of Section 3, Township 6 North, Range 21 East, City of West Allis, Milwaukee County, Wisconsin.

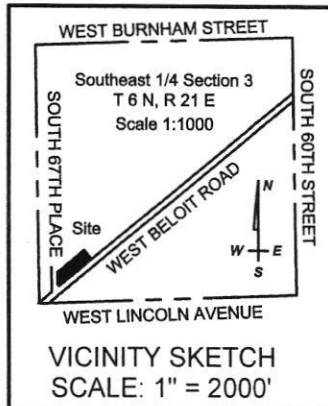
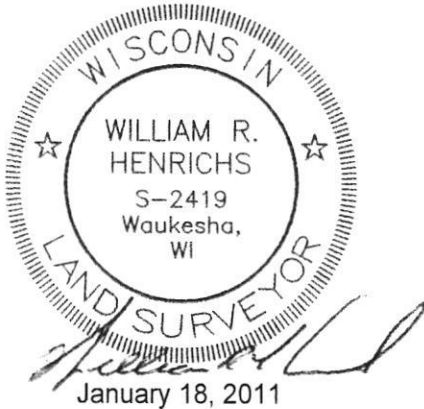

Bearings refer to Grid North of the Wisconsin State Plane Coordinate System Grid, South Zone per N.A.D. 27. The South line of the Southeast 1/4 of Section 3, Township 6 North, Range 21 East has a reference bearing of N 88°09'43" E. (June 2009 Datum)

Zoned: C-2 Neighborhood Commercial District
Tax Key No. 475-0195-001

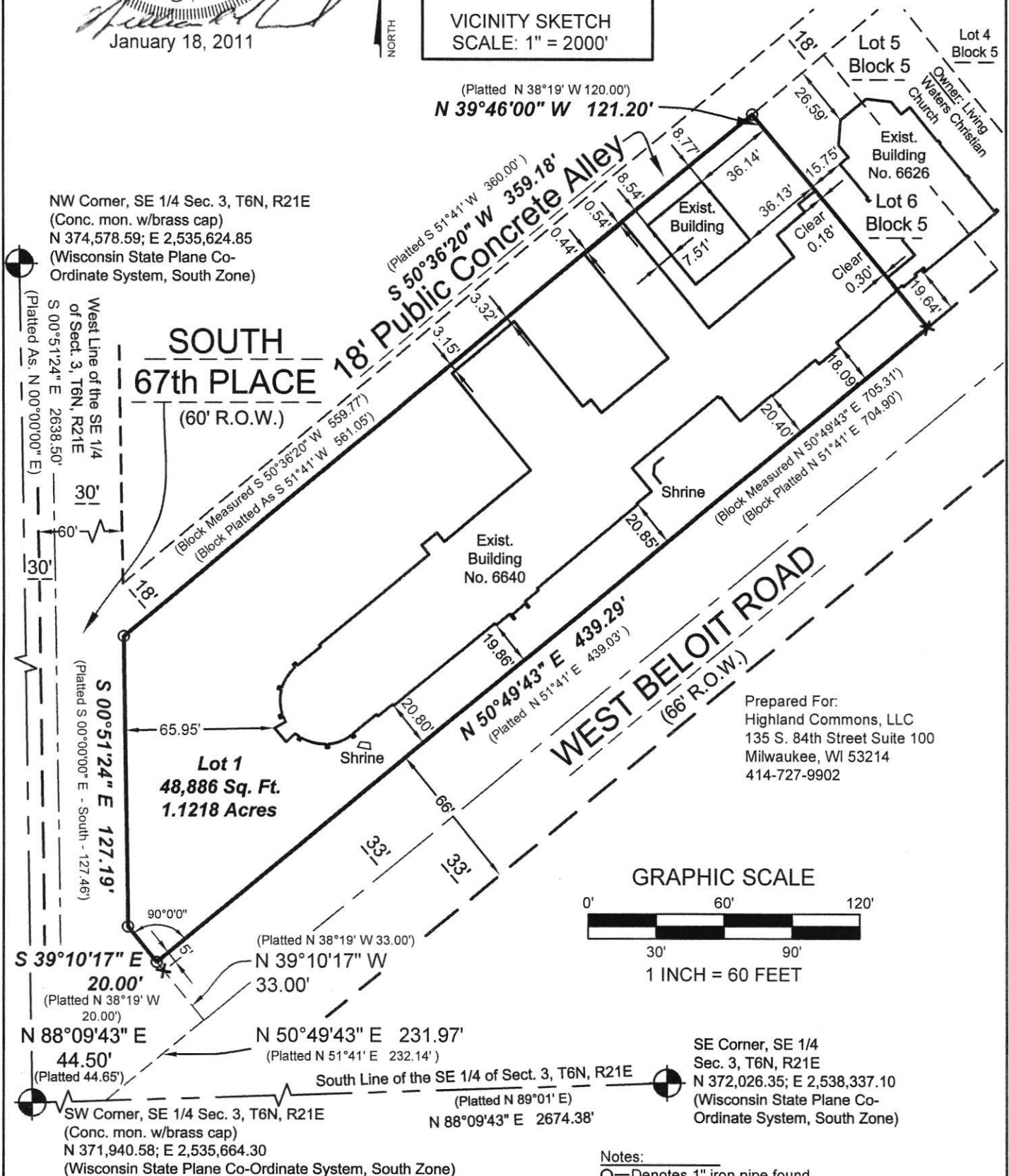

Prepared For:
Highland Commons, LLC
135 S. 84th Street Suite 100
Milwaukee, WI 53214
414-727-9902

GRAPHIC SCALE

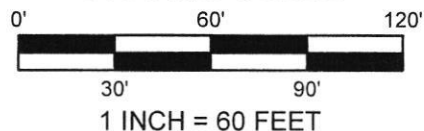

SE Corner, SE 1/4
Sec. 3, T6N, R21E
N 372,026.35; E 2,538,337.10
(Wisconsin State Plane Co-Ordinate System, South Zone)

Notes:

- Denotes 1" iron pipe found
- Denotes 1" x 24" iron pipe set, 1.68 lbs. per lin. ft.
- +—Denotes Found Chiseled Cross in Concrete

DAAR ENGINEERING, INC.

REGISTERED LAND SURVEYORS AND CIVIL ENGINEERS
2077 South 116th Street, West Allis, WI 53227
PH. (414) 604-0674 FAX (414) 604-0677
WWW.DAARENGINEERING.COM

This instrument drafted by
William R. Henrichs, RLS S-2419

Job Number: 100330
December 2, 2010
Sheet 1 of 4 Sheets

CERTIFIED SURVEY MAP NO. _____

Being Lots 7 to 16 inclusive, in Block 5, JUNEAU HIGHLANDS, being a part of the Southeast 1/4 of Section 3, Township 6 North, Range 21 East, City of West Allis, Milwaukee County, Wisconsin.

SURVEYOR'S CERTIFICATE

STATE OF WISCONSIN)
MILWAUKEE COUNTY) SS

I, William R. Henrichs, Registered Land Surveyor, do hereby certify:

That I have surveyed and mapped Lots 7 to 16 inclusive, in Block 5, JUNEAU HIGHLANDS, being a part of the Southeast 1/4 of Section 3, Township 6 North, Range 21 East, City of West Allis, Milwaukee County, Wisconsin, which is bounded and described as follows:

Commencing at the Southwest corner of said Southeast 1/4;
Thence N 88°09'43" E, along the South line of said Southeast 1/4, a distance of 44.50 feet;
Thence N 50°49'43" E, 231.97 feet;
Thence N 39°10'17" W, 33.00 feet to the Northerly right-of-way line of West Beloit Road and the Point of Beginning;
Thence N 50°49'43" E, 439.29 feet along said North right-of-way line;
Thence N 39°46'00" W, 121.20 feet;
Thence S 50°36'20" W, 359.18 feet to the Easterly right-of-way of South 67th Place;
Thence S 00°51'24" E, 127.19 feet along said Easterly right-of-way;
Thence S 39°10'17" E, 20.00 feet to the Point of Beginning.

Said lands containing 48,886 square feet, 1.1218 acres.

That I have made such survey, land division and map by the direction of Highland Commons, LLC, owner of said land.

That such plat is a correct representation of all the exterior boundaries of the land surveyed and the land division thereof made.

That I have fully complied with the provisions of s.236.34 of the Wisconsin State Statutes and the City of West Allis Land Division Ordinance in surveying, mapping and dividing the same.

January 18, 2011

Date

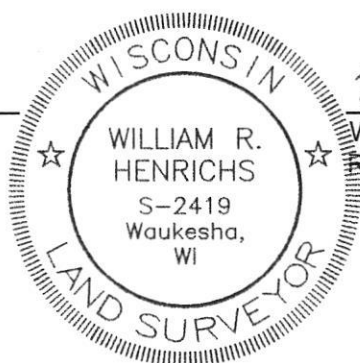

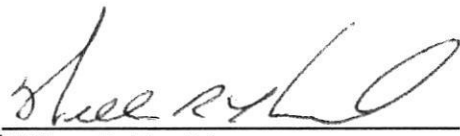
William R. Henrichs
Registered Land Surveyor, S-2419

DAAR ENGINEERING, INC.

REGISTERED LAND SURVEYORS AND CIVIL ENGINEERS

2077 South 116th Street, West Allis, WI 53227

PH. (414) 604-0674 FAX (414) 604-0677

WWW.DAARENGINEERING.COM

This instrument drafted by

William R. Henrichs, RLS S-2419

Job Number: 100330

December 2, 2010

Sheet 2 of 4 Sheets

CERTIFIED SURVEY MAP NO. _____

Being Lots 7 to 16 inclusive, in Block 5, JUNEAU HIGHLANDS, being a part of the Southeast 1/4 of Section 3, Township 6 North, Range 21 East, City of West Allis, Milwaukee County, Wisconsin.

COMMON COUNCIL APPROVAL

Be it resolved by the Common Council of the City of West Allis, Wisconsin, that the Certified Survey Map of a parcel of land being Lots 7 to 16 inclusive, in Block 5, JUNEAU HIGHLANDS, located in part of the Southeast 1/4 of Section 3, Township 6 North, Range 21 East, City of West Allis, Milwaukee County, Wisconsin be and the same is hereby adopted.

Approved: _____ Adopted: _____

Dan Devine, Mayor

Paul Ziehler
City Administrative Officer
Clerk/Treasurer

CERTIFICATE OF COUNTY TREASURER

STATE OF WISCONSIN)
MILWAUKEE COUNTY) SS

I, Daniel Diliberti, being the duly elected, qualified and acting Treasurer of the County of Milwaukee, Wisconsin, do hereby certify that in accordance with the records in my office, there are no unpaid taxes of unpaid special assessments as of _____, 2011 on any of the lands included in this Certified Survey Map.

Date

Daniel Diliberti
Milwaukee County Treasurer

CERTIFICATE OF CITY TREASURER

I, Paul Ziehler, being the duly elected, qualified and acting Treasurer of the City of West Allis, Wisconsin, do hereby certify that in accordance with the records in my office, there are no unpaid taxes of unpaid special assessments as of _____, 2011 on any of the lands included in this Certified Survey Map.

Date

Paul Ziehler
City Administrative Officer
Clerk/Treasurer

CERTIFICATE OF CITY CLERK

I, Paul Ziehler, being the duly elected, qualified and acting City Clerk of the City of West Allis, Wisconsin, and that the foregoing is a true and correct copy of a resolution adopted by the Common Council of the City of West Allis, Wisconsin on the _____ day of _____, 2011.

Date

Paul Ziehler
City Administrative Officer
Clerk/Treasurer

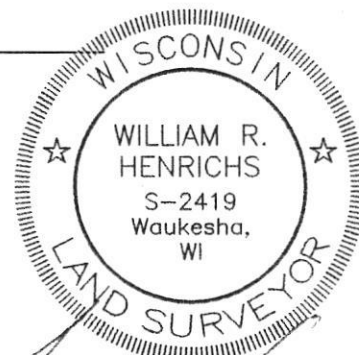

January 18, 2011

DAAR ENGINEERING, INC.
REGISTERED LAND SURVEYORS AND CIVIL ENGINEERS
2077 South 116th Street, West Allis, WI 53227
PH. (414) 604-0674 FAX (414) 604-0677
WWW.DAARENGINEERING.COM

This instrument drafted by
William R. Henrichs, RLS S-2419

Job Number: 100330
December 2, 2010
Sheet 4 of 4 Sheets

CERTIFIED SURVEY MAP NO. _____

Being Lots 7 to 16 inclusive, in Block 5, JUNEAU HIGHLANDS, being a part of the Southeast 1/4 of Section 3, Township 6 North, Range 21 East, City of West Allis, Milwaukee County, Wisconsin.

CORPORATE OWNER'S CERTIFICATE OF DEDICATION

Highland Commons, LLC, a limited liability company duly organized and existing under and by virtue of the laws of the State of Wisconsin, as owner, does hereby certify that said limited liability company caused the land described on this certified survey map to be surveyed and mapped as represented on this certified survey map. I also certify that this certified survey map is required by s.236.10 or s.236.12 of the Wisconsin State Statutes to be submitted to the following for approval or objection:

1. City of West Allis
2. County of Milwaukee

IN WITNESS WHEREOF, the said Highland Commons, LLC, has caused these presents to be signed by Erich Schwenker, President of Cardinal Capital Management, Inc., managing member of CCM - Highland Commons, LLC, the managing member of Highland Commons, LLC, at West Allis, Milwaukee County, Wisconsin, on this _____ day of _____, 2011.

In the presence of: Highland Commons, LLC.

By: CCM - Highland Commons, LLC, it's managing member.

By: Cardinal Capital Management, Inc. it's managing member.

By: _____
Erich Schwenker - President

STATE OF WISCONSIN)
MILWAUKEE COUNTY) SS

Personally came before me this _____ day of _____, 2011, Erich Schwenker, President of Cardinal Capital Management, Inc., managing member of CCM - Highland Commons, LLC, the managing member of Highland Commons, LLC, to me known to be the persons who executed the foregoing instrument and acknowledged that they executed the foregoing instrument as such officer as the deed of said limited liability company, by its authority.

Notary Public
State of Wisconsin
My Commission Expires: _____



January 18, 2011

DAAR ENGINEERING, INC.
REGISTERED LAND SURVEYORS AND CIVIL ENGINEERS
2077 South 116th Street, West Allis, WI 53227
PH. (414) 604-0674 FAX (414) 604-0677
WWW.DAARENGINEERING.COM

This instrument drafted by
William R. Henrichs, RLS S-2419

Job Number: 100330
December 2, 2010
Sheet 3 of 4 Sheets



September 27, 2011

CITY CLERK/TREASURER'S OFFICE

414/302-8200 or 414/302-8207 (Fax)

www.westalliswi.gov

Paul M. Ziehler

City Admin. Officer, Clerk/Treasurer

Monica Schultz

Assistant City Clerk

Rosemary West

Treasurer's Office Supervisor

Cardinal Capital Management, Inc.

Attn: Mr. Erich Schwenker

135 S. 84 Street,

Suite 100

Milwaukee, WI 53214

Dear Mr. Schwenker:

Enclosed is a copy of Certified Survey Map No. 8377, to combine all existing platted lots within tax key number 475-0195-001 for the proposed demolition of the existing New Samaria apartment building and construction of a new 50-unit multi-family apartment building to be located at 6640-6700 W. Beloit Rd. submitted by Norman Barrientos Design and Erich Schwenker of Cardinal Capital Management, which was recorded on August 11, 2011.

Sincerely,

Monica Schultz

Assistant City Clerk

/jl

enclosure

cc: Development Department
City Engineer
City Assessor
Director of Building Inspections and Neighborhood Services
Special Assessment Clerk
Pat Walker
Highland Commons, LLC.
William R. Henrichs, Surveyor

CERTIFIED SURVEY MAP NO. 8377

Being Lots 7 to 16 inclusive, in Block 5, JUNEAU HIGHLANDS, being a part of the Southeast 1/4 of Section 3, Township 6 North, Range 21 East, City of West Allis, Milwaukee County, Wisconsin.

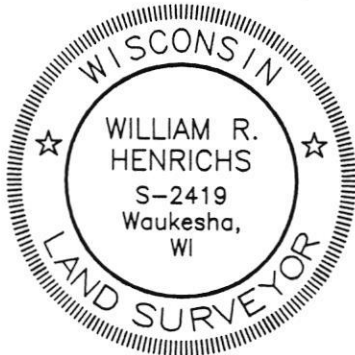

January 18, 2011

William R. Henrichs

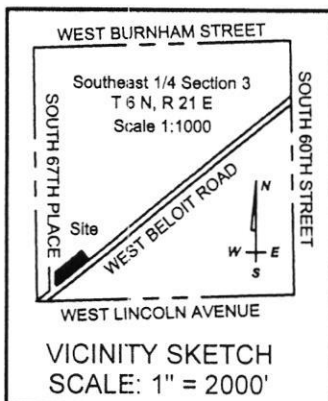

Bearings refer to Grid North of the Wisconsin State Plane Coordinate System Grid, South Zone per N.A.D. 27. The South line of the Southeast 1/4 of Section 3, Township 6 North, Range 21 East has a reference bearing of N 88°09'43" E. (June 2009 Datum)

Zoned: C-2 Neighborhood Commercial District
Tax Key No. 475-0195-001

NW Corner, SE 1/4 Sec. 3, T6N, R21E
(Conc. mon. w/brass cap)
N 374,578.59; E 2,535,624.85
(Wisconsin State Plane Co-Ordinate System, South Zone)

West Line of the SE 1/4 of Sect. 3, T6N, R21E
S 00°51'24" E 2638.50'
(Platted As. N 00°00'00" E)

SOUTH 67th PLACE
(60' R.O.W.)

18' Public Concrete Alley
(Platted S 51°41' W 360.00')
S 50°36'20" W 359.18'

S 00°51'24" E 127.19'
(Platted S 00°00'00" E - South - 127.46')

Lot 1
48,886 Sq. Ft.
1.1218 Acres

S 39°10'17" E 20.00'
(Platted N 38°19' W 20.00')
N 88°09'43" E 44.50'
(Platted 44.65')

SW Corner, SE 1/4 Sec. 3, T6N, R21E
(Conc. mon. w/brass cap)
N 371,940.58; E 2,535,664.30
(Wisconsin State Plane Co-Ordinate System, South Zone)

(Platted N 38°19' W 33.00')
N 39°10'17" W 33.00'
(Platted N 51°41' E 232.14')
N 50°49'43" E 231.97'

South Line of the SE 1/4 of Sect. 3, T6N, R21E
(Platted N 89°01' E)
N 88°09'43" E 2674.38'

Exist. Building No. 6640

Shrine

WEST BELOIT ROAD
(66' R.O.W.)
N 50°49'43" E 439.29'
(Platted N 51°41' E 439.03')

GRAPHIC SCALE

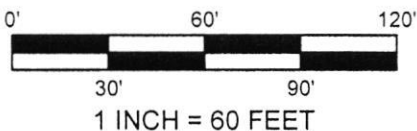

Prepared For:
Highland Commons, LLC
135 S. 84th Street Suite 100
Milwaukee, WI 53214
414-727-9902

SE Corner, SE 1/4 Sec. 3, T6N, R21E
N 372,026.35; E 2,538,337.10
(Wisconsin State Plane Co-Ordinate System, South Zone)

Notes:

- Denotes 1" iron pipe found
- Denotes 1" x 24" iron pipe set, 1.68 lbs. per lin. ft.
- +—Denotes Found Chiseled Cross in Concrete

DAAR ENGINEERING, INC.
REGISTERED LAND SURVEYORS AND CIVIL ENGINEERS
518 West Cherry Street, Milwaukee, WI 53212
PH. (414) 604-0674 FAX (414) 604-0677
WWW.DAARENGINEERING.COM

This instrument drafted by
William R. Henrichs, RLS S-2419

Job Number: 100330
December 2, 2010
Sheet 1 of 4 Sheets

CERTIFIED SURVEY MAP NO. 8377

Being Lots 7 to 16 inclusive, in Block 5, JUNEAU HIGHLANDS, being a part of the Southeast 1/4 of Section 3, Township 6 North, Range 21 East, City of West Allis, Milwaukee County, Wisconsin.

SURVEYOR'S CERTIFICATE

STATE OF WISCONSIN)
MILWAUKEE COUNTY) SS

I, William R. Henrichs, Registered Land Surveyor, do hereby certify:

That I have surveyed and mapped Lots 7 to 16 inclusive, in Block 5, JUNEAU HIGHLANDS, being a part of the Southeast 1/4 of Section 3, Township 6 North, Range 21 East, City of West Allis, Milwaukee County, Wisconsin, which is bounded and described as follows:

Commencing at the Southwest corner of said Southeast 1/4;
Thence N 88°09'43" E, along the South line of said Southeast 1/4, a distance of 44.50 feet;
Thence N 50°49'43" E, 231.97 feet;
Thence N 39°10'17" W, 33.00 feet to the Northerly right-of-way line of West Beloit Road and the Point of Beginning;
Thence N 50°49'43" E, 439.29 feet along said North right-of-way line;
Thence N 39°46'00" W, 121.20 feet;
Thence S 50°36'20" W, 359.18 feet to the Easterly right-of-way of South 67th Place;
Thence S 00°51'24" E, 127.19 feet along said Easterly right-of-way;
Thence S 39°10'17" E, 20.00 feet to the Point of Beginning.

Said lands containing 48,886 square feet, 1.1218 acres.

That I have made such survey, land division and map by the direction of Highland Commons, LLC, owner of said land.

That such plat is a correct representation of all the exterior boundaries of the land surveyed and the land division thereof made.

That I have fully complied with the provisions of s.236.34 of the Wisconsin State Statutes and the City of West Allis Land Division Ordinance in surveying, mapping and dividing the same.

January 18, 2011

Date

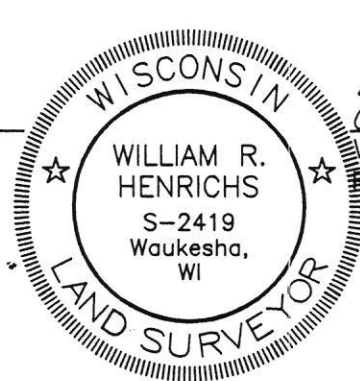

William R. Henrichs
Registered Land Surveyor, S-2419

DOC.# 10022385

RECORDED 08/11/2011 10:27AM
JOHN LA FAVE
REGISTER OF DEEDS
Milwaukee County, WI
AMOUNT: 30.00
FEE EXEMPT #:

DAAR ENGINEERING, INC.
REGISTERED LAND SURVEYORS AND CIVIL ENGINEERS
518 West Cherry Street, Milwaukee, WI 53212
PH. (414) 604-0674 FAX (414) 604-0677
WWW.DAARENGINEERING.COM

This instrument drafted by
William R. Henrichs, RLS S-2419

Job Number: 100330
December 2, 2010
Sheet 2 of 4 Sheets

CERTIFIED SURVEY MAP NO. 8377

Being Lots 7 to 16 inclusive, in Block 5, JUNEAU HIGHLANDS, being a part of the Southeast 1/4 of Section 3, Township 6 North, Range 21 East, City of West Allis, Milwaukee County, Wisconsin.

CORPORATE OWNER'S CERTIFICATE OF DEDICATION

Highland Commons, LLC, a limited liability company duly organized and existing under and by virtue of the laws of the State of Wisconsin, as owner, does hereby certify that said limited liability company caused the land described on this certified survey map to be surveyed and mapped as represented on this certified survey map. I also certify that this certified survey map is required by s.236.10 or s.236.12 of the Wisconsin State Statutes to be submitted to the following for approval or objection:

1. City of West Allis
2. County of Milwaukee

IN WITNESS WHEREOF, the said Highland Commons, LLC, has caused these presents to be signed by Erich Schwenker, President of Cardinal Capital Management, Inc., managing member of CCM - Highland Commons, LLC, the managing member of Highland Commons, LLC, at West Allis, Milwaukee County, Wisconsin, on this 11 day of August, 2011.

In the presence of: Highland Commons, LLC.
By: CCM - Highland Commons, LLC, it's managing member.
By: Cardinal Capital Management, Inc. it's managing member.

By: Erich Schwenker
Erich Schwenker - President

STATE OF WISCONSIN)
MILWAUKEE COUNTY) SS

Personally came before me this 11 day of August, 2011, Erich Schwenker, President of Cardinal Capital Management, Inc., managing member of CCM - Highland Commons, LLC, the managing member of Highland Commons, LLC, to me known to be the persons who executed the foregoing instrument and acknowledged that they executed the foregoing instrument as such officer as the deed of said limited liability company, by its authority.

Carol L. Kane
Notary Public
State of Wisconsin
My Commission Expires: March 11, 2012

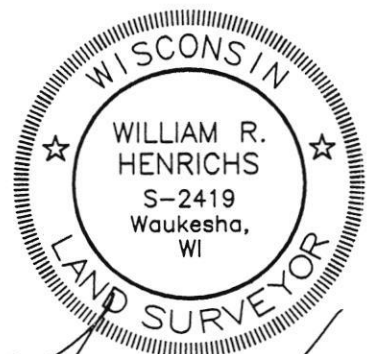

William R. Henrichs
January 18, 2011

DAAR ENGINEERING, INC.
REGISTERED LAND SURVEYORS AND CIVIL ENGINEERS
518 West Cherry Street, Milwaukee, WI 53212
PH. (414) 604-0674 FAX (414) 604-0677
WWW.DAARENGINEERING.COM

This instrument drafted by
William R. Henrichs, RLS S-2419

Job Number: 100330
December 2, 2010
Sheet 3 of 4 Sheets

CERTIFIED SURVEY MAP NO. 8377

Being Lots 7 to 16 inclusive, in Block 5, JUNEAU HIGHLANDS, being a part of the Southeast 1/4 of Section 3, Township 6 North, Range 21 East, City of West Allis, Milwaukee County, Wisconsin.

COMMON COUNCIL APPROVAL

Be it resolved by the Common Council of the City of West Allis, Wisconsin, that the Certified Survey Map of a parcel of land being Lots 7 to 16 inclusive, in Block 5, JUNEAU HIGHLANDS, located in part of the Southeast 1/4 of Section 3, Township 6 North, Range 21 East, City of West Allis, Milwaukee County, Wisconsin be and the same is hereby adopted.

Approved: February 18, 2011 Adopted: February 15, 2011

Dan Devine
Dan Devine, Mayor

Paul M. Ziehler
Paul Ziehler
City Administrative Officer
Clerk/Treasurer

CERTIFICATE OF COUNTY TREASURER

STATE OF WISCONSIN)
MILWAUKEE COUNTY) SS

I, Daniel Diliberti, being the duly elected, qualified and acting Treasurer of the County of Milwaukee, Wisconsin, do hereby certify that in accordance with the records in my office, there are no unpaid taxes of unpaid special assessments as of August 11, 2011, 2011 on any of the lands included in this Certified Survey Map.

August 11, 2011
Date

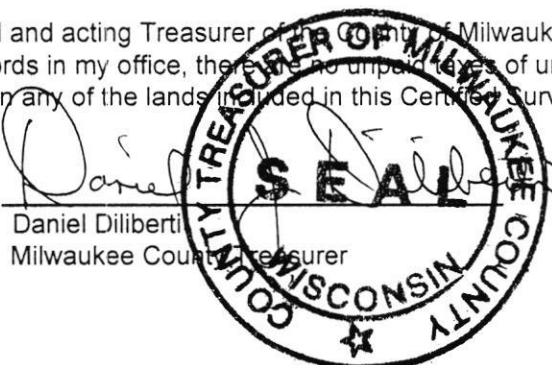

Daniel Diliberti
Daniel Diliberti
Milwaukee County Treasurer

CERTIFICATE OF CITY TREASURER

I, Paul Ziehler, being the duly elected, qualified and acting Treasurer of the City of West Allis, Wisconsin, do hereby certify that in accordance with the records in my office, there are no unpaid taxes of unpaid special assessments as of August 8, 2011 on any of the lands included in this Certified Survey Map.

8/8/11
Date

Paul M. Ziehler
Paul Ziehler
City Administrative Officer
Clerk/Treasurer

CERTIFICATE OF CITY CLERK

I, Paul Ziehler, being the duly elected, qualified and acting City Clerk of the City of West Allis, Wisconsin, and that the foregoing is a true and correct copy of a resolution adopted by the Common Council of the City of West Allis, Wisconsin on the 15th day of Febr, 2011.

8/8/11
Date

Paul M. Ziehler
Paul Ziehler
City Administrative Officer
Clerk/Treasurer

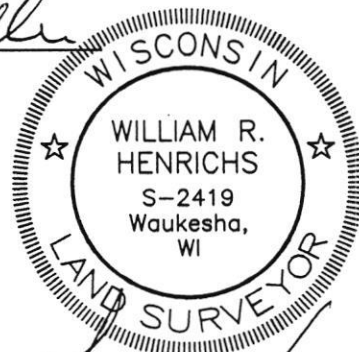

William R. Henrichs
January 18, 2011

DAAR ENGINEERING, INC.
REGISTERED LAND SURVEYORS AND CIVIL ENGINEERS
518 West Cherry Street, Milwaukee, WI 53212
PH. (414) 604-0674 FAX (414) 604-0677
WWW.DAAREENGINEERING.COM

This instrument drafted by
William R. Henrichs, RLS S-2419

Job Number: 100330
December 2, 2010
Sheet 4 of 4 Sheets

STATE OF WISCONSIN
MILWAUKEE COUNTY

I, the undersigned Register of Deeds of Milwaukee County, hereby certify that this document is a true and correct copy of the original on file or record in my office. Witness my hand and official seal this

AUG 11 2011

date

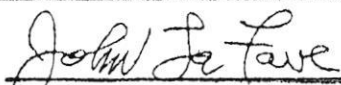

JOHN LA FAVE
Register of Deeds

RECEIVED

AUG 17 2011

WEST ALLIS
CITY ATTORNEY